

EXISTING GROUND FLOOR PLAN

- GENERAL NOTES:
- DO NOT SCALE.
 - ALL DIMENSIONS TO BE CHECKED ON SITE AND ANY DISCREPANCIES REPORTED IMMEDIATELY.
 - LOCATION OF ALL SERVICES (ABOVE & BELOW GROUND) TO BE FULLY VERIFIED BEFORE COMMENCEMENT.
 - DRAWINGS TO BE READ IN CONJUNCTION WITH ALL CONSULTANTS & SPECIALISTS DRAWINGS WHERE RELEVANT AND ANY DISCREPANCY BETWEEN THIS INFORMATION AND OTHER DRAWINGS FORMING PART OF THE CONTRACT TO BE CLARIFIED BEFORE COMMENCEMENT OR ORDERING OF MATERIALS.
 - THE COPYRIGHT OF THE DRAWINGS & DESIGN IS THE PROPERTY OF THE COMPANY AND UNAUTHORIZED REPRODUCTION IS PROHIBITED.
 - ALL ELEMENTS TO BE INSTALLED STRICTLY IN ACCORDANCE WITH MANUFACTURERS INSTRUCTIONS AND RELEVANT CURRENT LEGISLATION, BUILDING REGULATIONS, BRITISH STANDARDS AND GOOD PRACTICE.

2 No CCTV CAMERAS MOUNTED 2M ABOVE GL ON 100 mmX100mm POST WITH SPHERE CAPING

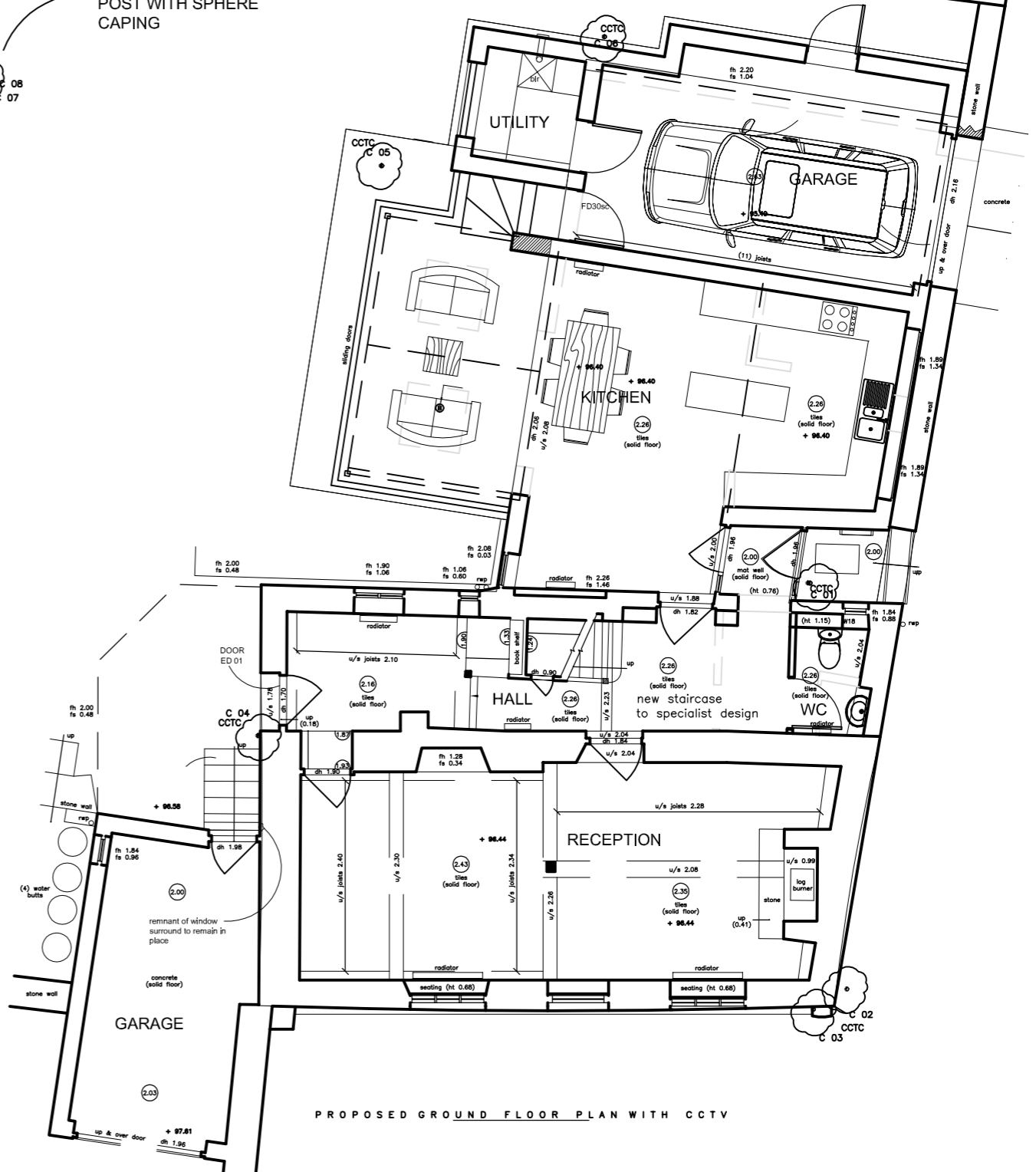
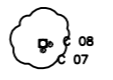

PROPOSED GROUND FLOOR PLAN WITH CCTV

PCA

ARCHITECTS & DESIGNERS

9 High Street, Eynsham, Oxford OX29 4HA
 Telephone: 01865 882646 Fax: 01865 883219
 email: PCA@PCA-Architects.com

PROJECT TITLE	PUMPKIN COTTAGE, 6 St. ANDREWS LANE, HEADINGTON, OXFORD		
DRAWING TITLE	Existing ground floor & proposed ground floor plan with CCTV locations		
CLIENT	MR & MRS MOUSSA		
drawn	PCA	scale	100
date	05/2021	dwg no.	1053-S02 PD UK 03