

01 EXISTING ROOF PLAN
SCALE 1:100 @ A3

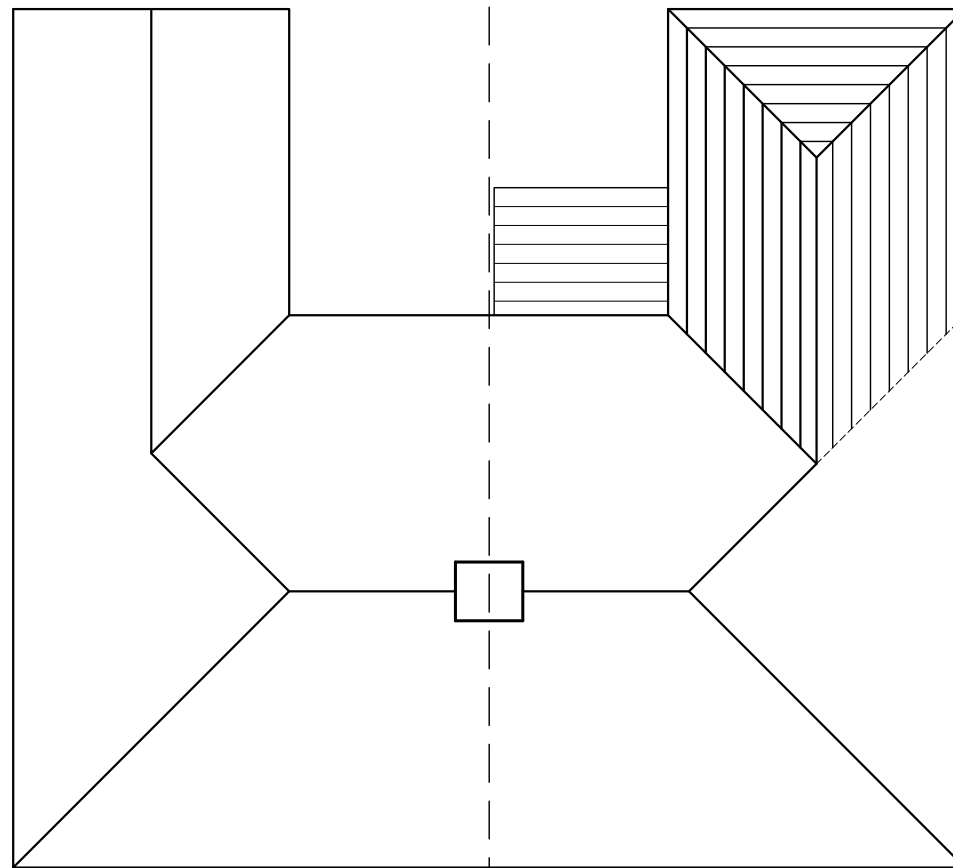

124 LYTHAM ROAD

02 PROPOSED ROOF PLAN
SCALE 1:100 @ A3

CONSTRUCT NEW PITCHED AND HIP ROOFS TO SINGLE AND TWO STOREY EXTENSIONS AS SHOWN USING CONCRETE INTERLOCKING TILES TO MATCH EXISTING. PITCH TO ROOF ABOVE SINGLE STOREY ELEMENT TO BE 22.5 DEGREES HIPPED ROOF TO TWO STOREY ELEMENT TO BE AT A PITCH TO MATCH EXISTING

ALL OFF TREATED SOFTWOOD BATTENS ON UNTEARABLE SARKING FELT AND TIMBER RAFTERS.

FORM NEW VALLEY WHEE SHOWN USING A PROPRIETARY BOARD SYSTEM OR CODE 5 LEAD ON 18mm WBP PLY

TREATED SOFTWOOD CEILING JOISTS WITH PLASTERBOARD AND SKIM FINISH INTERNALLY. KINGSPAN PIR INSULATION TO PROVIDE A MINIMUM OF 0.22W/m2K.

ROOF TO BE TIED LATERALLY TO NEW WALLS VIA 100 X 75mm TREATED SW WALLPLATES AND GALVANISED MS STRAPPING.

WHERE NEW ROOFS ABUT EXTERNAL WALLS INSERT NEW CODE 4 LEAD FLASHINGS 150mm ABOVE LINE OF ROOF LAPPED INTO NEW CAVITY TRAY

Rev	Description	Date	By	Chk
-----	-------------	------	----	-----

Status	Purpose for Issue
Planning <input type="checkbox"/>	Tender <input type="checkbox"/>
Construction <input type="checkbox"/>	As Built <input type="checkbox"/>

INFORMATION

Client
MR J BROADWELL

Contract
PROPOSED EXTENSION
122 LYTHAM ROAD
SOUTHPORT

Drawing
EXISTING AND PROPOSED ROOF PLAN



macintosh house
4a cambridge street
manchester m1 5gg
tel: 0161 236 0999
fax: 0161 236 0404
mail@bate-taylor.co.uk

Drawing No. MH1291-04 Revision /
Scales 1:100 @ A3 Date JUNE 21
Drawn DL Checked GB

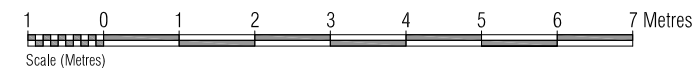

This drawing is the copyright of the Architect and may not be reproduced without licence.
DO NOT scale from this drawing.