

Site Block plan as existing  
1:200 scale

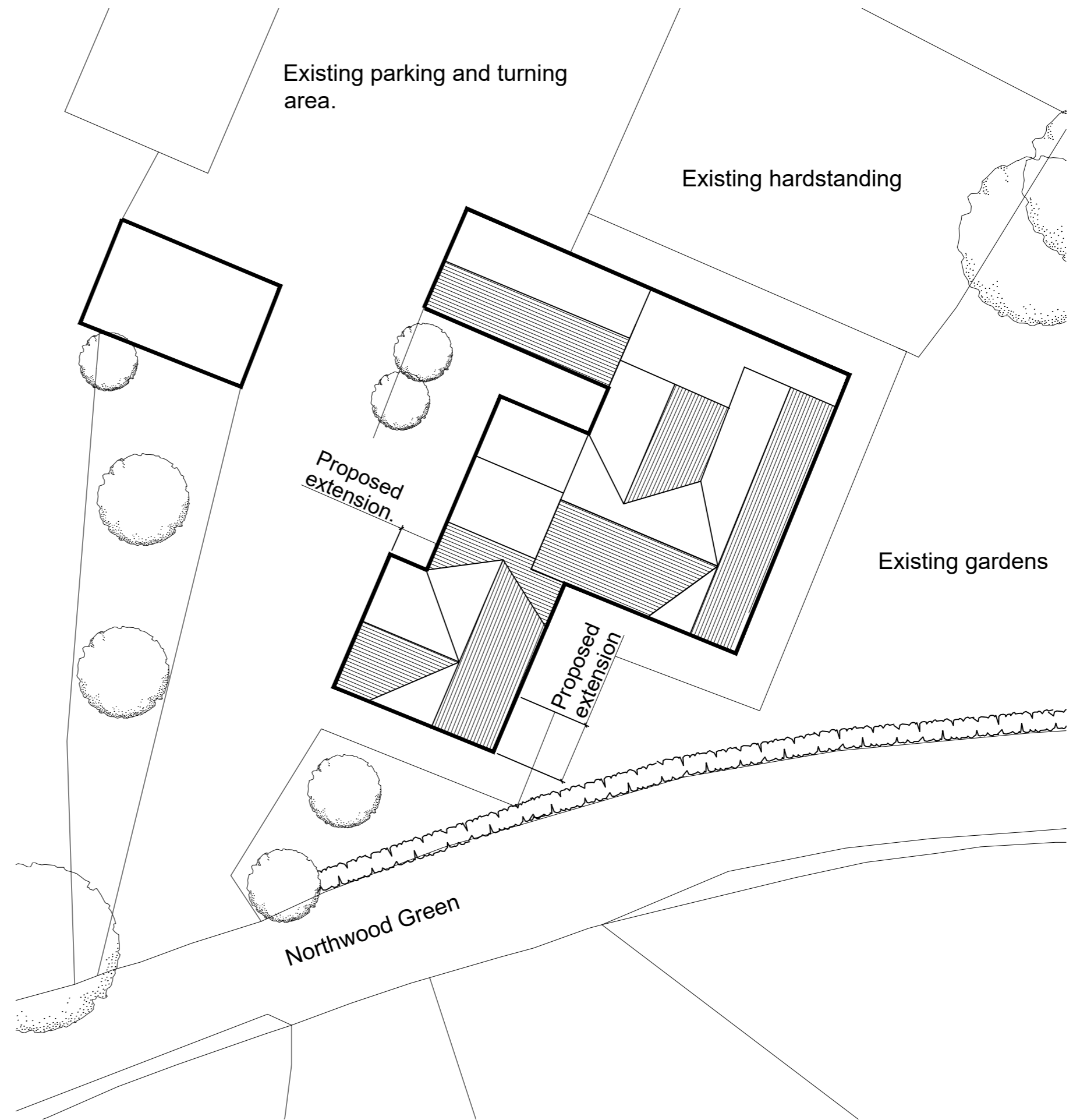
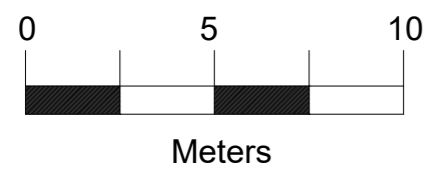

Site Block plan as Proposed  
1:200 scale

**Biodiversity enhancements**

- Bat boxes to be Schwegler 1FF or similar that will be hung at least 3.0m in height up the gable end.
- Bird boxes to be Vivara Seville 32mm woodstone Nest box and 1SP Schwegler Sparrow Terrace.

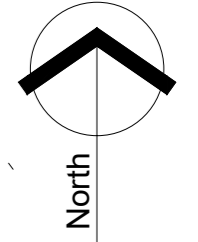

<b>GriffithsDesign</b> Architectural Technologists.			
			Tel: 07969446621 Email: griffithsdesign@outlook.com
<b>Client</b>	Mr & Mrs Paul		
<b>Project</b>	Proposed extension at; Oaklands Farm, Northwood Green Westbury on severn GL14 1NA		
<b>Drawing</b>	Existing and proposed site block plans.		
<b>Date</b>	April 2021	<b>Scale</b>	As Shown @ A2
<b>Drawn by</b>	JG	<b>Drawing No</b>	[PP] 03
<b>Checked by</b>	***		
<b>Revision</b>			