

Notes:
 Drawings are based on survey data and may not accurately represent what is physically present.
 Do not scale from this drawing. All dimensions are to be verified on site before proceeding with the work.
 All dimensions are in millimeters unless noted otherwise.
 Purcell shall be notified in writing of any discrepancies.

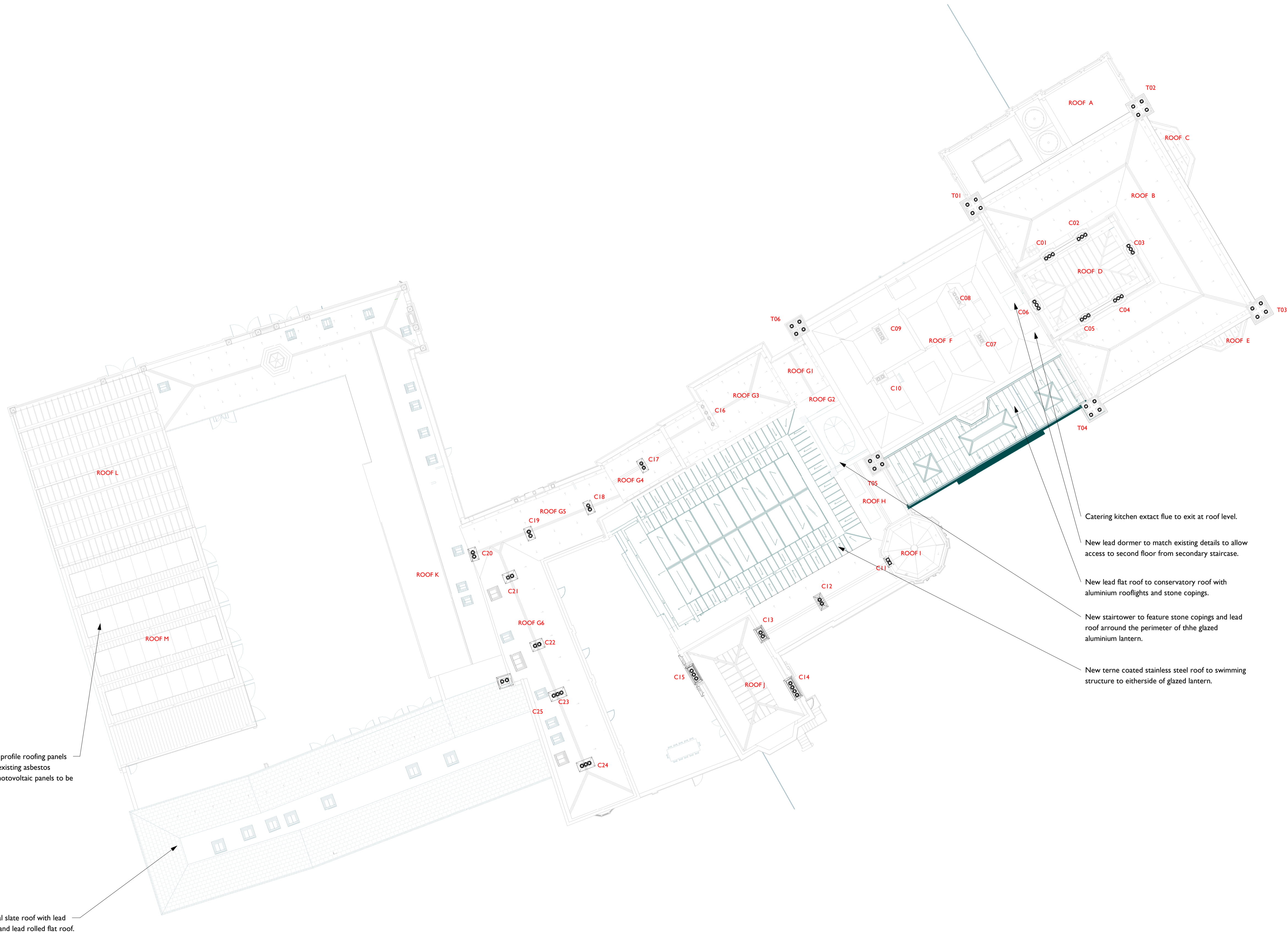
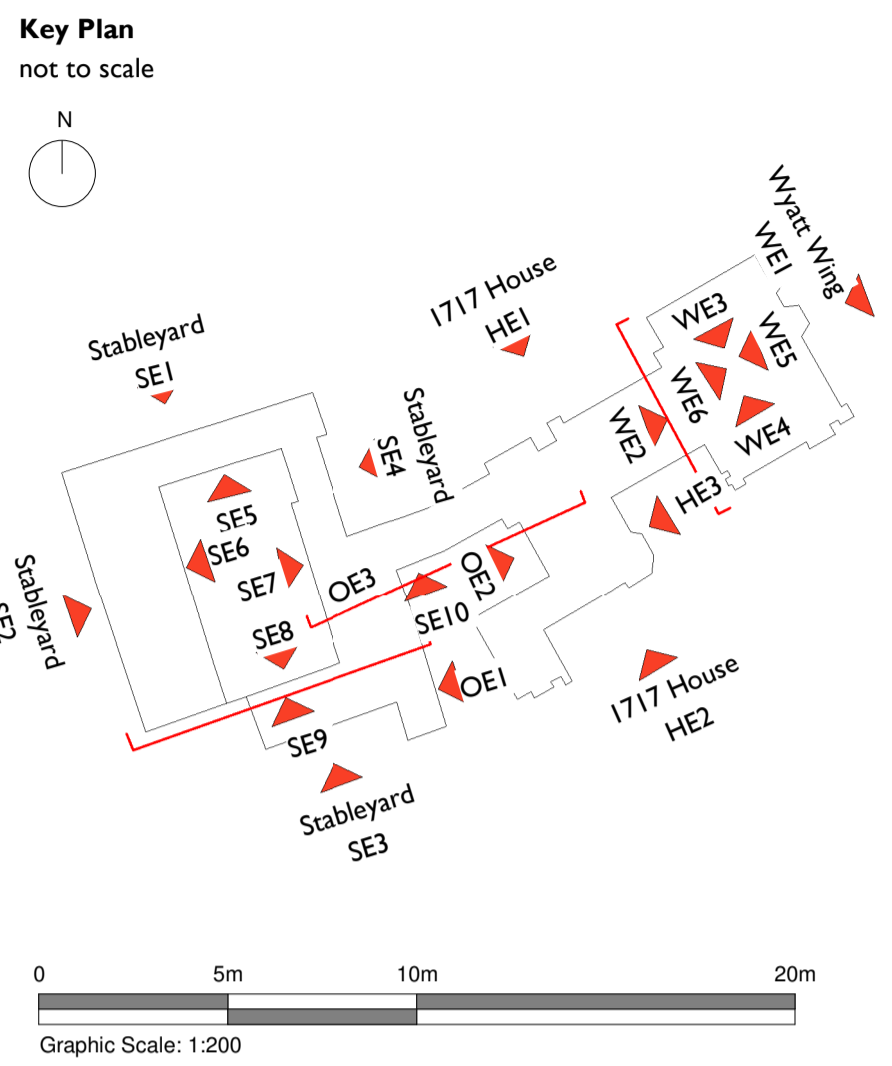

New metal profile roofing panels to replace existing asbestos sheeting. Photovoltaic panels to be installed.

New natural slate roof with lead rolled hips and lead rolled flat roof.

- Catering kitchen extract flue to exit at roof level.
- New lead dormer to match existing details to allow access to second floor from secondary staircase.
- New lead flat roof to conservatory roof with aluminium rooflights and stone copings.
- New stairtower to feature stone copings and lead roof around the perimeter of the glazed aluminium lantern.
- New terre coated stainless steel roof to swimming structure to eitherside of glazed lantern.

1 Roof Plan as Proposed with Repairs
 2120 1 : 200

P01	21/04/21	For Planning
REV	DATE	DESCRIPTION

CLIENT
 Colin Shenton

PROJECT
 Cuerden Hall, Chorley

JOB NUMBER
 240729

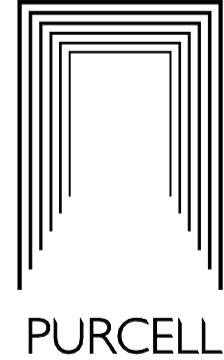

TITLE
 Roof Repairs

SIZE	SCALE	LAST REVISED	DRAWN	CHECKED
A1L	As Shown	16/03/2021	ZB	

REV SUITABILITY/REASON FOR ISSUE
P01 S04 - For Planning

DRAWING NUMBER
 240729-PUR-00-RF-DR-A-2120