

New windows openings to have flat brick arches, stone cills and timber framed casement windows.

Install new steel framed mezzanine structure and insulated joisted floor deck. Take up existing asbestos sheet roofing and replace with zinc profiled metal sheet roofing. Insulated between and below rafter. Replace glazed vertical rooflights (removed in the past).

Re-instate fire destroyed first floor structure, external walls and slate covered pitched roof structure over.

New windows openings to have flat brick arches, stone cills and timber framed casement windows.

Remove modern timber weatherboarding.

Inset new wall construction by approximately 600mm. Wall construction to be of steel and timber frame, with new timber horizontal boarding externally. Doors to be ledged and braced timber double doorsets with secure steel frames and backing as required for security.

Notes:
 Drawings are based on survey data and may not accurately represent what is physically present.

Do not scale from this drawing. All dimensions are to be verified on site before proceeding with the work.

All dimensions are in millimeters unless noted otherwise.

Purcell shall be notified in writing of any discrepancies.

Key Plan
 not to scale

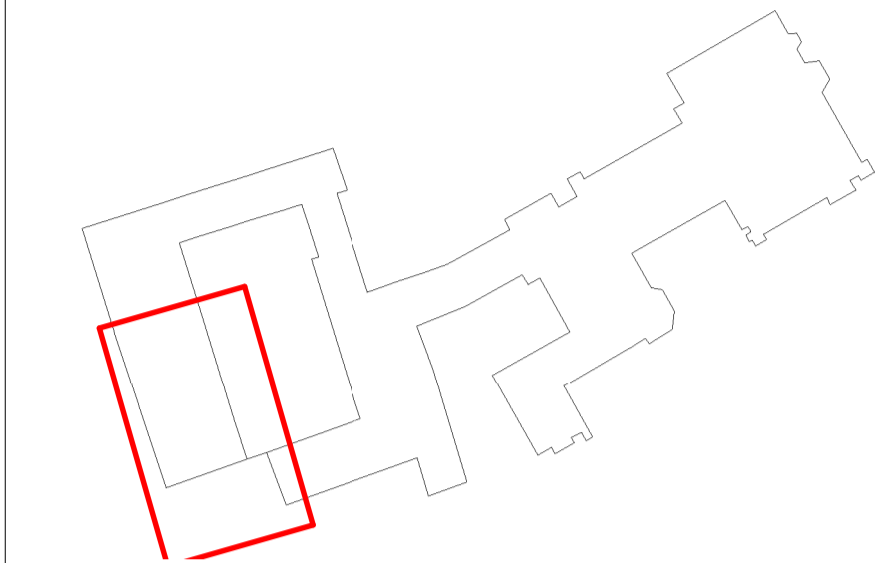

GENERAL NOTES

- Internal Refurbishment:
 Refurbish interiors generally throughout stableyard, office wing and service courtyard ranges. Install internal insulated linings to internal walls of the stableyard and office wing ranges. Install insulation between and below the rafters of the stableyard and upgrade insulation above ceiling level to the office wing and service courtyard.
- Take down modern suspended tile ceilings and metal framed suspension systems throughout, undertake repairs to existing plaster ceilings where in reasonable condition, or underdraw with new plasterboard ceilings where existing ceilings do not survive / are in poor condition.
- Where existing floors are modern concrete slabs, excavate, install new limecrete slabs with underfloor heating and new floor finishes. Where existing floors are stone flagged, carefully take up existing flagstones, excavate, install new limecrete slabs with underfloor heating and re-lay flagstones.
- Windows:
 Undertake repairs to existing timber sash frames, refurbish weights, pulleys and fittings, undertake repairs to glass where required, install draft seals and redecorate. Refer to window repair schedules for further detail. Install metal framed openable secondary glazing behind existing windows to stableyard, office wing and service courtyard ranges. New windows to these ranges to be double glazed timber framed units.
- Doors:
 Undertake repairs to existing timber internal and external doors, refurbish door hardware and redecorate. Install draft seals to external doors. New external doors as noted on the drawings.
- External Metalwork
 Brush down existing metalwork to remove corrosion, repair as required and redecorate.
- Structural Work
 Refer to Structural Engineer's information.
- Building Services
 Refer to M&E Consultant's information.
- Landscaping
 Refer to Landscape Architects drawings for further detail.

REV	DATE	DESCRIPTION
P01	21/04/21	For Planning

CLIENT
 Colin Shenton

PROJECT
 Cuerden Hall, Chorley

JOB NUMBER
 240729

TITLE
 Proposed Stableyard FF Sheet 5

SIZE	SCALE	LAST REVISED	DRAWN	CHECKED
A1L	As Shown	22/03/2021	ZB	

REV
 P01

SUITABILITY/REASON FOR ISSUE
 S04 - For Planning

DRAWING NUMBER
 240729-PUR-00-XX-DR-A-2046

St James, 79 Oxford Street, Manchester, M1 4FQ
 © PURCELL 2019. PURCELL IS THE TRADING NAME OF PURCELL ARCHITECTURE LTD.

