

KEY
 Install openable secondary glazing internally to existing windows to improve thermal performance.

Notes:
 Drawings are based on survey data and may not accurately represent what is physically present.
 Do not scale from this drawing. All dimensions are to be verified on site before proceeding with the work.
 All dimensions are in millimeters unless noted otherwise.
 Purcell shall be notified in writing of any discrepancies.

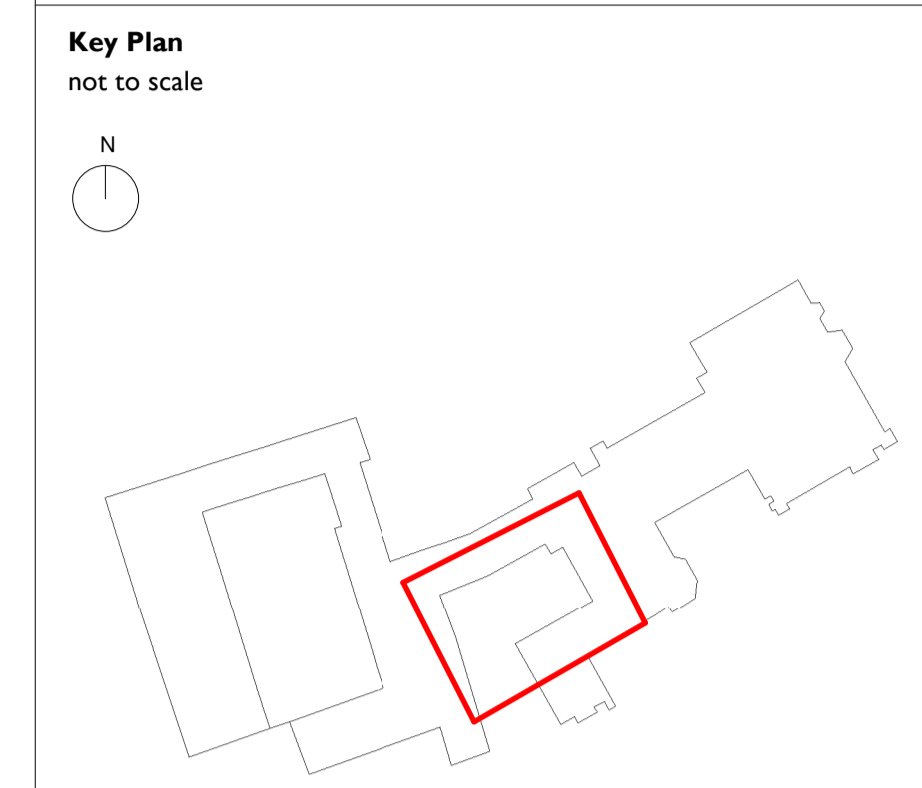

GENERAL NOTES

- Decoration:
 Replace modern inappropriate light fittings, emergency signage and electric wall heaters throughout, make good any damage to surfaces and redecorate throughout.
 Historic paint analysis to be undertaken to the principal rooms of the Wyatt Wing to inform decorative scheme and colours TBC.
- Ceilings:
 Take down modern suspended tile ceilings and metal framed suspension systems throughout and undertake repairs to existing plaster ceilings and cornicing.
- Windows:
 Undertake repairs to existing timber sash frames, refurbish weights, pulleys and fittings, undertake repairs to glass where required, install draft seals and redecorate. Refer to window repair schedules for further detail.
- Doors:
 Undertake repairs to existing timber internal and external doors, refurbish door hardware and redecorate. Install draft seals to external doors.
- External Metalwork
 Brush down existing metalwork to remove corrosion, repair as required and redecorate.
- Structural Work
 Refer to Structural Engineer's information.
- Building Services
 Refer to M&E Consultant's information.
- Landscaping
 Refer to Landscape Architects drawings for further detail.

P01	21/04/21	For Planning
REV	DATE	DESCRIPTION

CLIENT
Colin Shenton

PROJECT
Cuerden Hall, Chorley

JOB NUMBER
240729

PURCELL

TITLE
Proposed Wyatt Wing and 1717 House
FF Plan Sheet 4

SIZE	SCALE	LAST REVISED	DRAWN	CHECKED
A1L	As Shown	10/03/2021	ZB	ZB
REV	SUITABILITY/REASON FOR ISSUE			
P01	S04 - For Planning			
DRAWING NUMBER				
240729-PUR-00-01-DR-A-2038				
St James', 79 Oxford Street, Manchester, M1 4FQ				
© PURCELL 2019. PURCELL IS THE TRADING NAME OF PURCELL ARCHITECTURE LTD.				

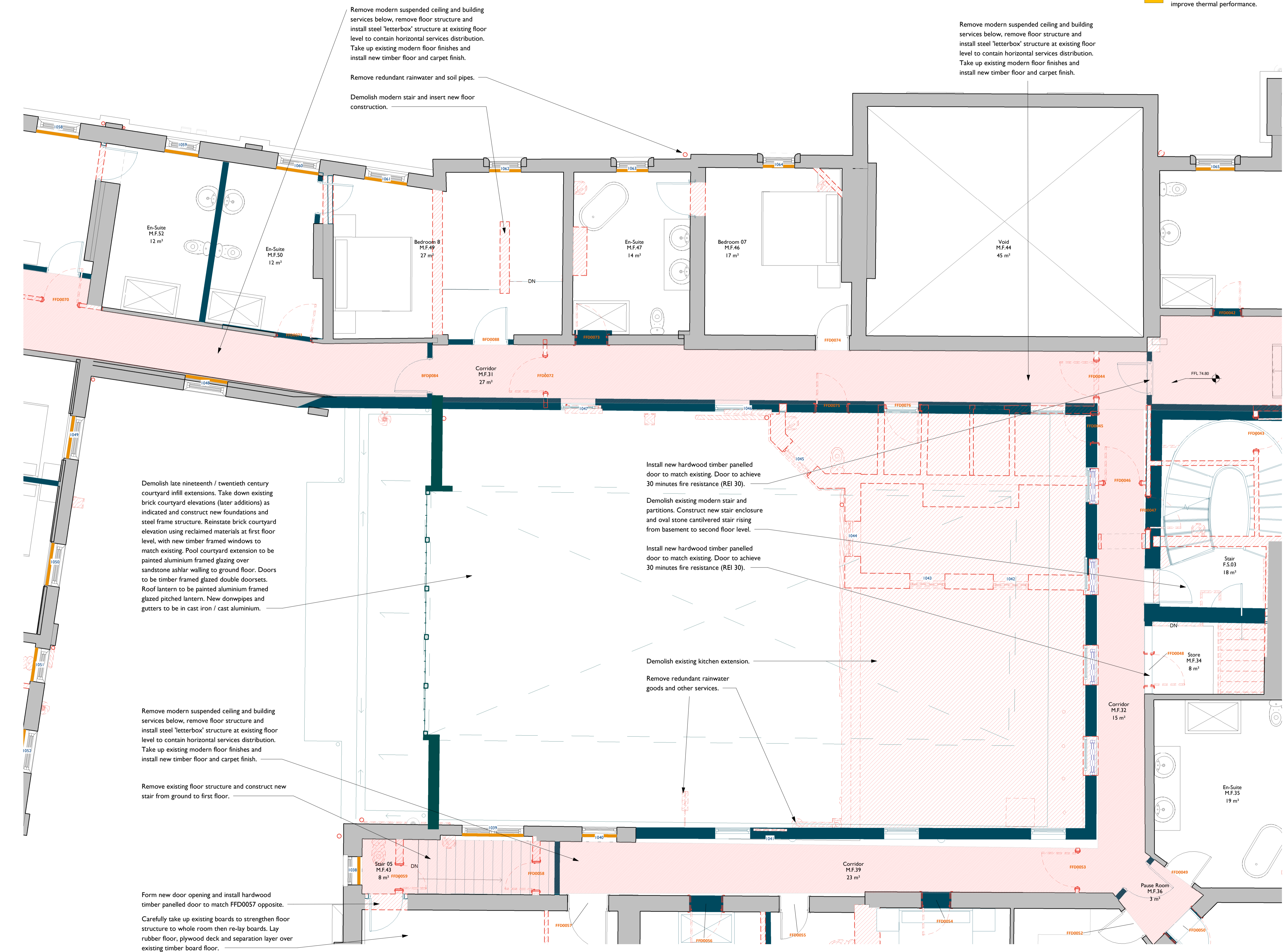

1 First Floor Plan As Proposed
 2038 1 : 50

