

Demolish late nineteenth / twentieth century courtyard infill extensions. Take down existing brick courtyard elevations (later additions) as indicated and construct new foundations and steel frame structure. Reinststate brick courtyard elevation using reclaimed materials at first floor level, with new timber framed windows to match existing. Pool courtyard extension to be painted aluminium framed glazing over sandstone ashlar walling to ground floor. Doors to be timber framed glazed double doorsets. Roof lantern to be painted aluminium framed glazed pitched lantern. New downpipes and gutters to be in cast iron / cast aluminium.

Form new opening and install hardwood timber six panel door and moulded architraves to match existing.

Remove existing floor structure and construct new stair from ground to first floor.

Remove existing modern partitions.

Remove timber boxings to reveal existing fireplace.

Re-glaze existing timber rooflight.

Demolish existing modern stair and partitions. Construct new stair enclosure and oval stone cantilvered stair rising from basement to second floor level.

Demolish existing kitchen extension.

Remove redundant rainwater goods and other services.

Carefully take up existing boards to strengthen floor structure to whole room then re-lay boards. Lay rubber floor, plywood deck and separation layer over existing timber board floor.

Replace modern door with hardwood timber six panelled door.

Brush down cast iron handrail and balustrade and redecorate.

Drop levels externally as part of the landscape proposals. Add one additional sandstone step to the base of the existing stone stair.

KEY

Install openable secondary glazing internally to existing windows to improve thermal performance.

Notes:

Drawings are based on survey data and may not accurately represent what is physically present.

Do not scale from this drawing. All dimensions are to be verified on site before proceeding with the work.

All dimensions are in millimeters unless noted otherwise.

Purcell shall be notified in writing of any discrepancies.

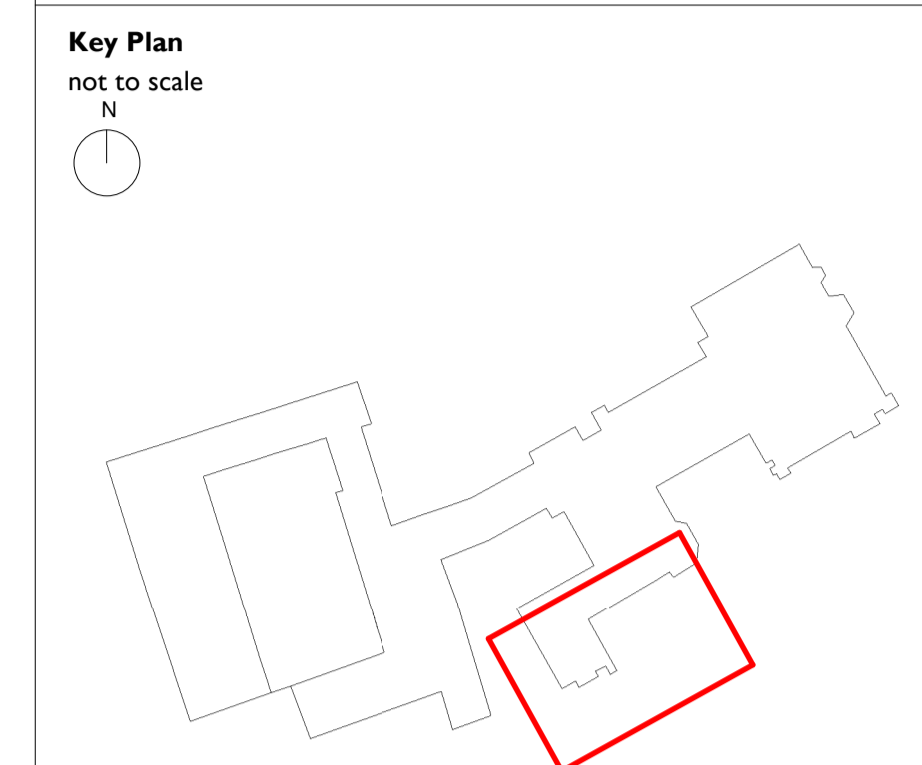

GENERAL NOTES

- Decoration:
 - Replace modern inappropriate light fittings, emergency signage and electric wall heaters throughout, make good any damage to surfaces and redecorate throughout.
 - Historic paint analysis to be undertaken to the principal rooms of the Wyatt Wing to inform decorative scheme and colours TBC.
- Ceilings:
 - Take down modern suspended tile ceilings and metal framed suspension systems throughout and undertake repairs to existing plaster ceilings and cornicing.
- Windows:
 - Undertake repairs to existing timber sash frames, refurbish weights, pulleys and fittings, undertake repairs to glass where required, install draft seals and redecorate. Refer to window repair schedules for further detail.
- Doors:
 - Undertake repairs to existing timber internal and external doors, refurbish door hardware and redecorate. Install draft seals to external doors.
- External Metalwork
 - Brush down existing metalwork to remove corrosion, repair as required and redecorate.
- Structural Work
 - Refer to Structural Engineer's information.
- Building Services
 - Refer to M&E Consultant's information.
- Landscaping
 - Refer to Landscape Architects drawings for further detail.

PO1	21/04/21	For Planning
REV	DATE	DESCRIPTION

CLIENT
Colin Shenton

PROJECT
Cuerden Hall, Chorley

JOB NUMBER
240729

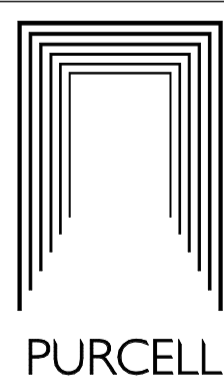

TITLE
Proposed Wyatt Wing and 1717 House
FF Sheet 5

SIZE	SCALE	LAST REVISED	DRAWN	CHECKED
A1L	As Shown	11/03/2021	ZB	
REV	SUITABILITY/REASON FOR ISSUE			
P01	S04 - For Planning			
DRAWING NUMBER				
240729-PUR-00-01-DR-A-2039				
St James', 79 Oxford Street, Manchester, M1 4FQ				
© PURCELL 2019. PURCELL IS THE TRADING NAME OF PURCELL ARCHITECTURE LTD.				

