

All drawings, notes, details and dimensions are to be checked prior to starting work and any discrepancies are to be reported immediately to DesignForLiving.

IF IN DOUBT ASK !

Notwithstanding the representations on this drawings, all foundations and structural members are to be designed to comply in all respects with the Construction and Building Acts, and all their amendments. This drawing is subject to advice from a structural consultant before implementation.

DesignForLiving cannot be responsible for drawing accuracy if issued from any other location other than their offices.

This drawing is the copyright of DesignForLiving.

PLANNING DRAWING

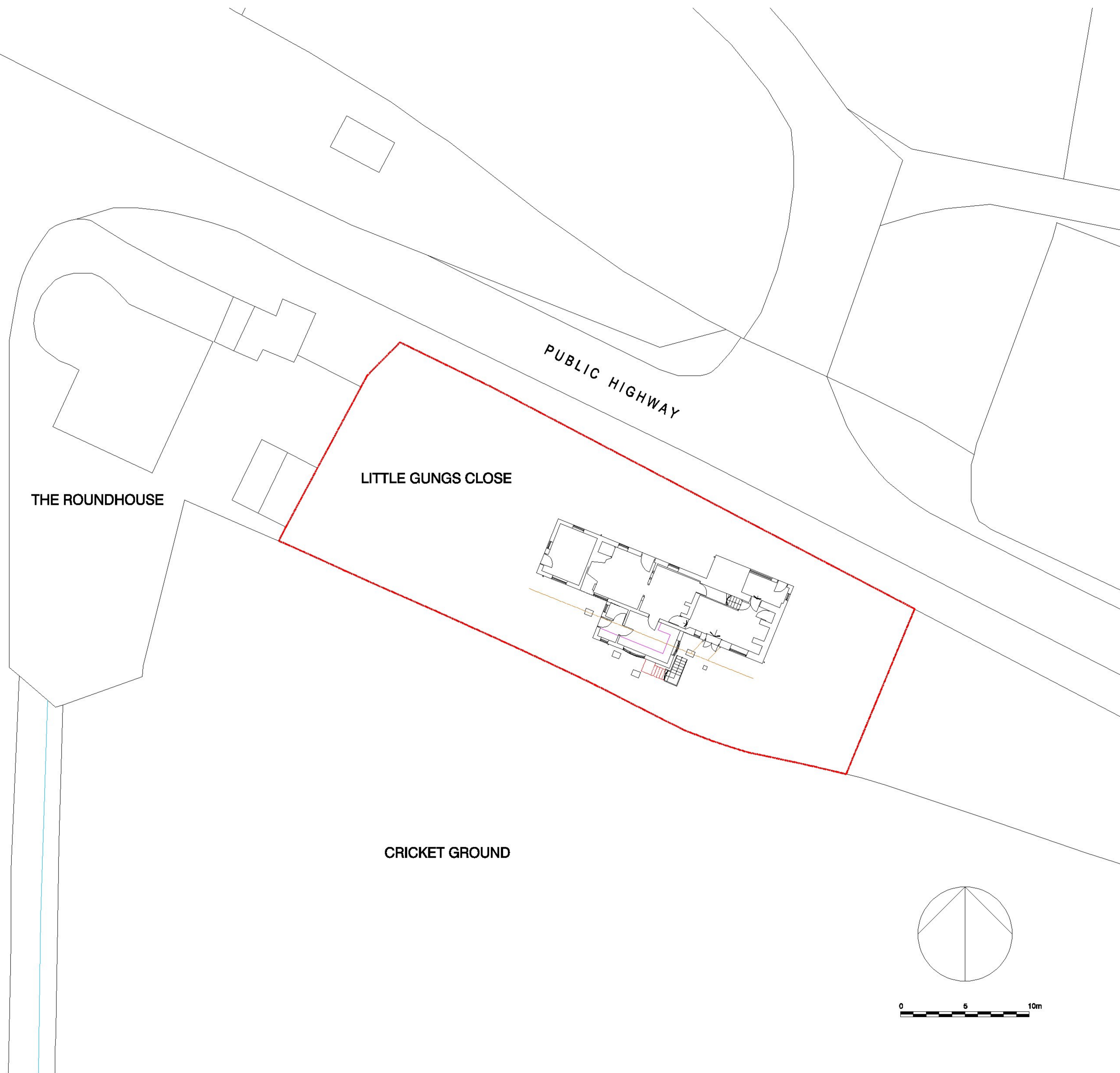

revision	description	date	drawn
----------	-------------	------	-------

drawing status **PLANNING DRAWING**

DesignForLiving

Architects Limited

Suite 9 Westend Courtyard, Groves Lane, Westend, Stonehouse GL10 3SL
Tel: 01453 298388 Mob: 07702 998208 info@designforlivinguk.com
www.designforlivinguk.com

title **SITE PLAN**

**LITTLE GUNGS CLOSE
WITCOMBE**

project

client

date **MAY 2021**

scale **1:200 @ A2**

drawn **DPS**

2290-P-03