

CATEGORY AND DEFINITION	
Trees unsuitable for retention	
Category U	Those in such condition that they cannot realistically be retained as living trees in the current land use for longer than 10 years
Trees to be considered for retention	
Category A	Trees of high quality with an estimated remaining life expectancy of at least 40 years
Category B	Trees of moderate quality with an estimated remaining life expectancy of at least 20 years
Category C	Trees of low quality with an estimated remaining life expectancy of at least 10 years, or young trees with a stem diameter below 150mm

NOTE:
Hayden's Arboricultural Consultants were provided with a Topographical Survey LDS Survey drawing no LDS/15009-TP1

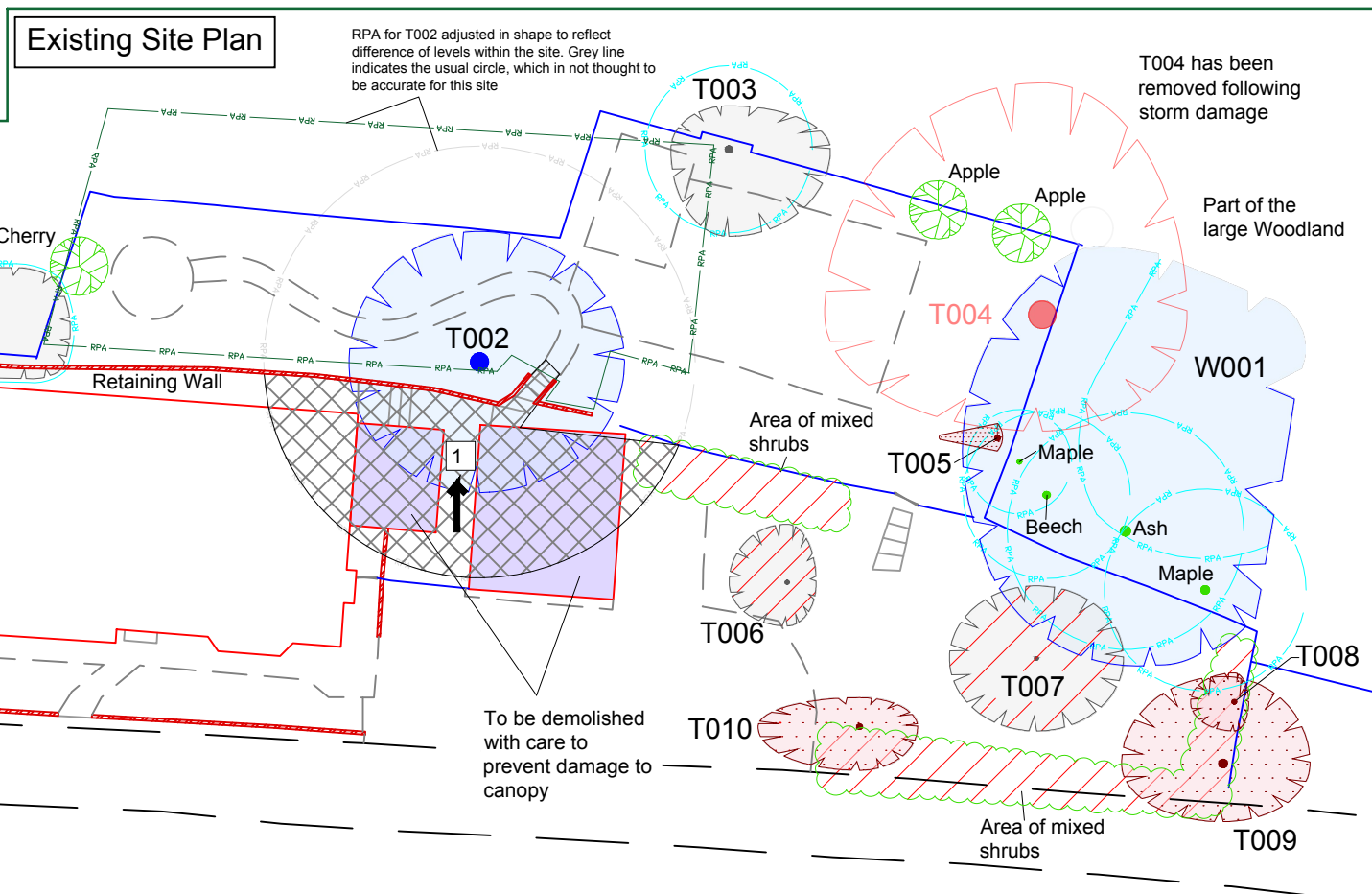

LEGEND	
	Existing Tree/Hedge BS 5837:2012 Category B
	Existing Tree/Hedge BS 5837:2012 Category C
	Existing Tree/Hedge to be removed to allow for development BS 5837:2012 Category C
	Existing Tree/Hedge to be removed BS 5837:2012 Category U
	Line of Root Protection Area (RPA) - calculated following guidelines set in BS 5837:2012
	Modified Root Protection Area as per section 4.6.2 of BS5837 : 2012
	Additional feature which doesn't meet BS 5837:2012 categorisation but is included for reference
	Existing hard surfacing within the RPA considered likely to have precluded notable root development
	Existing structure to be demolished with care to prevent damage to canopy
	Line of proposed temporary protective barrier
	Area of temporary Ground Protection
	Line of proposed Root Pruning
	Shed base within & close to the RPA to be constructed following the No Dig Specification

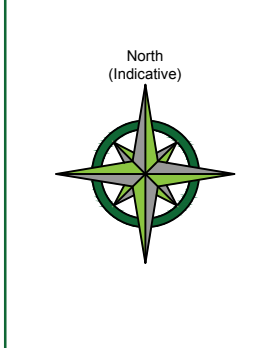
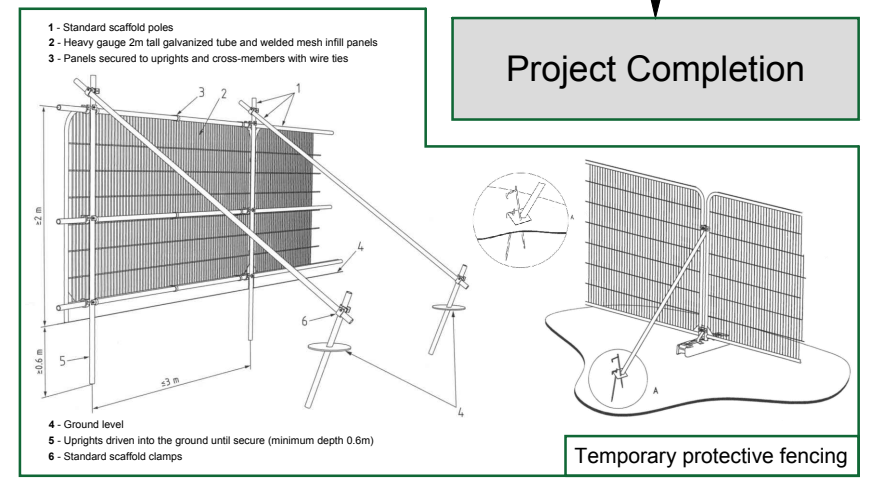
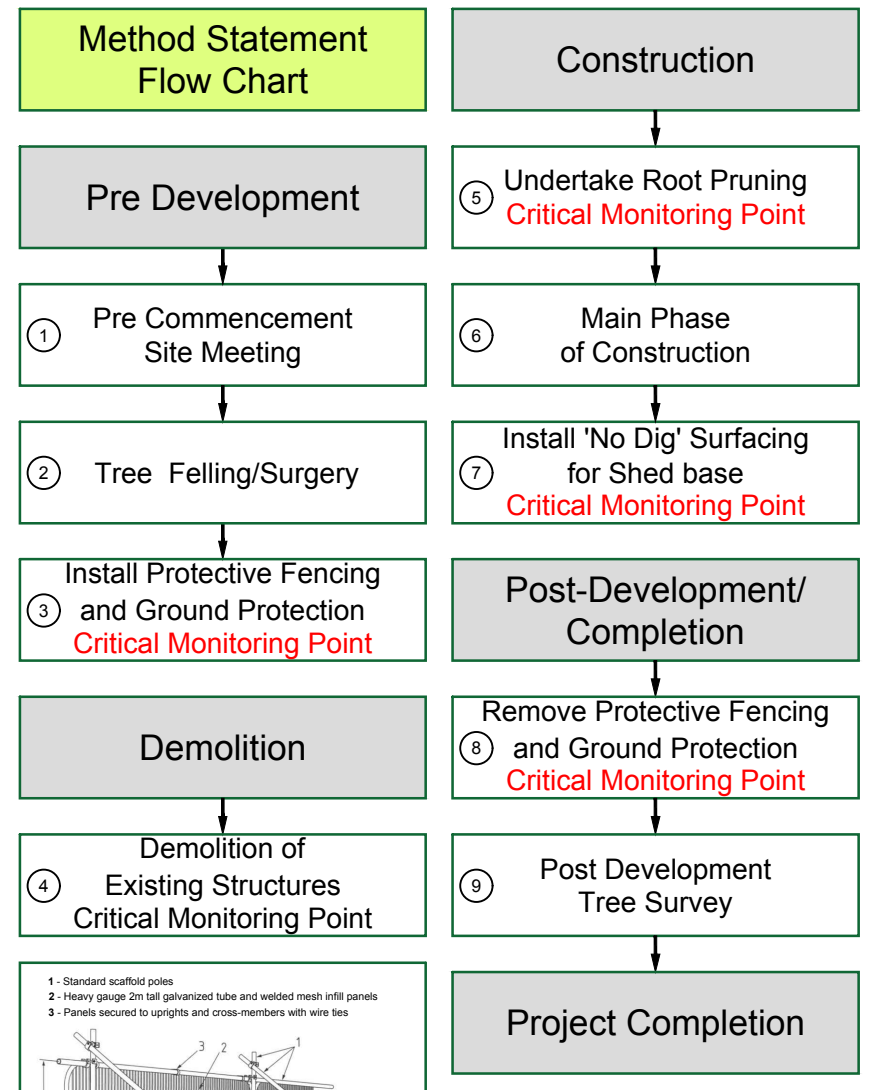
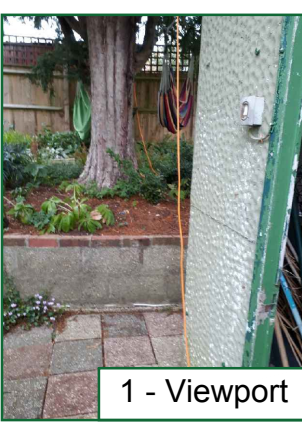
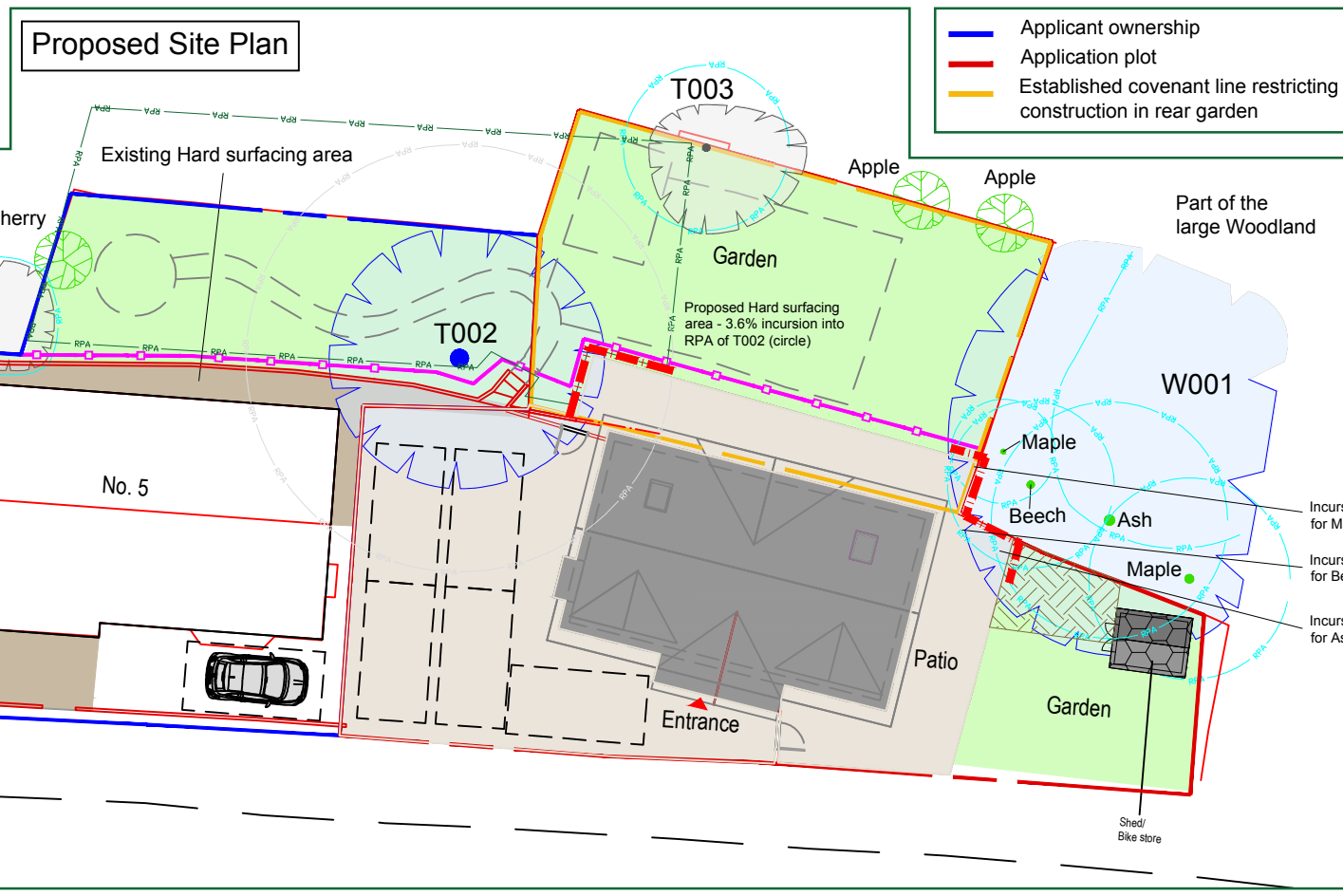
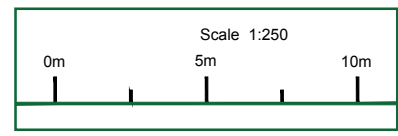

Rev.	Date	By	Revision
A	20/05/21	KFJ	Based on Birch Architects Proposed Site Plan Drawing: 0235-02
-	25/10/16	KA	Drawing based on Barclay and Philips drawing no P17-10002-02-02

The position, condition, and dimensions of the trees are based on a site survey undertaken on 04/10/18

"The original of this drawing was produced in colour - a monochrome copy should not be relied upon"

Do Not Scale