

SCALE 1 : 100

SCALE 1 : 1

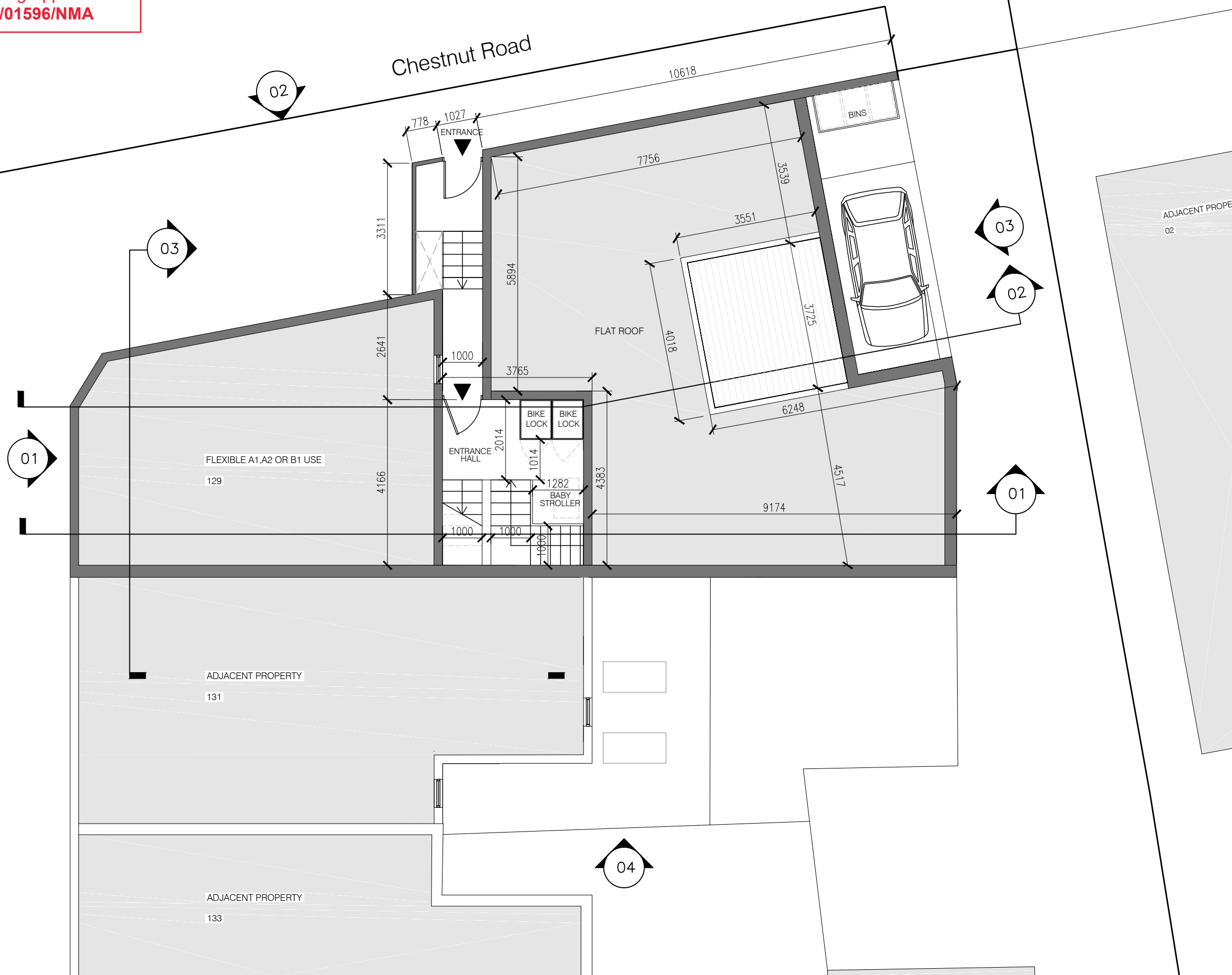

**Planning Application**  
**21/01596/NMA**



**Notes**

All dimensions to be verified on site.  
Do not scale this drawing.

All discrepancies to be clarified with project Architect. The areas are approximate and can only be verified by a detailed dimensional survey of the completed building. Any decisions to be made on the basis of these predictions, whether as to project viability, pre-letting, lease agreements or the like, should include due allowance for the increases and decreases inherent in the design development and building processes. Figures relate to the likely areas of the building at the current state of the design and using the Gross External Area (GEA) / Gross Internal Area (GIA) / Net Internal Area (NIA) method of measurement from the Code of Measuring Practice, 6th Edition (RICS Code of Practice).

This drawing is the property of SEEDING OFFICE LTD and is issued on the condition it is not reproduced, retained or disclosed to any unauthorized person, either wholly or in part without written consent of Stefano Sedda, principal director at Seeding Office.  
Ordnance Survey material is used with the permission of The Controller of HMSO, Crown copyright AR 159670.

The full project design teams comprehensive set of hazard management procedures are available from the Planning Supervisor/Safety Coordinator appointed for the project.



A0 29.10.18 FIRST ISSUE SS

Rev	Date	Description	By	Chk'd



Client  
**Sean Ferguson**  
129 Richmond Road, KT2 5BZ

Project  
129 Richmond Road  
London, KT2 5BZ

Drawing Title  
**GROUND FLOOR PLAN  
PROPOSED**

Drawn By: SS      Checked By: SS

Scale: 1:100@A3      Date: 29.10.18

Project No. 1702      Drawing No. SO-MA-20-2001      Revision A4

Status  
**PLANNING ONLY**

Notes