



Plate 37: Overview of excavated material from TP370.



Plate 38: Detailed view of sidewalls in completed TP370.



Plate 39: Overview of excavated material from TP375.



Plate 40: Detailed view of sidewalls in completed TP375.



Plate 41: Overview of excavated material from TP380.



Plate 42: Detailed view of sidewalls in completed TP380.



Plate 43: Overview of excavated material from TP387.



Plate 44: Detailed view of sidewalls of completed TP387.



Plate 45: Overview of excavated material from TP391.



Plate 46: Detailed view of sidewalls in completed TP391.



Plate 47: Overview of stockpiled material where sample SP6 was taken.



Plate 48: Overview of stockpiled material where sample SP9 was taken.



Appendix 3 Invasive Plant Survey

Johnson Poole and Bloomer
50 Speirs Wharf
Glasgow
G4 9TB

23rd December 2019

FAO: Martin Keir

Invasive Weeds Survey

S3077 - Saughs Road, Robroyston, Glasgow, G33 1PQ

Thank you for your recent enquiry in relation to invasive/legislated weeds. The development area above has been inspected and we are pleased to provide the following report in regard to our findings and recommendations.

Development Description

The survey area is located to the east of Robroyston, Glasgow. The survey area comprises mostly farmland the survey area has been subject to some soil disturbances/earthworks with bunds of soils to the southwest of the site. The M80 Motorway runs along the southern boundary with new developments to the Northwest and further farmland to the northeast

Survey Details – The survey was carried out on 19th December 2019 which is outwith the growing season. At this time of year controlled weeds are identified by any plant material/ vegetation remaining at the time of our inspection. Plant residue such as leaf litter and dead/ dying stalks are used as an identification aid. Japanese Knotweed undergoing herbicide management can be more difficult to find and identify, however, identification is still possible if plant crowns or sporadic/bonsai growth are present. We would ask that if the property owner/manager/developer is aware of any treatment programmes; including any infestations historically treated/eradicated and under guarantee, then this information should be disclosed to KleerKut.

This survey was non-intrusive and based on a visual inspection. We would caveat our findings on the basis that there has been significant soil movement within the south west of the site with bunds which may contain/conceal invasive species not visible at the time of our inspection.

Survey Findings – Commonly Known Species Controlled By Legislation

The commonly known plants which we record during our inspections are the following:

- | | |
|---|--------------------|
| • Japanese Knotweed (<i>Fallopia japonica</i>) | No evidence |
| • Giant Hogweed (<i>Heracleum mantegazzianum</i>) | No evidence |
| • Himalayan Balsam (<i>Impatiens glandulifera</i>) | No evidence |

These plants are on Schedule 9 of the Wildlife & Countryside (Scotland) Act 1981. In Scotland Schedule 9 has been superseded by amendments brought in by the Wildlife and Natural Environment (Scotland) Act 2011 (WANE) where the legal presumption is now against causing the growth in the wild of any non-native species outwith their native range (exceptions and definitions apply to non-wild areas).

There was no **Japanese Knotweed** (*Fallopia japonica*), **Giant Hogweed** (*Heracleum mantegazzianum*) or **Himalayan Balsam** (*Impatiens glandulifera*) recorded during our inspection of the survey area.

Survey Findings – Other Legislated Species

In addition to the commonly known plants noted above, there are other plants controlled under Schedule 9 of the Wildlife Countryside (Scotland) Act 1981 as amended by the Wildlife and Natural Environment (Scotland) Act 2011. Our reporting of these invasive plants is based on our opinion of the impact they will have on the proposed development and the risk that they will be spread as a result of the site works as the legislation controlling them make it an offence to grow or cause the growth of them.

There were no other legislated species of concern recorded during our inspection of the survey area.

Survey Findings – Problematic Non Legislated Species

In addition to the legislated plants recorded above, we also consider other non-legislated plants which could compromise/impact any development. While it is not an offence to have these plants on site there are reasons why the developer may want to consider management or treatment of them. One such plant is Horsetail.

There was no Horsetail identified during our inspection. Our walkover was limited to visual inspection given there has been some evidence of grounds maintenance and in addition as Horsetail quickly degrades once it has died back for winter, there is a possibility that Horsetail is present that was not visible at the time of our inspection.

KleerKut Conclusions

There was no Japanese Knotweed, Giant Hogweed or Himalayan Balsam visible within the survey area at the time of our inspection.

There was no evidence of any other problematic species either Legislated or Non Legislated visible within the site at the time of our inspection.

As noted previously Horsetail quickly degrades once it has died back for winter, leaving little residue. There is a possibility that there are infestations present that were not visible at the time of our inspection.

KleerKut Accreditation

KleerKut are a non-franchised Scottish business who have specialised in the management of invasive weeds since 2006. We have built up an enviable reputation as specialists in Japanese Knotweed by providing clear, concise and proven remediation strategies which ensure that Best Practical Environmental Options (BPEO) are achieved as recommended in the Japanese Knotweed Code of Practice.

Our knowledge and experience have enabled us to become approved consultants and contractors with many of the leading consultants, developers and construction companies throughout the UK. This was further enhanced after we were invited to join the Property Care Association (PCA). By being members of the PCA our works are Government endorsed through their Trustmark scheme. We are also able to provide our clients with insurance backed guarantees and Bondpay schemes.

KleerKut are accredited members of Constructionline and SMAS Safe Systems in Procurement demonstrating our commitment to working safely in partnership with our clients and sub-contractors.

In General

Thank you for your enquiry and should you have any further queries in relation to this site or any other site, please do not hesitate to contact me at this office.

Yours faithfully



Survey Photographs



Photo 1
General Overview



Photo 2
Area of soil disturbance.



Appendix 4 Historic Ordnance Survey Plans

Historical Mapping Legends

Ordnance Survey County Series and Ordnance Survey Plan 1:2,500

Quarry, **Gravel Pit**, **Sand Pit**, **Clay Pit**, **Shingle**, **Refuse Heap**, **Sloping Masonry**, **Flat Rock**, **Marsh**, **Reeds**, **Osiers**, **Rough Pasture**, **Furze**, **Wood**, **Mixed Wood**, **Brushwood**, **Orchard**, **Fir**, **Ford**, **Stepping Stones**, **Ferry**, **Waterfall**, **Lock**, **Trig. Station**, **Altitude at Trig. Station**, **B.M. 325-9**, **Bench Mark**, **Surface Level**, **Arrow denotes flow of water**, **Antiquities (site of)**, **Cutting**, **Embankment**, **Railway crossing Road**, **Level Crossing**, **Road crossing Railway**, **Railway crossing River or Canal**, **Road over single stream**, **Road over River or Canal**, **County Boundary (Geographical)**, **County & Civil Parish Boundary**, **Administrative County & Civil Parish Boundary**, **County Borough Boundary (England)**, **Co. Boro. Bdy.**, **County Burgh Boundary (Scotland)**, **Co. Burgh Bdy.**, **B.P. B.S.** Boundary Post or Stone, **P.C.B.** Police Call Box, **B.R.** Bridle Road, **P.** Pump, **E.P.** Electricity Pylon, **S.P.** Signal Post, **P.B.** Foot Bridge, **SL** Sluice, **F.P.** Foot Path, **Sp.** Spring, **G.P.** Guide Post or Board, **T.C.B.** Telephone Call Box, **M.S.** Mile Stone, **Tr.** Trough, **M.P. M.R.** Mooring Post or Ring, **W.** Well

Ordnance Survey Plan, Additional SIMs and Supply of Unpublished Survey Information 1:2,500 and 1:1,250

Inactive Quarry, Chalk Pit or Clay Pit, **Active Quarry, Chalk Pit or Clay Pit**, **Rock**, **Boulders**, **Cliff**, **Slopes**, **Top**, **Roofed Building**, **Glazed Roof Building**, **Sloping Masonry**, **Archway**, **Non-Coniferous Tree (surveyed)**, **Coniferous Tree (surveyed)**, **Non-Coniferous Trees (not surveyed)**, **Coniferous Trees (not surveyed)**, **Orchard Tree**, **Scrub**, **Bracken**, **Coppice, Osier**, **Reeds**, **Marsh, Saltings**, **Rough Grassland**, **Heath**, **Culvert**, **Direction of water flow**, **Bench Mark**, **Antiquity (site of)**, **Cave Entrance**, **Triangulation Station**, **Electricity Pylon**, **Electricity Transmission Line**, **County Boundary (Geographical)**, **County & Civil Parish Boundary**, **Civil Parish Boundary**, **Admin. County or County Bor. Boundary**, **L.B. Bdy.** London Borough Boundary, **Symbol marking point where boundary mereing changes**, **BH** Beer House, **P** Pillar, Pole or Post, **BP, BS** Boundary Post or Stone, **PO** Post Office, **Cn, C** Capstan, Crane, **PC** Public Convenience, **Chy** Chimney, **PH** Public House, **Cis** Cistern, **Pp** Pump, **Dismtd Rly** Dismantled Railway, **SB, S Br** Signal Box or Bridge, **EI Gen Sta** Electricity Generating Station, **SP, SL** Signal Post or Light, **EI P** Electricity Pole, Pillar, **SB, S Br** Signal Box or Bridge, **EI Sub Sta** Electricity Sub Station, **SP, SL** Signal Post or Light, **FB** Filter Bed, **Spr** Spring, **Fn / D Fn** Fountain / Drinking Ftn., **Tk** Tank or Track, **Gas Gov** Gas Valve Compound, **Tr** Trough, **GVC** Gas Governor, **Wd Pp** Wind Pump, **GP** Guide Post, **Wr Pt, Wr T** Water Point, Water Tap, **MH** Manhole, **Wks** Works (building or area), **MP, MS** Mile Post or Mile Stone, **W** Well

Large-Scale National Grid Data 1:2,500 and 1:1,250

Cliff, **Slopes**, **Top**, **Rock**, **Rock (scattered)**, **Boulders**, **Boulders (scattered)**, **Positioned Boulder**, **Scree**, **Non-Coniferous Tree (surveyed)**, **Coniferous Tree (surveyed)**, **Non-Coniferous Trees (not surveyed)**, **Coniferous Trees (not surveyed)**, **Orchard Tree**, **Scrub**, **Bracken**, **Coppice, Osier**, **Reeds**, **Marsh, Saltings**, **Rough Grassland**, **Heath**, **Culvert**, **Direction of water flow**, **Triangulation Station**, **Antiquity (site of)**, **Electricity Transmission Line**, **Electricity Pylon**, **BM 231.60m** Bench Mark, **Buildings with Building Seed**, **Roofed Building**, **Glazed Roof Building**, **Civil parish/community boundary**, **District boundary**, **County boundary**, **Boundary post/stone**, **Boundary mereing symbol (note: these always appear in opposed pairs or groups of three)**, **Bks** Barracks, **P** Pillar, Pole or Post, **Bty** Battery, **PO** Post Office, **Cemy** Cemetery, **PC** Public Convenience, **Chy** Chimney, **Pp** Pump, **Cis** Cistern, **Ppg Sta** Pumping Station, **Dismtd Rly** Dismantled Railway, **PW** Place of Worship, **EI Gen Sta** Electricity Generating Station, **Sewage Ppg Sta** Sewage Pumping Station, **EI P** Electricity Pole, Pillar, **SB, S Br** Signal Box or Bridge, **EI Sub Sta** Electricity Sub Station, **SP, SL** Signal Post or Light, **FB** Filter Bed, **Spr** Spring, **Fn / D Fn** Fountain / Drinking Ftn., **Tk** Tank or Track, **Gas Gov** Gas Valve Compound, **Tr** Trough, **GVC** Gas Governor, **Wd Pp** Wind Pump, **GP** Guide Post, **Wr Pt, Wr T** Water Point, Water Tap, **MH** Manhole, **Wks** Works (building or area), **MP, MS** Mile Post or Mile Stone, **W** Well

Historical Mapping & Photography included:

Mapping Type	Scale	Date	Pg
Lanarkshire	1:2,500	1859	2
Lanarkshire	1:2,500	1861	3
Lanarkshire	1:2,500	1861	4
Lanarkshire	1:2,500	1895	5
Lanarkshire	1:2,500	1912	6
Lanarkshire	1:2,500	1932	7
Ordnance Survey Plan	1:1,250	1954	8
Additional SIMs	1:1,250	1954 - 1984	9
Ordnance Survey Plan	1:2,500	1955	10
Ordnance Survey Plan	1:1,250	1975	11
Additional SIMs	1:1,250	1988 - 1992	12
Ordnance Survey Plan	1:1,250	1990	13
Large-Scale National Grid Data	1:1,250	1992	14
Large-Scale National Grid Data	1:1,250	1992	15
Historical Aerial Photography	1:2,500	2005	16

Historical Map - Segment A7

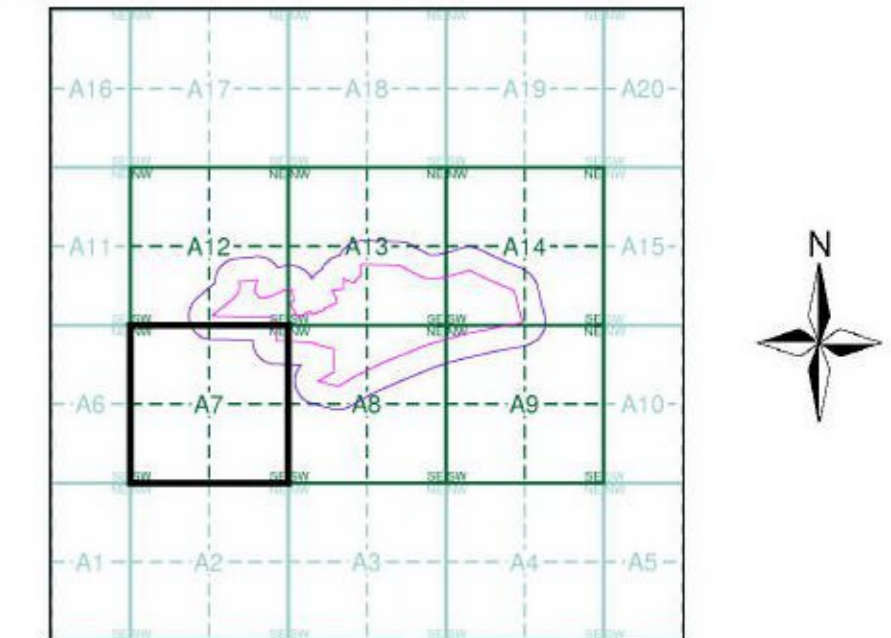

Order Details

Order Number: 232171897_1_1
 Customer Ref: TG276
 National Grid Reference: 264220, 669020
 Slice: A
 Site Area (Ha): 31.49
 Search Buffer (m): 100

Site Details

Robroyston North

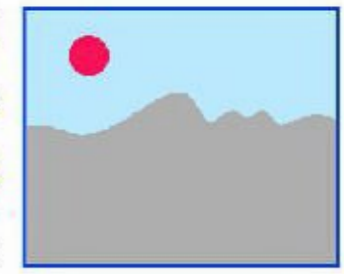

Lanarkshire

Published 1859

Source map scale - 1:2,500

The historical maps shown were reproduced from maps predominantly held at the scale adopted for England, Wales and Scotland in the 1840's. In 1854 the 1:2,500 scale was adopted for mapping urban areas and by 1896 it covered the whole of what were considered to be the cultivated parts of Great Britain. The published date given below is often some years later than the surveyed date. Before 1939, all OS maps were based on the Cassini Projection, with independent surveys of a single county or group of counties, giving rise to significant inaccuracies in outlying areas.

Map Name(s) and Date(s)

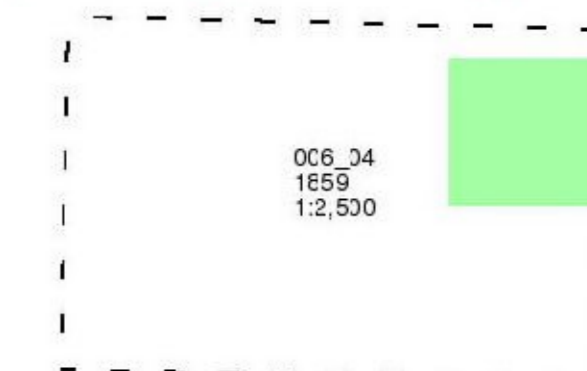

Historical Map - Segment A7

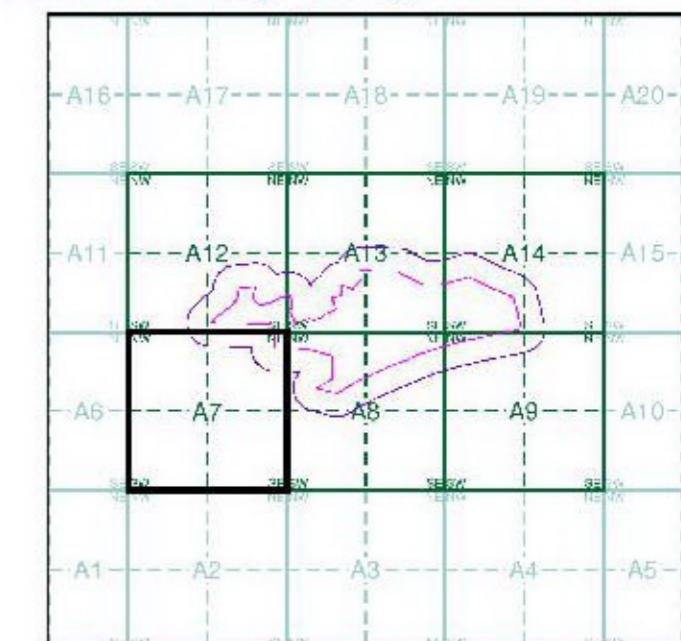

Order Details

Order Number: 232171897_1_1
 Customer Ref: TG276
 National Grid Reference: 264220, 669020
 Slice: A
 Site Area (Ha): 31.49
 Search Buffer (m): 100

Site Details

Robroyston North

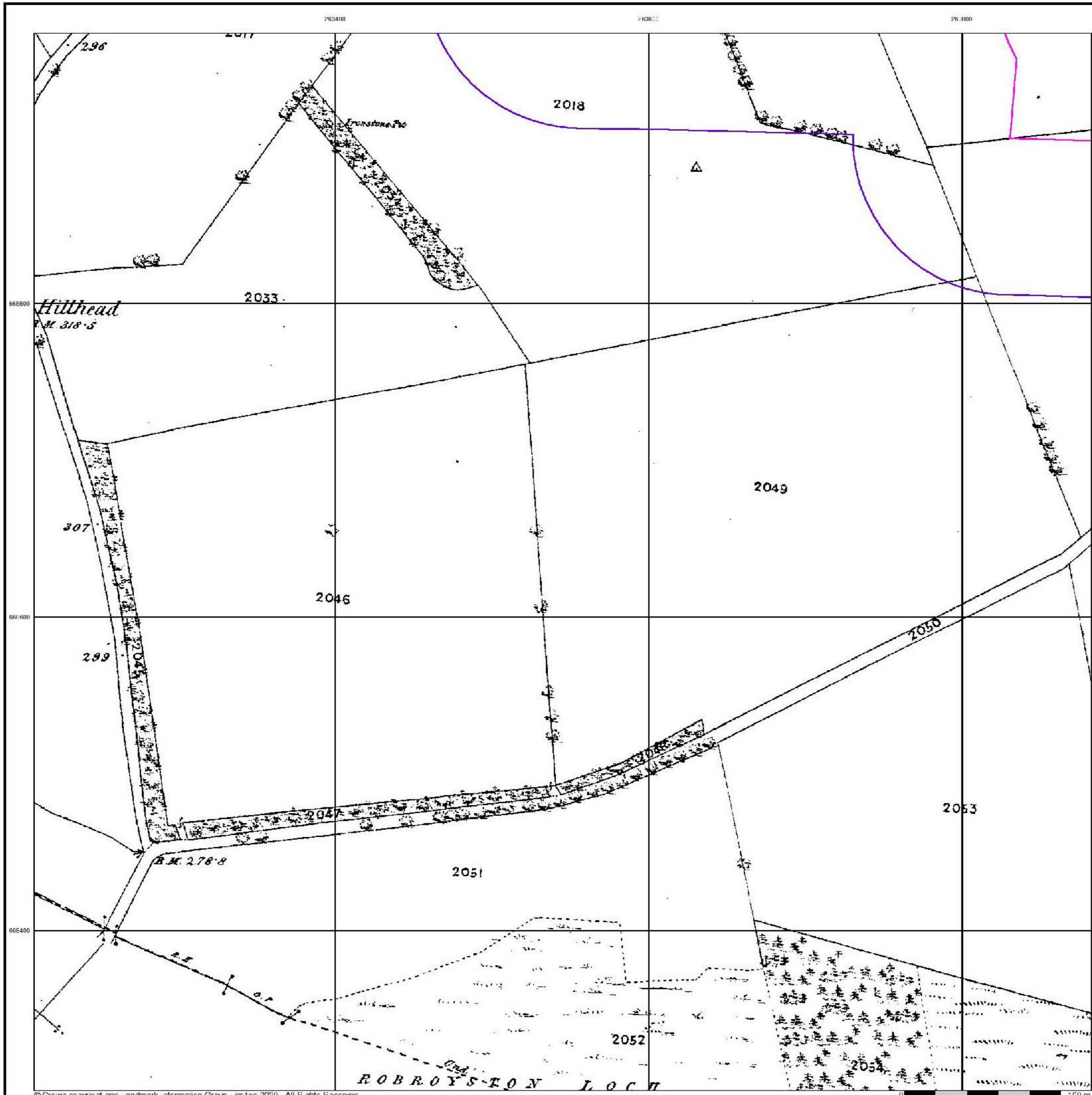

2631400

2636000

2641000

**JOHNSON
POOLE &
BLOOMER**

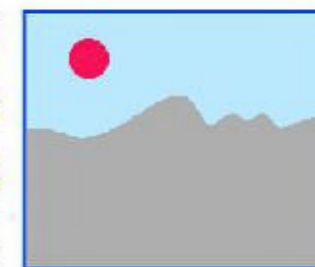

LAND CONSULTANTS

Lanarkshire

Published 1861

Source map scale - 1:2,500

The historical maps shown were reproduced from maps predominantly held at the scale adopted for England, Wales and Scotland in the 1840's. In 1854 the 1:2,500 scale was adopted for mapping urban areas and by 1898 it covered the whole of what were considered to be the cultivated parts of Great Britain. The published date given below is often some years later than the surveyed date. Before 1939, all OS maps were based on the Cassini Projection, with independent surveys of a single county or group of counties, giving rise to significant inaccuracies in outlying areas.

Map Name(s) and Date(s)

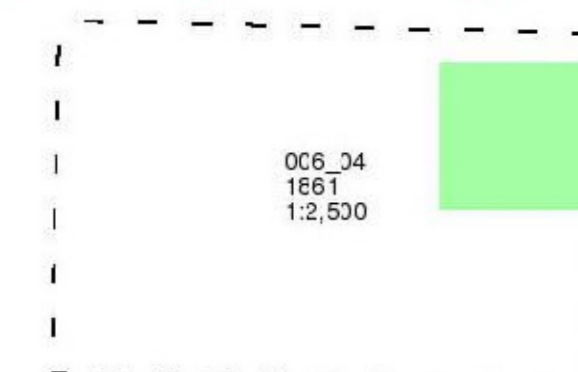

Historical Map - Segment A7

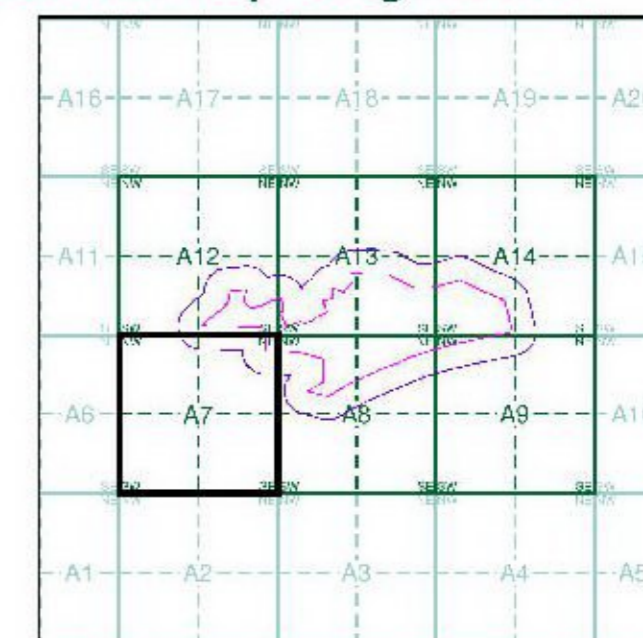

Order Details

Order Number: 232171897_1_1
Customer Ref: TG276
National Grid Reference: 264220, 669020
Slice: A
Site Area (Ha): 31.49
Search Buffer (m): 100

Site Details

Robroyston North

Landmark
INFORMATION GROUP

Tel: 0844 844 9952
Fax: 0844 844 9951
Web: www.envirocheck.co.uk

668600

668600

669200

669200

669800

669800

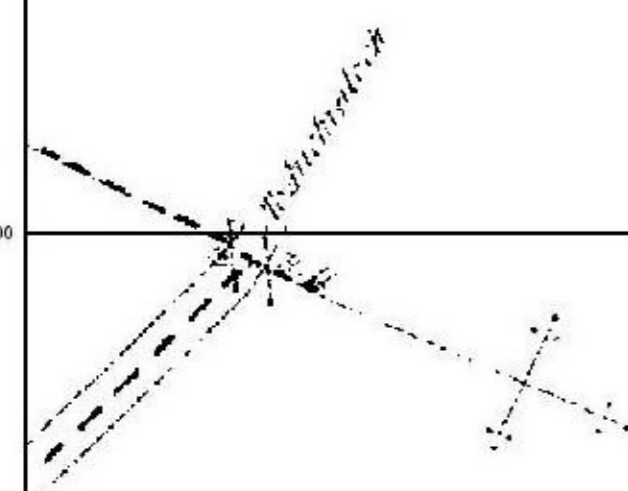

263400

263600

263800

**JOHNSON
POOLE &
BLOOMER**

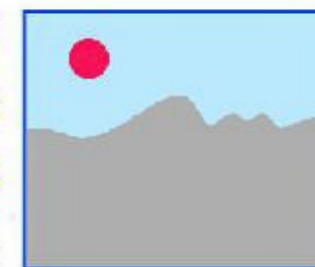

LAND CONSULTANTS

Lanarkshire

Published 1861

Source map scale - 1:2,500

The historical maps shown were reproduced from maps predominantly held at the scale adopted for England, Wales and Scotland in the 1840's. In 1854 the 1:2,500 scale was adopted for mapping urban areas and by 1896 it covered the whole of what were considered to be the cultivated parts of Great Britain. The published date given below is often some years later than the surveyed date. Before 1939, all OS maps were based on the Cassini Projection, with independent surveys of a single county or group of counties, giving rise to significant inaccuracies in outlying areas.

Map Name(s) and Date(s)

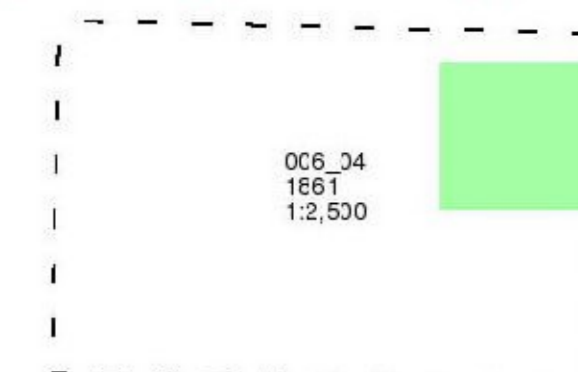

Historical Map - Segment A7

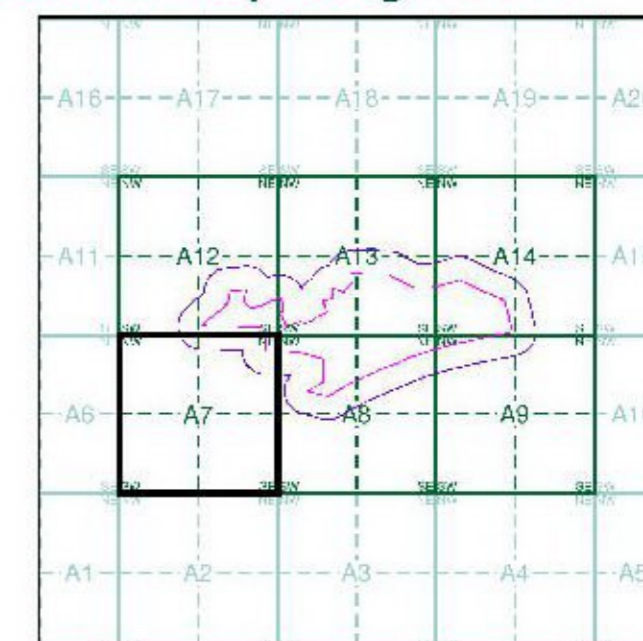

C A D D E R P H

Order Details

Order Number: 232171897_1_1
Customer Ref: TG276
National Grid Reference: 264220, 669020
Slice: A
Site Area (Ha): 31.49
Search Buffer (m): 100

Site Details

Robroyston North

Landmark
INFORMATION GROUP

Tel: 0844 844 9952
Fax: 0844 844 9951
Web: www.envirocheck.co.uk

668400

668600

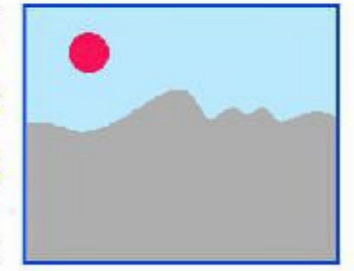

The historical maps shown were reproduced from maps predominantly held at the scale adopted for England, Wales and Scotland in the 1840's. In 1854 the 1:2,500 scale was adopted for mapping urban areas and by 1896 it covered the whole of what were considered to be the cultivated parts of Great Britain. The published date given below is often some years later than the surveyed date. Before 1939, all OS maps were based on the Cassini Projection, with independent surveys of a single county or group of counties, giving rise to significant inaccuracies in outlying areas.

Map Name(s) and Date(s)

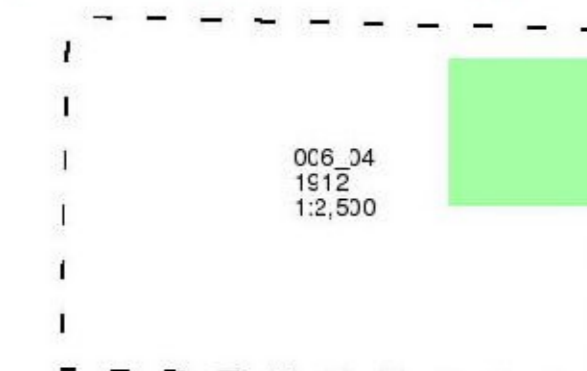

Historical Map - Segment A7

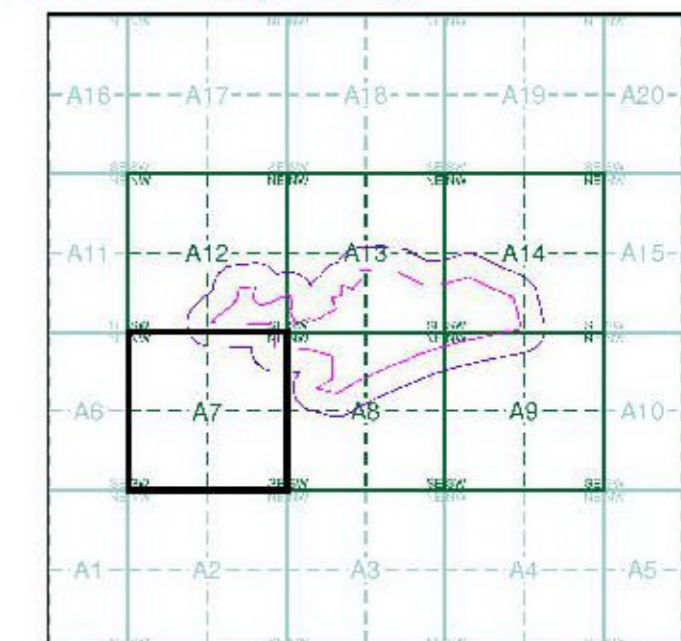

Order Details

Order Number: 232171897_1_1
 Customer Ref: TG276
 National Grid Reference: 264220, 669020
 Slice: A
 Site Area (Ha): 31.49
 Search Buffer (m): 100

Site Details

Robroyston North

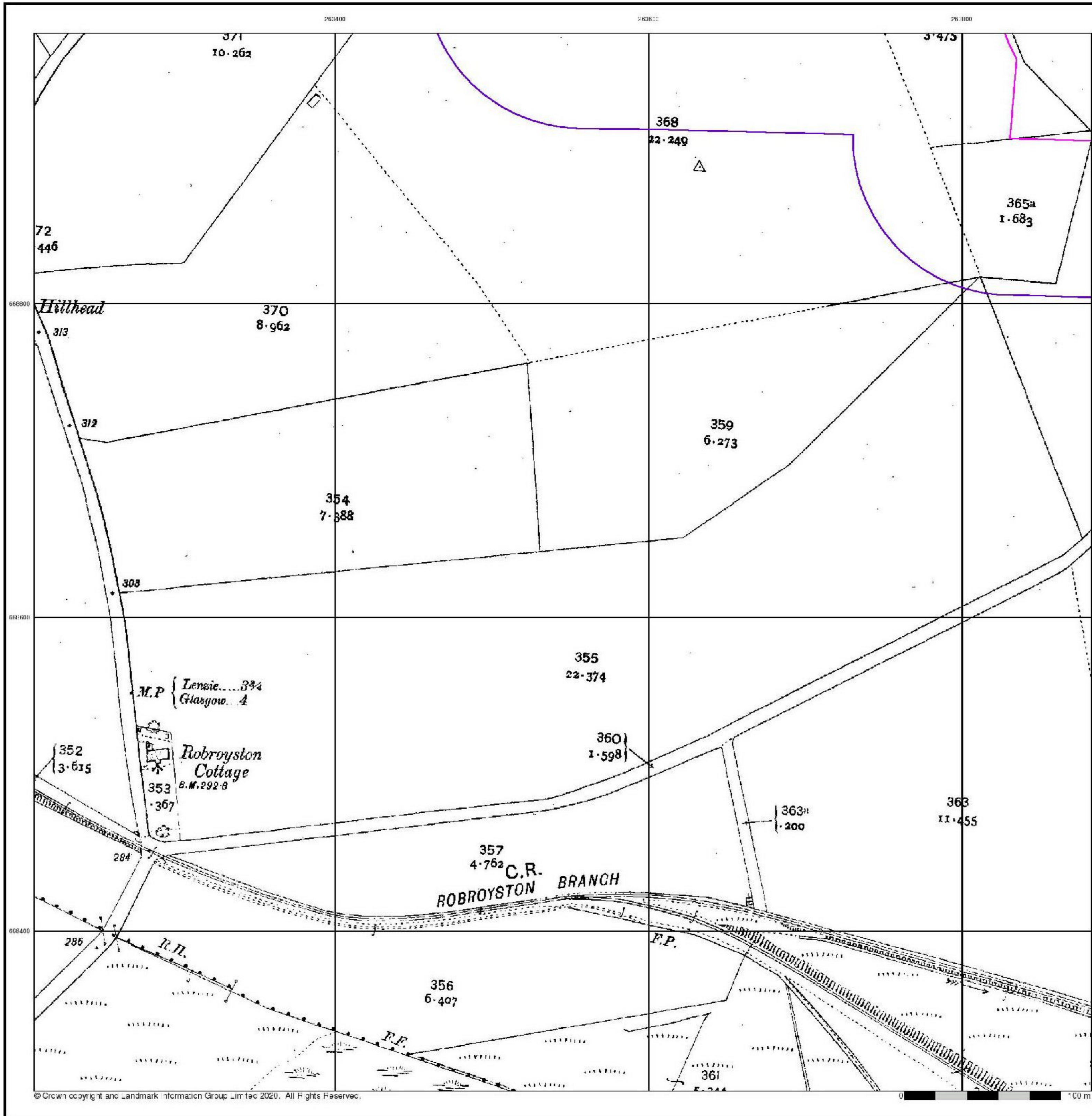

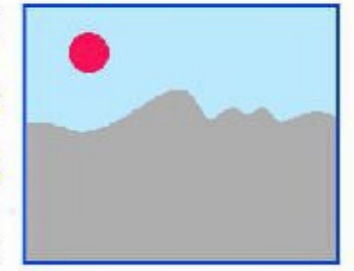

The historical maps shown were reproduced from maps predominantly held at the scale adopted for England, Wales and Scotland in the 1840's. In 1854 the 1:2,500 scale was adopted for mapping urban areas and by 1896 it covered the whole of what were considered to be the cultivated parts of Great Britain. The published date given below is often some years later than the surveyed date. Before 1939, all OS maps were based on the Cassini Projection, with independent surveys of a single county or group of counties, giving rise to significant inaccuracies in outlying areas.

Map Name(s) and Date(s)

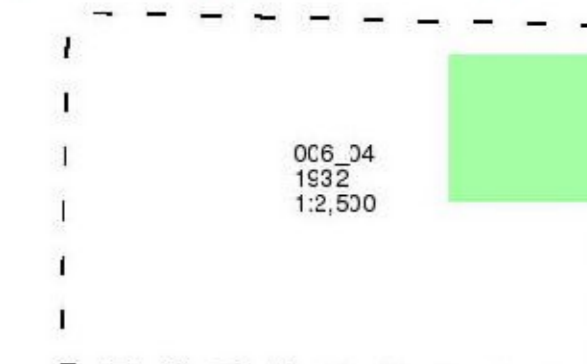

Historical Map - Segment A7

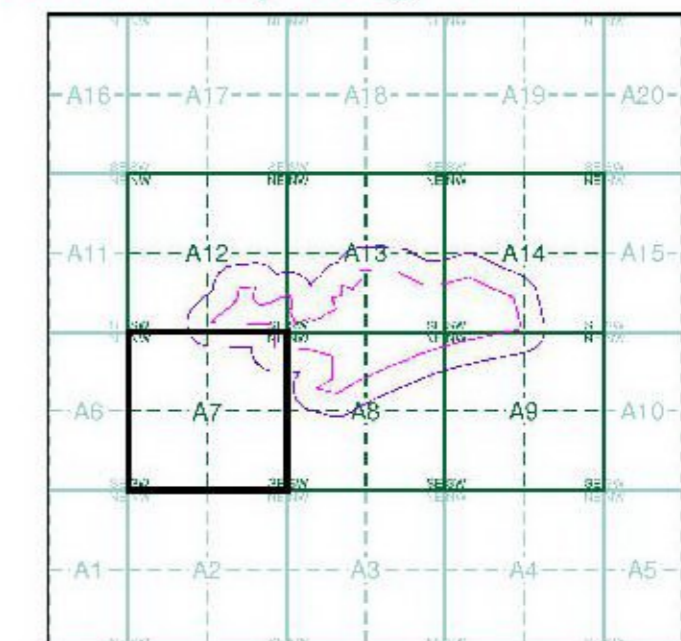

Order Details

Order Number: 232171897_1_1
 Customer Ref: TG276
 National Grid Reference: 264220, 669020
 Slice: A
 Site Area (Ha): 31.49
 Search Buffer (m): 100

Site Details

Robroyston North

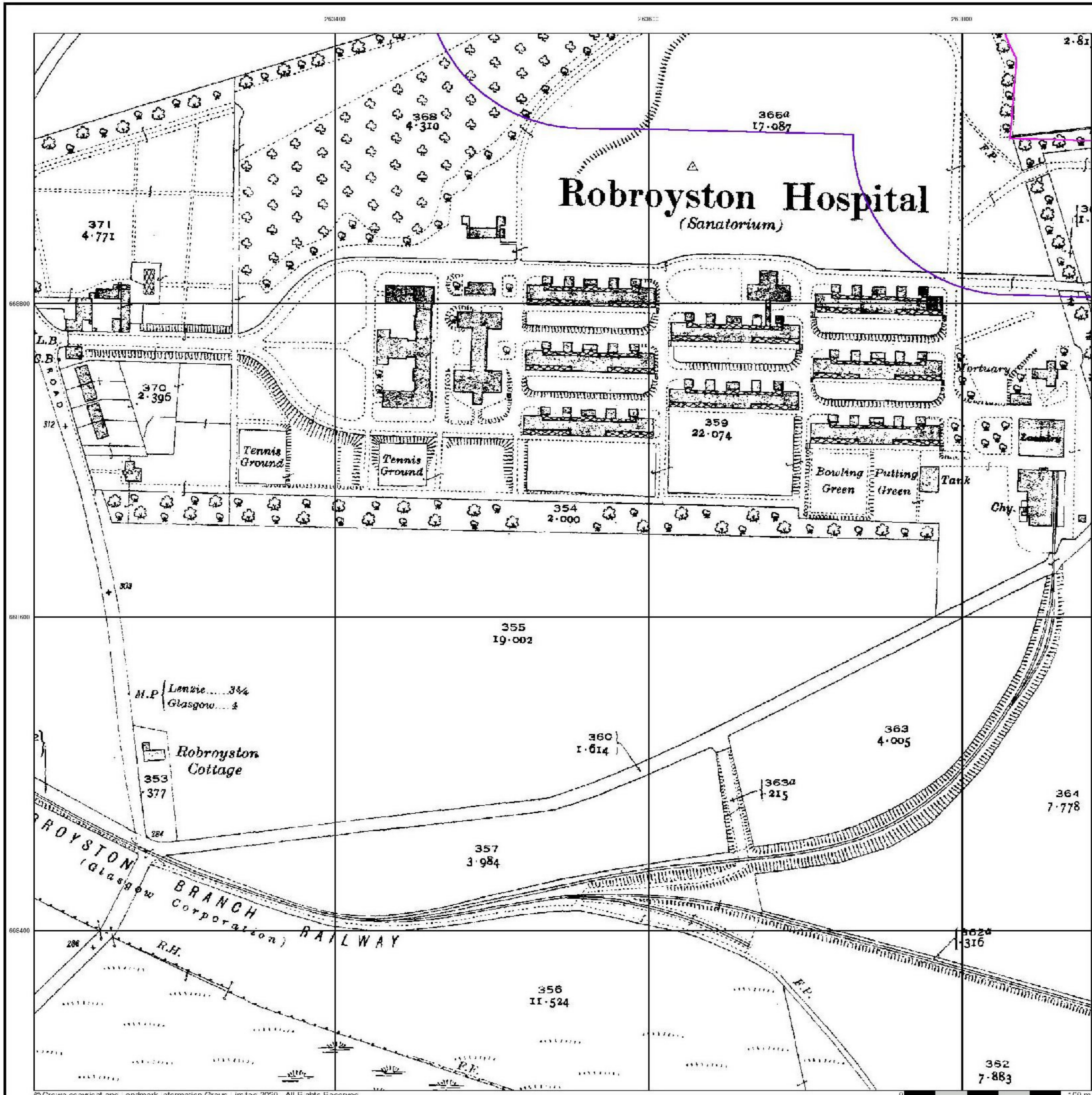

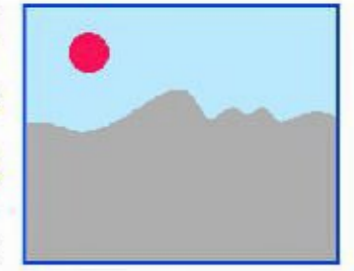

Ordnance Survey Plan

Published 1954

Source map scale - 1:1,250

The historical maps shown were reproduced from maps predominantly held at the scale adopted for England, Wales and Scotland in the 1840's. In 1854 the 1:2,500 scale was adopted for mapping urban areas and by 1896 it covered the whole of what were considered to be the cultivated parts of Great Britain. The published date given below is often some years later than the surveyed date. Before 1938, all OS maps were based on the Cassini Projection, with independent surveys of a single county or group of counties, giving rise to significant inaccuracies in outlying areas.

Map Name(s) and Date(s)

NS6388NW 1954 1:1,250	NS6388NE 1954 1:1,250
NS6388SW 1954 1:1,250	NS6388SE 1954 1:1,250

Historical Map - Segment A7

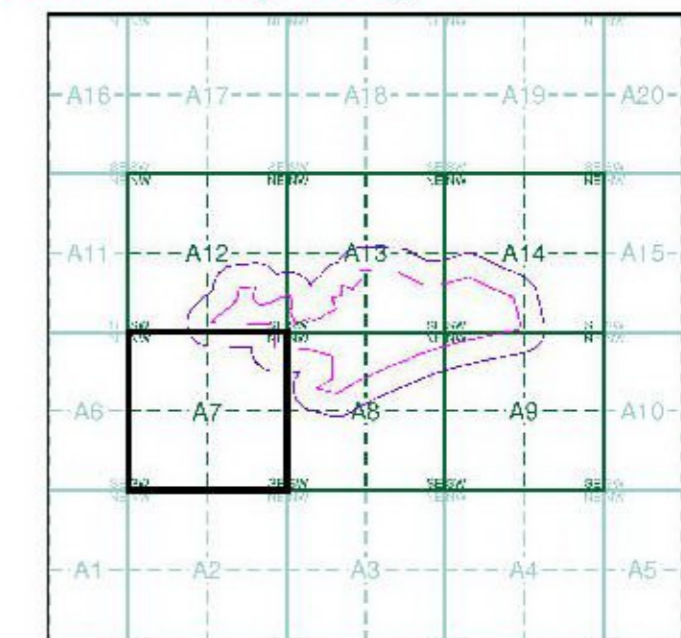

Order Details

Order Number: 232171897_1_1
 Customer Ref: TG276
 National Grid Reference: 264220, 669020
 Slice: A
 Site Area (Ha): 31.49
 Search Buffer (m): 100

Site Details

Robroyston North

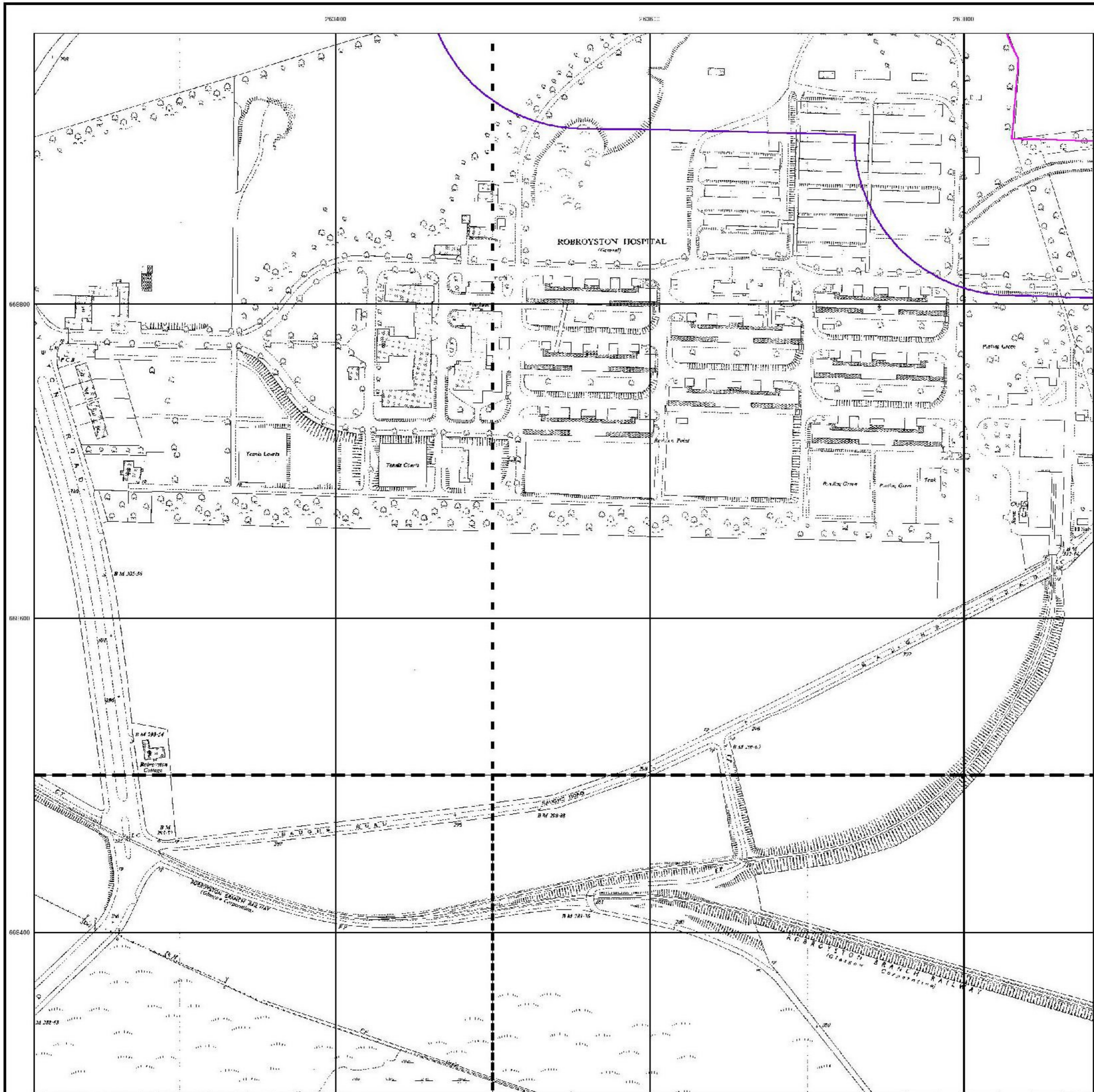

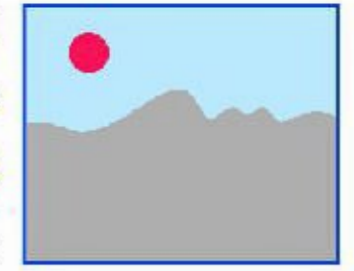

Additional SIMs

Published 1954 - 1984

Source map scale - 1:1,250

The SIM cards (Ordnance Survey's 'Survey of Information on Microfilm') are further, minor editions of mapping which were produced and published in between the main editions as an area was updated. They date from 1947 to 1994, and contain detailed information on buildings, roads and land-use. These maps were produced at both 1:2,500 and 1:1,250 scales.

Map Name(s) and Date(s)

NS6388NW 1984 1:1,250	NS6388NE 1984 1:1,250
NS6388SW 1954 1:1,250	

Historical Map - Segment A7

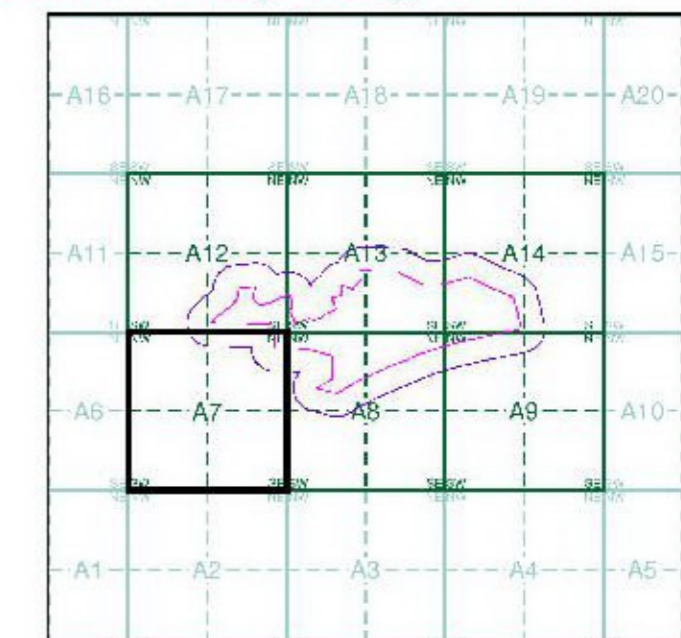

Order Details

Order Number: 232171897_1_1
 Customer Ref: TG276
 National Grid Reference: 264220, 669020
 Slice: A
 Site Area (Ha): 31.49
 Search Buffer (m): 100

Site Details

Robroyston North

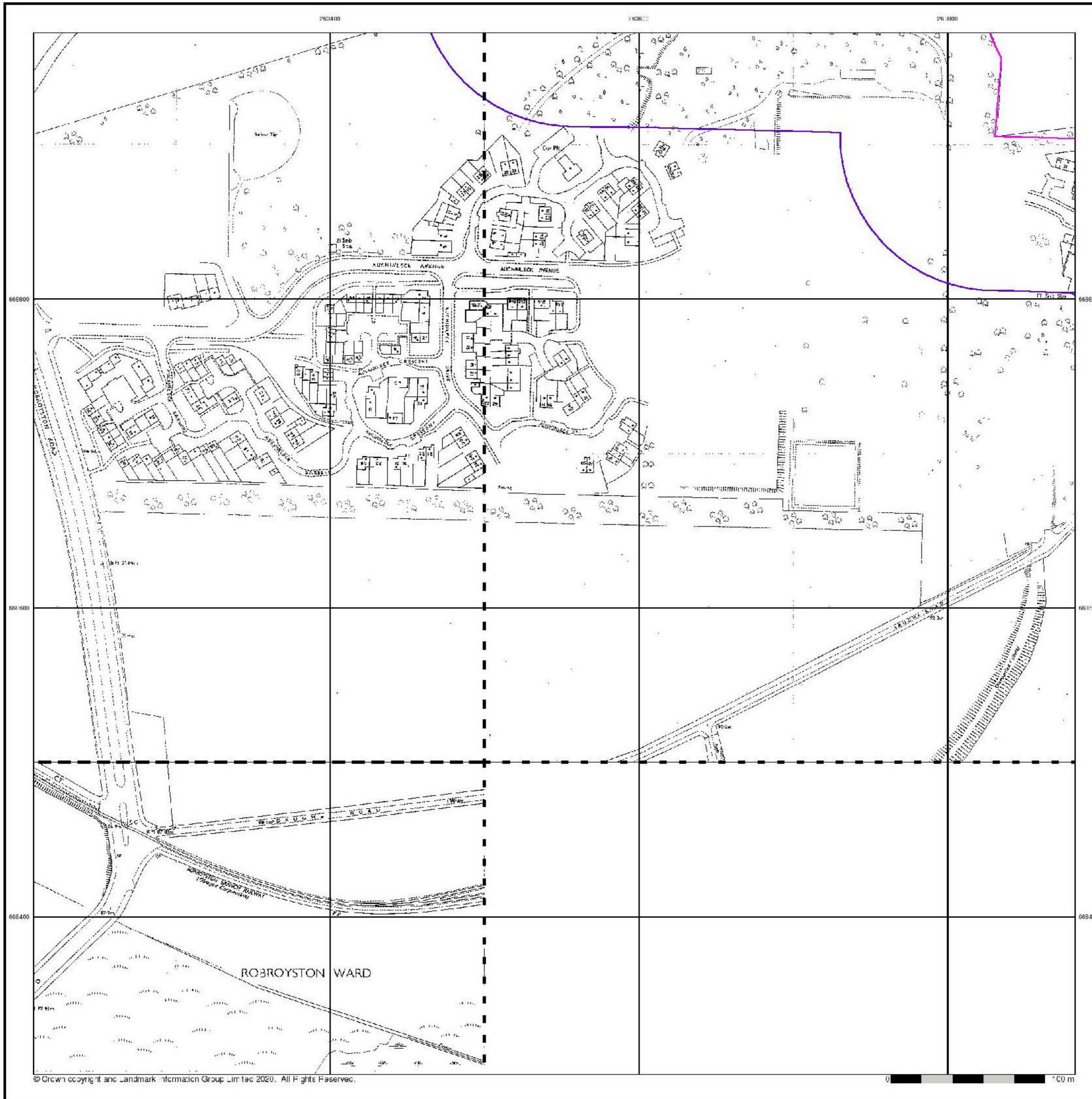

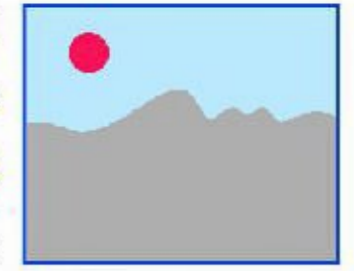

Ordnance Survey Plan

Published 1955

Source map scale - 1:2,500

The historical maps shown were reproduced from maps predominantly held at the scale adopted for England, Wales and Scotland in the 1840's. In 1854 the 1:2,500 scale was adopted for mapping urban areas and by 1896 it covered the whole of what were considered to be the cultivated parts of Great Britain. The published date given below is often some years later than the surveyed date. Before 1938, all OS maps were based on the Cassini Projection, with independent surveys of a single county or group of counties, giving rise to significant inaccuracies in outlying areas.

Map Name(s) and Date(s)



Historical Map - Segment A7

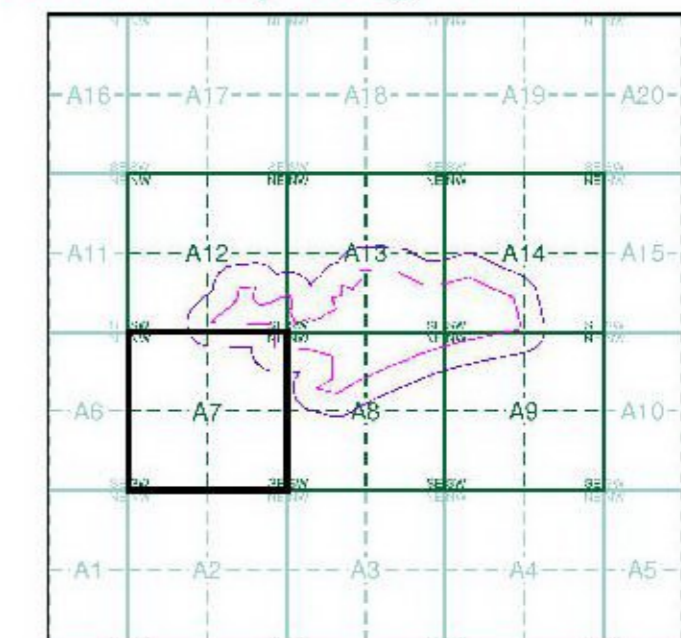

Order Details

Order Number: 232171897_1_1
 Customer Ref: TG276
 National Grid Reference: 264220, 669020
 Slice: A
 Site Area (Ha): 31.49
 Search Buffer (m): 100

Site Details

Robroyston North

