

EXISTING LAYOUT of GROUND FLOOR FLAT No. 77

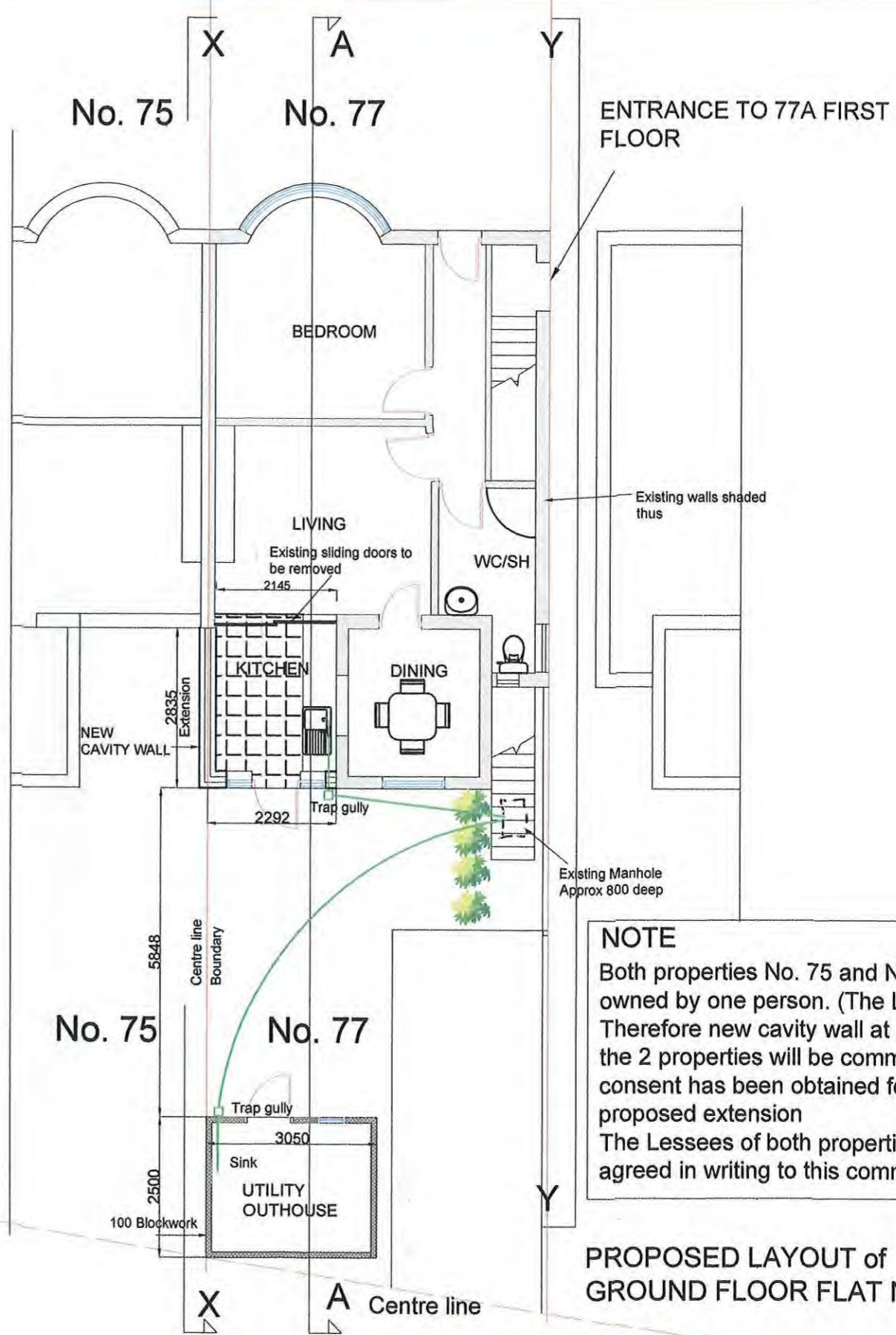

NOTE
 Both properties No. 75 and No. 77 are owned by one person. (The Lessor)
 Therefore new cavity wall at rear separating the 2 properties will be common. Lessor's consent has been obtained for the proposed extension
 The Lessees of both properties have agreed in writing to this common wall

PROPOSED LAYOUT of GROUND FLOOR FLAT No. 77

		Date	05.05.2021	Scale	1:100
PROPOSED EXTENSIONS TO No. 77, SOUTHVIEW AVENUE NEASDEN NW10 1RJ			EXISTING AND PROPOSED GROUND FLOOR PLANS		
			DRAWING No. 77/100		