



Proposed North Elevation 1 Planning  
1 : 50



Proposed North Elevation 2 Planning  
1 : 50



Proposed East Elevation Planning  
1 : 50

1. If in doubt, ask the Project Lead.
2. Do not scale this drawing.
3. All dimensions are in millimetres unless stated otherwise.
4. This drawing is to be read in conjunction with all other relevant drawings and specifications.
5. All Proprietary items to be installed in strict compliance with manufacturers instructions and recommendations.
6. Trees shown indicatively.

**Materials Key:**

1. **Horizontal Cedar Cladding**  
Horizontally installed fibre cement planks with timber effect integral pattern and colour matched aluminium profiles to junctions and flashings.  
Size: Regular continuous plank lengths  
Finish: Cedar Click Planks  
Colour: Light Grey (RAL tbc)
2. **Vertical Cedar Cladding**  
Vertically installed fibre cement planks with timber effect integral pattern and colour matched aluminium profiles to junctions and flashings.  
Size: Regular continuous plank lengths  
Finish: Cedar Click Planks  
Colour: Dark Grey / Black (RAL tbc)
3. **Render**  
Smooth K-Render  
Finish: Fine grade finish  
Colour: Off-White (RAL tbc)
4. **Roof to be stripped and replaced**  
Concrete interlocking roof tiles  
Colour: Mid to Dark Grey (RAL tbc)
5. **Juliet Balconies**  
Wall mounted Royal Chrome anodised balustrade and fixings with toughened clear polished glass
6. **External Balconies**  
Floor mounted Royal Chrome anodised balustrade and fixings with toughened clear polished glass
7. **Aluminium Feature Panels**  
Finish: Class 1 polyester powder coated  
Colour: Varies per location  
Proposed: Red, Orange and Blue (RAL tbc)
8. **Aluminium Fascia / Canopy**  
Finish: Class 1 polyester powder coated  
Colour: Dark Grey (RAL tbc)
9. **Windows all to be replaced**  
Finish: UPVC double glazed  
Colour: Varies to achieve contrast with cladding  
Dark Grey (RAL tbc) within Materials 1. & 3.  
Light Grey (RAL tbc) within Material 2.
10. **Doors all to be replaced**  
Finish: UPVC double glazed. Sliding doors where Juliet Balconies are provided.  
Colour: Varies to achieve contrast with cladding  
Dark Grey (RAL tbc) within Materials 1. & 3.  
Light Grey (RAL tbc) within Material 2.
11. **Curtain Wall System**  
Extruded aluminium alloy with vertical and horizontal pressure plate and cover caps.  
Panels: Double glazed or spandrel panel.  
Spandrel panel to consist of external pane to match double glazed panel with ceramic inner pane, colour to match frame.  
Finish: Polyester powder coated satin finish  
Colour: Dark Grey (RAL tbc)
12. **Rainwater Goods to be replaced**  
Extruded Aluminium square profile flush joint pipework, with plain rectangular hoppers and box gutters.  
Finish: Class 1 polyester powder coated  
Colour: Dark Grey (RAL tbc)
13. **Damp Proof Painted Brickwork**  
Existing brickwork to be coated in damp proof paint  
Finish: Matt  
Colour: Black
14. **Metal Signage**  
To be confirmed.
15. **Entrance Canopy**  
Cantilevered steel framework and concealed gutter with clear canopy roof  
Finish: Polyester powder coated  
Colour: Dark Grey (RAL tbc)
16. **Pitched Roof Sun Tunnels**  
Finish: Polyurethane black framed external profile with a flexible reflective fibreglass tunnel to provide natural daylight into the building.
17. **Rooflight**  
Fixed (non opening) flat glass rooflight with external aluminium finish
18. **Louvre**  
Acoustic and insulated metal louvre.  
Colour: To match external cladding
19. **Photovoltaic Panel**  
Shown indicatively.  
Size, number and position to be confirmed

Rev	Amendments	Rev'd By	Date
P03	Updated following proposed demolition of the Former Garden's House	DF	16.04.21
P02	RIBA STAGE 003 ISSUED FOR COMMENT AND REVIEW	DF	15.01.21
P01	Issued for Planning	DF	18.12.20



Project  
**Larwood House**  
Refurbishment & Remodelling

Title  
**Proposed Elevations - North & East**

Project	Originator	Volume	Level	Type	Role	Number
190340	WDC	ZZ	XX	DR	A	04013

Internal Project Reference  
**190340**

Suitability | Suitable for  
**S3 - Suitable for Review & Comment**

Scale	Created	Revision
As indicated @ A0	09.12.20	P03

Project Lead	Drawn	KN	Checked	DF
SE				

Reviewed	SD	Approved	SE

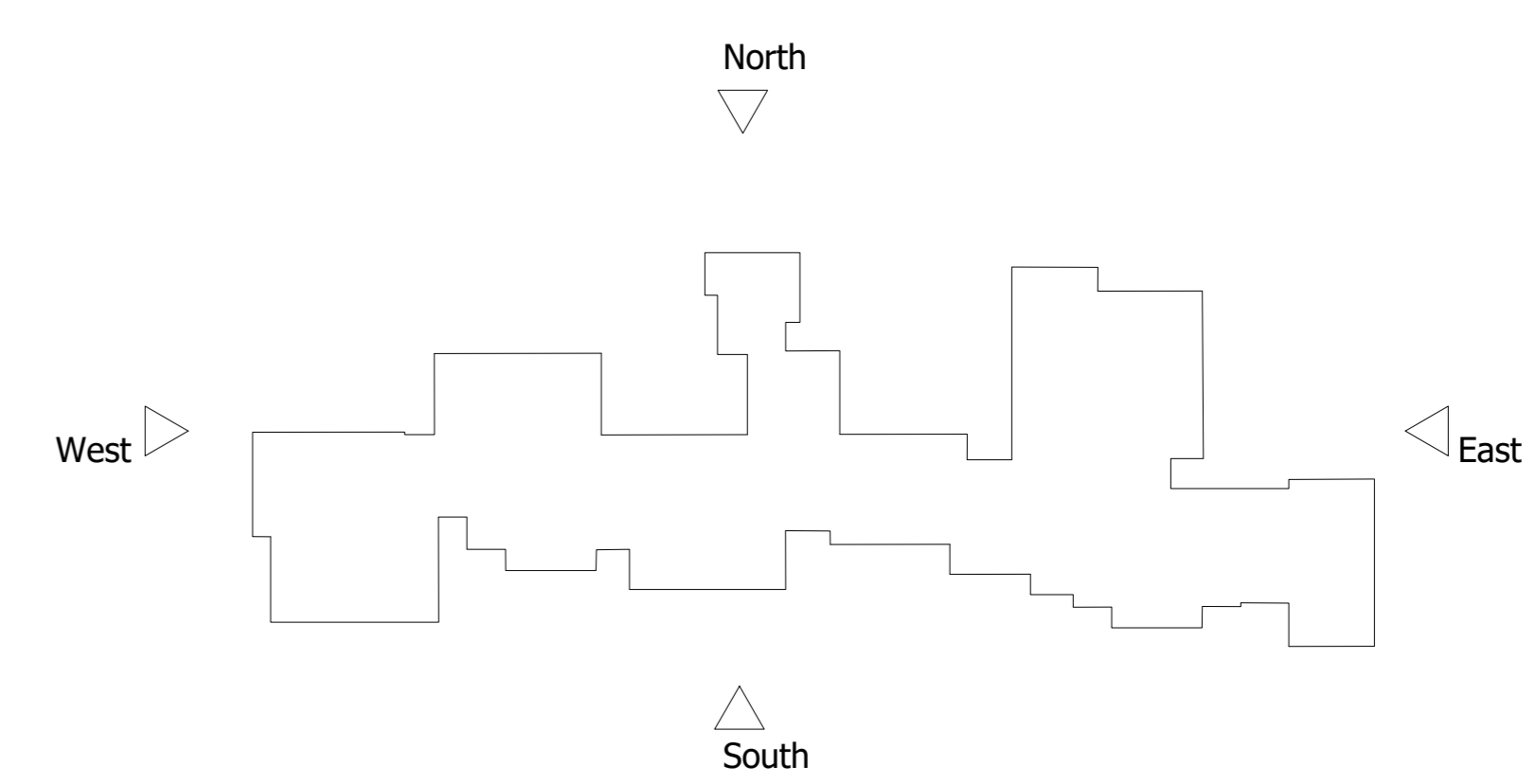

Elevation Key  
1 : 500

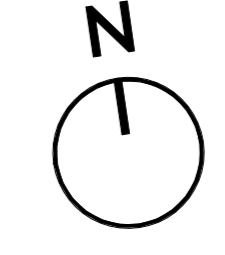

© 2019 WALDECK

1. These drawings are copyright and the property of Waldeck Associates Ltd. Copying of the designs, drawings or intellectual property in full or in part is not permitted without the written consent of a Director of Waldeck Associates Ltd. In the event of a default by the Employer of its obligations due to Waldeck Associates Ltd neither it or its designers or beneficiaries are permitted to use or copy this information until such time as the Employer has remedied to default and the Consultant gives written consent to reinstatement of its permission or licence to use its materials.

2. The initial feasibility pre-contract design specifications, cost plans, bill of quantities, feasibility studies and all other documents or media whether electronic or hard copy are indicative only and could be subject to changes in statute or other rules and regulations and changes in the Employer's requirements and will be subject to design development until such time as Waldeck's Services are engaged under a formal written agreement that pays for an appropriate fee at commercial rates. Use of these documents or media shall be entirely at the risk of the person using it. No reliance on these documents shall be permitted without the written and signed by a Director of Waldeck as recorded at Companies House.

3. "Waldeck" is a Trading Style of Waldeck Associates Ltd registered in England and Wales Company No 3459319.