

RISK ASSESSMENT : SIGNIFICANT RISKS THAT CANNOT BE DESIGNED OUT	LEVEL OF RISK (V/M)	SUGGESTED ACTION
DEEP EXCAVATIONS ASSOCIATED WITH NEW DRAINAGE WORKS.	HIGH	ENSURE ALL EXCAVATIONS HAVE ADEQUATE TRENCH SUPPORTS.
HANDLING LARGE DIAMETER MANHOLE RINGS	HIGH	USE CORRECT LIFTING EQUIPMENT AND ENSURE OPERATIVES WEAR APPROPRIATE PROTECTIVE CLOTHING AND WEAR.
CONTACT WITH SEWAGE.	MED	OPERATIVES TO USE CORRECT BREATHING EQUIPMENT.
NOISE.	MED	OPERATIVES TO USE CORRECT EAR PROTECTION.
DRAINAGE EXCAVATIONS ADJACENT EXISTING BOUNDARY STRUCTURES AND STEEPLY SLOPING BANKS	HIGH	ENSURE CORRECT SUPPORTS ARE PROVIDED TO TRENCHES AND BARRIERS WHERE REQUIRED.
EXCAVATION IN PUBLIC HIGHWAY.	HIGH	ENSURE CORRECT USE OF TRENCH SUPPORTS IN EXCAVATION AND SCREEN BARRIERS TO PROTECT MEMBERS OF THE PUBLIC.
MAINTAIN ACCESS TO ADJACENT PROPERTIES AND OCCUPIERS.	HIGH	ENSURE WORKS ARE PROTECTED WITH BARRIERS AND SIGNS TO GUIDE THE PUBLIC AWAY FROM THE WORKS.
DRAINAGE EXCAVATIONS NEAR TO EXISTING MAINS SERVICES.	HIGH	ENSURE ALL EXCAVATIONS WITHIN EXISTENT AREAS ARE CARRIED OUT USING CORRECT MECHANICAL EQUIPMENT. SIGNAGES, TRENCH SUPPORTS AND BARRIERS TO BE DESIGNED TO PROTECT THE PUBLIC.
EARTHWORKS ASSOCIATED WITH PROPOSED/EXISTING WATER FEATURES	HIGH	ENSURE ALL EXCAVATIONS HAVE ADEQUATE TRENCH SUPPORTS AND APPROPRIATE WARNING SIGNS ARE ERECTED.

IT IS ASSUMED THAT WORKS ASSOCIATED WITH THIS DESIGN WILL BE UNDERTAKEN BY A PERSON OR PERSONS WHO ARE COMPETENT AND HAVE THE REQUIRED LEVEL OF EXPERIENCE AND EXPERTISE.

Section along Road 13 centreline

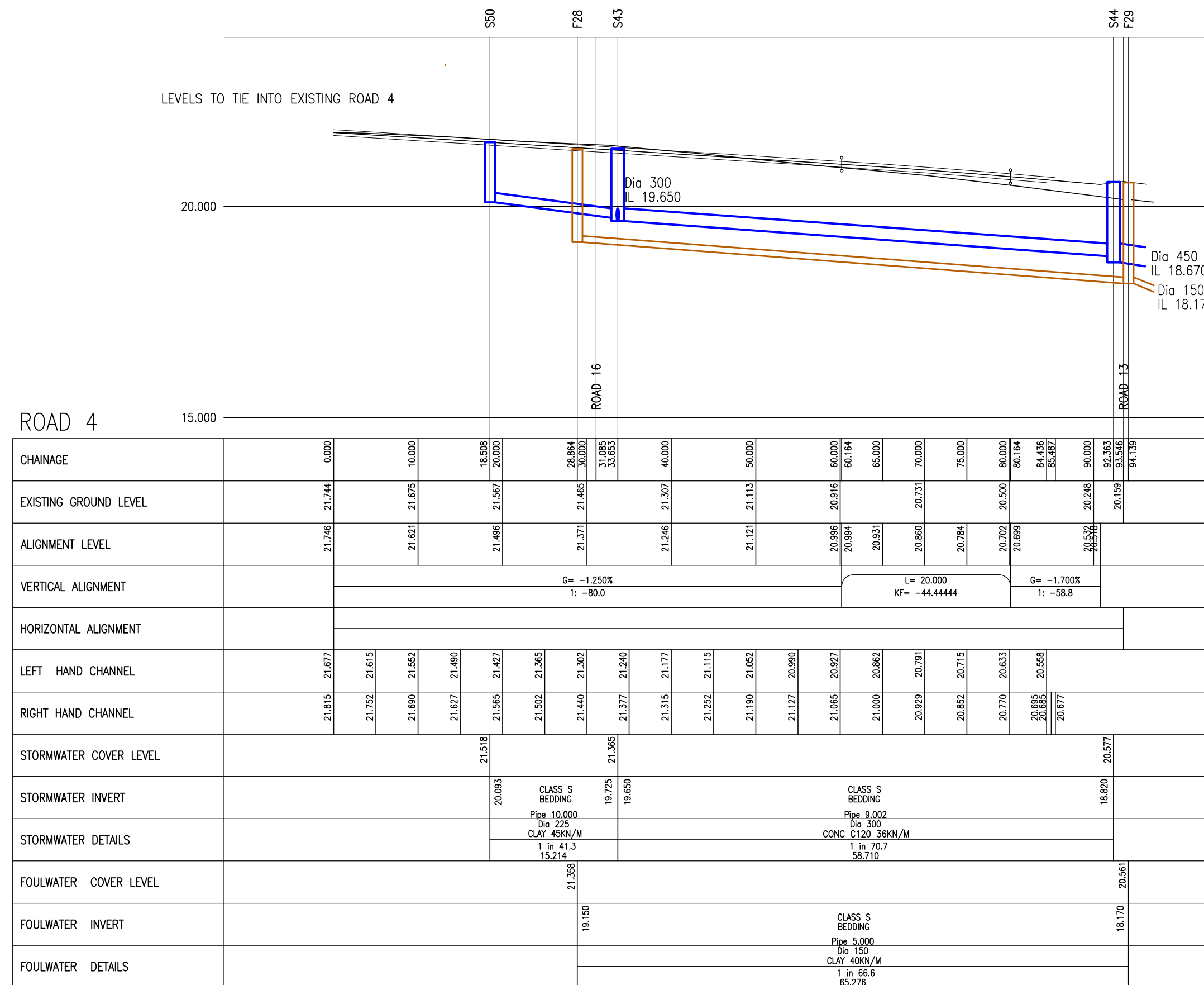

Section along Road 4 centreline

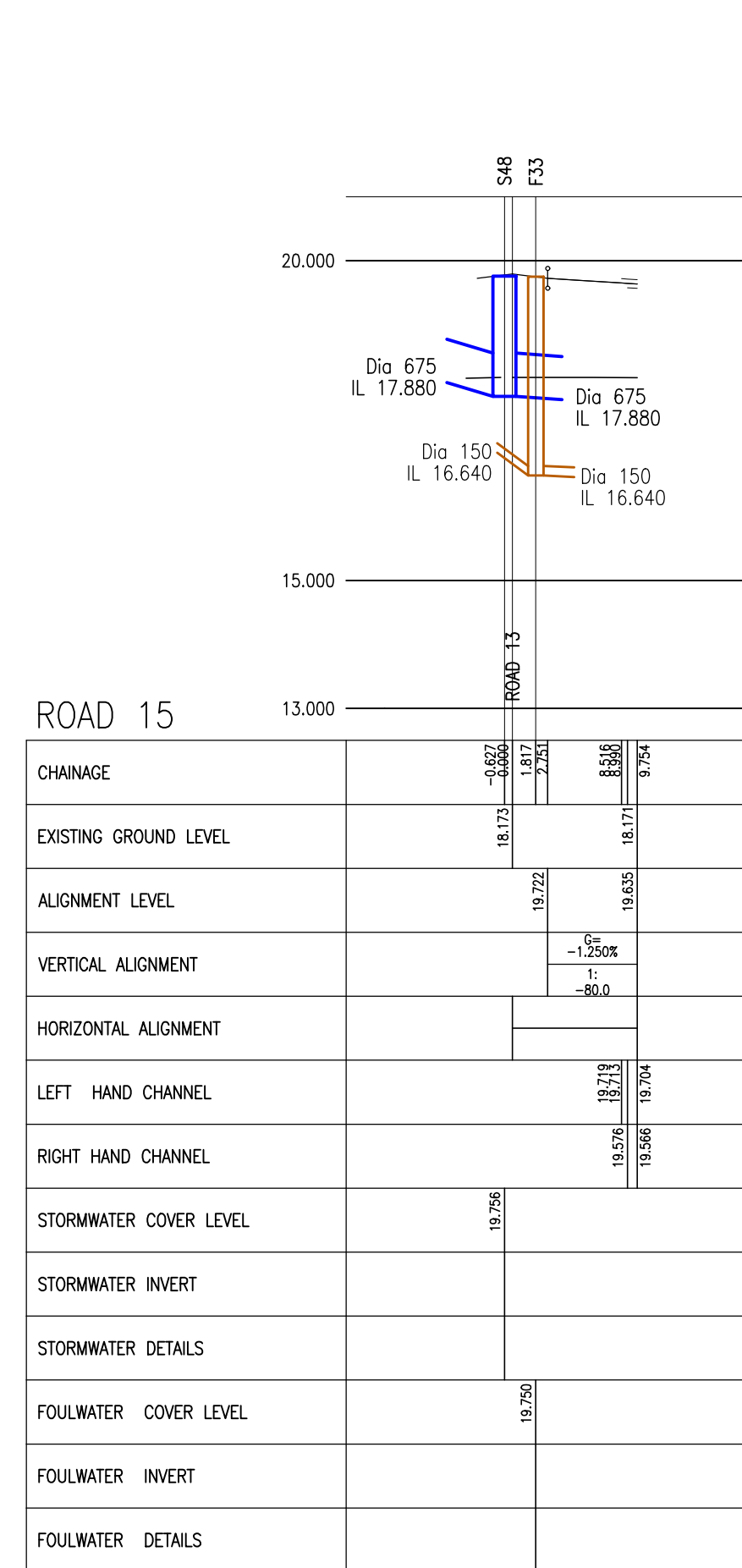

Section along Road 15 centreline

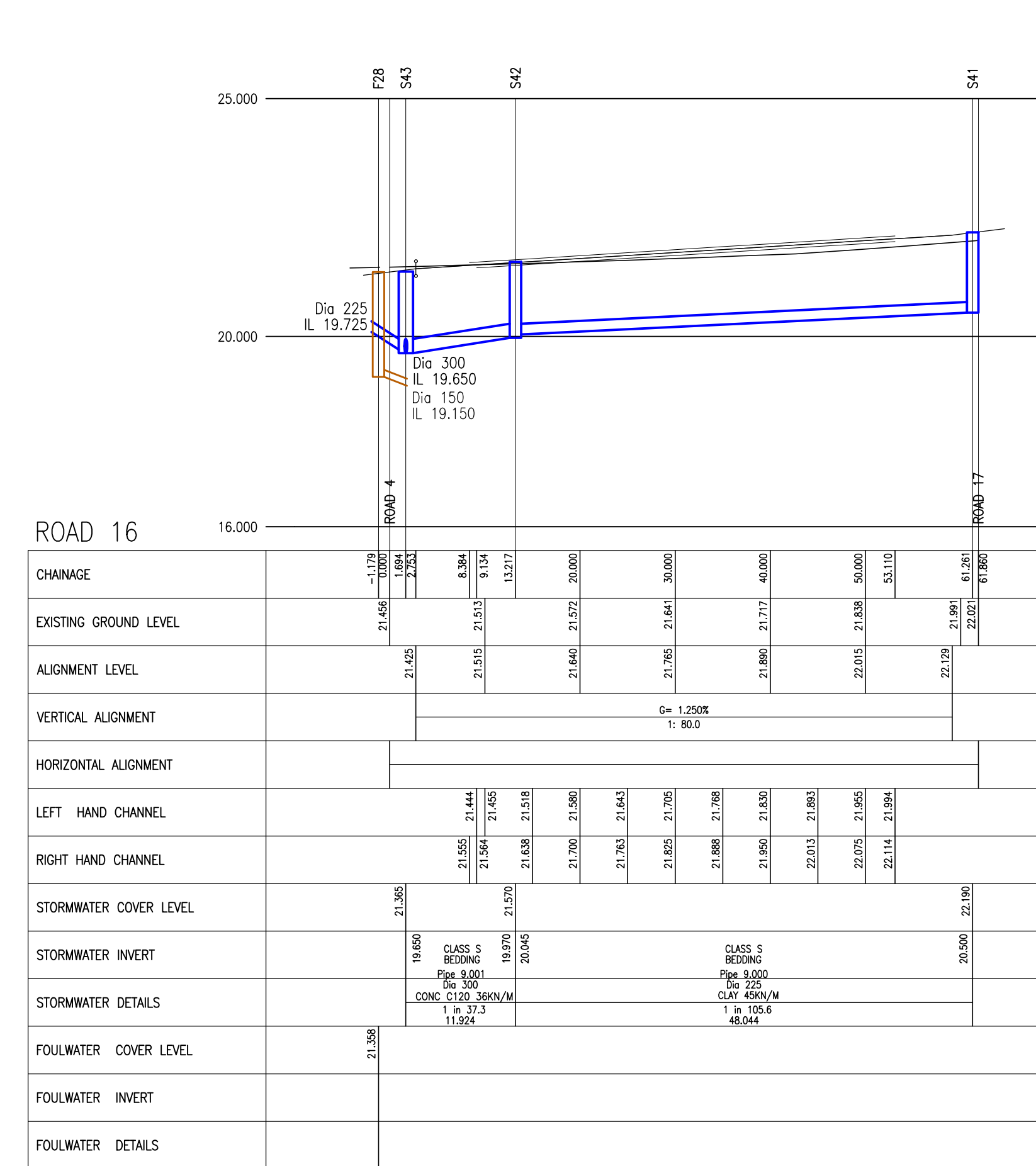

Section along Road 16 centreline

Revision.

**James Eaton Design Ltd**  
 Design Consultant 1992-2021  
 Development • Highways • Drainage  
 Stoneycroft, Brackenhill, Ackworth,  
 Pontefract, West Yorkshire WF7 7BG.  
 Tel. 01977 618626 Fax 01977 625114  
 e-mail james@jameseatondesign.co.uk

Client:  
**Harron Homes**  
 Site: **Retford**  
 Phase 3  
 Title:  
**Long Sections :**  
 Roads 4, 13, & 15-16  
 Date: Jan 21 Scales: 1/500, 1/100 Drawing No.: 21M/1006/1014