

The proposed new garden room is not visible from the north, east (principal) or south elevations of Flemish House.

PARTIAL GROUND FLOOR PLAN
1:100

- MATERIALS NOTES**
- ① Set of glazed folding doors - dark grey powder-coated aluminium, triple-glazed - set into new aperture on west wall of house - existing large & small windows removed.
 - ② Existing window removed and aperture deepened to create new opening into extension.
 - ③ Single-ply membrane flat roofing: flat profiled rooflights - dark grey powder-coated aluminium, triple glazed.
 - ④ Glazed sliding doors: dark grey powder-coated aluminium, high-spec and triple-glazed.
 - ⑤ Wraparound wide step, materials to match existing courtyard, with new brick detail to edges.
 - ⑥ Existing window relocated into garage wall.
 - ⑦ Existing door opening infilled.

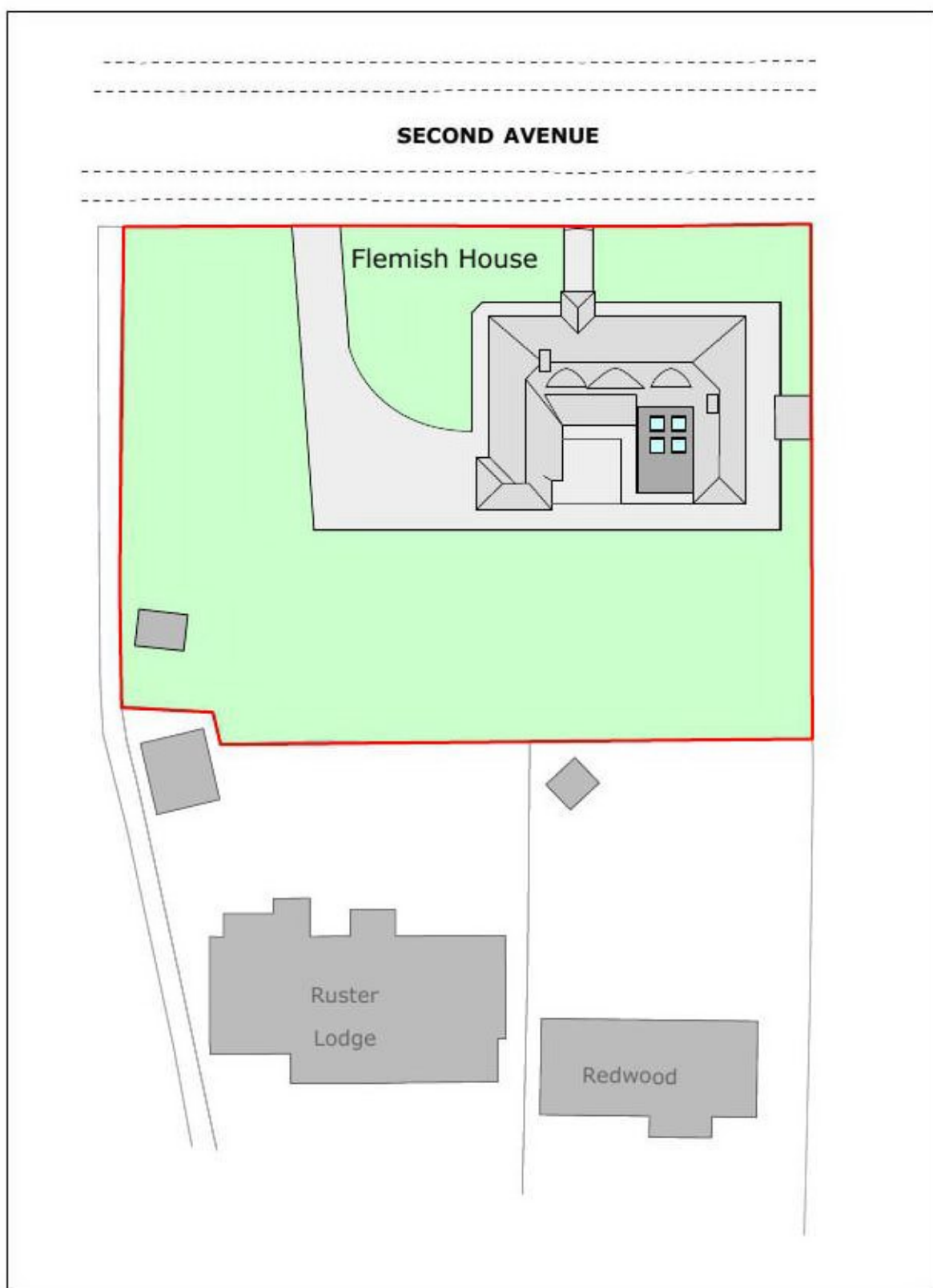

PROPOSED SITE PLAN
1:500



- GENERAL NOTES**
1. Dimensions are in millimetres (unless stated otherwise) and are to block or stud faces.
 2. Drawings are not to be scaled, use figured dimensions only.
 3. Notify the Architect of any discrepancies within the drawing and contact for clarification before proceeding.
 4. All proprietary items to be fitted strictly in accordance with manufacturers instructions.
 5. All works to be carried out in accordance with latest related British Standards and relevant codes of practice.

Rev	Date	Revision Description	Scale	AS SHOWN @ A2
		Project Title		
		PROPOSED GARDEN ROOM, FLEMISH HOUSE, FRINTON-ON-SEA	Project Ref.	3517
			Drawing Ref.	PA-10
		Drawing Title	Date Drawn	MAY 2021
		PROPOSED PLANS & ELEVATIONS (DETAIL)	Drawn By	CR
			Checked By	IJ

DUNCAN CLARK & BECKETT LTD
12A William's Walk, Colchester, Essex, CO1 1TS

RIBA Chartered Practice