

B 778 - LYLESTONE ROAD

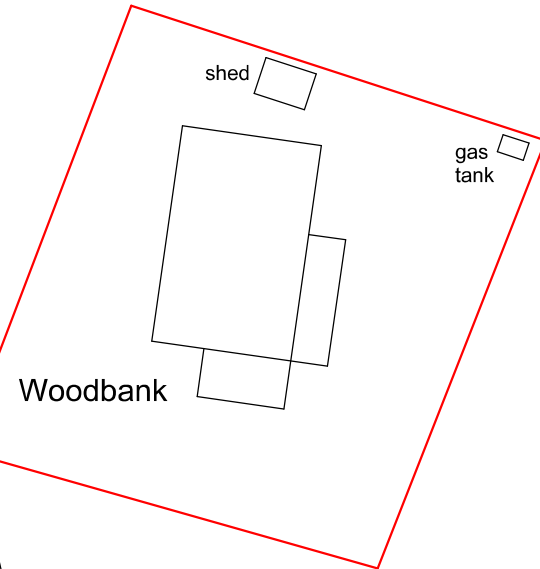

Woodbank

Westcroft

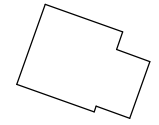
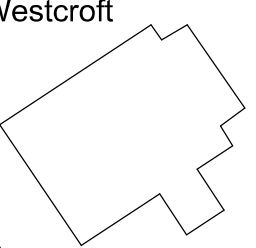
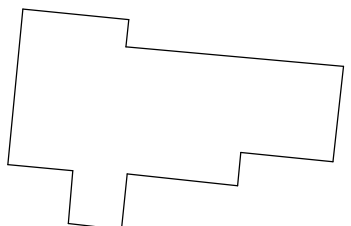

Ordnance Survey (c) Crown Copyright 2020. All rights reserved. Licence number 100022432

This is a true copy of the drawing referred to in the application dated2021

signed.....

Constructive Architectural Design Ltd.
34 Main Street,
Prestwick
KA9 1NX
Tel: 01292 479355
e-mail: constructivedesign@btconnect.com

Client	Mr J. Trott		
Address	Woodbank, Lylestone Road, Kilwinning KA13 7QN		
Project	Proposed Alterations & Side Extension		
Drawing	Existing Block Plan		

Date	October 2020	Scale	1:500
Drawn By	S.McCartney		

Job Ref.	Drawing No.
20/1139	03