

HOW DOES THE SYSTEM WORK?

- The Optimus is designed to ring your phone of choice once the relevant property button has been pressed on the external unit. You will receive a normal telephone call on your landline or mobile, and the number that appears on the screen (where applicable) is the unit telephone number and can be stored as "door/gate" for future reference.
- Answer the call as normal, and once you have confirmed the identity of the visitor you simply press the # key (by default) and this will trigger the operating equipment. You should hear a tone down the line confirming this has been accepted and the call will be dropped, or if you do not wish to allow the visitor access, simply hang up the call.
- If you have multiple entrances that need controlling, you can enter a different command on your telephone keypad to trigger the alternative equipment.

DEFAULT COMMANDS AND PIN CODES

- The following list confirms the default Access Tones and PIN Codes that are pre-programmed into your Optimus system at the point of installation.

ACCESS TONES What is pressed on the telephone keypad to allow access:

- # Pulses Relay 1
- 1# Pulses Relay 1
- 2# Pulses Relay 2
- 3# Latches Relay 3
- 6# Unlatches Relay 3

PIN CODES What is pressed on the coded entry keypad (where fitted) to gain access:

- *1111 Pulses Relay 1
- *2222 Pulses Relay 2
- *3333 Latches Relay 3
- *6666 Unlatches Relay 3

WE STRONGLY RECOMMEND THE ABOVE PIN CODES ARE CHANGED AT THE POINT OF INSTALLATION.

CODED ENTRY ACCESS

- If a coded entry keypad is fitted, you can programme in various PIN codes to trigger the operating equipment. Please refer to the default PIN code chart above.

AUTHORISED DIAL IN

- The Optimus system can be programmed with Authorised Dial-In numbers. If your number has been programmed into the system, you can ring into the intercom and trigger the operating equipment where necessary. Please contact your Installer should you wish to set this facility up.

TEXT COMMANDS

- You can send a text message to your Optimus intercom to request a specific operational command. The default words are: **Open, Latch, Close**. The words are not case sensitive but must be spelt as shown. The words create the following actions: **Open** sends a pulse command / **Latch** sends a "hold open" command or energises the relay / **Close** unlatches or de-energises the relay.
- The Optimus system will send a confirmation text message back to your phone charged at your standard network rate. If you would like the response messages deactivated, please contact your Installer.

ARE THERE ANY CUSTOM SETTINGS I NEED ENABLED FOR OPTIMUS TO WORK?

- **DTMF TONES** Dual Tone Multi Frequency: This must be enabled on any phone receiving a call from the Optimus system as it generates the tone which triggers the operating equipment. Please check with your phone manufacturer of choice to ensure DTMF tones can be enabled.

WHAT IF I NEED TO CHANGE A SETTING OR NUMBER?

- The Optimus system can be remotely configured by your installer.

WHAT HAPPENS IF I'M ON THE PHONE WHEN A VISITOR ARRIVES?

- We recommend enabling "Call Waiting" on your phone so you can see the additional call coming through. You can then put the original call on hold to answer the intercom, or it can be ignored. If your phone creates an engaged tone, the Optimus will automatically divert to the next number where applicable.
- If voice-mail is enabled, the system is unable to divert once this has answered. The visitor can leave a message or cancel the call by pressing the "Clear" button.

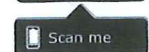



24VDC

BULL1524



COMMERCIAL USE

control unit with incorporated receiver and virtual encoder
personalised release key
built-in battery charger



up to 1500 kg



CONTROL UNITS:

BULL1524 — CP.B1524 — 164

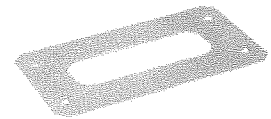

Foundation plate with anchor bolts included.
Motor and floor fixing distance
269 mm x 106 mm, no. 4 Ø 12 mm.

24 Vdc | intensive use

- 24 VDC geared motor with integrated control unit equipped with switching power supply (85±265 VAC) which reduces energy consumption and ensures a long lifespan of the actuator
- Very intensive use, ideal for condominium applications
- Anti-crushing system with amperometric obstacle detection
- The control unit makes it possible to calculate the position of the motor starting from the measurement of instantaneous speed (virtual encoder)
- The virtual encoder allows proper management of the slowing-down phases, movement tracking (STC system), and torque management in relation to the position of the gate, which guarantees maximum safety
- Fast and easy to install, with the self-programming function through the radio transmitter, activation is possible immediately after installation
- Option to operate opposed sliding gates using the SIS accessory and in case of power failure with the built-in battery charger accessory
- Metal release lever
- Version available with magnetic limit switches (BULL1524.S)

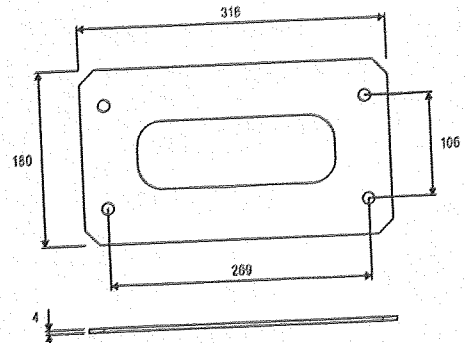
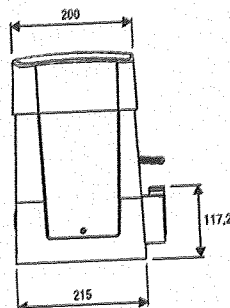
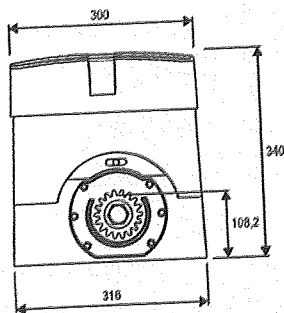



RI.M4F

M4 rack, to weld or attach with screws, 30x12x1000 mm slotted and galvanised, Supplied with M6 metric screws and threaded spacers, **Package of 4 pcs.**



RI.M4Z

M4 galvanised rack to weld 22x22x2000 mm, **Package of 2 pcs.**

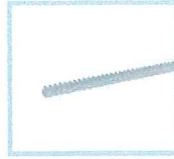

RI.M4ZF

Galvanised slotted M4 rack 22x22x2010 mm for fastening to the side with the teeth, Supplied with M6 screws, **Package of 1 pc.**

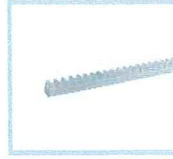

RI.M6Z

M6 galvanised rack to weld 30x30x2000 mm, **Requires pinion RI.P6.**



RI.P6

M6 gear, it needs the rack RI.M6Z.



BULL.PI

Raised foundation plate, Height 32 mm, Floor fixing distance 280x170 mm, no. 4 Ø 11 mm, motor fixing distance 269x106 mm n.4 M10.



SB.BULL20.F

Externally fitted anti-intrusion cable unlock device (L=4.5m).



ID.TA

Warning board.



IRI.TX4VA

4-channel transmitter with Advanced Rolling Code and Rolling Code.



IRI.TX4AK

4-channel transmitter with Advanced Rolling Code and Fixed Code.



IRI.LAMP

White full range flashing light, 20-255 VAC with built-in aerial.



IRI.KPAD

Battery operated wireless vandal-proof digital keypad with alert buzzer and backlit buttons, Triple coding: Rolling Code, Programmable Code and Advanced Rolling Code, 254 memorisable codes.



IRI.CELL

Pair of vandal-proof metal covers for PUPILLA/PUPILLA.R photocells, comprising front and rear shells with concealed screw, They can maintain perfect orientation over 180°.



PUPILLA

Pair of photocells adjustable to 180°. Option to synchronise up to 4 pairs, 24 VAC/DC power supply. Easy adjustment through a LED that signals optimal alignment, Compact size: 36x110x35 mm

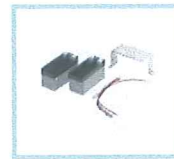

BULL1524.CB

Accessory equipped with 1.2 Ah batteries and support bracket.



SIS

Quick connection electronic board that allows synchronised movement of 2 automation devices (opposed sliding gates). One board for each motor is necessary.

TECHNICAL DATA	BULL1524	BULL1524.S
Power supply	85 ± 265 Vac (50-60Hz)	85 ± 265 Vac (50-60Hz)
Motor supply	24 Vdc	24 Vdc
Max absorbed current	1,7 A	1,7 A
Max Thrust	944 N	944 N
Opening speed	11,7 m/min	11,7 m/min
Duty cycle	intensive use	intensive use
Protection level	IP44	IP44
Magnetic limit switches	NO	YES
Operating temperature	-20°C /+50°C	-20°C /+50°C
Max gate weight	1500 kg	1500 kg
Driving gear for rack	M4 Z18	M4 Z18
Weight	15,9 kg	16 kg

DRG NO.

EGS 220521 01 FAIRWAYS

VIEWED FROM OUTSIDE LOOKING IN - GATES OPENING TO THE RIGHT

FULLY WELDED CONSTRUCTION - ALL WELDS DRESSED FLUSH & SMOOTH

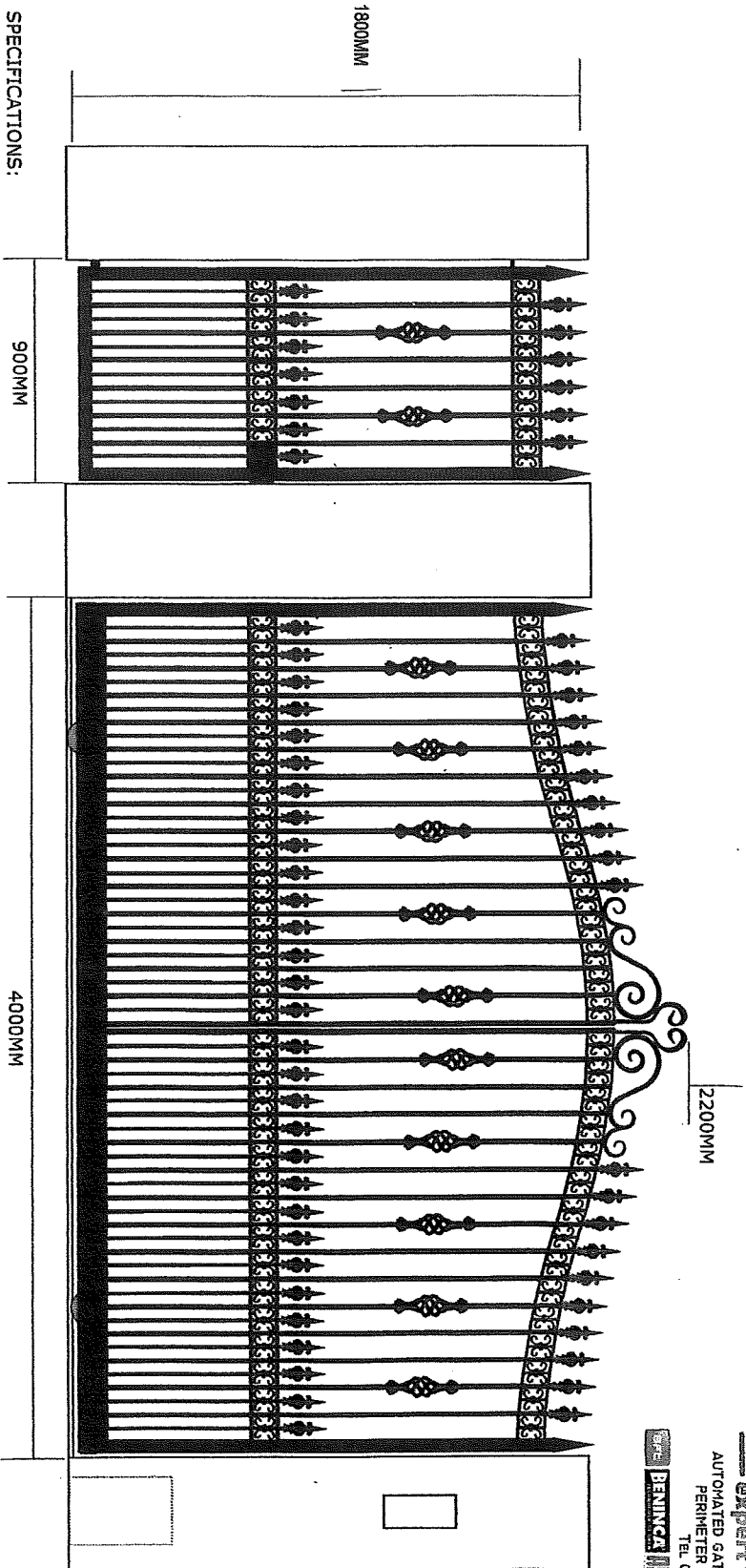

SPECIFICATIONS:

OUTER GATE FRAMES 50MM X 50MM SHS
 GATE ROLLER RAIL 100MM X 50MM SHS
 HORIZONTAL RAILS 50MM X 12MM SHS
 VERTICAL INFILLS 25MM X 25MM SHS
 INTERMEDIATE LOWER VERTICAL INFILLS 20MM X 20MM
 GALVANISED
 POWDER COATED RAL 9005 BLACK

AUTOMATION SYSTEM

BENINCA BULL1524ESA MOTOR
 6 X SAFETY EDGES
 2 PAIRS SAFETY PHOTOCELLS
 OPTIMUS GSM INTERCOM

PLEASE CONTACT ENGINEERING DEPARTMENT REGARDING ANY AMENDMENTS TO THIS DRG

DRAWN BY: S.TROMAN		CHECKED BY		DRAWN DATE : 22/05/21		SCALE: NOT TO SCALE	
MATERIAL		FINISH		EXPECTED DELIVERY DATE		ISSUE NO	
MILD STEEL		POWDER COATED RAL 9005		TBC		01	
THIS DRAWING IS THE PROPERTY OF EXPERT GATE SYSTEMS IT IS PRIVATE AND CONFIDENTIAL AND MUST NOT BE COPIED OR SHOWN TO A THIRD PARTY UNLESS PRIOR AUTHORISATION IS GIVEN				TITLE: AUTOMATED SLIDING ENTRANCE GATE		DRG No.	
				EGS220521 01		PRINT A3	

expert gate systems
 expert fabrications
 AUTOMATED GATES-BARRIERS-BOLLARDS
 PERIMETER SECURITY SYSTEMS
 TEL. 01675 475427

BENINCA **LAAS**
 SAFETY WARDER

DRG NO. EGS 220521 02 FAIRWAYS - RAILINGS	
FULLY WELDED CONSTRUCTION - ALL WELDS DRESSED FLUSH & SMOOTH	

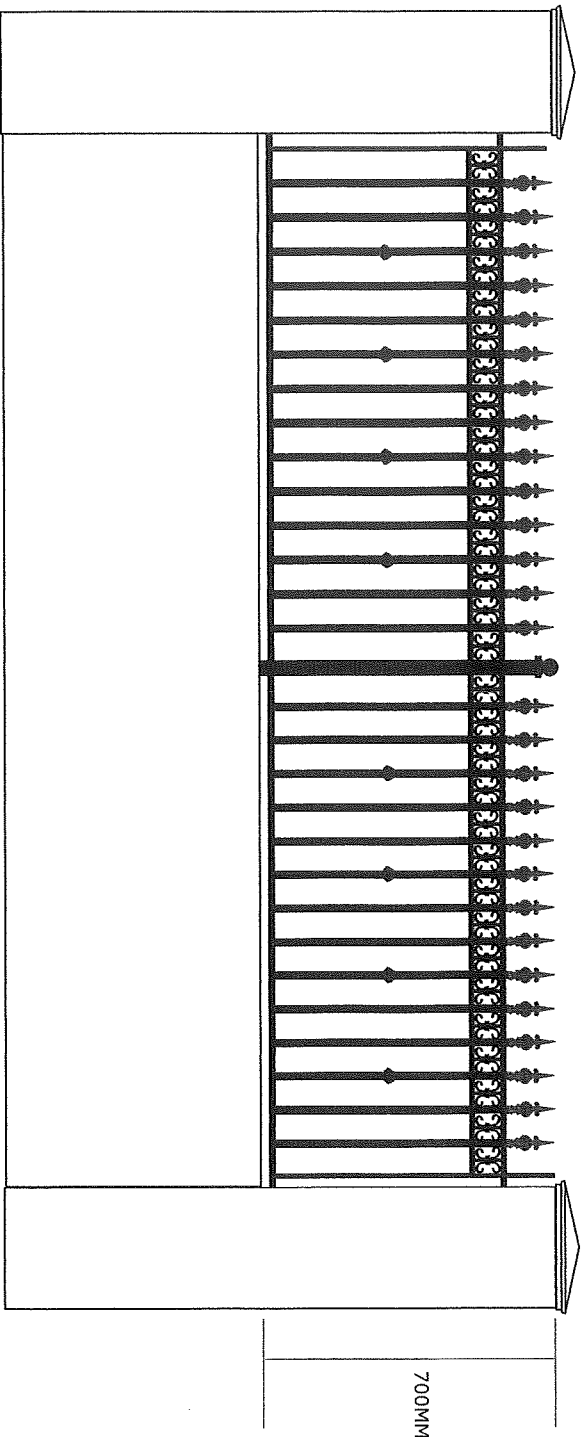

SPECIFICATIONS:
 OUTER RAILING FRAMES 50MM X 12MM SHS
 VERTICAL INFILLS 20MM X 20MM SHS
 POSTS 60MM X 60MM
 GALVANISED
 POWDER COATED RAL 9005 BLACK

PLEASE CONTACT ENGINEERING DEPARTMENT REGARDING ANY AMENDMENTS TO THIS DRG

DRAWN BY: S.TROMAN	CHECKED BY	DRAWN DATE : 22/05/21	SCALE: NOT TO SCALE
MATERIAL MILD STEEL, GALVANISED	FINISH COLOUR POWDER COATED RAL 9005	EXPECTED DELIVERY DATE TBC	ISSUE NO 01
THIS DRAWING IS THE PROPERTY OF EXPERT GATE SYSTEMS IT IS PRIVATE AND CONFIDENTIAL AND MUST NOT BE COPIED OR SHOWN TO A THIRD PARTY UNLESS PRIOR AUTHORISATION IS GIVEN		TITLE: FAIRWAYS RAILINGS	PRINT A3
		DRG No. EGS220521 02	

expert gate systems

specialised expert fabrications

AUTOMATED GATES-BARRIERS-BOLLARDS
 PERIMETER SECURITY SYSTEMS
 TEL: 01675 475427

BENINCA **SAVED** **FAES** **li**

CONSTRUCTION SECURITY SYSTEMS