



RDK CONSTRUCTION

PROPOSED LEISURE DEVELOPMENT FAIRLIE, NORTH AYRSHIRE

TRANSPORTION STATEMENT

DOUGALL BAILLIE ASSOCIATES

Civil • Structural • Transportation

3 Glenfield Road

Kelvin

East Kilbride G75 0RA



December 2010

CONTENTS

1	INTRODUCTION	4
2	NATIONAL POLICY FRAMEWORK.....	5
3	PUBLIC TRANSPORT ACCESSIBILITY.....	8
4	SITE ACCESS PROPOSAL.....	11
5	TRAFFIC GENERATION AND DISTRIBUTION	12
6	CAR PARKING AND SERVICE REQUIREMENTS.....	14
7	CONCLUSIONS.....	15

FIGURES

Site Location Plan	Diagram 1.1
Site Plan Proposed.....	Diagram 1.2

APPENDICES

TRICS Database Output.....	Appendix A
Automatic Traffic Counter Data (Extract)	Appendix B

1 INTRODUCTION

- 1.1 RDK Construction appointed Dougall Baillie Associates (DBA) to act on their behalf in connection with the proposed development of a site in Fairlie, North Ayrshire, to the west of the A78 Trunk Road. The proposed development comprises a garden centre and restaurant/café. The location of the site is indicated on Diagram 1.1, while the site layout is shown in Diagram 1.2.
- 1.2 A planning application has been submitted to North Ayrshire Council for a garden centre of 285m² Retail Floor Area with associated plant sales and tree nursery areas; and a café/restaurant of 250m² Public Floor Area.
- 1.3 The proposed development would be accessed from the A78 by upgrading the existing access to a parking area south of Baillie Road. This existing parking area is utilised by Fairlie Bowling Club, and is located approximately 100m within the northern boundary of the 30mph speed limit in Fairlie.
- 1.4 In keeping with current Government policy guidelines this Transportation Statement assesses the potential for minimising private car usage by public transport. To this end an assessment of existing pedestrian, cycle and public transport facilities has been carried out. Parking provision and servicing requirements are also assessed.
- 1.5 This document takes into account current local, regional and national legislation and identifies the accessibility of the site by all sustainable transport modes. Travel information has been studied and an assessment of existing transport infrastructure and service provision has been made.
- 1.6 The report also identifies the impact of vehicular traffic generated by the proposed development on the adjacent road network. The traffic data collection, calculations of traffic generation and local road network assessment have been summarised in this report. More detailed information pertaining to certain aspects of the report are available and can be obtained on request.

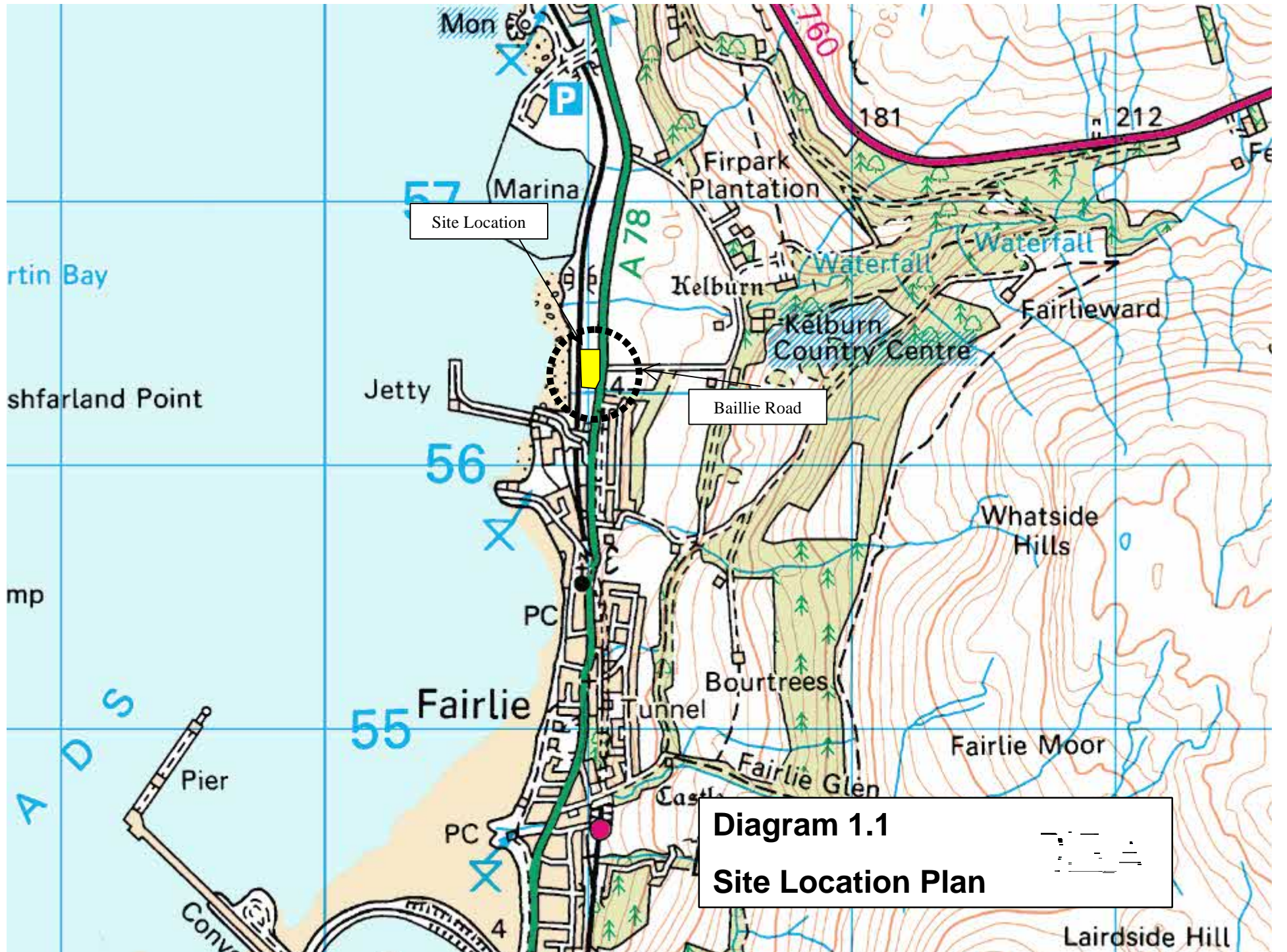

PROPOSED GARDEN CENTRE AND RESTAURANT

- NORTH OF FAIRLIE BOWLING CLUB

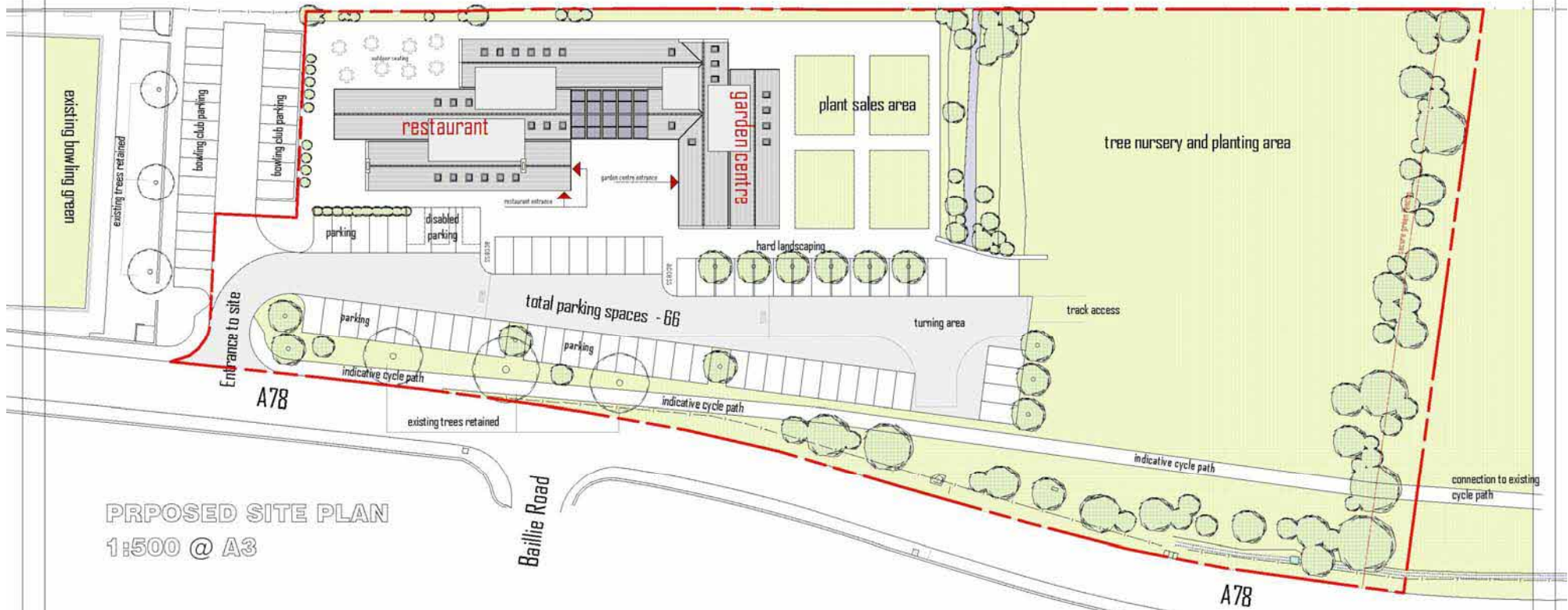

PROPOSED SITE PLAN
1:500 @ A3

parking requirements:

cafe/restaurant area - 250m² 20/100m² = 50 spaces
garden centre retail floor area - 285m² 5.5/100m² = 16 spaces

TOTAL REQUIRED	66 SPACES
PROVISION	66 SPACES

Diagram 1.2
Site Layout

RDK Construction Ltd.

This drawing is the property of RobertRyan Homes Ltd. Copyright is reserved by the said RobertRyan Homes Ltd. and this drawing is issued on condition that it is not copied, reproduced, retained or disclosed to any unauthorised person, either wholly or in part, without prior consent in writing from RobertRyan Homes Ltd.

GARDEN CENTRE AND RESTAURANT.

Location:	North of Fairlie Bowling Club.	PLANNING DRAWING	Drawing No: 04
Date:	29.11.10		
Scale:	1:500 @ A3		
Drawn by:	D.M.D.B.		
		SITE PLAN PROPOSED	

2 NATIONAL POLICY FRAMEWORK

Introduction

- 2.1 Scottish Planning Policy is a statement of the Scottish Government's policy on land use planning matters.
- 2.2 Scottish Planning Policy (SPP) of February 2010 superseded SPP 17 which provided guidance on Transport and Planning matters.
- 2.3 SPP of February 2010 contains sections on a wealth of planning subject policies and includes a separate section for Transport. Planning Advice Note (PAN) 75 accompanies the SPP on transport matters.

Scottish Planning Policy on Transport

- 2.4 As stated above, SPP provides guidance on the development of integrated land use and transport planning. It aims to provide guidance sufficient to enable sustainable development in terms of improving transport to support economic growth while protecting the environment and improving the quality of life.
- 2.5 Paragraph 165 notes that "*Reducing emissions from transport sources as a contribution to achieving Scottish Government greenhouses gas emission targets requires a shift to more sustainable modes of transport*". This means a shift from car based travel to walking, cycling or public transport.
- 2.6 It is indicated in Paragraph 165 that the "*planning system should support a pattern of development which reduces the need to travel, facilitates travel by public transport and freight movement by rail or water, and provides safe and convenient opportunities for walking or cycling*".
- 2.7 The planning system should also support the installation of infrastructure and new technology.
- 2.8 SSP identifies how the planning system and relationship between transportation issues and land use has a strong influence on sustainable economic growth. It is noted that tackling congestion will also support sustainable economic growth and reduce emissions.
- 2.9 SPP paragraph 167 notes that "*significant travel generating uses should be in locations which are well served by public transport and the amount of associated car parking permitted should be controlled to encourage more sustainable travel choices*". SSP indicates that Travel Plans should also be encouraged for these types of developments.
- 2.10 Paragraph 168 goes on to emphasise that planning permission should not be granted for significant travel generating uses in locations :-

where immediate links to walking and cycling networks are not available or cannot be made available;

where access to public transport networks would involve walking more than 400m;

which would encourage reliance on the private car

which would be likely to have a detrimental effect on the capacity of the strategic road and/or rail network;

where a Transport Assessment does not include any satisfactory mechanism for meeting sustainable transport requirements.

- 2.11 SPP paragraph 169 gives a hierarchy of personal travel modes to be prioritised. These are in the following order:-

Walking

Cycling

Public Transport

Car

Other Motorised Vehicles

- 2.12 It also indicates that buildings and facilities should be accessible on foot and cycle and that “*improvements to active transport networks, such as paths and cycle routes, in urban and rural areas will support more sustainable travel choices*”. It is also the aim that urban areas become more attractive and safer for pedestrians and cyclists including people who may have mobility problems. Accessibility issues along with street layout and design should be part of the design and planning processes from the outset.
- 2.13 Parking policies are emphasised in SPP. Paragraph 171 notes that “the available of parking can have an important influence in reducing the reliance on the car”. It suggests that planning authorities should apply maximum parking standards to on-site parking at new development to encourage modal shift, but also notes that such parking restraint policies should be accompanied by measures to support high quality public transport services.

Planning Advice Note 75

- 2.14 PAN (Planning Advice Note) 75 accompanies SPP providing advice on good practice. Paragraph 6 notes that ‘one focus of SPP 17 (now superseded by SPP on Transport) is to achieve better and earlier integration between transport and land use planning at national, regional and local level. It continues that ‘Integration can reduce the need to travel and offer more sustainable travel choices. To achieve sustainable development the objectives of SPP 17 must be considered in the context of other planning policy and guidance’.

Local Transport Strategy

- 2.15 Local Transport Strategies (LTS) are intended to set out a local authority’s objectives, strategies and implementation plans for the development of an integrated transport system. The LTS should flow from and in turn be incorporated into the relevant development plan.
- 2.16 North Ayrshire Council (NAC) has published an LTS document, “Local Transport Strategy 2008-2013”, which has been referred to in the preparation of this report.
- 2.17 The overall strategic vision for North Ayrshire Council’s LTS will remain unchanged from the previous strategy to:

“ integrate all forms of transport, land use planning, and other strategic policies of the Council relating to economic regeneration, development, and the environment;

“Maintain and enhance the choice of mode of transport to ensure that all sections of the community have safe, secure and equal opportunity of access to all local facilities, and good transport links to other parts of the country; and

“Manage and contain any future growth in traffic and promote alternatives, to ensure that problems of traffic congestion and air pollution do not develop.”

2.18 The following objectives have been identified for the North Ayrshire Council 2008-2013 LTS;

*To promote **social inclusion** by connecting communities to facilities and services, and increasing the **accessibility** of the transport network;*

*To promote **economic growth** by maximising the effectiveness and efficiency of transport services, infrastructure and networks;*

*To minimise the **environmental footprint** of transport services, infrastructure and networks;*

*To improve the **integration** of the transport system between different services and modes, and with other relevant local, regional, and national policies; and*

*To reduce accidents and enhance the **personal safety** of all users of the transport network, by improving the **safety and security** of journeys.*

3 PUBLIC TRANSPORT ACCESSIBILITY

- 3.1 This assessment of Public Transport facilities and services considers in detail the four elements of the public transport network that serve the area in which the proposed development is located.
- 3.2 Current infrastructure for Pedestrian and Cyclists is considered, along with enhancements provided in conjunction with the development. The Bus Services and Rail Transport sections deal with the routes, quantity and availability of all relevant services. These two modes have been examined, along with the potential to maximise access to the site for all travel modes.
- 3.3 The bus and rail elements of the assessment are based on published service data for bus and train services. This data is often subject to revision and the data used will become outdated in the future, however it is considered to represent a reasonable basis on which to carry out the type of desktop study summarised in this section of the report.
- 3.4 Scottish Planning Policy (SPP) on Transport, emphasises that development should be located in areas that are capable of being integrated into effective networks for all forms of transport, including walking cycling and public transport. SPP also clearly identifies a hierarchy of priority that should be given to different transport modes in terms of measures to accommodate their access to a development. This hierarchy is walking, cycling, Public Transport and lastly car.

Walking

- 3.5 The term ‘pedestrian’ covers able-bodied people, disabled people, with or without the use of wheelchairs, the infirm, the elderly and parents with children in pushchairs or buggies. Due to the range of mobility exhibited by pedestrians it is important to ensure that the requirements of those with restricted mobility are considered.
- 3.6 The most popular pedestrian routes serving the development are anticipated to be those leading to public transport interchanges, local services and residential areas.
- 3.7 There is existing pedestrian provision adjacent to the development with a footway on the east side of the A78. There are footways on both sides of the A78 south of the development site, connecting the site with the local residential areas and to the existing bus stops on the A78. The eastern footway continues into the centre of Fairlie, providing a connection from the site to all residential areas, and to local facilities.

Cycling

- 3.8 At present there are cycle routes to the north and south of the development site. South of Fairlie and north of West Kilbride these are designated on-road routes. There is also a short section of off-road cycle route in the Hunterston area. To the north of Fairlie there is a cycle route running into Largs. This cycle route extends from Largs to the Kelburn Country Centre however at present the off road section terminates at the A78 trunk road, at the southern entrance to the country park, within the derestricted 60mph section.
- 3.9 It has previously been suggested by the applicant that this cycle route could be extended to the south by its incorporation into the development site. This remains viable and the development proposals show an indicative cycle path passing along the site frontage which would facilitate access to Fairlie for cyclists travelling to and from the north.

- 3.10 In the future the cycle route is proposed to connect to Fairlie Rail Station, some 1.7km south of the development site, linking with the existing cycle network. This route has the potential to serve cycle trips to and from the development to neighbouring areas by either staff or customers. The potential future extension of the cycle route would also carry longer distance cycling trips which would be likely to visit the proposed development due to its proximity and the type of uses proposed.

Bus Services

- 3.11 SPP specifies that new development should be within 400m of public transport services. There are existing bus stops some 60m and 135m south of the development access. These distances are equivalent to a walk of approximately 1 to 2 minutes respectively at a walking speed of 1.5 metres per second, which is an easy walking pace for most people.
- 3.12 The bus stops are served by 2 bus services, operated by Stagecoach and Orion Autobus. The Stagecoach Service 585 provides a half hourly bus between Greenock and Ayr while the Orion Autobus Service 45 provides an hourly bus between Upper Skelmorlie and Fairlie. These services are detailed in Table 3.1.

Route	Operator	Route Description	Frequency	Veh/Hr
585	Stagecoach	Greenock West - Greenock, IBM - Wemyss Bay - Largs Main Street - Fairlie - West Kilbride Meadowfoot Rd - West Kilbride Main St - Seamill Hydro - Ardrossan Witches Linn - Ardrossan Princes St - Saltcoats, Railway Station - Stevenston Cross - Irvine Cross - Prestwick Airport - Prestwick Cross – Ayr Bus Stn	30 minutes	2
45	Orion Autobus	Upper Skelmorlie - Largs - Fairlie	60 minutes	1
			Total	3

Table 3.1 –Bus Service Provision

Train Services

- 3.13 The closest station to the development site is Fairlie Station, which is approximately 1700m to the south of the site. Fairlie Station is on the Clyde Coast network and is part of the Largs to Glasgow line. Table 3.2 below illustrates the Largs to Glasgow route. There is a train available most hours however the timing between each varies between 60 and 80 minutes.

Route	Frequency (Mon-Sat)
Glasgow Central, Paisley Gilmour Street, Johnstone, Milliken Park, Howwood, Lochwinnoch, Glengarnock, Dalry, Kilwinning, Stevenston, Saltcoats, Ardrossan South Beach, West Kilbride, Fairlie , Largs	~ 1 per hour

Table 3.2 – Train Services during Weekday AM and PM Peaks

- 3.14 Fairlie Rail Station currently has 9 car parking spaces. The station has step-free access and one of the car parking spaces is allocated for disabled persons. There is also a cycle rack available with space for 4 bicycles.
- 3.15 At a typical walking speed of 1.5m per second the distance from the development site to the station would take some 19 minutes to walk. While this is a feasible walking distance for many people, given the nature of the proposed development, and the availability of bus service immediately adjacent to the site, it is not considered like that rail would be used by many employees or visitors to the site.
- 3.16 .In summary, the site is well served by public transport and non-car modes of travel, and the use of non-car modes would be feasible for many employees at and visitors to the proposed development.

4 SITE ACCESS PROPOSAL

- 4.1 The proposed development would be accessed from the A78 by upgrading the existing access to a parking area south of Baillie Road. This existing parking area is utilised by Fairlie Bowling Club, and is located approximately 100m within the northern boundary of the 30mph speed limit in Fairlie.
- 4.2 To the south of the existing access, there is a wall bounding the bowling green, which is set back approximately 2m from the road edge at the rear of the existing footway on the A78.
- 4.3 This wall is relatively low and permits a degree of visibility to the left-hand (south) side of the junction for exiting traffic. The existing wall is considered to be close to the required 1.05m visibility height for splays at a junction. The proposed reconfiguring of the existing junction would permit the level of the access to be raised slightly to ensuring that visibility splay at 1.05m is achievable.
- 4.4 To the north of the site access, a line of trees exists within the site, which would be retained under the development proposals. These trees are set back approximately 4 to 5m from the edge of the carriageway, and therefore permit ample visibility to the north of the access to be achieved.
- 4.5 Since the access is located well within the 30mph speed limit zone, it is considered that the proposed improvement of the existing access will achieve a suitable access junction for the development.
- 4.6 It is apparent that a use of this type and scale has been considered appropriate in the past, since a previous consent was granted for the same use on a larger site in this location.

5 TRAFFIC GENERATION AND DISTRIBUTION

- 5.1 In order to assess the potential impact of the proposed development, reference was made to existing surveys of similar developments, in the form of the TRICS (Trip Rate Information Computer System) national database 2010(a) v6.5.1.
- 5.2 Trip rates indicated by TRICS are shown in Table 5.1 alongside the rates and generation that have been applied. Extracts of data from TRICS database are contained in Appendix A.
- 5.3 The rates for Restaurants were obtained from a sample of sites which were considered to be representative and provided data which was averaged.
- 5.4 Surveys of garden centres were fewer and despite a wider sample area, this approach still provided only one weekday survey, but 6 weekend surveys, based on limiting the maximum size of development. The results were averaged to produce the rates shown in Table 5.1.
- 5.5 It should be noted that trips generation is generally assessed on Gross Floor Area, and these are the figures applied in Table 5.1. Consideration was given to three road network peak periods, namely Weekday AM and PM commuting peaks, and a Weekend afternoon peaks. An allowance was also made to reflect the fact that there would be a degree of shared trips between the two parts of the development. To reflect this trip sharing, Garden Centre trips were reduced by 30% in the Sunday Peak.
- 5.6 Since the Restaurant use would be closed during the Weekday AM, and garden centre traffic would generally be limited to staff and deliveries, the AM commuting peak is not significant in traffic terms and is not shown in Table 5.1. The peak hours adopted correspond to peak flows on the A78.

Land Use	Trip Rates In / Out Weekday PM Peak	Vehicles In / Out / Tot PM Peak 4pm to 5pm	Trip Rates In / Out Sunday Peak	Vehicles In / Out Sunday Peak 2pm to 3pm
Café / Restaurant (446m ² GFA)	0.896 / 0.993	4 / 4 = 8	1.987 / 2.464	9 / 11 = 20
Garden Centre (520m ² GFA)	0.351 / 0.649	2 / 3 = 5	1.516 / 1.616	8 / 8 = 16
Total Trips	-	6 / 7 = 13	-	17 / 19 = 36
Sunday Garden Centre Total with 30% reduction applied				14 / 17 = 31

Table 5.1 – Estimated Development Trip Generation

- 5.7 This predicted development traffic generation was compared to the existing peak hour traffic flows on the A78 through Fairlie. There is an existing Automatic Traffic Counter (ATC) located on the A78 in Fairlie, in the vicinity of the development site. Peak hour data from this site was extracted for comparison with predicted development traffic levels. The month of May 2009 was adopted as a neutral month. This data is included in Appendix B.

- 5.8 Existing northbound and southbound traffic flows on the A78 were averaged for the peak hours considered. Fridays were excluded as being untypical of weekday commuting patterns. Monday to Thursday flows were averaged for the 4pm to 5pm peak hour. The Sunday peak hour flows on the A78 from 2pm to 3pm were similarly averaged for May 2009.
- 5.9 Given that the distribution of base traffic flows on the A78 is relatively balanced between the northbound and southbound directions, it is likely that generated traffic flows would also be split between these approach directions in a similar way. In order to provide a robust assessment however, a worst case was assumed where 75% of development traffic approached from the north (i.e. southbound), these flows being slightly lower than the A78 northbound flows.

Peak hour	A78 Traffic flow 2009	Development Traffic	Percentage impact
Northbound		(25%)	
Weekday PM – 4 to 5pm	519	3	0.6%
Sunday PM – 2 to 3pm	429	8	1.9%
Southbound		(75%)	
Weekday PM – 4 to 5pm	489	10	2.0%
Sunday PM – 2 to 3pm	402	23	5.7%

Table 5.2 – Comparison with Existing Traffic Flows

- 5.10 This assessment indicates that the expected peak hour traffic generation from the proposed development would be modest, in the order of one vehicle every 2½ minutes in the peak direction. Traffic flows at this level would not have a significant impact on the operation of the A78.

6 CAR PARKING AND SERVICE REQUIREMENTS

- 6.1 North Ayrshire Council utilises the former Strathclyde Regional Council Roads Development Guide 1995 parking standards in assessing the requirement for parking provision by new developments.
- 6.2 This document does not identify a specific standard for garden centres. It was deemed appropriate to apply the standard quoted as for stand-alone DIY superstores, since this standard is noted to potentially include garden centres with the DIY store. The applicable standard for the size of garden centre is 5.5 spaces per 100m² Gross Floor Area (GFA).
- 6.3 The parking requirement for restaurants is expressed in terms of the public floor area of these facilities. The relevant standards are 20 per 100m² PFA for restaurants.
- 6.4 In the assessment of parking provision it is important to take account of the same trip sharing effect as was reflected in the trip generation assessment. The figures in Table 7.1 are therefore modified by applying the same 30% reduction in garden centre parking.

Land Use	Size	Parking standard	Appropriate Provision
Garden Centre	520m ² GFA	5.5 / 100m ² GFA	29
Restaurant	250m ² PFA	20 / 100m ² PFA	50
30% reduction in Garden Centre Parking			20
TOTAL		-	70

Table 6.1 – Proposed Development Parking Provision

- 6.5 The proposed development would provide some 66 parking spaces, in total, 3 of which would be disabled parking spaces. This is less than the total provision and therefore would meet national policy on parking provision which defines commercial standards as maximums.
- 6.6 It is intended that the detailed layout of the development would comply with the Council’s development roads guidelines and would accommodate the normal service vehicle manoeuvres within the site that would be expected for a development of this nature.

7 CONCLUSIONS

- 7.1 The proposed development can and would be integrated into the existing local transport network of footways, which provide convenient access to existing public transport and other local services.
- 7.2 There is ample provision of public transport services in the area of the site, and these are highly accessible due to the proximity of bus stops close to the development access.
- 7.3 There is the potential for the development to improve existing cycle access to the north of Fairlie.
- 7.4 The existing access to the A78 would be improved in terms of its layout and alignment as part of the development proposals. It is also possible to improve the visibility to the south of the access as part of the proposed works.
- 7.5 The impact of the proposed development on traffic flows on the A78 is expected to be modest, and would not have a noticeable effect on the operation of the A78.
- 7.6 Car parking would be provided in accordance with the Council's parking standards, as assessment of which demonstrates that an appropriate number of spaces can be achieved on the development site.

APPENDIX A

TRICS DATABASE OUTPUT

TRIP RATE CALCULATION SELECTION PARAMETERS:

Land Use : 06 - HOTEL, FOOD & DRINK
 Category : B - RESTAURANTS
 VEHICLES

Selected regions and areas:

08	NORTH WEST	
	GM GREATER MANCHESTER	1 days
09	NORTH	
	DH DURHAM	1 days
11	SCOTLAND	
	GC GLASGOW CITY	1 days
15	GREATER DUBLIN	
	DL DUBLIN	1 days

Filtering Stage 2 selection:

Parameter: Gross floor area
 Range: 330 to 2400 (units: sqm)

Public Transport Provision:

Selection by: Include all surveys

Date Range: 01/01/02 to 21/05/10

Selected survey days:

Monday	1 days
Wednesday	1 days
Thursday	2 days

Selected survey types:

Manual count	4 days
Directional ATC Count	0 days

Selected Locations:

Town Centre	1
Edge of Town Centre	3

Selected Location Sub Categories:

Development Zone	2
Built-Up Zone	2

TRIP RATE for Land Use 06 - HOTEL, FOOD & DRINK/B - RESTAURANTS
VEHICLES

Calculation factor: 100 sqm

BOLD print indicates peak (busiest) period

Time Range	ARRIVALS			DEPARTURES			TOTALS		
	No. Days	Ave. GFA	Trip Rate	No. Days	Ave. GFA	Trip Rate	No. Days	Ave. GFA	Trip Rate
00:00 - 01:00	0	0	0.000	0	0	0.000	0	0	0.000
01:00 - 02:00	0	0	0.000	0	0	0.000	0	0	0.000
02:00 - 03:00	0	0	0.000	0	0	0.000	0	0	0.000
03:00 - 04:00	0	0	0.000	0	0	0.000	0	0	0.000
04:00 - 05:00	0	0	0.000	0	0	0.000	0	0	0.000
05:00 - 06:00	0	0	0.000	0	0	0.000	0	0	0.000
06:00 - 07:00	0	0	0.000	0	0	0.000	0	0	0.000
07:00 - 08:00	0	0	0.000	0	0	0.000	0	0	0.000
08:00 - 09:00	0	0	0.000	0	0	0.000	0	0	0.000
09:00 - 10:00	0	0	0.000	0	0	0.000	0	0	0.000
10:00 - 11:00	2	1365	0.037	2	1365	0.037	2	1365	0.074
11:00 - 12:00	3	1210	0.028	3	1210	0.000	3	1210	0.028
12:00 - 13:00	4	1033	0.412	4	1033	0.097	4	1033	0.509
13:00 - 14:00	4	1033	0.920	4	1033	0.533	4	1033	1.453
14:00 - 15:00	4	1033	1.138	4	1033	1.186	4	1033	2.324
15:00 - 16:00	4	1033	1.114	4	1033	1.211	4	1033	2.325
16:00 - 17:00	4	1033	0.896	4	1033	0.993	4	1033	1.889
17:00 - 18:00	4	1033	0.896	4	1033	0.896	4	1033	1.792
18:00 - 19:00	4	1033	1.332	4	1033	0.823	4	1033	2.155
19:00 - 20:00	4	1033	1.671	4	1033	1.259	4	1033	2.930
20:00 - 21:00	4	1033	1.308	4	1033	1.356	4	1033	2.664
21:00 - 22:00	4	1033	1.017	4	1033	1.501	4	1033	2.518
22:00 - 23:00	4	1033	0.605	4	1033	1.453	4	1033	2.058
23:00 - 24:00	3	1077	0.000	3	1077	0.155	3	1077	0.155
Total Rates:			11.374			11.500			22.874

Parameter summary

Trip rate parameter range selected: 330 - 2400 (units: sqm)
 Survey date range: 01/01/02 - 21/05/10
 Number of weekdays (Monday-Friday): 4
 Number of Saturdays: 0
 Number of Sundays: 0
 Surveys manually removed from selection: 0

TRIP RATE CALCULATION SELECTION PARAMETERS:

Land Use : 06 - HOTEL, FOOD & DRINK
 Category : B - RESTAURANTS
 VEHICLES

Selected regions and areas:

05	EAST MIDLANDS	
	DS DERBYSHIRE	1 days
	LE LEICESTERSHIRE	1 days
10	WALES	
	CP CAERPHILLY	1 days

Filtering Stage 2 selection:

Parameter: Gross floor area
 Range: 383 to 450 (units: sqm)

Public Transport Provision:

Selection by: Include all surveys

Date Range: 01/01/02 to 21/05/10

Selected survey days:

Saturday 3 days

Selected survey types:

Manual count 3 days
 Directional ATC Count 0 days

Selected Locations:

Town Centre	1
Edge of Town Centre	1
Suburban Area (PPS6 Out of Centre)	1

Selected Location Sub Categories:

Commercial Zone	1
Built-Up Zone	1
No Sub Category	1

TRIP RATE for Land Use 06 - HOTEL, FOOD & DRINK/B - RESTAURANTS
VEHICLES

Calculation factor: 100 sqm

BOLD print indicates peak (busiest) period

Time Range	ARRIVALS			DEPARTURES			TOTALS		
	No. Days	Ave. GFA	Trip Rate	No. Days	Ave. GFA	Trip Rate	No. Days	Ave. GFA	Trip Rate
00:00 - 01:00	0	0	0.000	0	0	0.000	0	0	0.000
01:00 - 02:00	0	0	0.000	0	0	0.000	0	0	0.000
02:00 - 03:00	0	0	0.000	0	0	0.000	0	0	0.000
03:00 - 04:00	0	0	0.000	0	0	0.000	0	0	0.000
04:00 - 05:00	0	0	0.000	0	0	0.000	0	0	0.000
05:00 - 06:00	0	0	0.000	0	0	0.000	0	0	0.000
06:00 - 07:00	0	0	0.000	0	0	0.000	0	0	0.000
07:00 - 08:00	0	0	0.000	0	0	0.000	0	0	0.000
08:00 - 09:00	0	0	0.000	0	0	0.000	0	0	0.000
09:00 - 10:00	1	425	0.000	1	425	0.000	1	425	0.000
10:00 - 11:00	3	419	0.000	3	419	0.000	3	419	0.000
11:00 - 12:00	3	419	1.272	3	419	0.238	3	419	1.510
12:00 - 13:00	3	419	2.464	3	419	1.113	3	419	3.577
13:00 - 14:00	3	419	2.385	3	419	3.021	3	419	5.406
14:00 - 15:00	3	419	1.987	3	419	2.464	3	419	4.451
15:00 - 16:00	3	419	0.954	3	419	1.192	3	419	2.146
16:00 - 17:00	3	419	1.351	3	419	1.272	3	419	2.623
17:00 - 18:00	3	419	2.146	3	419	1.431	3	419	3.577
18:00 - 19:00	3	419	2.067	3	419	1.908	3	419	3.975
19:00 - 20:00	3	419	2.305	3	419	2.862	3	419	5.167
20:00 - 21:00	3	419	1.351	3	419	1.431	3	419	2.782
21:00 - 22:00	3	419	1.669	3	419	2.146	3	419	3.815
22:00 - 23:00	3	419	0.238	3	419	0.636	3	419	0.874
23:00 - 24:00	3	419	0.000	3	419	0.715	3	419	0.715
Total Rates:			20.189			20.429			40.618

Parameter summary

Trip rate parameter range selected: 383 - 450 (units: sqm)
 Survey date range: 01/01/02 - 21/05/10
 Number of weekdays (Monday-Friday): 0
 Number of Saturdays: 3
 Number of Sundays: 0
 Surveys manually removed from selection: 0

TRIP RATE CALCULATION SELECTION PARAMETERS:

Land Use : 01 - RETAIL
Category : H - GARDEN CENTRE
VEHICLES

Selected regions and areas:

02 SOUTH EAST
HC HAMPSHIRE 1 days

Filtering Stage 2 selection:

Parameter: Gross floor area
Range: 3700 to 3700 (units: sqm)

Public Transport Provision:

Selection by: Include all surveys

Date Range: 01/01/00 to 18/10/09

Selected survey days:

Monday 1 days

Selected survey types:

Manual count 1 days
Directional ATC Count 0 days

Selected Locations:

Suburban Area (PPS6 Out of Centre) 1

Selected Location Sub Categories:

No Sub Category 1

TRIP RATE for Land Use 01 - RETAIL/H - GARDEN CENTRE
 VEHICLES
 Calculation factor: 100 sqm
 BOLD print indicates peak (busiest) period

Time Range	ARRIVALS			DEPARTURES			TOTALS		
	No. Days	Ave. GFA	Trip Rate	No. Days	Ave. GFA	Trip Rate	No. Days	Ave. GFA	Trip Rate
00:00 - 01:00	0	0	0.000	0	0	0.000	0	0	0.000
01:00 - 02:00	0	0	0.000	0	0	0.000	0	0	0.000
02:00 - 03:00	0	0	0.000	0	0	0.000	0	0	0.000
03:00 - 04:00	0	0	0.000	0	0	0.000	0	0	0.000
04:00 - 05:00	0	0	0.000	0	0	0.000	0	0	0.000
05:00 - 06:00	0	0	0.000	0	0	0.000	0	0	0.000
06:00 - 07:00	0	0	0.000	0	0	0.000	0	0	0.000
07:00 - 08:00	0	0	0.000	0	0	0.000	0	0	0.000
08:00 - 09:00	1	3700	0.351	1	3700	0.054	1	3700	0.405
09:00 - 10:00	1	3700	0.270	1	3700	0.270	1	3700	0.540
10:00 - 11:00	1	3700	0.757	1	3700	0.757	1	3700	1.514
11:00 - 12:00	1	3700	1.514	1	3700	1.595	1	3700	3.109
12:00 - 13:00	1	3700	0.838	1	3700	0.838	1	3700	1.676
13:00 - 14:00	1	3700	1.000	1	3700	0.865	1	3700	1.865
14:00 - 15:00	1	3700	1.405	1	3700	0.946	1	3700	2.351
15:00 - 16:00	1	3700	0.865	1	3700	1.243	1	3700	2.108
16:00 - 17:00	1	3700	0.351	1	3700	0.649	1	3700	1.000
17:00 - 18:00	1	3700	0.108	1	3700	0.270	1	3700	0.378
18:00 - 19:00	0	0	0.000	0	0	0.000	0	0	0.000
19:00 - 20:00	0	0	0.000	0	0	0.000	0	0	0.000
20:00 - 21:00	0	0	0.000	0	0	0.000	0	0	0.000
21:00 - 22:00	0	0	0.000	0	0	0.000	0	0	0.000
22:00 - 23:00	0	0	0.000	0	0	0.000	0	0	0.000
23:00 - 24:00	0	0	0.000	0	0	0.000	0	0	0.000
Total Rates:			7.459			7.487			14.946

Parameter summary

Trip rate parameter range selected: 3700 - 3700 (units: sqm)
 Survey date range: 01/01/00 - 18/10/09
 Number of weekdays (Monday-Friday): 1
 Number of Saturdays: 0
 Number of Sundays: 0
 Surveys manually removed from selection: 0

TRIP RATE CALCULATION SELECTION PARAMETERS:

Land Use : 01 - RETAIL
Category : H - GARDEN CENTRE
VEHICLES

Selected regions and areas:

04	EAST ANGLIA	
	SF SUFFOLK	1 days
06	WEST MIDLANDS	
	WM WEST MIDLANDS	1 days
	WO WORCESTERSHIRE	1 days
08	NORTH WEST	
	CH CHESHIRE	1 days
11	SCOTLAND	
	EB CITY OF EDINBURGH	1 days

Filtering Stage 2 selection:

Parameter: Gross floor area
Range: 1850 to 7500 (units: sqm)

Public Transport Provision:

Selection by: Include all surveys

Date Range: 01/01/00 to 18/10/09

Selected survey days:

Sunday 5 days

Selected survey types:

Manual count 5 days
Directional ATC Count 0 days

Selected Locations:

Suburban Area (PPS6 Out of Centre)	1
Edge of Town	1
Neighbourhood Centre (PPS6 Local Centre)	2
Free Standing (PPS6 Out of Town)	1

Selected Location Sub Categories:

Village	2
Out of Town	2
No Sub Category	1

TRIP RATE for Land Use 01 - RETAIL/H - GARDEN CENTRE
 VEHICLES
 Calculation factor: 100 sqm
 BOLD print indicates peak (busiest) period

Time Range	ARRIVALS			DEPARTURES			TOTALS		
	No. Days	Ave. GFA	Trip Rate	No. Days	Ave. GFA	Trip Rate	No. Days	Ave. GFA	Trip Rate
00:00 - 01:00	0	0	0.000	0	0	0.000	0	0	0.000
01:00 - 02:00	0	0	0.000	0	0	0.000	0	0	0.000
02:00 - 03:00	0	0	0.000	0	0	0.000	0	0	0.000
03:00 - 04:00	0	0	0.000	0	0	0.000	0	0	0.000
04:00 - 05:00	0	0	0.000	0	0	0.000	0	0	0.000
05:00 - 06:00	0	0	0.000	0	0	0.000	0	0	0.000
06:00 - 07:00	0	0	0.000	0	0	0.000	0	0	0.000
07:00 - 08:00	0	0	0.000	0	0	0.000	0	0	0.000
08:00 - 09:00	1	5400	0.019	1	5400	0.000	1	5400	0.019
09:00 - 10:00	4	5325	0.183	4	5325	0.052	4	5325	0.235
10:00 - 11:00	5	4630	0.881	5	4630	0.454	5	4630	1.335
11:00 - 12:00	5	4630	1.140	5	4630	0.929	5	4630	2.069
12:00 - 13:00	5	4630	1.339	5	4630	1.132	5	4630	2.471
13:00 - 14:00	5	4630	1.529	5	4630	1.330	5	4630	2.859
14:00 - 15:00	5	4630	1.516	5	4630	1.616	5	4630	3.132
15:00 - 16:00	5	4630	1.024	5	4630	1.542	5	4630	2.566
16:00 - 17:00	5	4630	0.341	5	4630	0.773	5	4630	1.114
17:00 - 18:00	2	4950	0.071	2	4950	0.212	2	4950	0.283
18:00 - 19:00	1	4500	0.000	1	4500	0.022	1	4500	0.022
19:00 - 20:00	0	0	0.000	0	0	0.000	0	0	0.000
20:00 - 21:00	0	0	0.000	0	0	0.000	0	0	0.000
21:00 - 22:00	0	0	0.000	0	0	0.000	0	0	0.000
22:00 - 23:00	0	0	0.000	0	0	0.000	0	0	0.000
23:00 - 24:00	0	0	0.000	0	0	0.000	0	0	0.000
Total Rates:			8.043			8.062			16.105

Parameter summary

Trip rate parameter range selected: 1850 - 7500 (units: sqm)
 Survey date range: 01/01/00 - 18/10/09
 Number of weekdays (Monday-Friday): 0
 Number of Saturdays: 1
 Number of Sundays: 5
 Surveys manually removed from selection: 0

APPENDIX B

**AUTOMATIC TRAFFIC COUNTER
DATA (EXTRACT)**

EXPBYD RUN ON 29MAR10 WITH OPTIONS:- INPUT=JTC10071 DATEFROM=01JAN2009 DATETO=29MAR2010 RAWDATA=N.

Vehicle Class Codes Used:-	Monday	446	555	507	494	500.5	Monday	410	555	440	585	498		
CCE1 = E1	Tuesday	449	541	532	584	526.5	Tuesday	426	539	458	501	481		
CCE2 = E2	Wednesday	478	565	496	559	524.5	Wednesday	419	556	506	518	500		
CCE3 = E3	Thursday	518	512	524	544	524.5	Thursday	450	483	489	490	478		
CCE4 = E4						519						489		
CCE5 = E5	Sunday	491	433	434	372	415	429	Sunday	432	440	379	384	376	402
CCE6 = E6														

HOURLY BY DAY FOR SITE JTC10071 FROM 01JAN2009 TO 29MAR2010. (VALID AND PATCHED DATA ONLY)

Site Code	Route	Link Code	Magent	Date	Time	Counts						Counts							
						North						South							
						Lane A						Lane A							
						CCE1	CCE2	CCE3	CCE4	CCE5	CCE6	CCE1	CCE2	CCE3	CCE4	CCE5	CCE6		
JTC10071	A78	140250	Friday	01MAY2009	00:00 - 01:00	0	20	0	0	0	0	20	0	25	0	0	0	0	25
JTC10071	A78	140250	Friday	01MAY2009	01:00 - 02:00	0	14	0	0	0	0	14	0	22	0	2	0	0	24
JTC10071	A78	140250	Friday	01MAY2009	02:00 - 03:00	0	3	0	1	0	0	4	0	11	0	0	0	0	11
JTC10071	A78	140250	Friday	01MAY2009	03:00 - 04:00	0	5	0	1	0	0	6	0	3	0	1	0	0	4
JTC10071	A78	140250	Friday	01MAY2009	04:00 - 05:00	0	1	0	2	0	0	3	0	7	0	3	0	0	10
JTC10071	A78	140250	Friday	01MAY2009	05:00 - 06:00	0	20	0	4	1	0	25	0	23	0	2	0	0	25
JTC10071	A78	140250	Friday	01MAY2009	06:00 - 07:00	1	89	0	12	0	2	104	0	82	0	7	6	1	96
JTC10071	A78	140250	Friday	01MAY2009	07:00 - 08:00	1	264	0	25	7	2	299	5	324	1	22	6	3	361
JTC10071	A78	140250	Friday	01MAY2009	08:00 - 09:00	3	359	1	39	6	1	409	1	335	1	21	1	2	361
JTC10071	A78	140250	Friday	01MAY2009	09:00 - 10:00	11	258	3	42	9	2	325	1	206	3	28	1	2	241
JTC10071	A78	140250	Friday	01MAY2009	10:00 - 11:00	18	252	0	47	4	2	323	0	246	1	43	8	4	302
JTC10071	A78	140250	Friday	01MAY2009	11:00 - 12:00	9	269	1	46	2	2	329	1	272	4	58	4	1	340
JTC10071	A78	140250	Friday	01MAY2009	12:00 - 13:00	2	318	3	31	8	2	364	0	284	1	32	4	2	323
JTC10071	A78	140250	Friday	01MAY2009	13:00 - 14:00	3	341	2	29	5	4	384	2	328	1	41	3	2	377
JTC10071	A78	140250	Friday	01MAY2009	14:00 - 15:00	5	352	3	28	1	2	391	3	363	2	46	5	6	425
JTC10071	A78	140250	Friday	01MAY2009	15:00 - 16:00	10	448	0	24	1	1	484	3	419	2	41	1	2	468
JTC10071	A78	140250	Friday	01MAY2009	16:00 - 17:00	5	450	1	19	0	2	477	2	377	4	16	6	2	407
JTC10071	A78	140250	Friday	01MAY2009	17:00 - 18:00	4	404	0	11	0	2	421	2	421	2	16	0	1	442
JTC10071	A78	140250	Friday	01MAY2009	18:00 - 19:00	3	342	2	11	1	3	362	1	267	1	10	0	3	282
JTC10071	A78	140250	Friday	01MAY2009	19:00 - 20:00	1	213	0	7	0	0	221	1	221	0	6	0	2	230
JTC10071	A78	140250	Friday	01MAY2009	20:00 - 21:00	0	181	0	6	2	0	189	3	175	0	4	1	1	184
JTC10071	A78	140250	Friday	01MAY2009	21:00 - 22:00	0	123	1	2	0	0	126	1	112	1	3	0	0	117
JTC10071	A78	140250	Friday	01MAY2009	22:00 - 23:00	0	78	0	4	0	0	82	0	114	0	4	0	0	118
JTC10071	A78	140250	Friday	01MAY2009	23:00 - 24:00	0	65	0	0	0	0	65	1	71	0	1	0	0	73
JTC10071	A78	140250	Saturday	02MAY2009	00:00 - 01:00	0	36	0	1	0	0	37	0	45	0	0	0	0	45
JTC10071	A78	140250	Saturday	02MAY2009	01:00 - 02:00	1	32	0	0	0	0	33	0	30	0	5	0	0	35
JTC10071	A78	140250	Saturday	02MAY2009	02:00 - 03:00	0	15	0	1	1	0	17	0	26	0	0	0	0	26
JTC10071	A78	140250	Saturday	02MAY2009	03:00 - 04:00	0	17	0	1	0	0	18	0	18	0	2	0	0	20
JTC10071	A78	140250	Saturday	02MAY2009	04:00 - 05:00	0	8	0	3	0	0	11	0	11	0	4	0	0	15
JTC10071	A78	140250	Saturday	02MAY2009	05:00 - 06:00	0	16	0	1	0	0	17	0	19	0	1	0	0	20
JTC10071	A78	140250	Saturday	02MAY2009	06:00 - 07:00	0	53	0	2	0	2	57	1	25	0	4	0	1	31
JTC10071	A78	140250	Saturday	02MAY2009	07:00 - 08:00	1	106	1	5	0	2	115	1	77	0	3	0	1	82
JTC10071	A78	140250	Saturday	02MAY2009	08:00 - 09:00	1	168	2	13	1	1	186	0	134	0	13	1	1	149
JTC10071	A78	140250	Saturday	02MAY2009	09:00 - 10:00	4	275	3	14	0	2	298	1	214	3	11	2	1	232
JTC10071	A78	140250	Saturday	02MAY2009	10:00 - 11:00	7	323	1	12	1	2	346	4	278	0	15	0	2	299
JTC10071	A78	140250	Saturday	02MAY2009	11:00 - 12:00	10	383	1	8	0	3	405	4	341	3	15	0	2	365
JTC10071	A78	140250	Saturday	02MAY2009	12:00 - 13:00	10	455	1	13	0	3	482	6	369	1	6	0	2	384
JTC10071	A78	140250	Saturday	02MAY2009	13:00 - 14:00	8	428	2	10	0	2	450	9	359	2	4	0	2	376
JTC10071	A78	140250	Saturday	02MAY2009	14:00 - 15:00	10	428	2	11	0	2	453	11	396	1	9	0	0	417
JTC10071	A78	140250	Saturday	02MAY2009	15:00 - 16:00	15	387	0	3	1	1	407	4	331	1	1	0	3	340
JTC10071	A78	140250	Saturday	02MAY2009	16:00 - 17:00	8	395	0	4	0	2	409	14	522	1	9	0	4	550

JTC10071	A78	140250	Saturday	02MAY2009	17:00 - 18:00	11	377	0	2	0	2	392	11	454	1	6	0	0	472
JTC10071	A78	140250	Saturday	02MAY2009	18:00 - 19:00	4	327	0	7	0	3	341	6	323	0	5	0	3	337
JTC10071	A78	140250	Saturday	02MAY2009	19:00 - 20:00	12	232	1	3	0	0	248	4	260	2	5	0	4	275
JTC10071	A78	140250	Saturday	02MAY2009	20:00 - 21:00	4	164	0	5	0	0	173	12	211	0	4	0	1	228
JTC10071	A78	140250	Saturday	02MAY2009	21:00 - 22:00	0	106	0	4	0	0	110	1	126	0	2	1	0	130
JTC10071	A78	140250	Saturday	02MAY2009	22:00 - 23:00	0	93	1	1	0	0	95	0	120	1	2	0	0	123
JTC10071	A78	140250	Saturday	02MAY2009	23:00 - 24:00	0	67	0	4	0	0	71	1	82	0	0	0	0	83
JTC10071	A78	140250	Sunday	03MAY2009	00:00 - 01:00	0	33	0	0	0	0	33	0	31	0	1	0	0	32
JTC10071	A78	140250	Sunday	03MAY2009	01:00 - 02:00	0	32	0	2	0	1	35	0	39	0	1	0	1	41
JTC10071	A78	140250	Sunday	03MAY2009	02:00 - 03:00	0	28	0	1	0	0	29	0	26	0	0	0	0	26
JTC10071	A78	140250	Sunday	03MAY2009	03:00 - 04:00	0	14	0	0	0	0	14	0	15	0	0	0	0	15
JTC10071	A78	140250	Sunday	03MAY2009	04:00 - 05:00	0	6	0	0	0	0	6	0	5	0	0	0	0	5
JTC10071	A78	140250	Sunday	03MAY2009	05:00 - 06:00	0	11	0	2	1	0	14	0	23	0	2	0	0	25
JTC10071	A78	140250	Sunday	03MAY2009	06:00 - 07:00	0	32	1	1	0	0	34	0	24	0	2	0	0	26
JTC10071	A78	140250	Sunday	03MAY2009	07:00 - 08:00	0	84	0	1	2	0	87	1	59	0	3	0	0	63
JTC10071	A78	140250	Sunday	03MAY2009	08:00 - 09:00	0	91	1	2	1	0	95	3	89	0	6	0	0	98
JTC10071	A78	140250	Sunday	03MAY2009	09:00 - 10:00	1	160	2	3	0	1	167	4	168	0	8	1	1	182
JTC10071	A78	140250	Sunday	03MAY2009	10:00 - 11:00	4	214	1	9	0	1	229	2	247	1	9	1	0	260
JTC10071	A78	140250	Sunday	03MAY2009	11:00 - 12:00	11	347	2	5	0	1	366	3	266	1	3	2	1	276
JTC10071	A78	140250	Sunday	03MAY2009	12:00 - 13:00	11	431	0	9	0	1	452	4	360	0	6	1	0	371
JTC10071	A78	140250	Sunday	03MAY2009	13:00 - 14:00	9	505	1	6	0	2	523	4	398	1	6	0	0	409
JTC10071	A78	140250	Sunday	03MAY2009	14:00 - 15:00	11	472	2	5	0	1	491	4	422	1	4	0	1	432
JTC10071	A78	140250	Sunday	03MAY2009	15:00 - 16:00	9	479	0	6	0	1	495	4	407	1	5	1	0	418
JTC10071	A78	140250	Sunday	03MAY2009	16:00 - 17:00	12	397	0	4	0	0	413	11	494	2	6	0	2	515
JTC10071	A78	140250	Sunday	03MAY2009	17:00 - 18:00	13	301	1	5	0	1	321	20	441	0	2	1	0	464
JTC10071	A78	140250	Sunday	03MAY2009	18:00 - 19:00	4	264	1	4	0	0	273	4	277	1	5	0	3	290
JTC10071	A78	140250	Sunday	03MAY2009	19:00 - 20:00	4	213	1	3	0	1	222	4	209	1	1	0	1	216
JTC10071	A78	140250	Sunday	03MAY2009	20:00 - 21:00	5	146	1	1	0	0	153	2	196	1	1	0	0	200
JTC10071	A78	140250	Sunday	03MAY2009	21:00 - 22:00	0	102	1	1	0	0	104	0	125	0	6	0	0	131
JTC10071	A78	140250	Sunday	03MAY2009	22:00 - 23:00	0	64	0	0	0	0	64	0	72	0	1	0	0	73
JTC10071	A78	140250	Sunday	03MAY2009	23:00 - 24:00	0	47	0	1	0	0	48	0	40	0	0	0	0	40
JTC10071	A78	140250	Monday	04MAY2009	00:00 - 01:00	0	28	0	0	0	0	28	0	28	0	1	0	0	29
JTC10071	A78	140250	Monday	04MAY2009	01:00 - 02:00	0	14	0	1	0	0	15	0	15	0	2	0	0	17
JTC10071	A78	140250	Monday	04MAY2009	02:00 - 03:00	0	8	0	1	0	0	9	0	14	0	0	0	0	14
JTC10071	A78	140250	Monday	04MAY2009	03:00 - 04:00	0	9	0	0	0	0	9	0	4	0	3	0	0	7
JTC10071	A78	140250	Monday	04MAY2009	04:00 - 05:00	0	8	0	4	0	0	12	0	8	0	3	0	0	11
JTC10071	A78	140250	Monday	04MAY2009	05:00 - 06:00	0	21	0	2	1	0	24	0	21	0	0	0	0	21
JTC10071	A78	140250	Monday	04MAY2009	06:00 - 07:00	0	54	0	5	0	2	61	0	34	0	3	2	1	40
JTC10071	A78	140250	Monday	04MAY2009	07:00 - 08:00	0	129	1	6	0	2	138	2	191	1	8	1	1	204
JTC10071	A78	140250	Monday	04MAY2009	08:00 - 09:00	4	166	3	20	1	2	196	1	153	0	13	0	1	168
JTC10071	A78	140250	Monday	04MAY2009	09:00 - 10:00	0	183	1	22	3	2	211	0	163	3	17	0	1	184
JTC10071	A78	140250	Monday	04MAY2009	10:00 - 11:00	0	277	1	18	1	3	300	6	248	1	16	5	5	281
JTC10071	A78	140250	Monday	04MAY2009	11:00 - 12:00	1	330	3	13	3	2	352	2	273	1	13	1	2	292
JTC10071	A78	140250	Monday	04MAY2009	12:00 - 13:00	2	344	2	14	5	3	370	2	353	1	23	1	2	382
JTC10071	A78	140250	Monday	04MAY2009	13:00 - 14:00	2	354	3	19	1	2	381	10	383	1	8	2	2	406
JTC10071	A78	140250	Monday	04MAY2009	14:00 - 15:00	1	384	3	7	1	2	398	0	389	5	9	1	2	406
JTC10071	A78	140250	Monday	04MAY2009	15:00 - 16:00	0	336	0	13	0	1	350	5	382	1	13	3	2	406
JTC10071	A78	140250	Monday	04MAY2009	16:00 - 17:00	2	433	0	7	0	4	446	1	399	1	7	0	2	410
JTC10071	A78	140250	Monday	04MAY2009	17:00 - 18:00	0	315	0	10	1	3	329	8	373	0	11	3	1	396
JTC10071	A78	140250	Monday	04MAY2009	18:00 - 19:00	0	246	1	2	0	1	250	0	263	0	1	0	3	267
JTC10071	A78	140250	Monday	04MAY2009	19:00 - 20:00	2	154	0	1	0	1	158	0	189	0	2	0	2	193
JTC10071	A78	140250	Monday	04MAY2009	20:00 - 21:00	0	151	0	1	0	1	153	3	134	1	2	0	1	141
JTC10071	A78	140250	Monday	04MAY2009	21:00 - 22:00	0	81	0	3	0	0	84	0	103	0	2	0	0	105
JTC10071	A78	140250	Monday	04MAY2009	22:00 - 23:00	1	54	0	2	0	0	57	0	72	0	3	0	0	75
JTC10071	A78	140250	Monday	04MAY2009	23:00 - 24:00	0	34	0	2	0	0	36	1	28	0	0	0	0	29
JTC10071	A78	140250	Tuesday	05MAY2009	00:00 - 01:00	0	24	0	1	0	0	25	0	18	0	1	0	0	19
JTC10071	A78	140250	Tuesday	05MAY2009	01:00 - 02:00	0	6	0	0	0	0	6	0	6	0	2	0	0	8
JTC10071	A78	140250	Tuesday	05MAY2009	02:00 - 03:00	0	4	0	1	0	0	5	0	4	0	0	0	0	4

JTC10071	A78	140250	Tuesday	05MAY2009	03:00 - 04:00	0	1	0	2	0	0	3	0	3	0	2	0	0	5
JTC10071	A78	140250	Tuesday	05MAY2009	04:00 - 05:00	0	10	0	2	0	0	12	0	5	0	4	0	0	9
JTC10071	A78	140250	Tuesday	05MAY2009	05:00 - 06:00	0	34	0	2	1	0	37	0	28	0	4	0	0	32
JTC10071	A78	140250	Tuesday	05MAY2009	06:00 - 07:00	0	102	0	6	0	2	110	0	69	1	8	1	1	80
JTC10071	A78	140250	Tuesday	05MAY2009	07:00 - 08:00	1	286	1	22	7	4	321	7	325	2	15	2	1	352
JTC10071	A78	140250	Tuesday	05MAY2009	08:00 - 09:00	1	412	1	46	4	4	468	0	405	3	33	2	3	446
JTC10071	A78	140250	Tuesday	05MAY2009	09:00 - 10:00	0	317	6	49	2	2	376	0	231	3	45	4	2	285
JTC10071	A78	140250	Tuesday	05MAY2009	10:00 - 11:00	0	275	3	47	1	3	329	6	233	2	31	8	4	284
JTC10071	A78	140250	Tuesday	05MAY2009	11:00 - 12:00	0	263	1	37	7	2	310	6	298	2	41	7	2	356
JTC10071	A78	140250	Tuesday	05MAY2009	12:00 - 13:00	0	274	5	32	7	2	320	6	307	2	32	2	2	351
JTC10071	A78	140250	Tuesday	05MAY2009	13:00 - 14:00	7	283	4	38	5	2	339	3	302	3	30	4	4	346
JTC10071	A78	140250	Tuesday	05MAY2009	14:00 - 15:00	0	271	1	36	9	2	319	1	329	1	33	5	2	371
JTC10071	A78	140250	Tuesday	05MAY2009	15:00 - 16:00	1	327	1	26	0	4	359	3	372	4	36	6	6	427
JTC10071	A78	140250	Tuesday	05MAY2009	16:00 - 17:00	1	419	2	21	3	3	449	2	389	1	30	1	3	426
JTC10071	A78	140250	Tuesday	05MAY2009	17:00 - 18:00	3	486	1	16	1	3	510	1	407	0	12	3	1	424
JTC10071	A78	140250	Tuesday	05MAY2009	18:00 - 19:00	1	295	1	4	2	2	305	3	283	0	9	0	3	298
JTC10071	A78	140250	Tuesday	05MAY2009	19:00 - 20:00	0	179	0	5	0	0	184	0	213	0	3	0	2	218
JTC10071	A78	140250	Tuesday	05MAY2009	20:00 - 21:00	1	119	0	3	0	0	123	0	117	0	5	2	1	125
JTC10071	A78	140250	Tuesday	05MAY2009	21:00 - 22:00	0	117	0	4	0	0	121	0	122	0	2	0	0	124
JTC10071	A78	140250	Tuesday	05MAY2009	22:00 - 23:00	0	64	0	2	1	0	67	0	82	0	2	0	0	84
JTC10071	A78	140250	Tuesday	05MAY2009	23:00 - 24:00	0	36	0	1	1	0	38	0	41	0	2	2	0	45
JTC10071	A78	140250	Wednesday	06MAY2009	00:00 - 01:00	0	18	0	0	0	0	18	0	14	0	0	0	0	14
JTC10071	A78	140250	Wednesday	06MAY2009	01:00 - 02:00	0	5	0	0	0	0	5	0	4	0	1	0	0	5
JTC10071	A78	140250	Wednesday	06MAY2009	02:00 - 03:00	0	4	0	3	0	0	7	0	2	0	1	0	0	3
JTC10071	A78	140250	Wednesday	06MAY2009	03:00 - 04:00	0	1	0	1	0	0	2	0	2	0	3	0	0	5
JTC10071	A78	140250	Wednesday	06MAY2009	04:00 - 05:00	0	6	0	3	0	0	9	0	7	0	3	0	0	10
JTC10071	A78	140250	Wednesday	06MAY2009	05:00 - 06:00	0	20	0	2	1	0	23	0	29	0	1	0	0	30
JTC10071	A78	140250	Wednesday	06MAY2009	06:00 - 07:00	0	103	0	8	2	2	115	2	76	0	8	2	1	89
JTC10071	A78	140250	Wednesday	06MAY2009	07:00 - 08:00	1	281	0	24	3	4	313	5	350	1	13	1	1	371
JTC10071	A78	140250	Wednesday	06MAY2009	08:00 - 09:00	3	383	1	48	3	4	442	4	388	2	32	3	4	433
JTC10071	A78	140250	Wednesday	06MAY2009	09:00 - 10:00	1	317	1	49	3	2	373	3	244	2	30	3	2	284
JTC10071	A78	140250	Wednesday	06MAY2009	10:00 - 11:00	5	261	6	30	6	3	311	4	227	0	27	4	2	264
JTC10071	A78	140250	Wednesday	06MAY2009	11:00 - 12:00	0	249	1	29	2	2	283	1	296	4	35	4	2	342
JTC10071	A78	140250	Wednesday	06MAY2009	12:00 - 13:00	0	272	4	32	2	2	312	0	299	2	30	5	2	338
JTC10071	A78	140250	Wednesday	06MAY2009	13:00 - 14:00	0	305	2	29	7	2	345	0	304	3	34	1	2	344
JTC10071	A78	140250	Wednesday	06MAY2009	14:00 - 15:00	4	261	3	24	2	3	297	1	288	2	38	7	3	339
JTC10071	A78	140250	Wednesday	06MAY2009	15:00 - 16:00	0	294	1	30	2	3	330	2	366	3	34	2	7	414
JTC10071	A78	140250	Wednesday	06MAY2009	16:00 - 17:00	6	443	2	23	1	3	478	0	383	2	30	1	3	419
JTC10071	A78	140250	Wednesday	06MAY2009	17:00 - 18:00	2	455	1	3	0	3	464	1	392	1	23	1	1	419
JTC10071	A78	140250	Wednesday	06MAY2009	18:00 - 19:00	0	295	1	8	1	2	307	1	298	1	11	0	3	314
JTC10071	A78	140250	Wednesday	06MAY2009	19:00 - 20:00	0	180	0	11	1	0	192	0	197	0	7	1	2	207
JTC10071	A78	140250	Wednesday	06MAY2009	20:00 - 21:00	1	132	0	2	0	0	135	0	142	0	5	0	1	148
JTC10071	A78	140250	Wednesday	06MAY2009	21:00 - 22:00	0	100	0	4	0	0	104	0	90	0	3	0	0	93
JTC10071	A78	140250	Wednesday	06MAY2009	22:00 - 23:00	0	69	0	2	1	0	72	0	66	0	2	0	0	68
JTC10071	A78	140250	Wednesday	06MAY2009	23:00 - 24:00	0	31	0	2	0	0	33	0	43	0	0	1	0	44
JTC10071	A78	140250	Thursday	07MAY2009	00:00 - 01:00	0	18	0	1	0	0	19	0	18	0	0	0	0	18
JTC10071	A78	140250	Thursday	07MAY2009	01:00 - 02:00	0	7	0	1	0	0	8	0	5	0	3	0	0	8
JTC10071	A78	140250	Thursday	07MAY2009	02:00 - 03:00	0	3	0	3	0	0	6	0	4	0	1	0	0	5
JTC10071	A78	140250	Thursday	07MAY2009	03:00 - 04:00	0	3	0	1	0	0	4	0	2	0	3	0	0	5
JTC10071	A78	140250	Thursday	07MAY2009	04:00 - 05:00	0	5	0	5	0	0	10	0	6	0	3	0	0	9
JTC10071	A78	140250	Thursday	07MAY2009	05:00 - 06:00	0	23	0	2	3	0	28	0	26	0	0	0	0	26
JTC10071	A78	140250	Thursday	07MAY2009	06:00 - 07:00	0	103	0	8	1	2	114	2	71	0	8	4	1	86
JTC10071	A78	140250	Thursday	07MAY2009	07:00 - 08:00	1	293	0	26	1	4	325	2	344	0	19	2	1	368
JTC10071	A78	140250	Thursday	07MAY2009	08:00 - 09:00	2	389	2	46	5	4	448	3	387	0	29	3	5	427
JTC10071	A78	140250	Thursday	07MAY2009	09:00 - 10:00	0	322	2	34	2	2	362	1	227	2	36	4	3	273
JTC10071	A78	140250	Thursday	07MAY2009	10:00 - 11:00	1	256	1	45	11	2	316	1	235	0	29	5	5	275
JTC10071	A78	140250	Thursday	07MAY2009	11:00 - 12:00	0	272	0	40	2	2	316	1	252	1	46	3	2	305
JTC10071	A78	140250	Thursday	07MAY2009	12:00 - 13:00	0	260	3	30	3	3	299	1	296	1	42	2	3	345

JTC10071	A78	140250	Thursday	07MAY2009	13:00 - 14:00	0	295	1	30	2	2	330	0	288	0	45	4	3	340
JTC10071	A78	140250	Thursday	07MAY2009	14:00 - 15:00	2	296	2	35	4	3	342	0	314	0	39	7	2	362
JTC10071	A78	140250	Thursday	07MAY2009	15:00 - 16:00	0	302	1	38	3	6	350	1	364	2	49	2	5	423
JTC10071	A78	140250	Thursday	07MAY2009	16:00 - 17:00	3	489	1	20	3	2	518	0	410	2	30	3	5	450
JTC10071	A78	140250	Thursday	07MAY2009	17:00 - 18:00	3	439	0	11	0	4	457	1	455	1	13	0	1	471
JTC10071	A78	140250	Thursday	07MAY2009	18:00 - 19:00	0	356	1	8	1	2	368	0	280	0	7	1	4	292
JTC10071	A78	140250	Thursday	07MAY2009	19:00 - 20:00	0	188	0	4	0	0	192	2	229	0	9	1	2	243
JTC10071	A78	140250	Thursday	07MAY2009	20:00 - 21:00	0	140	0	6	0	0	146	2	193	0	5	0	1	201
JTC10071	A78	140250	Thursday	07MAY2009	21:00 - 22:00	0	99	0	4	0	0	103	0	103	0	5	0	0	108
JTC10071	A78	140250	Thursday	07MAY2009	22:00 - 23:00	0	62	0	3	0	0	65	0	77	0	2	0	0	79
JTC10071	A78	140250	Thursday	07MAY2009	23:00 - 24:00	0	49	0	3	0	0	52	0	32	0	1	0	0	33
JTC10071	A78	140250	Friday	08MAY2009	00:00 - 01:00	0	24	0	1	0	0	25	0	26	0	0	0	0	26
JTC10071	A78	140250	Friday	08MAY2009	01:00 - 02:00	0	15	0	0	0	0	15	0	19	0	1	0	0	20
JTC10071	A78	140250	Friday	08MAY2009	02:00 - 03:00	0	3	0	1	0	0	4	0	4	0	0	0	0	4
JTC10071	A78	140250	Friday	08MAY2009	03:00 - 04:00	0	1	0	1	0	0	2	0	7	0	3	0	0	10
JTC10071	A78	140250	Friday	08MAY2009	04:00 - 05:00	0	8	0	3	0	0	11	0	6	0	3	0	0	9
JTC10071	A78	140250	Friday	08MAY2009	05:00 - 06:00	0	19	0	3	1	0	23	0	24	0	2	0	0	26
JTC10071	A78	140250	Friday	08MAY2009	06:00 - 07:00	0	89	0	6	2	2	99	0	75	0	10	5	1	91
JTC10071	A78	140250	Friday	08MAY2009	07:00 - 08:00	1	281	1	26	4	3	316	4	326	1	19	7	1	358
JTC10071	A78	140250	Friday	08MAY2009	08:00 - 09:00	1	399	3	46	4	5	458	1	367	0	36	4	4	412
JTC10071	A78	140250	Friday	08MAY2009	09:00 - 10:00	0	308	2	40	6	2	358	0	231	1	33	2	2	269
JTC10071	A78	140250	Friday	08MAY2009	10:00 - 11:00	5	226	3	36	1	2	273	0	223	1	29	6	4	263
JTC10071	A78	140250	Friday	08MAY2009	11:00 - 12:00	5	321	5	38	5	4	378	0	266	4	41	5	3	319
JTC10071	A78	140250	Friday	08MAY2009	12:00 - 13:00	0	287	3	36	5	2	333	6	308	1	35	3	2	355
JTC10071	A78	140250	Friday	08MAY2009	13:00 - 14:00	1	344	5	33	5	3	391	0	320	6	35	5	2	368
JTC10071	A78	140250	Friday	08MAY2009	14:00 - 15:00	0	345	3	33	3	4	388	0	360	2	35	7	2	406
JTC10071	A78	140250	Friday	08MAY2009	15:00 - 16:00	1	401	2	21	1	3	429	2	434	2	30	4	7	479
JTC10071	A78	140250	Friday	08MAY2009	16:00 - 17:00	4	470	0	19	3	3	499	4	380	3	23	3	3	416
JTC10071	A78	140250	Friday	08MAY2009	17:00 - 18:00	5	373	0	17	4	2	401	2	439	1	19	1	2	464
JTC10071	A78	140250	Friday	08MAY2009	18:00 - 19:00	1	302	1	8	0	3	315	2	312	0	9	1	2	326
JTC10071	A78	140250	Friday	08MAY2009	19:00 - 20:00	3	227	1	3	0	0	234	0	199	1	6	0	2	208
JTC10071	A78	140250	Friday	08MAY2009	20:00 - 21:00	4	184	0	8	1	1	198	0	151	0	2	0	2	155
JTC10071	A78	140250	Friday	08MAY2009	21:00 - 22:00	0	131	0	5	0	0	136	0	143	0	4	0	0	147
JTC10071	A78	140250	Friday	08MAY2009	22:00 - 23:00	0	91	0	3	0	0	94	0	120	0	3	0	0	123
JTC10071	A78	140250	Friday	08MAY2009	23:00 - 24:00	0	67	0	2	0	0	69	0	84	0	1	0	0	85
JTC10071	A78	140250	Saturday	09MAY2009	00:00 - 01:00	0	38	0	1	0	0	39	0	42	0	3	0	0	45
JTC10071	A78	140250	Saturday	09MAY2009	01:00 - 02:00	0	27	0	1	0	0	28	0	37	0	2	0	0	39
JTC10071	A78	140250	Saturday	09MAY2009	02:00 - 03:00	0	14	0	2	0	0	16	0	18	0	0	0	0	18
JTC10071	A78	140250	Saturday	09MAY2009	03:00 - 04:00	0	8	0	0	0	0	8	0	12	0	1	0	0	13
JTC10071	A78	140250	Saturday	09MAY2009	04:00 - 05:00	0	4	0	2	0	0	6	0	4	0	2	0	0	6
JTC10071	A78	140250	Saturday	09MAY2009	05:00 - 06:00	0	21	0	3	1	0	25	0	16	0	4	0	0	20
JTC10071	A78	140250	Saturday	09MAY2009	06:00 - 07:00	0	45	0	2	0	2	49	0	31	0	3	1	1	36
JTC10071	A78	140250	Saturday	09MAY2009	07:00 - 08:00	0	114	0	8	1	2	125	0	102	3	6	0	1	112
JTC10071	A78	140250	Saturday	09MAY2009	08:00 - 09:00	0	176	2	17	0	2	197	0	152	1	18	0	1	172
JTC10071	A78	140250	Saturday	09MAY2009	09:00 - 10:00	0	219	3	14	0	3	239	0	196	0	14	2	1	213
JTC10071	A78	140250	Saturday	09MAY2009	10:00 - 11:00	3	280	1	13	0	4	301	0	264	1	10	0	3	278
JTC10071	A78	140250	Saturday	09MAY2009	11:00 - 12:00	3	324	1	10	0	2	340	0	305	1	10	1	2	319
JTC10071	A78	140250	Saturday	09MAY2009	12:00 - 13:00	0	310	2	5	0	2	319	1	298	0	10	0	2	311
JTC10071	A78	140250	Saturday	09MAY2009	13:00 - 14:00	2	276	1	5	0	3	287	0	274	4	1	0	2	281
JTC10071	A78	140250	Saturday	09MAY2009	14:00 - 15:00	3	296	2	5	0	2	308	0	292	0	4	0	2	298
JTC10071	A78	140250	Saturday	09MAY2009	15:00 - 16:00	1	353	0	5	1	2	362	1	269	1	1	0	2	274
JTC10071	A78	140250	Saturday	09MAY2009	16:00 - 17:00	1	277	1	4	1	2	286	1	301	3	8	1	4	318
JTC10071	A78	140250	Saturday	09MAY2009	17:00 - 18:00	10	308	1	8	0	3	330	1	332	0	10	0	1	344
JTC10071	A78	140250	Saturday	09MAY2009	18:00 - 19:00	0	258	0	6	0	3	267	1	234	0	5	0	4	244
JTC10071	A78	140250	Saturday	09MAY2009	19:00 - 20:00	0	201	0	5	0	0	206	0	184	0	6	0	2	192
JTC10071	A78	140250	Saturday	09MAY2009	20:00 - 21:00	0	132	0	5	0	0	137	3	161	0	4	0	1	169
JTC10071	A78	140250	Saturday	09MAY2009	21:00 - 22:00	1	99	1	5	0	0	106	2	114	0	4	0	0	120
JTC10071	A78	140250	Saturday	09MAY2009	22:00 - 23:00	0	78	0	1	0	0	79	0	108	0	2	0	0	110

JTC10071	A78	140250	Saturday	09MAY2009	23:00 - 24:00	0	65	0	0	0	0	65	1	87	0	1	0	0	89
JTC10071	A78	140250	Sunday	10MAY2009	00:00 - 01:00	0	50	0	2	0	0	52	0	63	0	0	0	0	63
JTC10071	A78	140250	Sunday	10MAY2009	01:00 - 02:00	0	32	0	0	0	0	32	0	37	1	3	0	0	41
JTC10071	A78	140250	Sunday	10MAY2009	02:00 - 03:00	0	25	0	2	0	0	27	0	30	0	1	0	0	31
JTC10071	A78	140250	Sunday	10MAY2009	03:00 - 04:00	0	16	0	1	0	0	17	0	17	0	0	0	0	17
JTC10071	A78	140250	Sunday	10MAY2009	04:00 - 05:00	0	6	0	1	0	0	7	0	4	0	1	0	0	5
JTC10071	A78	140250	Sunday	10MAY2009	05:00 - 06:00	0	11	0	0	0	0	11	0	19	0	0	0	0	19
JTC10071	A78	140250	Sunday	10MAY2009	06:00 - 07:00	0	38	0	2	0	0	40	0	24	0	5	0	0	29
JTC10071	A78	140250	Sunday	10MAY2009	07:00 - 08:00	2	106	0	2	0	0	110	1	71	1	2	0	0	75
JTC10071	A78	140250	Sunday	10MAY2009	08:00 - 09:00	3	117	1	12	0	0	133	1	108	1	8	0	0	118
JTC10071	A78	140250	Sunday	10MAY2009	09:00 - 10:00	10	181	3	10	1	2	207	5	136	1	3	1	2	148
JTC10071	A78	140250	Sunday	10MAY2009	10:00 - 11:00	6	266	0	6	1	2	281	7	226	0	9	1	0	243
JTC10071	A78	140250	Sunday	10MAY2009	11:00 - 12:00	13	338	1	13	0	0	365	19	288	3	13	1	2	326
JTC10071	A78	140250	Sunday	10MAY2009	12:00 - 13:00	4	405	1	6	1	1	418	11	330	1	11	0	0	353
JTC10071	A78	140250	Sunday	10MAY2009	13:00 - 14:00	20	447	1	13	0	0	481	19	378	2	7	0	0	406
JTC10071	A78	140250	Sunday	10MAY2009	14:00 - 15:00	13	413	1	5	0	1	433	16	413	2	6	1	2	440
JTC10071	A78	140250	Sunday	10MAY2009	15:00 - 16:00	16	421	1	6	0	1	445	9	398	1	5	0	1	414
JTC10071	A78	140250	Sunday	10MAY2009	16:00 - 17:00	9	404	2	8	0	0	423	18	504	1	10	0	2	535
JTC10071	A78	140250	Sunday	10MAY2009	17:00 - 18:00	18	366	1	5	0	2	392	11	418	1	3	1	0	434
JTC10071	A78	140250	Sunday	10MAY2009	18:00 - 19:00	11	297	0	3	0	1	312	10	303	0	5	0	1	319
JTC10071	A78	140250	Sunday	10MAY2009	19:00 - 20:00	12	233	1	0	0	1	247	12	275	0	7	0	1	295
JTC10071	A78	140250	Sunday	10MAY2009	20:00 - 21:00	1	202	0	3	0	0	206	15	240	0	3	0	0	258
JTC10071	A78	140250	Sunday	10MAY2009	21:00 - 22:00	2	114	0	1	0	0	117	4	155	0	2	0	0	161
JTC10071	A78	140250	Sunday	10MAY2009	22:00 - 23:00	1	51	1	0	0	0	53	1	70	0	0	0	0	71
JTC10071	A78	140250	Sunday	10MAY2009	23:00 - 24:00	0	30	0	0	0	0	30	1	37	0	3	0	0	41
JTC10071	A78	140250	Monday	11MAY2009	00:00 - 01:00	0	15	0	1	0	1	17	0	19	0	0	0	0	19
JTC10071	A78	140250	Monday	11MAY2009	01:00 - 02:00	0	5	0	1	0	0	6	0	13	0	2	0	0	15
JTC10071	A78	140250	Monday	11MAY2009	02:00 - 03:00	0	5	0	2	0	0	7	0	5	0	0	0	0	5
JTC10071	A78	140250	Monday	11MAY2009	03:00 - 04:00	0	5	0	1	0	0	6	0	5	0	2	0	0	7
JTC10071	A78	140250	Monday	11MAY2009	04:00 - 05:00	0	8	0	4	0	0	12	0	7	0	4	1	0	12
JTC10071	A78	140250	Monday	11MAY2009	05:00 - 06:00	0	24	0	3	2	0	29	0	30	0	3	0	0	33
JTC10071	A78	140250	Monday	11MAY2009	06:00 - 07:00	0	105	1	9	0	2	117	0	70	1	6	3	1	81
JTC10071	A78	140250	Monday	11MAY2009	07:00 - 08:00	3	273	1	21	4	4	306	7	319	0	19	6	1	352
JTC10071	A78	140250	Monday	11MAY2009	08:00 - 09:00	1	406	3	43	5	4	462	4	394	1	18	2	4	423
JTC10071	A78	140250	Monday	11MAY2009	09:00 - 10:00	2	311	3	34	6	3	359	2	246	2	27	4	4	285
JTC10071	A78	140250	Monday	11MAY2009	10:00 - 11:00	0	308	4	42	4	2	360	1	257	3	35	14	7	317
JTC10071	A78	140250	Monday	11MAY2009	11:00 - 12:00	7	315	2	39	5	4	372	2	265	1	36	7	2	313
JTC10071	A78	140250	Monday	11MAY2009	12:00 - 13:00	6	357	1	42	7	3	416	2	319	3	38	4	2	368
JTC10071	A78	140250	Monday	11MAY2009	13:00 - 14:00	6	389	2	41	5	3	446	5	309	5	28	7	3	357
JTC10071	A78	140250	Monday	11MAY2009	14:00 - 15:00	3	310	0	24	7	3	347	7	349	2	23	2	2	385
JTC10071	A78	140250	Monday	11MAY2009	15:00 - 16:00	7	343	2	24	4	5	385	5	435	3	25	2	6	476
JTC10071	A78	140250	Monday	11MAY2009	16:00 - 17:00	14	512	0	24	2	3	555	7	506	2	36	1	3	555
JTC10071	A78	140250	Monday	11MAY2009	17:00 - 18:00	9	465	1	11	1	2	489	9	467	0	16	5	1	498
JTC10071	A78	140250	Monday	11MAY2009	18:00 - 19:00	19	337	0	8	1	3	368	7	289	2	9	2	2	311
JTC10071	A78	140250	Monday	11MAY2009	19:00 - 20:00	16	224	0	3	0	0	243	10	225	0	8	0	2	245
JTC10071	A78	140250	Monday	11MAY2009	20:00 - 21:00	9	144	1	8	0	0	162	16	220	1	4	0	1	242
JTC10071	A78	140250	Monday	11MAY2009	21:00 - 22:00	2	132	0	2	0	0	136	8	165	0	6	0	0	179
JTC10071	A78	140250	Monday	11MAY2009	22:00 - 23:00	1	85	0	3	0	0	89	2	122	0	3	0	0	127
JTC10071	A78	140250	Monday	11MAY2009	23:00 - 24:00	0	39	0	2	0	0	41	0	42	0	2	0	0	44
JTC10071	A78	140250	Tuesday	12MAY2009	00:00 - 01:00	0	26	0	0	0	0	26	0	18	0	1	1	0	20
JTC10071	A78	140250	Tuesday	12MAY2009	01:00 - 02:00	0	12	0	0	0	0	12	0	9	0	1	0	0	10
JTC10071	A78	140250	Tuesday	12MAY2009	02:00 - 03:00	0	3	0	2	0	0	5	0	2	0	1	0	0	3
JTC10071	A78	140250	Tuesday	12MAY2009	03:00 - 04:00	0	3	0	1	0	0	4	0	1	0	2	0	0	3
JTC10071	A78	140250	Tuesday	12MAY2009	04:00 - 05:00	0	6	0	4	0	0	10	0	6	0	4	0	0	10
JTC10071	A78	140250	Tuesday	12MAY2009	05:00 - 06:00	0	24	0	2	1	0	27	0	27	0	1	0	0	28
JTC10071	A78	140250	Tuesday	12MAY2009	06:00 - 07:00	2	111	0	9	1	2	125	1	70	2	6	1	1	81
JTC10071	A78	140250	Tuesday	12MAY2009	07:00 - 08:00	5	289	2	31	6	4	337	9	312	1	19	1	2	344
JTC10071	A78	140250	Tuesday	12MAY2009	08:00 - 09:00	0	410	7	50	4	4	475	9	423	2	34	1	2	471

JTC10071	A78	140250	Tuesday	12MAY2009	09:00 - 10:00	2	330	1	39	1	2	375	0	246	1	29	2	4	282
JTC10071	A78	140250	Tuesday	12MAY2009	10:00 - 11:00	1	295	1	47	5	2	351	6	236	3	38	3	4	290
JTC10071	A78	140250	Tuesday	12MAY2009	11:00 - 12:00	2	338	7	32	8	2	389	2	303	1	47	4	2	359
JTC10071	A78	140250	Tuesday	12MAY2009	12:00 - 13:00	4	334	1	45	2	2	388	3	326	2	33	10	2	376
JTC10071	A78	140250	Tuesday	12MAY2009	13:00 - 14:00	2	369	2	47	10	2	432	2	355	2	37	1	2	399
JTC10071	A78	140250	Tuesday	12MAY2009	14:00 - 15:00	12	317	3	32	5	3	372	3	366	4	26	12	2	413
JTC10071	A78	140250	Tuesday	12MAY2009	15:00 - 16:00	12	391	3	27	4	4	441	4	401	5	31	2	5	448
JTC10071	A78	140250	Tuesday	12MAY2009	16:00 - 17:00	6	505	1	25	0	4	541	8	497	2	28	1	3	539
JTC10071	A78	140250	Tuesday	12MAY2009	17:00 - 18:00	9	469	0	11	2	3	494	4	506	2	20	1	1	534
JTC10071	A78	140250	Tuesday	12MAY2009	18:00 - 19:00	10	370	1	5	0	3	389	13	321	1	9	1	3	348
JTC10071	A78	140250	Tuesday	12MAY2009	19:00 - 20:00	14	252	2	6	0	0	274	3	259	0	9	0	2	273
JTC10071	A78	140250	Tuesday	12MAY2009	20:00 - 21:00	13	184	0	5	0	0	202	8	227	0	5	1	1	242
JTC10071	A78	140250	Tuesday	12MAY2009	21:00 - 22:00	1	128	0	3	1	0	133	16	192	0	6	0	0	214
JTC10071	A78	140250	Tuesday	12MAY2009	22:00 - 23:00	0	77	0	5	0	0	82	0	101	0	2	0	0	103
JTC10071	A78	140250	Tuesday	12MAY2009	23:00 - 24:00	2	34	0	1	0	0	37	0	39	0	3	1	1	44
JTC10071	A78	140250	Wednesday	13MAY2009	00:00 - 01:00	1	22	0	1	0	0	24	0	18	0	0	0	0	18
JTC10071	A78	140250	Wednesday	13MAY2009	01:00 - 02:00	0	10	0	0	0	0	10	0	8	0	1	0	0	9
JTC10071	A78	140250	Wednesday	13MAY2009	02:00 - 03:00	0	3	0	1	0	0	4	0	3	0	0	0	0	3
JTC10071	A78	140250	Wednesday	13MAY2009	03:00 - 04:00	0	2	0	1	0	0	3	0	0	0	2	0	0	2
JTC10071	A78	140250	Wednesday	13MAY2009	04:00 - 05:00	0	4	0	2	0	0	6	0	6	0	2	0	0	8
JTC10071	A78	140250	Wednesday	13MAY2009	05:00 - 06:00	0	13	0	4	1	0	18	0	30	0	3	0	0	33
JTC10071	A78	140250	Wednesday	13MAY2009	06:00 - 07:00	2	95	0	6	3	2	108	2	60	0	8	1	1	72
JTC10071	A78	140250	Wednesday	13MAY2009	07:00 - 08:00	2	295	1	18	3	4	323	8	312	1	21	4	1	347
JTC10071	A78	140250	Wednesday	13MAY2009	08:00 - 09:00	5	392	4	39	5	4	449	7	425	0	31	6	5	474
JTC10071	A78	140250	Wednesday	13MAY2009	09:00 - 10:00	3	338	1	38	5	2	387	4	231	1	23	3	5	267
JTC10071	A78	140250	Wednesday	13MAY2009	10:00 - 11:00	1	278	3	38	9	3	332	2	245	2	37	3	3	292
JTC10071	A78	140250	Wednesday	13MAY2009	11:00 - 12:00	4	309	2	35	5	3	358	2	312	2	42	8	4	370
JTC10071	A78	140250	Wednesday	13MAY2009	12:00 - 13:00	0	288	1	34	9	3	335	3	288	1	30	5	3	330
JTC10071	A78	140250	Wednesday	13MAY2009	13:00 - 14:00	2	322	0	27	7	2	360	3	326	2	33	9	2	375
JTC10071	A78	140250	Wednesday	13MAY2009	14:00 - 15:00	3	318	2	22	5	7	357	4	341	0	28	8	2	383
JTC10071	A78	140250	Wednesday	13MAY2009	15:00 - 16:00	5	355	2	22	5	3	392	3	388	3	36	2	5	437
JTC10071	A78	140250	Wednesday	13MAY2009	16:00 - 17:00	10	521	0	29	2	3	565	6	505	2	36	4	3	556
JTC10071	A78	140250	Wednesday	13MAY2009	17:00 - 18:00	9	429	1	16	1	3	459	2	466	0	16	2	1	487
JTC10071	A78	140250	Wednesday	13MAY2009	18:00 - 19:00	7	330	0	7	0	3	347	10	334	0	8	0	3	355
JTC10071	A78	140250	Wednesday	13MAY2009	19:00 - 20:00	14	225	0	4	0	0	243	10	216	0	7	0	2	235
JTC10071	A78	140250	Wednesday	13MAY2009	20:00 - 21:00	14	158	0	6	0	0	178	12	153	0	5	0	1	171
JTC10071	A78	140250	Wednesday	13MAY2009	21:00 - 22:00	1	123	1	2	1	0	128	7	138	1	2	0	0	148
JTC10071	A78	140250	Wednesday	13MAY2009	22:00 - 23:00	3	95	0	1	0	0	99	1	84	0	4	0	0	89
JTC10071	A78	140250	Wednesday	13MAY2009	23:00 - 24:00	0	41	0	1	0	0	42	0	40	0	0	1	0	41
JTC10071	A78	140250	Thursday	14MAY2009	00:00 - 01:00	0	18	0	1	0	0	19	0	18	0	0	0	0	18
JTC10071	A78	140250	Thursday	14MAY2009	01:00 - 02:00	0	3	0	1	0	0	4	0	6	0	1	0	0	7
JTC10071	A78	140250	Thursday	14MAY2009	02:00 - 03:00	0	5	0	2	0	0	7	0	3	0	0	0	0	3
JTC10071	A78	140250	Thursday	14MAY2009	03:00 - 04:00	0	3	0	1	0	0	4	0	1	0	2	0	0	3
JTC10071	A78	140250	Thursday	14MAY2009	04:00 - 05:00	0	4	0	2	0	0	6	0	6	0	2	0	0	8
JTC10071	A78	140250	Thursday	14MAY2009	05:00 - 06:00	0	21	0	2	1	0	24	0	30	0	2	0	0	32
JTC10071	A78	140250	Thursday	14MAY2009	06:00 - 07:00	0	98	0	8	2	2	110	1	77	0	5	3	1	87
JTC10071	A78	140250	Thursday	14MAY2009	07:00 - 08:00	2	275	0	22	4	4	307	6	345	0	26	3	2	382
JTC10071	A78	140250	Thursday	14MAY2009	08:00 - 09:00	2	377	2	37	2	4	424	6	362	0	33	4	2	407
JTC10071	A78	140250	Thursday	14MAY2009	09:00 - 10:00	0	305	1	35	4	2	347	0	226	1	29	3	3	262
JTC10071	A78	140250	Thursday	14MAY2009	10:00 - 11:00	0	267	2	43	7	2	321	2	275	3	30	6	3	319
JTC10071	A78	140250	Thursday	14MAY2009	11:00 - 12:00	2	266	3	30	7	2	310	1	266	2	44	6	3	322
JTC10071	A78	140250	Thursday	14MAY2009	12:00 - 13:00	2	314	1	31	4	3	355	1	304	1	27	4	2	339
JTC10071	A78	140250	Thursday	14MAY2009	13:00 - 14:00	2	278	1	35	4	2	322	2	265	2	38	5	2	314
JTC10071	A78	140250	Thursday	14MAY2009	14:00 - 15:00	3	322	2	27	6	3	363	3	317	1	25	6	2	354
JTC10071	A78	140250	Thursday	14MAY2009	15:00 - 16:00	4	323	0	24	3	4	358	6	376	2	31	2	6	423
JTC10071	A78	140250	Thursday	14MAY2009	16:00 - 17:00	3	486	1	18	1	3	512	11	429	1	37	2	3	483
JTC10071	A78	140250	Thursday	14MAY2009	17:00 - 18:00	2	416	1	12	1	3	435	4	452	2	11	3	1	473
JTC10071	A78	140250	Thursday	14MAY2009	18:00 - 19:00	8	374	1	13	0	2	398	5	321	2	9	0	3	340

JTC10071	A78	140250	Thursday	14MAY2009	19:00 - 20:00	7	238	1	5	1	0	252	3	243	0	7	0	3	256
JTC10071	A78	140250	Thursday	14MAY2009	20:00 - 21:00	6	167	0	5	2	0	180	10	201	0	5	0	1	217
JTC10071	A78	140250	Thursday	14MAY2009	21:00 - 22:00	4	126	0	4	1	0	135	5	148	0	3	0	0	156
JTC10071	A78	140250	Thursday	14MAY2009	22:00 - 23:00	0	66	0	2	0	0	68	1	114	0	3	1	0	119
JTC10071	A78	140250	Thursday	14MAY2009	23:00 - 24:00	0	44	0	1	0	0	45	0	40	0	1	0	0	41
JTC10071	A78	140250	Friday	15MAY2009	00:00 - 01:00	1	26	0	0	0	0	27	0	18	0	1	0	0	19
JTC10071	A78	140250	Friday	15MAY2009	01:00 - 02:00	0	7	0	2	0	0	9	0	15	0	2	0	0	17
JTC10071	A78	140250	Friday	15MAY2009	02:00 - 03:00	0	3	0	1	0	0	4	0	8	0	1	0	0	9
JTC10071	A78	140250	Friday	15MAY2009	03:00 - 04:00	0	4	0	1	0	0	5	0	0	0	2	0	0	2
JTC10071	A78	140250	Friday	15MAY2009	04:00 - 05:00	0	5	0	4	0	0	9	0	6	0	4	0	0	10
JTC10071	A78	140250	Friday	15MAY2009	05:00 - 06:00	0	17	0	2	1	0	20	0	31	0	5	0	0	36
JTC10071	A78	140250	Friday	15MAY2009	06:00 - 07:00	0	82	0	8	0	2	92	3	70	1	6	1	1	82
JTC10071	A78	140250	Friday	15MAY2009	07:00 - 08:00	1	264	1	20	1	4	291	2	327	1	22	4	1	357
JTC10071	A78	140250	Friday	15MAY2009	08:00 - 09:00	0	420	3	40	3	4	470	4	374	0	32	1	3	414
JTC10071	A78	140250	Friday	15MAY2009	09:00 - 10:00	2	250	4	38	9	3	306	0	240	1	34	3	3	281
JTC10071	A78	140250	Friday	15MAY2009	10:00 - 11:00	5	291	4	45	6	3	354	2	251	2	42	5	4	306
JTC10071	A78	140250	Friday	15MAY2009	11:00 - 12:00	3	301	2	35	2	2	345	1	291	4	50	5	2	353
JTC10071	A78	140250	Friday	15MAY2009	12:00 - 13:00	4	318	1	39	5	2	369	3	300	2	33	9	2	349
JTC10071	A78	140250	Friday	15MAY2009	13:00 - 14:00	3	326	0	35	7	3	374	5	347	2	28	5	3	390
JTC10071	A78	140250	Friday	15MAY2009	14:00 - 15:00	5	368	2	31	3	4	413	0	404	2	32	5	3	446
JTC10071	A78	140250	Friday	15MAY2009	15:00 - 16:00	3	417	0	23	3	3	449	2	421	1	30	3	6	463
JTC10071	A78	140250	Friday	15MAY2009	16:00 - 17:00	6	462	4	14	3	3	492	3	428	1	17	0	4	453
JTC10071	A78	140250	Friday	15MAY2009	17:00 - 18:00	3	399	0	8	0	2	412	2	429	0	14	0	2	447
JTC10071	A78	140250	Friday	15MAY2009	18:00 - 19:00	0	313	1	7	1	2	324	2	269	2	3	1	3	280
JTC10071	A78	140250	Friday	15MAY2009	19:00 - 20:00	4	245	0	10	1	1	261	0	273	0	9	0	2	284
JTC10071	A78	140250	Friday	15MAY2009	20:00 - 21:00	0	170	0	4	1	1	176	1	131	0	5	1	1	139
JTC10071	A78	140250	Friday	15MAY2009	21:00 - 22:00	1	126	0	3	0	0	130	1	123	1	5	0	0	130
JTC10071	A78	140250	Friday	15MAY2009	22:00 - 23:00	0	84	0	3	0	0	87	0	111	0	3	0	0	114
JTC10071	A78	140250	Friday	15MAY2009	23:00 - 24:00	0	73	0	1	0	0	74	0	99	0	0	0	0	99
JTC10071	A78	140250	Saturday	16MAY2009	00:00 - 01:00	1	40	0	2	0	0	43	0	50	0	0	0	0	50
JTC10071	A78	140250	Saturday	16MAY2009	01:00 - 02:00	0	43	0	0	0	0	43	0	49	0	4	0	0	53
JTC10071	A78	140250	Saturday	16MAY2009	02:00 - 03:00	0	20	0	2	0	0	22	0	22	0	0	0	0	22
JTC10071	A78	140250	Saturday	16MAY2009	03:00 - 04:00	0	8	0	0	0	0	8	0	12	0	1	0	0	13
JTC10071	A78	140250	Saturday	16MAY2009	04:00 - 05:00	0	5	0	1	0	0	6	0	4	0	4	0	0	8
JTC10071	A78	140250	Saturday	16MAY2009	05:00 - 06:00	0	14	0	4	1	0	19	0	16	0	0	0	0	16
JTC10071	A78	140250	Saturday	16MAY2009	06:00 - 07:00	0	43	0	5	2	2	52	0	46	0	3	2	1	52
JTC10071	A78	140250	Saturday	16MAY2009	07:00 - 08:00	0	99	0	8	1	2	110	1	86	2	5	0	2	96
JTC10071	A78	140250	Saturday	16MAY2009	08:00 - 09:00	2	164	0	11	2	1	180	1	123	1	11	1	1	138
JTC10071	A78	140250	Saturday	16MAY2009	09:00 - 10:00	1	262	1	17	0	3	284	0	173	0	11	0	1	185
JTC10071	A78	140250	Saturday	16MAY2009	10:00 - 11:00	3	304	1	12	1	3	324	2	268	1	8	3	2	284
JTC10071	A78	140250	Saturday	16MAY2009	11:00 - 12:00	4	349	1	11	2	2	369	2	340	2	10	1	2	357
JTC10071	A78	140250	Saturday	16MAY2009	12:00 - 13:00	18	396	3	8	0	3	428	7	355	2	8	1	2	375
JTC10071	A78	140250	Saturday	16MAY2009	13:00 - 14:00	0	337	3	6	0	2	348	0	340	2	7	1	2	352
JTC10071	A78	140250	Saturday	16MAY2009	14:00 - 15:00	2	417	3	9	0	2	433	1	370	0	9	0	2	382
JTC10071	A78	140250	Saturday	16MAY2009	15:00 - 16:00	9	387	0	12	0	1	409	4	396	0	7	0	2	409
JTC10071	A78	140250	Saturday	16MAY2009	16:00 - 17:00	9	379	1	7	0	3	399	6	408	1	5	1	4	425
JTC10071	A78	140250	Saturday	16MAY2009	17:00 - 18:00	9	341	0	4	1	2	357	8	391	0	9	0	1	409
JTC10071	A78	140250	Saturday	16MAY2009	18:00 - 19:00	0	270	2	6	0	1	279	3	244	0	4	0	3	254
JTC10071	A78	140250	Saturday	16MAY2009	19:00 - 20:00	5	229	0	4	0	1	239	3	250	1	8	0	2	264
JTC10071	A78	140250	Saturday	16MAY2009	20:00 - 21:00	0	159	0	3	0	0	162	0	170	0	5	0	1	176
JTC10071	A78	140250	Saturday	16MAY2009	21:00 - 22:00	0	80	0	2	1	0	83	0	111	0	4	0	0	115
JTC10071	A78	140250	Saturday	16MAY2009	22:00 - 23:00	0	88	0	3	0	0	91	1	110	0	3	0	0	114
JTC10071	A78	140250	Saturday	16MAY2009	23:00 - 24:00	0	69	0	3	0	0	72	0	88	0	2	0	1	91
JTC10071	A78	140250	Sunday	17MAY2009	00:00 - 01:00	0	56	0	1	0	0	57	0	57	0	0	0	0	57
JTC10071	A78	140250	Sunday	17MAY2009	01:00 - 02:00	0	23	0	0	0	0	23	0	42	0	1	0	0	43
JTC10071	A78	140250	Sunday	17MAY2009	02:00 - 03:00	0	21	0	1	0	0	22	0	31	0	0	0	0	31
JTC10071	A78	140250	Sunday	17MAY2009	03:00 - 04:00	0	12	0	0	0	0	12	0	14	0	0	0	0	14
JTC10071	A78	140250	Sunday	17MAY2009	04:00 - 05:00	0	8	0	0	0	0	8	0	8	0	0	0	0	8

JTC10071	A78	140250	Sunday	17MAY2009	05:00 - 06:00	0	15	1	1	0	0	17	0	18	0	2	0	0	20
JTC10071	A78	140250	Sunday	17MAY2009	06:00 - 07:00	0	31	0	2	0	0	33	0	20	0	4	1	0	25
JTC10071	A78	140250	Sunday	17MAY2009	07:00 - 08:00	0	81	0	2	1	0	84	1	69	0	3	0	0	73
JTC10071	A78	140250	Sunday	17MAY2009	08:00 - 09:00	6	96	0	6	0	1	109	2	89	0	5	1	1	98
JTC10071	A78	140250	Sunday	17MAY2009	09:00 - 10:00	2	172	1	7	1	1	184	0	185	2	3	1	1	192
JTC10071	A78	140250	Sunday	17MAY2009	10:00 - 11:00	5	250	2	7	0	2	266	1	210	1	9	0	0	221
JTC10071	A78	140250	Sunday	17MAY2009	11:00 - 12:00	6	285	2	4	0	0	297	8	247	2	8	1	2	268
JTC10071	A78	140250	Sunday	17MAY2009	12:00 - 13:00	9	417	4	12	0	1	443	7	332	2	4	0	0	345
JTC10071	A78	140250	Sunday	17MAY2009	13:00 - 14:00	3	432	4	5	0	0	444	14	354	2	1	0	0	371
JTC10071	A78	140250	Sunday	17MAY2009	14:00 - 15:00	13	412	2	6	0	1	434	5	361	4	7	1	1	379
JTC10071	A78	140250	Sunday	17MAY2009	15:00 - 16:00	21	406	1	8	0	0	436	19	402	2	3	0	0	426
JTC10071	A78	140250	Sunday	17MAY2009	16:00 - 17:00	8	371	0	7	0	0	386	15	488	0	6	0	0	509
JTC10071	A78	140250	Sunday	17MAY2009	17:00 - 18:00	1	300	0	0	0	1	302	3	381	1	7	1	1	394
JTC10071	A78	140250	Sunday	17MAY2009	18:00 - 19:00	1	199	1	2	0	1	204	3	224	1	4	1	1	234
JTC10071	A78	140250	Sunday	17MAY2009	19:00 - 20:00	1	189	0	4	0	1	195	3	215	0	6	0	1	225
JTC10071	A78	140250	Sunday	17MAY2009	20:00 - 21:00	0	130	0	4	0	0	134	2	146	0	2	0	0	150
JTC10071	A78	140250	Sunday	17MAY2009	21:00 - 22:00	6	82	0	2	0	0	90	2	94	0	2	0	0	98
JTC10071	A78	140250	Sunday	17MAY2009	22:00 - 23:00	1	53	0	0	0	0	54	0	53	0	0	0	0	53
JTC10071	A78	140250	Sunday	17MAY2009	23:00 - 24:00	0	29	0	0	0	0	29	0	39	0	1	0	0	40
JTC10071	A78	140250	Monday	18MAY2009	00:00 - 01:00	0	17	0	4	0	0	21	0	14	0	1	0	0	15
JTC10071	A78	140250	Monday	18MAY2009	01:00 - 02:00	0	8	0	1	0	0	9	0	8	0	1	0	0	9
JTC10071	A78	140250	Monday	18MAY2009	02:00 - 03:00	0	5	0	1	0	0	6	0	7	0	1	0	0	8
JTC10071	A78	140250	Monday	18MAY2009	03:00 - 04:00	0	4	0	1	0	0	5	0	5	0	2	0	0	7
JTC10071	A78	140250	Monday	18MAY2009	04:00 - 05:00	0	9	0	1	1	0	11	0	8	0	3	0	0	11
JTC10071	A78	140250	Monday	18MAY2009	05:00 - 06:00	0	19	0	4	1	0	24	0	23	0	2	0	0	25
JTC10071	A78	140250	Monday	18MAY2009	06:00 - 07:00	0	94	0	7	0	2	103	0	80	0	7	3	1	91
JTC10071	A78	140250	Monday	18MAY2009	07:00 - 08:00	4	290	0	19	2	4	319	4	329	3	30	4	1	371
JTC10071	A78	140250	Monday	18MAY2009	08:00 - 09:00	1	381	5	37	5	4	433	1	376	1	31	4	5	418
JTC10071	A78	140250	Monday	18MAY2009	09:00 - 10:00	0	270	1	36	1	4	312	0	227	2	24	4	3	260
JTC10071	A78	140250	Monday	18MAY2009	10:00 - 11:00	0	267	2	54	8	3	334	0	221	5	36	8	5	275
JTC10071	A78	140250	Monday	18MAY2009	11:00 - 12:00	5	276	1	42	5	2	331	0	237	1	41	6	3	288
JTC10071	A78	140250	Monday	18MAY2009	12:00 - 13:00	2	276	3	36	3	2	322	0	288	1	41	3	3	336
JTC10071	A78	140250	Monday	18MAY2009	13:00 - 14:00	4	272	3	24	4	3	310	0	282	3	35	4	2	326
JTC10071	A78	140250	Monday	18MAY2009	14:00 - 15:00	1	317	1	44	2	3	368	3	344	0	29	6	2	384
JTC10071	A78	140250	Monday	18MAY2009	15:00 - 16:00	6	361	0	25	3	4	399	0	398	1	32	4	6	441
JTC10071	A78	140250	Monday	18MAY2009	16:00 - 17:00	6	469	3	26	1	2	507	2	398	1	32	4	3	440
JTC10071	A78	140250	Monday	18MAY2009	17:00 - 18:00	3	416	1	12	0	3	435	1	445	0	22	5	2	475
JTC10071	A78	140250	Monday	18MAY2009	18:00 - 19:00	2	303	1	9	1	4	320	1	310	0	10	1	3	325
JTC10071	A78	140250	Monday	18MAY2009	19:00 - 20:00	5	193	1	6	1	0	206	3	194	0	4	1	2	204
JTC10071	A78	140250	Monday	18MAY2009	20:00 - 21:00	2	155	0	3	4	0	164	3	165	0	3	0	1	172
JTC10071	A78	140250	Monday	18MAY2009	21:00 - 22:00	1	86	0	7	0	0	94	3	126	0	5	0	0	134
JTC10071	A78	140250	Monday	18MAY2009	22:00 - 23:00	0	62	0	1	0	0	63	1	68	0	3	0	0	72
JTC10071	A78	140250	Monday	18MAY2009	23:00 - 24:00	0	30	0	0	0	0	30	0	30	0	0	0	0	30
JTC10071	A78	140250	Tuesday	19MAY2009	00:00 - 01:00	0	22	0	1	0	0	23	0	18	0	1	0	0	19
JTC10071	A78	140250	Tuesday	19MAY2009	01:00 - 02:00	0	15	0	0	0	0	15	0	6	0	2	0	0	8
JTC10071	A78	140250	Tuesday	19MAY2009	02:00 - 03:00	0	1	0	2	0	0	3	0	4	0	0	0	0	4
JTC10071	A78	140250	Tuesday	19MAY2009	03:00 - 04:00	0	4	0	1	0	0	5	0	3	0	4	0	0	7
JTC10071	A78	140250	Tuesday	19MAY2009	04:00 - 05:00	0	9	0	2	0	0	11	0	8	0	3	0	0	11
JTC10071	A78	140250	Tuesday	19MAY2009	05:00 - 06:00	0	28	0	3	4	0	35	0	25	0	1	0	0	26
JTC10071	A78	140250	Tuesday	19MAY2009	06:00 - 07:00	1	101	0	6	0	2	110	0	68	0	9	3	1	81
JTC10071	A78	140250	Tuesday	19MAY2009	07:00 - 08:00	3	258	1	28	3	4	297	2	322	1	23	0	1	349
JTC10071	A78	140250	Tuesday	19MAY2009	08:00 - 09:00	1	374	1	46	5	4	431	1	402	4	34	4	4	449
JTC10071	A78	140250	Tuesday	19MAY2009	09:00 - 10:00	0	278	3	39	4	3	327	0	221	3	31	5	2	262
JTC10071	A78	140250	Tuesday	19MAY2009	10:00 - 11:00	8	284	1	42	9	3	347	0	219	0	42	9	4	274
JTC10071	A78	140250	Tuesday	19MAY2009	11:00 - 12:00	0	286	2	38	9	2	337	0	252	0	41	8	3	304
JTC10071	A78	140250	Tuesday	19MAY2009	12:00 - 13:00	5	272	2	36	8	2	325	1	318	2	28	4	2	355
JTC10071	A78	140250	Tuesday	19MAY2009	13:00 - 14:00	0	277	1	34	6	2	320	1	290	1	38	6	3	339
JTC10071	A78	140250	Tuesday	19MAY2009	14:00 - 15:00	0	281	1	26	7	3	318	1	274	2	29	7	3	316

JTC10071	A78	140250	Tuesday	19MAY2009	15:00 - 16:00	1	304	2	28	2	3	340	0	337	2	34	7	6	386
JTC10071	A78	140250	Tuesday	19MAY2009	16:00 - 17:00	3	492	4	22	7	4	532	3	422	3	26	1	3	458
JTC10071	A78	140250	Tuesday	19MAY2009	17:00 - 18:00	2	447	0	8	1	2	460	1	446	1	16	5	1	470
JTC10071	A78	140250	Tuesday	19MAY2009	18:00 - 19:00	6	344	0	14	2	2	368	3	330	0	13	1	4	351
JTC10071	A78	140250	Tuesday	19MAY2009	19:00 - 20:00	8	229	2	6	1	1	247	4	196	0	6	1	3	210
JTC10071	A78	140250	Tuesday	19MAY2009	20:00 - 21:00	0	149	0	4	0	0	153	6	198	0	5	1	1	211
JTC10071	A78	140250	Tuesday	19MAY2009	21:00 - 22:00	0	120	0	2	0	1	123	3	142	0	5	0	0	150
JTC10071	A78	140250	Tuesday	19MAY2009	22:00 - 23:00	1	69	0	5	1	0	76	1	96	0	4	0	0	101
JTC10071	A78	140250	Tuesday	19MAY2009	23:00 - 24:00	0	37	0	0	0	0	37	0	43	0	1	2	0	46
JTC10071	A78	140250	Wednesday	20MAY2009	00:00 - 01:00	0	22	0	2	0	0	24	0	17	0	0	0	0	17
JTC10071	A78	140250	Wednesday	20MAY2009	01:00 - 02:00	0	10	0	0	0	0	10	0	11	0	1	0	0	12
JTC10071	A78	140250	Wednesday	20MAY2009	02:00 - 03:00	0	4	0	1	0	0	5	0	4	0	0	0	0	4
JTC10071	A78	140250	Wednesday	20MAY2009	03:00 - 04:00	0	5	0	1	0	0	6	0	1	0	2	0	0	3
JTC10071	A78	140250	Wednesday	20MAY2009	04:00 - 05:00	0	6	0	2	0	0	8	0	5	0	4	0	0	9
JTC10071	A78	140250	Wednesday	20MAY2009	05:00 - 06:00	0	19	0	3	1	0	23	0	29	0	1	1	0	31
JTC10071	A78	140250	Wednesday	20MAY2009	06:00 - 07:00	2	94	0	6	1	2	105	0	76	1	5	4	1	87
JTC10071	A78	140250	Wednesday	20MAY2009	07:00 - 08:00	2	276	0	33	9	3	323	3	338	1	17	6	1	366
JTC10071	A78	140250	Wednesday	20MAY2009	08:00 - 09:00	4	410	3	44	4	5	470	4	399	2	33	2	3	443
JTC10071	A78	140250	Wednesday	20MAY2009	09:00 - 10:00	1	333	2	44	3	2	385	1	230	0	35	7	4	277
JTC10071	A78	140250	Wednesday	20MAY2009	10:00 - 11:00	0	291	2	45	9	2	349	3	200	0	33	3	3	242
JTC10071	A78	140250	Wednesday	20MAY2009	11:00 - 12:00	4	289	1	40	1	3	338	0	278	0	43	7	2	330
JTC10071	A78	140250	Wednesday	20MAY2009	12:00 - 13:00	4	303	2	32	4	2	347	3	276	2	40	2	2	325
JTC10071	A78	140250	Wednesday	20MAY2009	13:00 - 14:00	4	263	2	36	9	2	316	2	322	1	32	2	2	361
JTC10071	A78	140250	Wednesday	20MAY2009	14:00 - 15:00	1	317	2	30	2	4	356	1	357	4	24	10	2	398
JTC10071	A78	140250	Wednesday	20MAY2009	15:00 - 16:00	3	362	2	16	2	4	389	2	397	2	35	3	7	446
JTC10071	A78	140250	Wednesday	20MAY2009	16:00 - 17:00	6	452	1	25	9	3	496	2	463	2	29	7	3	506
JTC10071	A78	140250	Wednesday	20MAY2009	17:00 - 18:00	4	464	1	18	0	2	489	3	435	2	20	0	2	462
JTC10071	A78	140250	Wednesday	20MAY2009	18:00 - 19:00	12	338	0	7	0	2	359	2	321	0	8	2	2	335
JTC10071	A78	140250	Wednesday	20MAY2009	19:00 - 20:00	5	213	0	5	1	1	225	6	206	0	3	0	2	217
JTC10071	A78	140250	Wednesday	20MAY2009	20:00 - 21:00	3	159	1	8	1	0	172	9	185	0	6	1	1	202
JTC10071	A78	140250	Wednesday	20MAY2009	21:00 - 22:00	1	137	1	1	0	0	140	2	155	1	4	0	0	162
JTC10071	A78	140250	Wednesday	20MAY2009	22:00 - 23:00	0	100	0	2	0	0	102	0	108	0	6	0	0	114
JTC10071	A78	140250	Wednesday	20MAY2009	23:00 - 24:00	0	63	0	0	0	0	63	0	63	0	1	0	0	64
JTC10071	A78	140250	Thursday	21MAY2009	00:00 - 01:00	0	20	0	1	0	0	21	0	32	0	0	0	0	32
JTC10071	A78	140250	Thursday	21MAY2009	01:00 - 02:00	0	12	0	1	0	0	13	0	6	0	0	0	0	6
JTC10071	A78	140250	Thursday	21MAY2009	02:00 - 03:00	0	3	0	0	0	0	3	0	2	0	1	0	0	3
JTC10071	A78	140250	Thursday	21MAY2009	03:00 - 04:00	0	5	0	3	0	0	8	0	2	0	2	0	0	4
JTC10071	A78	140250	Thursday	21MAY2009	04:00 - 05:00	0	7	0	2	0	0	9	0	9	0	2	0	0	11
JTC10071	A78	140250	Thursday	21MAY2009	05:00 - 06:00	0	30	0	4	1	0	35	0	29	0	2	0	0	31
JTC10071	A78	140250	Thursday	21MAY2009	06:00 - 07:00	0	92	0	7	0	2	101	1	80	1	6	3	1	92
JTC10071	A78	140250	Thursday	21MAY2009	07:00 - 08:00	3	274	0	27	3	3	310	4	333	0	28	7	1	373
JTC10071	A78	140250	Thursday	21MAY2009	08:00 - 09:00	2	407	4	42	5	5	465	5	399	1	27	2	4	438
JTC10071	A78	140250	Thursday	21MAY2009	09:00 - 10:00	9	307	3	25	5	2	351	1	253	1	41	4	4	304
JTC10071	A78	140250	Thursday	21MAY2009	10:00 - 11:00	2	312	1	57	10	2	384	2	211	1	35	4	5	258
JTC10071	A78	140250	Thursday	21MAY2009	11:00 - 12:00	2	273	5	34	5	3	322	1	272	1	31	9	2	316
JTC10071	A78	140250	Thursday	21MAY2009	12:00 - 13:00	6	351	3	32	7	3	402	4	335	2	34	10	2	387
JTC10071	A78	140250	Thursday	21MAY2009	13:00 - 14:00	5	301	0	26	9	3	344	2	316	2	24	5	2	351
JTC10071	A78	140250	Thursday	21MAY2009	14:00 - 15:00	10	315	1	29	4	3	362	6	350	2	34	1	3	396
JTC10071	A78	140250	Thursday	21MAY2009	15:00 - 16:00	2	366	2	28	2	3	403	11	384	2	40	8	6	451
JTC10071	A78	140250	Thursday	21MAY2009	16:00 - 17:00	6	488	1	24	2	3	524	8	444	2	29	3	3	489
JTC10071	A78	140250	Thursday	21MAY2009	17:00 - 18:00	7	452	0	15	5	2	481	6	409	0	17	5	1	438
JTC10071	A78	140250	Thursday	21MAY2009	18:00 - 19:00	21	329	0	6	1	3	360	0	313	0	10	2	3	328
JTC10071	A78	140250	Thursday	21MAY2009	19:00 - 20:00	9	229	0	5	3	1	247	7	252	1	6	0	2	268
JTC10071	A78	140250	Thursday	21MAY2009	20:00 - 21:00	3	193	2	3	0	0	201	7	207	1	2	0	1	218
JTC10071	A78	140250	Thursday	21MAY2009	21:00 - 22:00	2	132	0	4	0	0	138	8	155	0	2	0	0	165
JTC10071	A78	140250	Thursday	21MAY2009	22:00 - 23:00	2	76	0	2	0	0	80	1	93	0	2	0	0	96
JTC10071	A78	140250	Thursday	21MAY2009	23:00 - 24:00	1	52	0	1	0	0	54	2	59	0	0	0	0	61
JTC10071	A78	140250	Friday	22MAY2009	00:00 - 01:00	0	46	0	0	0	0	46	0	52	0	0	0	0	52

JTC10071	A78	140250	Sunday	24MAY2009	11:00 - 12:00	24	374	1	12	0	0	411	7	264	1	15	1	1	289
JTC10071	A78	140250	Sunday	24MAY2009	12:00 - 13:00	10	454	2	8	0	1	475	13	324	1	8	0	1	347
JTC10071	A78	140250	Sunday	24MAY2009	13:00 - 14:00	6	410	0	1	0	2	419	9	339	2	4	0	0	354
JTC10071	A78	140250	Sunday	24MAY2009	14:00 - 15:00	12	357	0	2	0	1	372	11	366	0	5	1	1	384
JTC10071	A78	140250	Sunday	24MAY2009	15:00 - 16:00	10	329	3	3	0	0	345	13	381	3	7	0	0	404
JTC10071	A78	140250	Sunday	24MAY2009	16:00 - 17:00	3	372	0	2	1	0	378	36	399	0	3	0	1	439
JTC10071	A78	140250	Sunday	24MAY2009	17:00 - 18:00	5	260	0	4	0	1	270	4	355	0	4	1	1	365
JTC10071	A78	140250	Sunday	24MAY2009	18:00 - 19:00	3	228	1	6	0	0	238	4	262	1	2	0	1	270
JTC10071	A78	140250	Sunday	24MAY2009	19:00 - 20:00	4	170	0	3	0	1	178	5	204	0	3	0	1	213
JTC10071	A78	140250	Sunday	24MAY2009	20:00 - 21:00	4	143	0	1	0	0	148	4	167	0	3	0	0	174
JTC10071	A78	140250	Sunday	24MAY2009	21:00 - 22:00	0	88	0	1	0	0	89	4	111	0	1	0	0	116
JTC10071	A78	140250	Sunday	24MAY2009	22:00 - 23:00	1	63	0	0	0	0	64	0	77	0	0	0	0	77
JTC10071	A78	140250	Sunday	24MAY2009	23:00 - 24:00	0	58	0	0	0	0	58	0	43	0	1	0	0	44
JTC10071	A78	140250	Monday	25MAY2009	00:00 - 01:00	0	42	0	1	0	0	43	0	40	0	1	0	0	41
JTC10071	A78	140250	Monday	25MAY2009	01:00 - 02:00	0	13	0	1	0	0	14	0	6	0	1	0	0	7
JTC10071	A78	140250	Monday	25MAY2009	02:00 - 03:00	0	9	0	1	0	0	10	0	14	0	1	0	0	15
JTC10071	A78	140250	Monday	25MAY2009	03:00 - 04:00	0	10	0	0	0	0	10	0	9	0	1	0	0	10
JTC10071	A78	140250	Monday	25MAY2009	04:00 - 05:00	0	9	0	2	0	0	11	0	11	0	2	0	0	13
JTC10071	A78	140250	Monday	25MAY2009	05:00 - 06:00	0	16	0	4	1	2	23	0	23	0	2	0	0	25
JTC10071	A78	140250	Monday	25MAY2009	06:00 - 07:00	0	76	0	8	0	2	86	0	47	0	9	2	1	59
JTC10071	A78	140250	Monday	25MAY2009	07:00 - 08:00	0	174	1	12	6	2	195	6	223	0	22	7	2	260
JTC10071	A78	140250	Monday	25MAY2009	08:00 - 09:00	2	239	2	34	6	1	284	0	210	1	21	3	0	235
JTC10071	A78	140250	Monday	25MAY2009	09:00 - 10:00	10	239	1	27	4	2	283	4	170	5	14	5	1	199
JTC10071	A78	140250	Monday	25MAY2009	10:00 - 11:00	8	304	3	42	2	2	361	13	247	1	23	3	5	292
JTC10071	A78	140250	Monday	25MAY2009	11:00 - 12:00	8	374	3	28	5	2	420	1	325	3	24	3	2	358
JTC10071	A78	140250	Monday	25MAY2009	12:00 - 13:00	3	480	3	28	4	3	521	1	355	2	19	5	2	384
JTC10071	A78	140250	Monday	25MAY2009	13:00 - 14:00	3	447	1	23	4	2	480	8	392	1	15	1	2	419
JTC10071	A78	140250	Monday	25MAY2009	14:00 - 15:00	5	398	1	16	2	2	424	4	413	1	20	2	3	443
JTC10071	A78	140250	Monday	25MAY2009	15:00 - 16:00	0	380	1	27	0	1	409	1	524	0	30	0	2	557
JTC10071	A78	140250	Monday	25MAY2009	16:00 - 17:00	6	474	2	10	0	2	494	1	552	5	24	0	3	585
JTC10071	A78	140250	Monday	25MAY2009	17:00 - 18:00	10	341	0	3	0	3	357	1	434	1	16	1	1	454
JTC10071	A78	140250	Monday	25MAY2009	18:00 - 19:00	3	287	0	7	0	1	298	2	301	0	6	0	3	312
JTC10071	A78	140250	Monday	25MAY2009	19:00 - 20:00	1	179	0	5	0	1	186	0	187	0	6	0	2	195
JTC10071	A78	140250	Monday	25MAY2009	20:00 - 21:00	1	122	0	1	1	0	125	0	148	0	3	0	1	152
JTC10071	A78	140250	Monday	25MAY2009	21:00 - 22:00	1	80	0	3	0	0	84	0	117	0	3	0	0	120
JTC10071	A78	140250	Monday	25MAY2009	22:00 - 23:00	1	66	0	2	0	0	69	1	76	0	3	0	0	80
JTC10071	A78	140250	Monday	25MAY2009	23:00 - 24:00	0	33	0	2	0	0	35	0	31	0	1	0	0	32
JTC10071	A78	140250	Tuesday	26MAY2009	00:00 - 01:00	0	25	0	3	0	0	28	0	15	0	2	0	0	17
JTC10071	A78	140250	Tuesday	26MAY2009	01:00 - 02:00	0	5	0	2	0	0	7	0	5	0	0	0	0	5
JTC10071	A78	140250	Tuesday	26MAY2009	02:00 - 03:00	0	0	0	1	0	0	1	0	1	0	2	0	0	3
JTC10071	A78	140250	Tuesday	26MAY2009	03:00 - 04:00	0	1	0	1	0	0	2	0	1	0	3	0	0	4
JTC10071	A78	140250	Tuesday	26MAY2009	04:00 - 05:00	0	6	0	2	0	0	8	0	7	0	3	0	0	10
JTC10071	A78	140250	Tuesday	26MAY2009	05:00 - 06:00	0	24	0	4	1	0	29	0	23	0	1	0	0	24
JTC10071	A78	140250	Tuesday	26MAY2009	06:00 - 07:00	1	101	0	8	3	2	115	0	73	0	6	2	1	82
JTC10071	A78	140250	Tuesday	26MAY2009	07:00 - 08:00	2	277	1	22	2	3	307	5	325	1	24	5	1	361
JTC10071	A78	140250	Tuesday	26MAY2009	08:00 - 09:00	4	387	5	42	8	5	451	2	406	2	30	7	3	450
JTC10071	A78	140250	Tuesday	26MAY2009	09:00 - 10:00	2	346	3	51	7	2	411	0	254	1	36	4	3	298
JTC10071	A78	140250	Tuesday	26MAY2009	10:00 - 11:00	3	254	3	44	9	5	318	0	228	3	33	13	4	281
JTC10071	A78	140250	Tuesday	26MAY2009	11:00 - 12:00	1	316	2	45	7	2	373	0	260	0	50	5	2	317
JTC10071	A78	140250	Tuesday	26MAY2009	12:00 - 13:00	1	312	4	40	2	3	362	2	325	2	40	7	2	378
JTC10071	A78	140250	Tuesday	26MAY2009	13:00 - 14:00	0	308	1	36	7	2	354	1	275	6	33	6	3	324
JTC10071	A78	140250	Tuesday	26MAY2009	14:00 - 15:00	2	297	1	34	4	3	341	2	335	3	36	7	3	386
JTC10071	A78	140250	Tuesday	26MAY2009	15:00 - 16:00	4	371	3	34	8	4	424	1	402	2	43	2	6	456
JTC10071	A78	140250	Tuesday	26MAY2009	16:00 - 17:00	5	550	1	23	2	3	584	6	452	3	31	5	4	501
JTC10071	A78	140250	Tuesday	26MAY2009	17:00 - 18:00	4	472	1	16	2	2	497	1	503	0	20	2	1	527
JTC10071	A78	140250	Tuesday	26MAY2009	18:00 - 19:00	8	336	1	10	1	2	358	2	366	0	11	1	5	385
JTC10071	A78	140250	Tuesday	26MAY2009	19:00 - 20:00	6	233	0	6	1	1	247	3	219	1	9	1	2	235
JTC10071	A78	140250	Tuesday	26MAY2009	20:00 - 21:00	2	165	1	5	0	0	173	8	195	0	4	0	1	208

JTC10071	A78	140250	Tuesday	26MAY2009	21:00 - 22:00	5	122	0	2	1	0	130	8	161	0	6	0	0	175
JTC10071	A78	140250	Tuesday	26MAY2009	22:00 - 23:00	0	71	0	1	0	0	72	6	98	0	1	0	0	105
JTC10071	A78	140250	Tuesday	26MAY2009	23:00 - 24:00	0	42	0	0	0	0	42	0	45	0	0	1	0	46
JTC10071	A78	140250	Wednesday	27MAY2009	00:00 - 01:00	0	28	0	2	0	0	30	0	20	0	0	1	0	21
JTC10071	A78	140250	Wednesday	27MAY2009	01:00 - 02:00	0	8	0	2	0	0	10	0	12	0	2	0	0	14
JTC10071	A78	140250	Wednesday	27MAY2009	02:00 - 03:00	0	1	0	2	0	0	3	0	1	0	1	0	0	2
JTC10071	A78	140250	Wednesday	27MAY2009	03:00 - 04:00	0	1	0	1	0	0	2	0	1	0	2	0	0	3
JTC10071	A78	140250	Wednesday	27MAY2009	04:00 - 05:00	0	4	0	3	0	0	7	0	6	0	2	0	0	8
JTC10071	A78	140250	Wednesday	27MAY2009	05:00 - 06:00	0	17	0	6	1	0	24	0	30	0	2	0	0	32
JTC10071	A78	140250	Wednesday	27MAY2009	06:00 - 07:00	0	93	1	10	3	2	109	0	69	0	8	5	1	83
JTC10071	A78	140250	Wednesday	27MAY2009	07:00 - 08:00	1	270	3	27	4	3	308	2	326	2	25	4	1	360
JTC10071	A78	140250	Wednesday	27MAY2009	08:00 - 09:00	3	400	4	36	7	6	456	1	393	1	32	4	5	436
JTC10071	A78	140250	Wednesday	27MAY2009	09:00 - 10:00	1	304	1	52	7	3	368	1	222	2	33	2	6	266
JTC10071	A78	140250	Wednesday	27MAY2009	10:00 - 11:00	2	261	2	35	7	6	313	0	214	1	27	7	5	254
JTC10071	A78	140250	Wednesday	27MAY2009	11:00 - 12:00	3	282	1	41	8	2	337	1	274	3	40	13	2	333
JTC10071	A78	140250	Wednesday	27MAY2009	12:00 - 13:00	2	288	1	35	16	2	344	2	310	1	32	11	2	358
JTC10071	A78	140250	Wednesday	27MAY2009	13:00 - 14:00	2	328	3	37	8	2	380	1	281	0	43	7	3	335
JTC10071	A78	140250	Wednesday	27MAY2009	14:00 - 15:00	4	299	1	34	5	4	347	1	330	4	38	7	6	386
JTC10071	A78	140250	Wednesday	27MAY2009	15:00 - 16:00	3	319	2	38	10	4	376	1	331	3	37	6	9	387
JTC10071	A78	140250	Wednesday	27MAY2009	16:00 - 17:00	2	527	2	23	2	3	559	5	452	4	49	5	3	518
JTC10071	A78	140250	Wednesday	27MAY2009	17:00 - 18:00	6	476	2	11	2	2	499	6	466	4	21	0	1	498
JTC10071	A78	140250	Wednesday	27MAY2009	18:00 - 19:00	3	318	1	5	0	2	329	1	331	1	9	1	3	346
JTC10071	A78	140250	Wednesday	27MAY2009	19:00 - 20:00	10	220	0	8	1	1	240	2	214	0	3	1	2	222
JTC10071	A78	140250	Wednesday	27MAY2009	20:00 - 21:00	2	129	1	10	1	1	144	9	154	1	3	0	1	168
JTC10071	A78	140250	Wednesday	27MAY2009	21:00 - 22:00	0	89	0	2	1	0	92	5	130	0	3	0	0	138
JTC10071	A78	140250	Wednesday	27MAY2009	22:00 - 23:00	0	79	0	1	0	0	80	0	102	1	1	1	0	105
JTC10071	A78	140250	Wednesday	27MAY2009	23:00 - 24:00	0	38	0	0	0	0	38	0	35	0	0	0	0	35
JTC10071	A78	140250	Thursday	28MAY2009	00:00 - 01:00	0	24	0	2	0	0	26	0	18	0	0	0	0	18
JTC10071	A78	140250	Thursday	28MAY2009	01:00 - 02:00	0	7	0	1	0	0	8	0	6	0	1	0	0	7
JTC10071	A78	140250	Thursday	28MAY2009	02:00 - 03:00	0	3	0	2	0	0	5	0	6	0	1	0	0	7
JTC10071	A78	140250	Thursday	28MAY2009	03:00 - 04:00	0	2	0	1	0	0	3	0	2	0	3	0	0	5
JTC10071	A78	140250	Thursday	28MAY2009	04:00 - 05:00	0	7	0	3	0	0	10	0	11	0	4	2	0	17
JTC10071	A78	140250	Thursday	28MAY2009	05:00 - 06:00	0	26	0	2	5	0	33	0	29	0	1	0	0	30
JTC10071	A78	140250	Thursday	28MAY2009	06:00 - 07:00	0	96	1	10	2	2	111	0	66	0	9	5	1	81
JTC10071	A78	140250	Thursday	28MAY2009	07:00 - 08:00	1	284	3	29	4	3	324	3	326	1	25	6	1	362
JTC10071	A78	140250	Thursday	28MAY2009	08:00 - 09:00	1	394	3	41	6	5	450	2	420	0	35	2	2	461
JTC10071	A78	140250	Thursday	28MAY2009	09:00 - 10:00	0	291	2	52	8	3	356	0	239	3	28	5	5	280
JTC10071	A78	140250	Thursday	28MAY2009	10:00 - 11:00	3	275	2	43	8	3	334	4	228	1	36	7	5	281
JTC10071	A78	140250	Thursday	28MAY2009	11:00 - 12:00	6	295	3	42	14	3	363	4	259	1	42	9	4	319
JTC10071	A78	140250	Thursday	28MAY2009	12:00 - 13:00	6	330	1	43	4	2	386	1	320	2	29	5	1	358
JTC10071	A78	140250	Thursday	28MAY2009	13:00 - 14:00	1	310	1	40	7	2	361	2	269	0	20	5	0	296
JTC10071	A78	140250	Thursday	28MAY2009	14:00 - 15:00	0	300	3	17	8	3	331	3	343	2	29	8	4	389
JTC10071	A78	140250	Thursday	28MAY2009	15:00 - 16:00	5	391	1	37	5	3	442	4	412	1	44	5	8	474
JTC10071	A78	140250	Thursday	28MAY2009	16:00 - 17:00	4	505	1	25	4	5	544	3	439	4	37	4	3	490
JTC10071	A78	140250	Thursday	28MAY2009	17:00 - 18:00	2	455	0	18	1	3	479	1	489	0	19	3	2	514
JTC10071	A78	140250	Thursday	28MAY2009	18:00 - 19:00	2	358	0	5	2	3	370	0	351	1	17	1	4	374
JTC10071	A78	140250	Thursday	28MAY2009	19:00 - 20:00	6	224	0	9	0	1	240	9	237	0	5	0	2	253
JTC10071	A78	140250	Thursday	28MAY2009	20:00 - 21:00	5	192	2	5	0	0	204	1	201	1	7	3	3	216
JTC10071	A78	140250	Thursday	28MAY2009	21:00 - 22:00	3	121	0	5	0	0	129	8	158	1	3	0	0	170
JTC10071	A78	140250	Thursday	28MAY2009	22:00 - 23:00	9	104	0	3	0	0	116	0	88	0	1	0	0	89
JTC10071	A78	140250	Thursday	28MAY2009	23:00 - 24:00	1	40	0	2	1	0	44	0	43	0	2	0	0	45
JTC10071	A78	140250	Friday	29MAY2009	00:00 - 01:00	0	17	0	1	0	0	18	0	22	0	0	0	0	22
JTC10071	A78	140250	Friday	29MAY2009	01:00 - 02:00	0	18	0	1	0	0	19	0	20	0	1	0	0	21
JTC10071	A78	140250	Friday	29MAY2009	02:00 - 03:00	0	5	0	1	0	0	6	1	5	0	0	0	0	6
JTC10071	A78	140250	Friday	29MAY2009	03:00 - 04:00	0	2	0	2	0	0	4	0	4	0	3	0	0	7
JTC10071	A78	140250	Friday	29MAY2009	04:00 - 05:00	0	5	0	2	0	0	7	0	15	0	4	0	0	19
JTC10071	A78	140250	Friday	29MAY2009	05:00 - 06:00	0	14	0	8	4	0	26	0	25	0	2	1	0	28
JTC10071	A78	140250	Friday	29MAY2009	06:00 - 07:00	1	94	0	7	5	2	109	1	65	0	3	8	1	78

JTC10071	A78	140250	Friday	29MAY2009	07:00 - 08:00	2	267	2	29	8	2	310	6	305	1	22	4	1	339
JTC10071	A78	140250	Friday	29MAY2009	08:00 - 09:00	3	365	5	47	1	5	426	4	368	1	34	5	4	416
JTC10071	A78	140250	Friday	29MAY2009	09:00 - 10:00	4	321	2	40	12	2	381	3	227	1	34	8	2	275
JTC10071	A78	140250	Friday	29MAY2009	10:00 - 11:00	2	300	4	45	12	3	366	4	226	1	30	10	5	276
JTC10071	A78	140250	Friday	29MAY2009	11:00 - 12:00	15	317	1	31	5	2	371	4	306	3	38	8	2	361
JTC10071	A78	140250	Friday	29MAY2009	12:00 - 13:00	10	393	1	25	10	2	441	6	342	3	28	7	2	388
JTC10071	A78	140250	Friday	29MAY2009	13:00 - 14:00	7	340	2	42	6	4	401	8	354	1	40	4	3	410
JTC10071	A78	140250	Friday	29MAY2009	14:00 - 15:00	13	355	4	33	4	3	412	12	396	1	37	9	2	457
JTC10071	A78	140250	Friday	29MAY2009	15:00 - 16:00	18	431	1	23	6	3	482	9	443	4	49	4	6	515
JTC10071	A78	140250	Friday	29MAY2009	16:00 - 17:00	6	511	2	21	2	3	545	4	447	2	29	3	3	488
JTC10071	A78	140250	Friday	29MAY2009	17:00 - 18:00	13	423	1	11	2	2	452	8	473	0	9	1	2	493
JTC10071	A78	140250	Friday	29MAY2009	18:00 - 19:00	22	409	2	5	0	2	440	9	347	1	8	1	3	369
JTC10071	A78	140250	Friday	29MAY2009	19:00 - 20:00	16	283	2	6	1	1	309	16	289	0	8	0	2	315
JTC10071	A78	140250	Friday	29MAY2009	20:00 - 21:00	23	193	0	9	0	0	225	14	250	1	6	0	1	272
JTC10071	A78	140250	Friday	29MAY2009	21:00 - 22:00	2	176	0	7	0	0	185	19	186	0	3	0	0	208
JTC10071	A78	140250	Friday	29MAY2009	22:00 - 23:00	0	119	0	2	0	0	121	6	148	0	5	0	0	159
JTC10071	A78	140250	Friday	29MAY2009	23:00 - 24:00	3	77	1	1	0	0	82	1	83	0	2	0	0	86
JTC10071	A78	140250	Saturday	30MAY2009	00:00 - 01:00	0	47	0	1	0	0	48	0	57	0	2	0	0	59
JTC10071	A78	140250	Saturday	30MAY2009	01:00 - 02:00	0	27	0	2	0	0	29	0	35	0	2	0	0	37
JTC10071	A78	140250	Saturday	30MAY2009	02:00 - 03:00	0	13	0	3	0	0	16	0	16	0	0	0	0	16
JTC10071	A78	140250	Saturday	30MAY2009	03:00 - 04:00	0	11	0	0	0	0	11	0	14	0	2	0	0	16
JTC10071	A78	140250	Saturday	30MAY2009	04:00 - 05:00	0	4	0	2	0	0	6	0	10	0	3	0	0	13
JTC10071	A78	140250	Saturday	30MAY2009	05:00 - 06:00	0	8	0	2	1	0	11	0	16	0	0	0	0	16
JTC10071	A78	140250	Saturday	30MAY2009	06:00 - 07:00	1	53	1	2	0	2	59	3	44	0	3	0	0	50
JTC10071	A78	140250	Saturday	30MAY2009	07:00 - 08:00	4	109	0	7	1	2	123	4	85	0	5	2	2	98
JTC10071	A78	140250	Saturday	30MAY2009	08:00 - 09:00	7	187	1	17	1	1	214	2	151	0	15	0	1	169
JTC10071	A78	140250	Saturday	30MAY2009	09:00 - 10:00	5	282	1	22	1	4	315	6	213	1	20	2	2	244
JTC10071	A78	140250	Saturday	30MAY2009	10:00 - 11:00	12	351	1	16	1	2	383	4	286	0	20	0	2	312
JTC10071	A78	140250	Saturday	30MAY2009	11:00 - 12:00	21	428	4	14	0	5	472	9	378	0	14	0	3	404
JTC10071	A78	140250	Saturday	30MAY2009	12:00 - 13:00	16	491	1	7	0	2	517	12	423	0	11	0	2	448
JTC10071	A78	140250	Saturday	30MAY2009	13:00 - 14:00	21	514	1	5	0	2	543	10	408	1	7	0	3	429
JTC10071	A78	140250	Saturday	30MAY2009	14:00 - 15:00	12	430	4	7	0	2	455	11	497	2	8	0	2	520
JTC10071	A78	140250	Saturday	30MAY2009	15:00 - 16:00	16	405	1	7	1	4	434	16	454	1	10	0	2	483
JTC10071	A78	140250	Saturday	30MAY2009	16:00 - 17:00	9	385	1	6	0	2	403	13	422	1	7	1	0	444
JTC10071	A78	140250	Saturday	30MAY2009	17:00 - 18:00	11	439	1	4	0	5	460	17	428	3	5	0	3	456
JTC10071	A78	140250	Saturday	30MAY2009	18:00 - 19:00	17	387	1	10	0	1	416	10	332	0	9	0	3	354
JTC10071	A78	140250	Saturday	30MAY2009	19:00 - 20:00	9	275	0	3	0	1	288	5	269	1	9	0	6	290
JTC10071	A78	140250	Saturday	30MAY2009	20:00 - 21:00	5	196	0	2	0	0	203	7	222	1	6	0	1	237
JTC10071	A78	140250	Saturday	30MAY2009	21:00 - 22:00	3	128	0	4	0	0	135	9	187	0	4	0	0	200
JTC10071	A78	140250	Saturday	30MAY2009	22:00 - 23:00	1	90	0	2	0	0	93	1	108	0	5	0	0	114
JTC10071	A78	140250	Saturday	30MAY2009	23:00 - 24:00	1	72	0	0	0	0	73	2	88	0	0	0	1	91
JTC10071	A78	140250	Sunday	31MAY2009	00:00 - 01:00	0	53	0	2	0	0	55	0	62	0	2	0	0	64
JTC10071	A78	140250	Sunday	31MAY2009	01:00 - 02:00	0	34	0	1	0	1	36	0	37	0	1	0	0	38
JTC10071	A78	140250	Sunday	31MAY2009	02:00 - 03:00	0	32	0	1	0	0	33	0	35	0	1	0	0	36
JTC10071	A78	140250	Sunday	31MAY2009	03:00 - 04:00	0	16	0	0	0	0	16	0	15	0	0	0	0	15
JTC10071	A78	140250	Sunday	31MAY2009	04:00 - 05:00	0	2	0	0	0	0	2	0	9	0	0	0	0	9
JTC10071	A78	140250	Sunday	31MAY2009	05:00 - 06:00	0	9	0	1	0	0	10	0	15	0	3	0	0	18
JTC10071	A78	140250	Sunday	31MAY2009	06:00 - 07:00	0	33	0	0	0	0	33	1	32	0	1	0	0	34
JTC10071	A78	140250	Sunday	31MAY2009	07:00 - 08:00	1	70	1	1	0	0	73	2	66	0	5	0	0	73
JTC10071	A78	140250	Sunday	31MAY2009	08:00 - 09:00	3	84	1	3	0	0	91	4	84	3	7	0	0	98
JTC10071	A78	140250	Sunday	31MAY2009	09:00 - 10:00	10	147	4	5	0	1	167	4	117	1	5	1	1	129
JTC10071	A78	140250	Sunday	31MAY2009	10:00 - 11:00	13	250	0	9	0	2	274	2	188	0	13	1	1	205
JTC10071	A78	140250	Sunday	31MAY2009	11:00 - 12:00	12	336	3	10	0	2	363	5	262	1	6	0	1	275
JTC10071	A78	140250	Sunday	31MAY2009	12:00 - 13:00	20	383	3	8	0	1	415	8	286	1	5	0	0	300
JTC10071	A78	140250	Sunday	31MAY2009	13:00 - 14:00	24	384	2	10	1	0	421	15	337	0	6	0	1	359
JTC10071	A78	140250	Sunday	31MAY2009	14:00 - 15:00	10	393	2	8	0	2	415	16	352	1	6	0	1	376
JTC10071	A78	140250	Sunday	31MAY2009	15:00 - 16:00	12	414	3	13	0	0	442	21	396	0	3	0	0	420
JTC10071	A78	140250	Sunday	31MAY2009	16:00 - 17:00	9	384	0	6	0	0	399	30	498	2	8	0	2	540

JTC10071	A78	140250	Sunday	31MAY2009	17:00 - 18:00	12	323	0	8	0	1	344	13	405	3	7	0	1	429
JTC10071	A78	140250	Sunday	31MAY2009	18:00 - 19:00	15	384	0	3	0	0	402	19	319	1	4	0	1	344
JTC10071	A78	140250	Sunday	31MAY2009	19:00 - 20:00	9	281	1	4	0	1	296	13	288	2	5	1	1	310
JTC10071	A78	140250	Sunday	31MAY2009	20:00 - 21:00	6	211	0	3	0	0	220	14	253	1	2	0	0	270
JTC10071	A78	140250	Sunday	31MAY2009	21:00 - 22:00	6	146	0	1	0	0	153	6	177	0	0	0	0	183
JTC10071	A78	140250	Sunday	31MAY2009	22:00 - 23:00	0	73	0	6	0	0	79	7	84	0	2	0	0	93
JTC10071	A78	140250	Sunday	31MAY2009	23:00 - 24:00	0	46	0	0	0	0	46	1	56	0	1	0	0	58

END OF DATA FOR SITE JTC10071