

Vehicular Access (Existing)

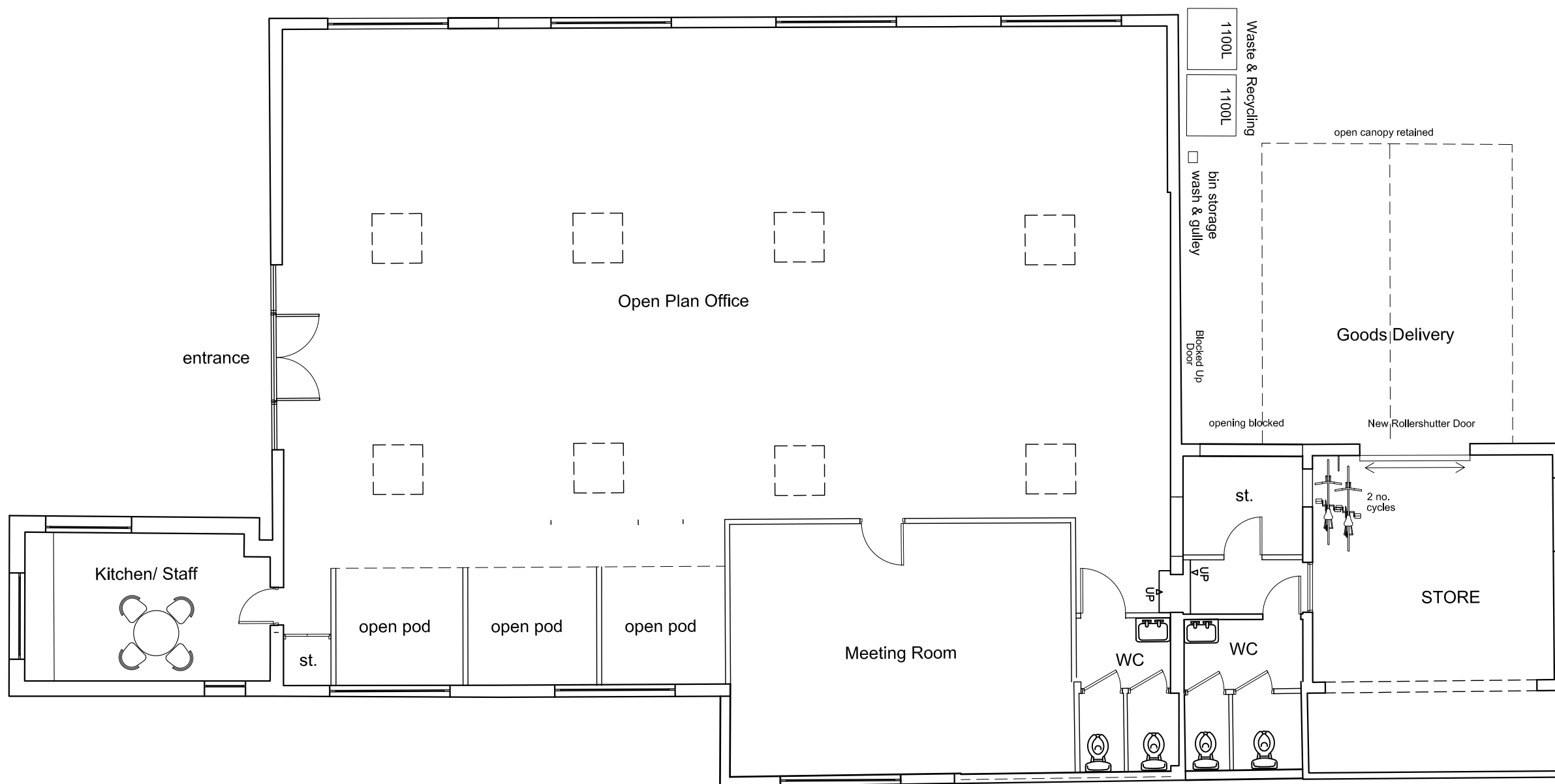

Rev/date	Comments	Drn	Chk
A: ---.21	--	--	--

Report all errors and omissions to the Architect
 Dimensions to be checked on site

© josef - whiteman architects llp all rights reserved
 mail@josefwhiteman.com www.josefwhiteman.com

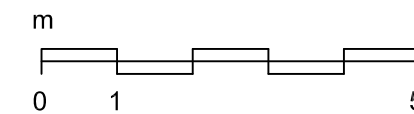

Client
 VERTEC Ltd

Project
 VERTEC Offices, Haddenham

Title
 Proposed Plans

Drawing status
 PLANNING

josef - whiteman architects llp



Scale	Date
1:100	23.04.2021

Drawing no.	Rev
2103-4-P-100	-

Proposed Plan 1:100