

Tree Protection Plan

This drawing must be read and followed in conjunction with the *Arboricultural Method Statement (AMS 7627)*, including the *Drive Cross-section in Appendix B*, and the *Structural Landscape Plan (LAND 7627)*. Failure to follow these documents and drawings could result in local authority enforcement action including STOP Notices for all site activity. For queries and advice, contact the project arboriculturist at the earliest moment to help to prevent inadvertent breaches of planning conditions.

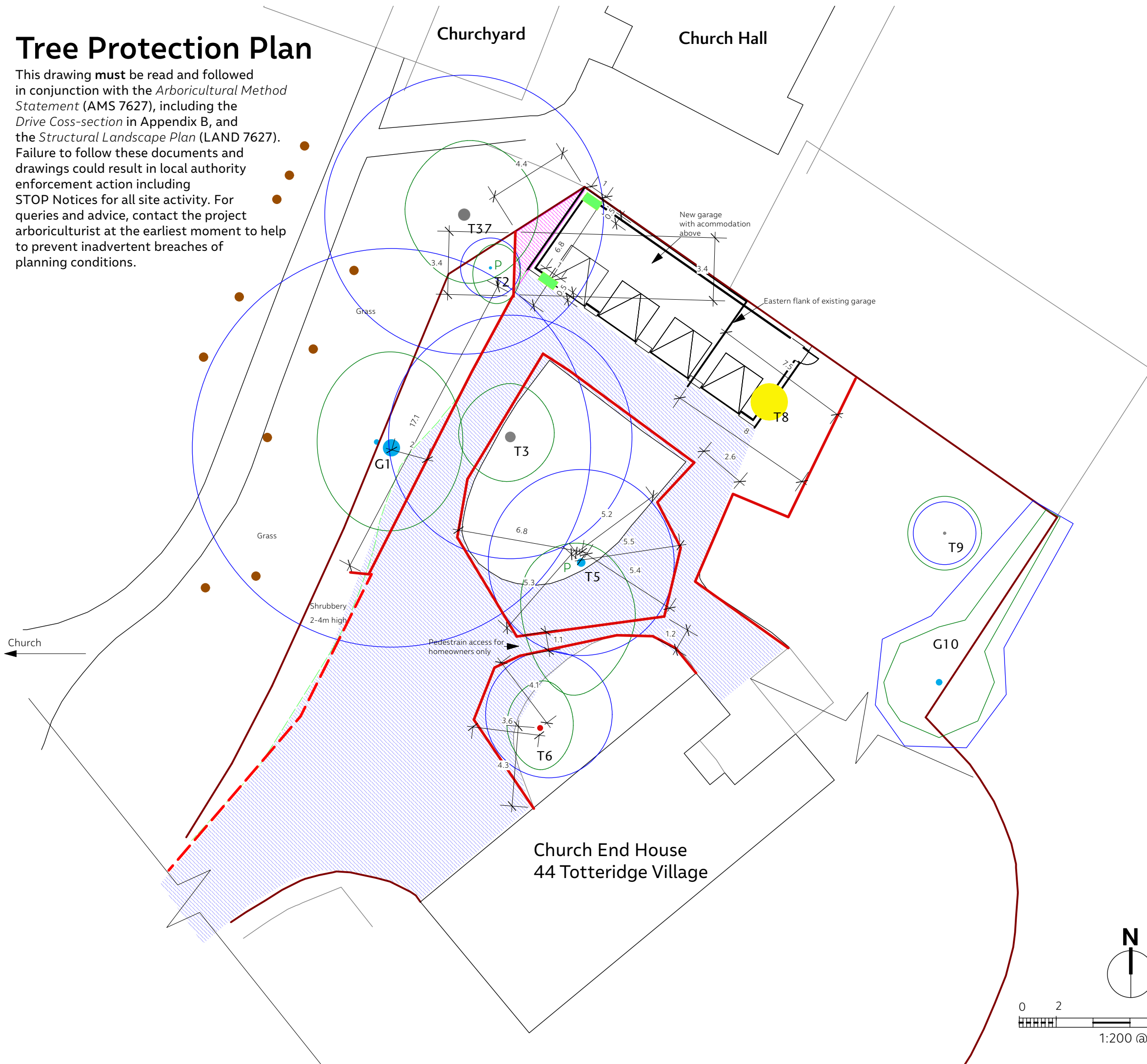

- Boundary.
- Representational tree trunk**
 - Category A: high quality
 - Category B: moderate quality
 - Category C: low quality or very young tree
 - Category U: unsuitable for retention regardless of the development
- Trees**
 - Minimum root protection area
 - Indicative crown spread
 - Shading
 - Non-material off-site tree or off-site tree with its root protection area and/or crown spread within material trees shown
- Tree removal and pruning**
 - Tree to be removed: T8 only. See AMS 7627 paragraph 4.1.1.
 - P Tree to be pruned: T2 and T5 only. See AMS 7627 paragraph 4.1.2 and 4.1.3.
- Tree protection**
 - Protective fencing, type A: see AMS 7627 paragraphs 5.13, 5.14 and 5.16 to 5.18.
 - Protective fencing, type B: see AMS 7627 paragraphs 5.13, 5.15 and 5.16 to 5.18.
 - Temporary ground protection: see AMS 7627 paragraphs 5.10 to 5.12.
 - New gravel drive also providing ground protection: see AMS 7627 paragraphs 5.1 to 5.9 and Appendix B, as well as LAND 7627.
 - Minimum number and position of trial trenches 1m x 0.5m minimum: see AMS 7627 paragraphs 10.1 and 10.2.

The Tree Bureau
 Old Warwick Studio
 2a Warwick Road
 St Albans Herts AL1 4DL
 01727 855006
 info@thetreebureau.co.uk

Title: Tree Protection Plan

Drawing reference: TPP 7627

Scale 1:200 @ A3

Client: Fausto Furlotti

Site: 'Church End House', 44 Totteridge Village
 London N20 8PR

Date: 12 05 21

© The Tree Bureau 2021

