

1.0 PARKING
North Street is Controlled Parking Zone area and there are sufficient on street spaces available to accommodate extra vehicles.

2.0 CYCLE STORE
There will be adequate space available within the application site. Secure covered storage area will provide space for at least two cycles.

3.0 DOMESTIC, RECYCLABLE & GARDEN WASTE
Refuse and recyclable bin storage area is located within the site curtilage. The refuse area for the development will be located conveniently for collection by the council as usual.

WASTE MANAGEMENT

The dwelling will be provided with separate refuse and recycling storage facilities; typically, 240 litre wheelie bins for general household waste, green waste and compost, and green bag for dry recyclables (recyclable glass, tins and plastic goods, paper and cardboard).

Three 10 litre dedicated labelled recycling bins will be provided in the kitchen to allow the successful separation and storage of waste prior to collection, including a kitchen food waste caddy. Waste collection will be kept the same as existing. Which will be once a week at a specific day & time.

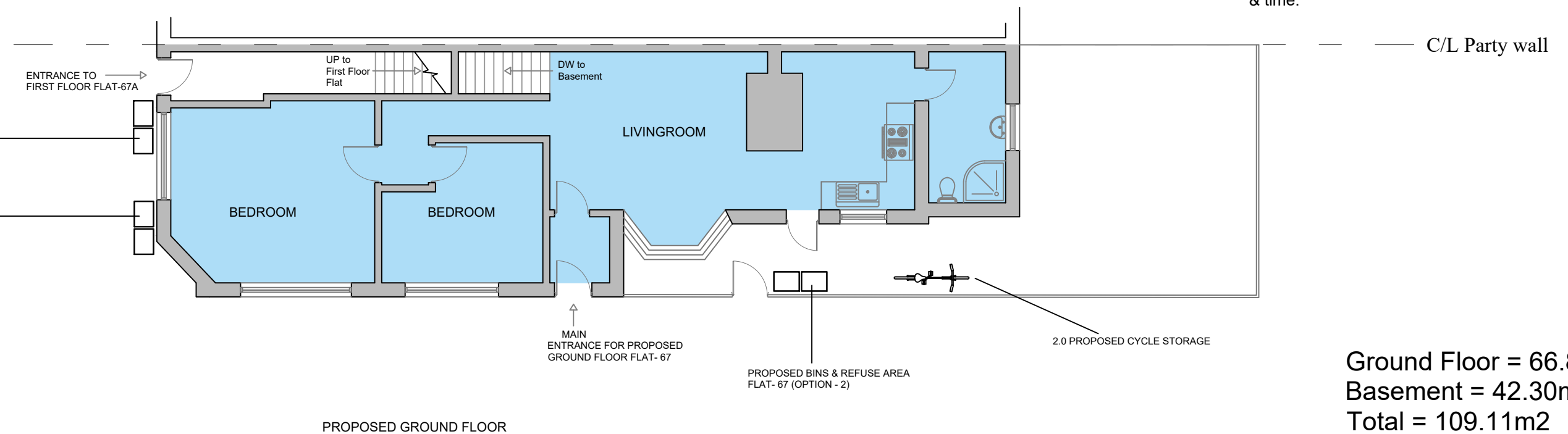
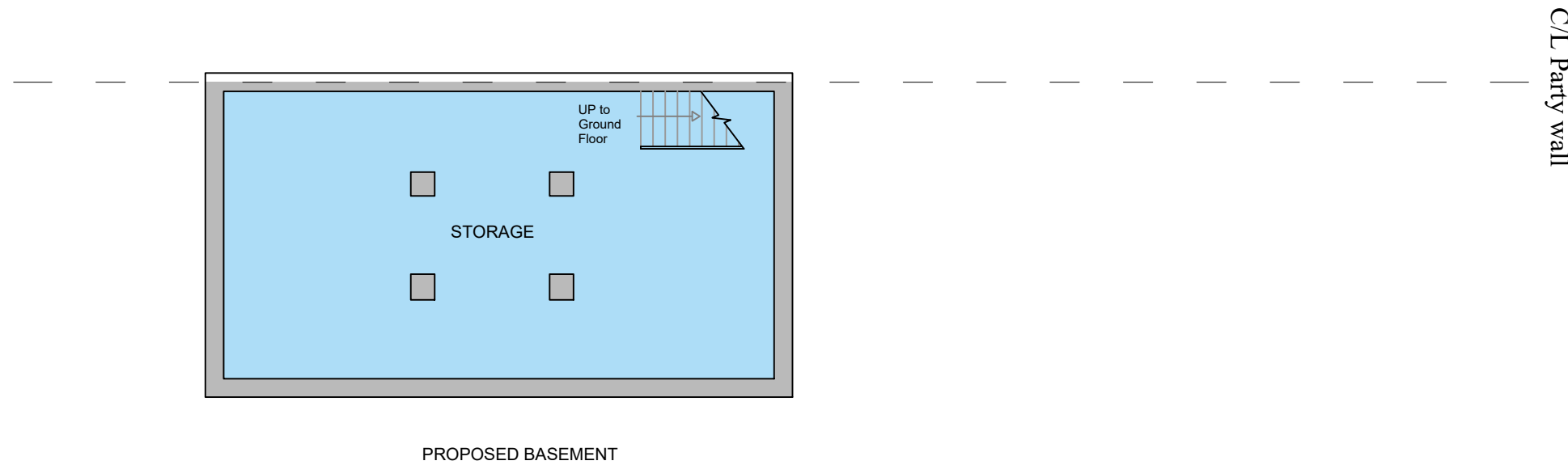

Ground Floor = 66.81m²
Basement = 42.30m²
Total = 109.11m²