

Block Plan (Proposed)
Scale 1:500

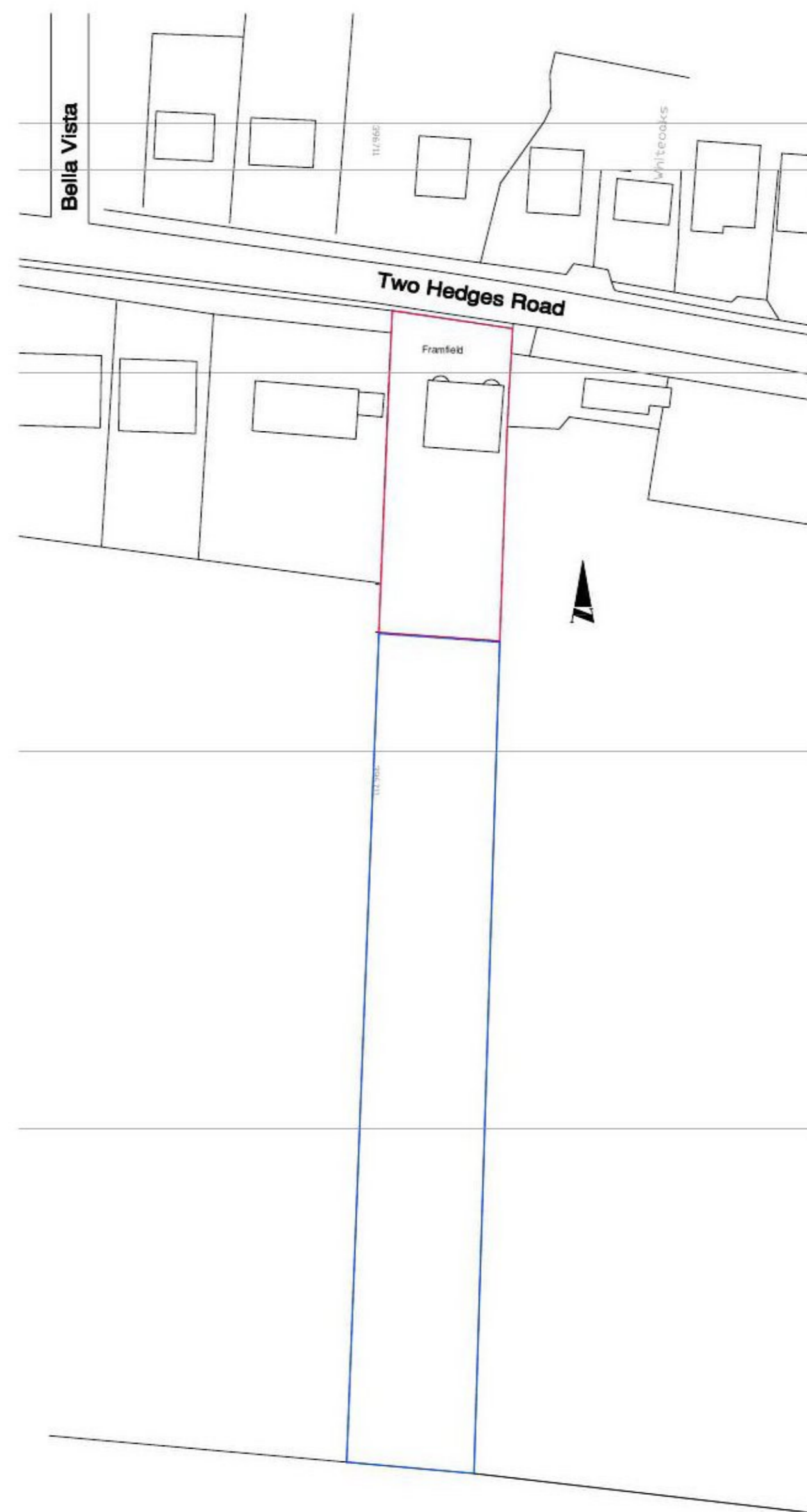

Location Plan (Existing)
Scale 1:1250

REV	REVISION	DATE
-----	----------	------

project

**Proposed single storey
studio extension,
'Framfield',
Two Hedges Road,
Woodmancote GL52 9PT
for**

**'Framfield',
Two Hedges Road,
Woodmancote GL52 9PT**

drawing
Location and Block Plan

status
Planning

drawn by;	JD-W
checked by;	JD-W
date;	9/7/20
scale;	1:1250_500@A3

drawing no.
200709/PL/001

**Do not scale from this drawing.
All information shown is copyright of eA.**