

Refer to drawing 110\_L01\_02 for extent of boundary

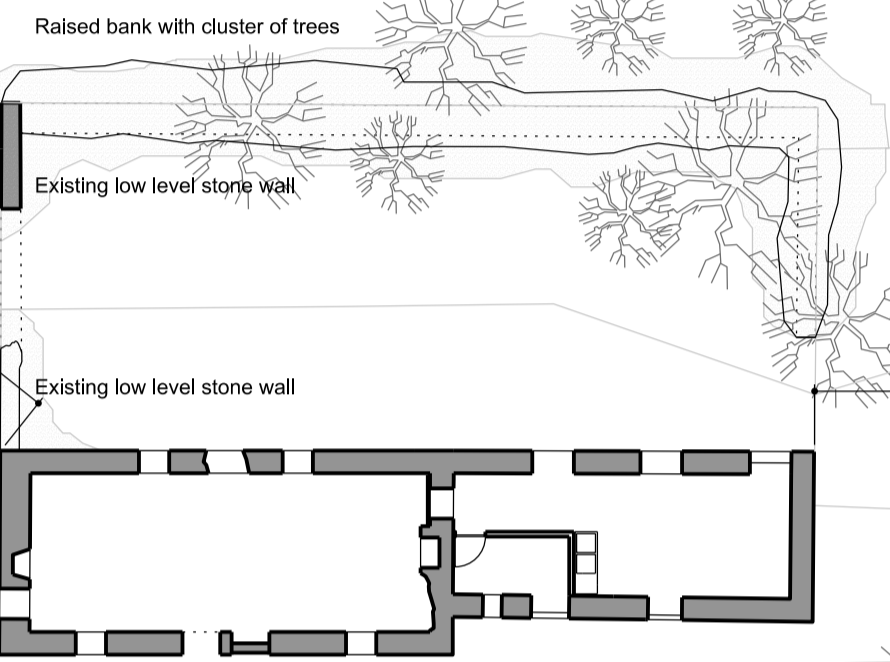

- 1 Burnished Ruin  
10.5m x 3.84m (external)  
48.1m<sup>2</sup> GIA
- 2 Burnished House  
9.5m x 4.5m (external)  
60m<sup>2</sup> GIA (inc. 1st floor)

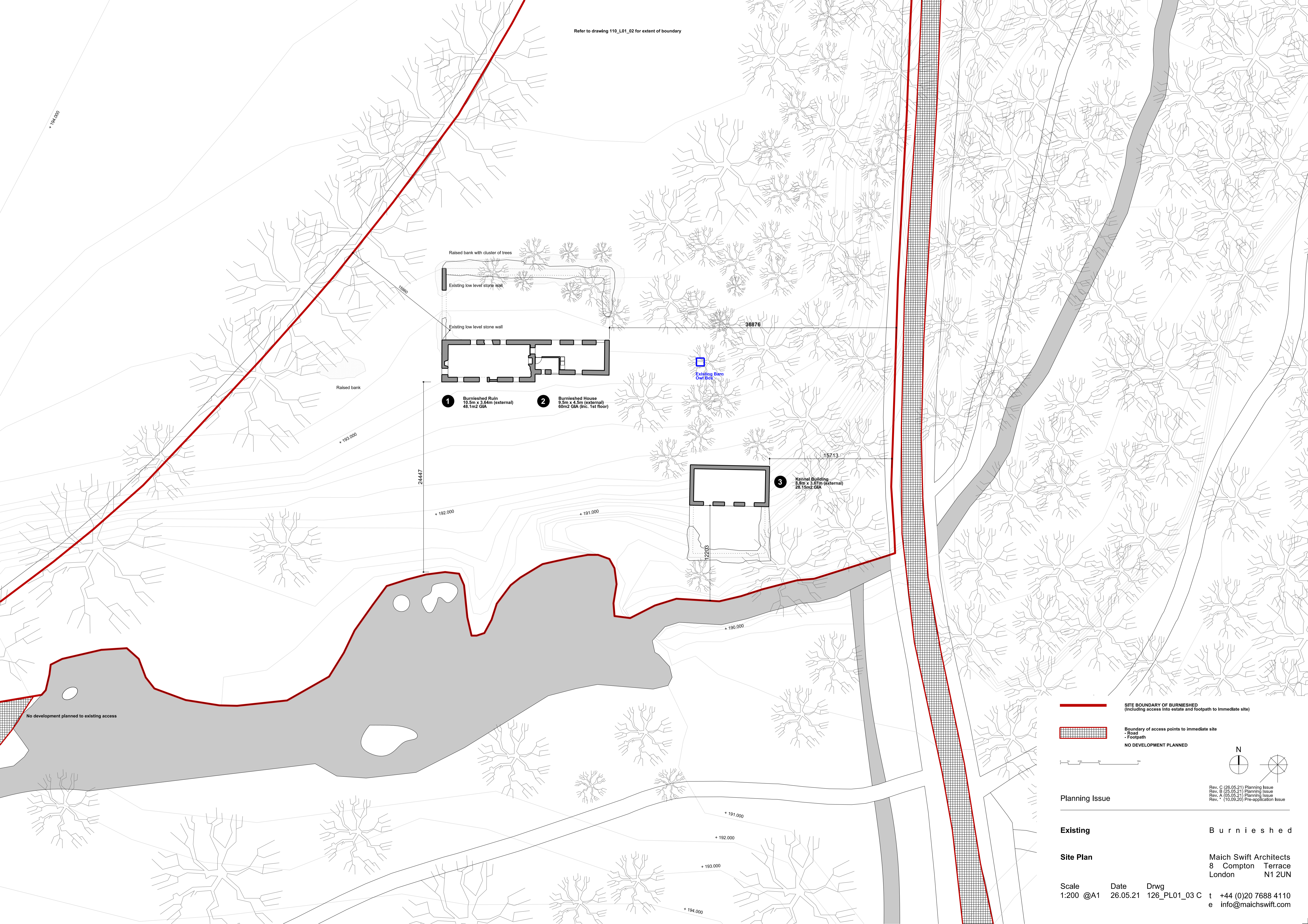
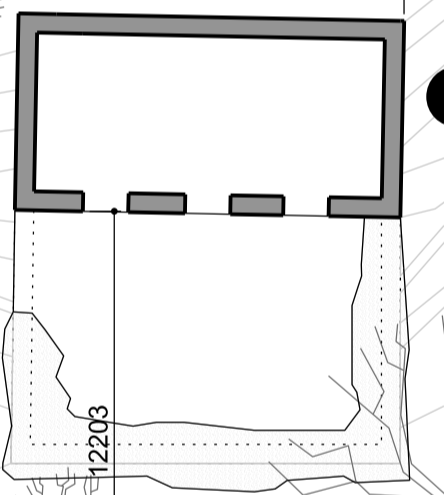

- 3 Kennel Building  
9.8m x 3.87m (external)  
28.15m<sup>2</sup> GIA

**SITE BOUNDARY OF BURNISHED**  
(Including access into estate and footpath to immediate site)

**Boundary of access points to immediate site**  
- Road  
- Footpath

**NO DEVELOPMENT PLANNED**



Planning Issue

Rev. C (26.05.21) Planning Issue  
Rev. B (25.05.21) Planning Issue  
Rev. A (05.05.21) Planning Issue  
Rev. \* (10.09.20) Pre-application Issue

Existing **Burnished**

**Site Plan**

**Maich Swift Architects**  
8 Compton Terrace  
London N1 2UN

Scale 1:200 @A1 Date 26.05.21 Drwg 126\_PL01\_03 C t +44 (0)20 7688 4110 e info@maichswift.com