



NOTES



This drawing to be read in accordance with the specification/Bills of Quantities and related drawings.

No Dimensions to be scaled from this drawing. All stated dimensions to be verified on site and the Architect notified of any discrepancies.

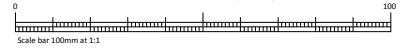

Scale bar 100mm at 1:1

APPLICATION BOUNDARY

ADJACENT LAND WITHIN APPLICANT OWNERSHIP

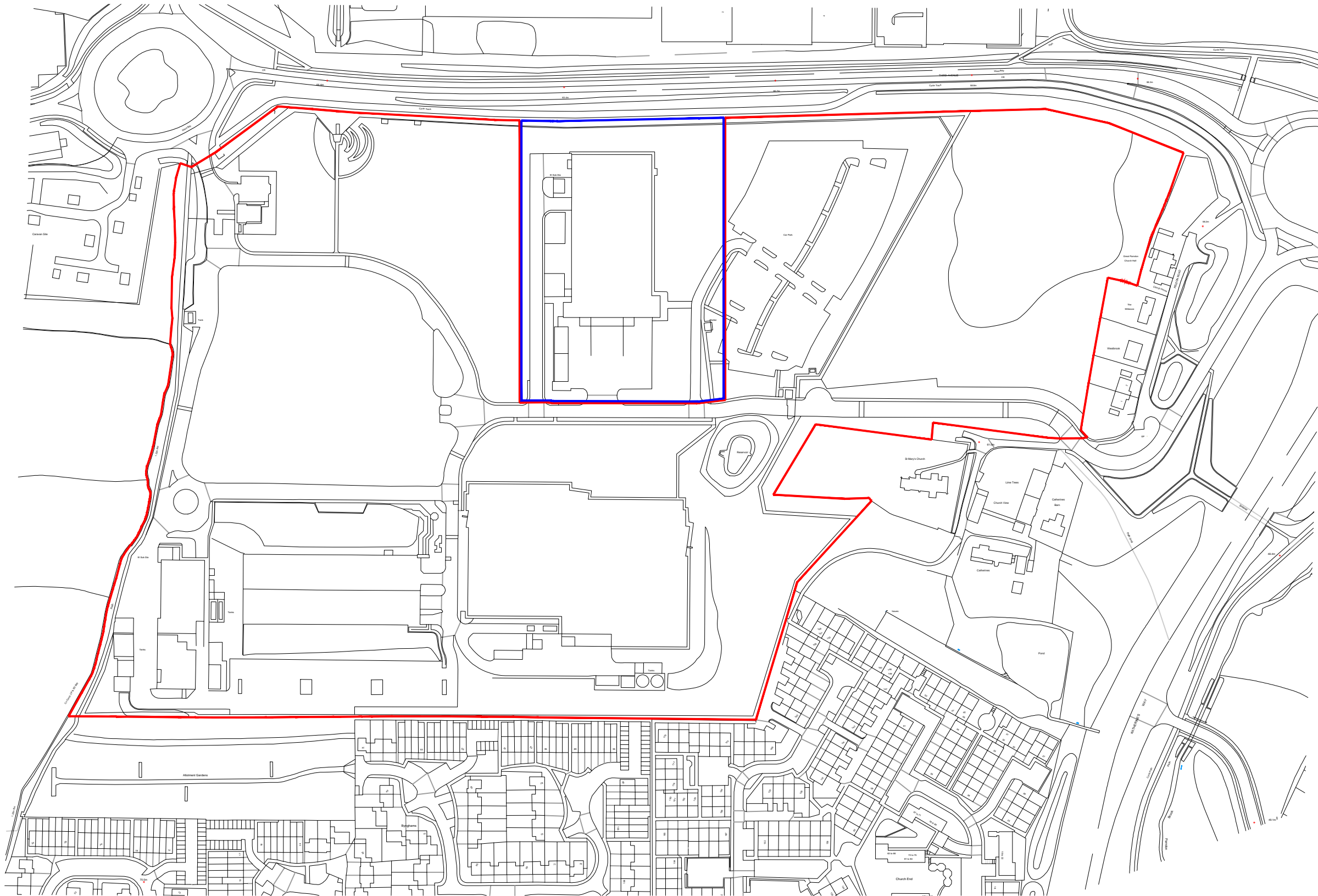

FOR PLANNING

REV	DATE	NOTE	IN

Project
**FORMER GSK SITE
THIRD AVENUE
HARLOW**

Title
APPLICATION BOUNDARY PLAN

Scale
1:1250 @ A1
Date
MAY 2017
Drawn
KB
Checked
MB

Drawing Number
7805/P100
Revision
A

Saunders
Architecture + Urban Design