

LOCATION PLAN

Scale 1:1250

- Ownership Boundary
- Site Boundary
- - - Site Access

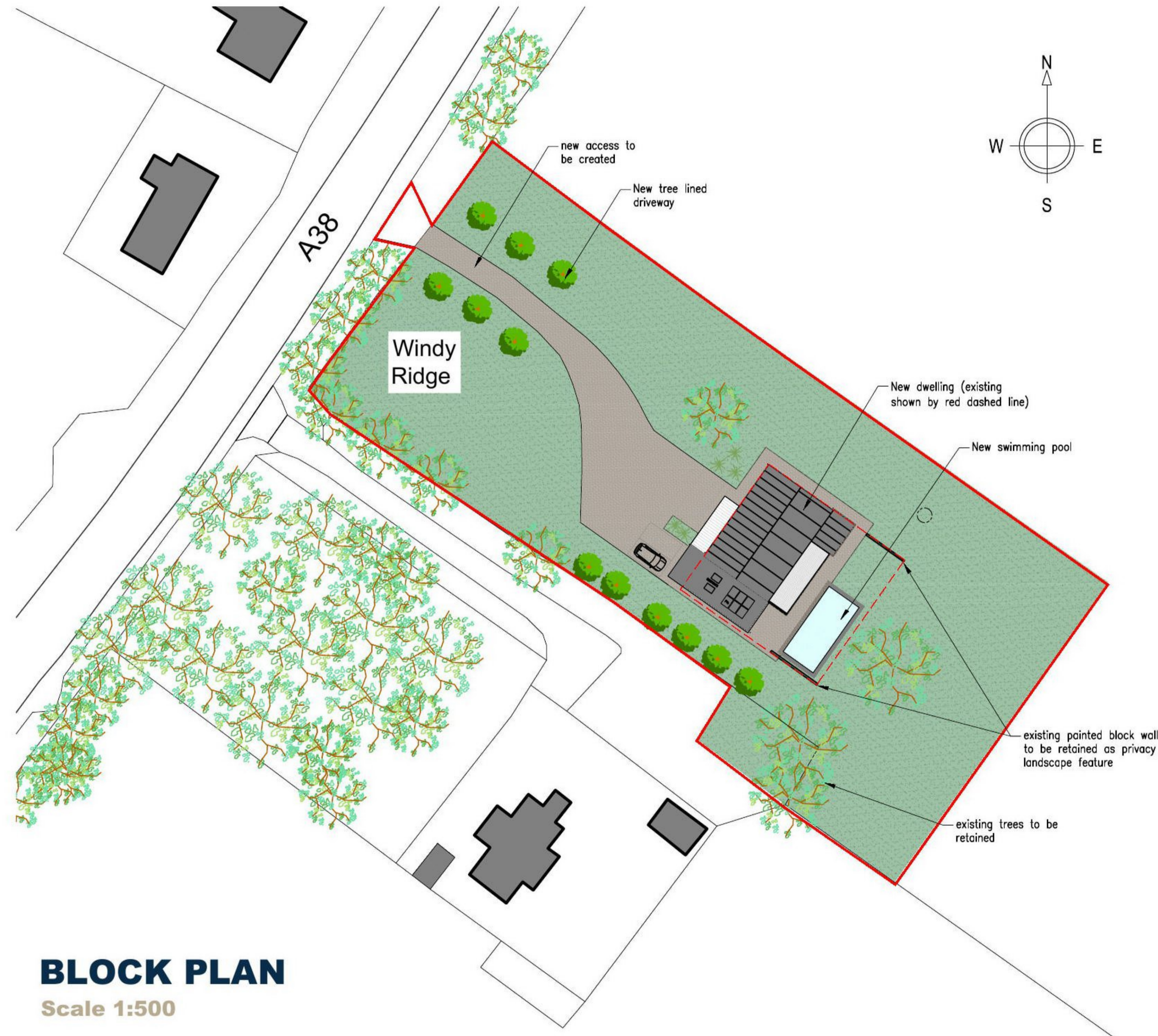
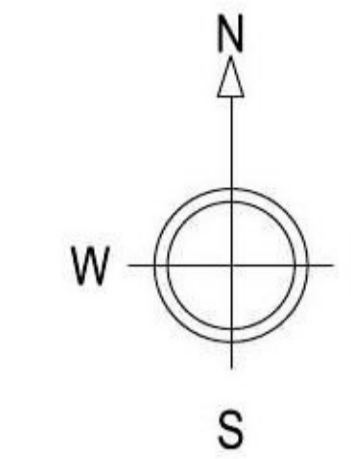

BLOCK PLAN

Scale 1:500

- - - Building to be Demolished
- Site Boundary

PLANNING

Rev.	Date.	Amendment.	Drawn	Checked
A	04-06-21	Blue line amended	HHB	MB

Windy Ridge, Tewkesbury Road,
Coombe Hill, Gloucestershire, GL19 4AR

TITLE
Proposed New Dwelling
Location & Block Plan

SCALE	DATE	DRAWN BY	CHECKED BY
AS SHOWN @A2	JAN 21	HHB	MB
JOB NO.	DRAWING NO.	REVISION	
MB/1468/0121	200_01	A	



- NOTES:
- Use written dimensions only. All dimensions to be checked on site and any discrepancies reported to ACORUS immediately. If in doubt ask.
 - This drawing is confidential and remains the exclusive property of ACORUS.
 - Ordnance Survey Paper Map Copying Licence Number: 100039456.
- © ACORUS Rural Property Services Ltd.

