

GH1 GH1

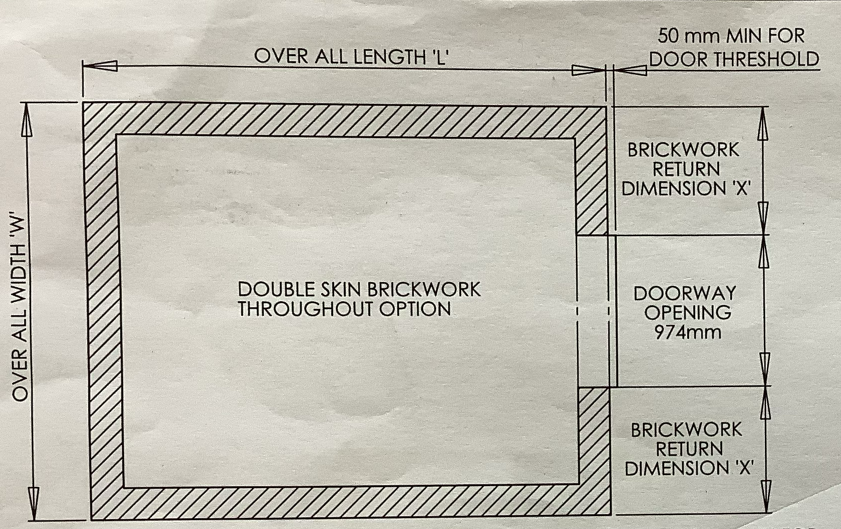

PIERS AT DOOR OPENING IN SINGLE SKIN BRICKWORK OPTION

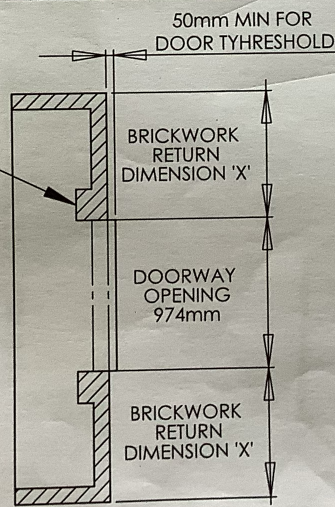

GREENHOUSE TYPE	OVER ALL WIDTH 'W'	BRICKWORK RETURN DIMENSION 'X'
RUGBY (6 WIDTH)	1968mm	497mm
RUSHMOOR (8 WIDTH)	2598mm	812mm
ROEDEAN (11 WIDTH)	3532mm	1279mm

OVER ALL LENGTH 'L' = BASIC GREENHOUSE LENGTH + EXTENSION LENGTH IF REQUIRED

BASIC GREENHOUSE	LENGTH	GREENHOUSE EXTENSION	EX. LENGTH
6 LONG	1990mm	6 EXT LONG	1860mm
8 LONG	2610mm	8 EXT LONG	2480mm
10 LONG	3230mm	10 EXT LONG	3100mm
12 LONG	3850mm	12 EXT LONG	3720mm

GUIDANCE NOTE FOR ROBINSONS DWARF WALL GREENHOUSES. FOOTINGS

CONCRETE STRIP FOOTINGS SHOULD BE A MINIMUM OF 400mm WIDE X 200mm DEEP. IF THE SITE IS ON MADE UP GROUND IT IS IMPORTANT THAT THE FOOTINGS ARE CUT INTO THE COMPACTED GROUND BELOW. WHERE THE GROUND IS LIABLE TO MOVEMENT SUCH AS HEAVY CLAY OR LOOSE SANDY SOIL REINFORCING SHOULD BE ADDED TO THE CONCRETE FOOTINGS.

WALLS

IT IS MOST IMPORTANT THAT THE BRICKWORK IS IN ACCORDANCE WITH THE 'mm' DIMENSIONS PROVIDED AND IS SQUARE, LEVEL AND UPRIGHT, THE DIAGONAL MEASUREMENTS SHOULD BE EQUAL.

WALLS CAN BE EITHER DOUBLE OR SINGLE SKIN.

THE TOP COURSE OF BRICKS SHOULD BE LAID FROG DOWN. IF ENGINEERING BRICKS ARE USED FOR THE TOP COURSE PLEASE ENSURE THEY ARE SOLID NOT CELLULAR (WITH HOLES THROUGH THEM) OR FIXING DOWN OF THE GREENHOUSE WILL BE A PROBLEM. BRICKS SHOULD BE A GOOD QUALITY STOCK BRICK, SAND FACED FLETTON TYPE BRICKS ARE NOT SUITABLE.

GABLE DOOR OPENING

THE DOOR THRESHOLD REQUIRES BRICK WORK ACROSS THE OPENING WHICH SHOULD BE LEVEL WITH THE FINISHED FLOOR LEVEL (F.F.L) OF THE GREENHOUSE. THE OPENING FOR THE DOORWAY AND THE HEIGHT TO THE TOP OF THE WALL FROM THE THRESHOLD LEVEL REQUIRE THE HIGHEST ACCURACY AND ARE MOST IMPORTANT SO THAT THE DOOR FITS THE APERTURE CORRECTLY. PLEASE ALSO BE AWARE THAT THE DOOR OPENS INWARDS AND THEREFORE THE FOUNDATIONS NEED TO AVOID ANY DOOR INTERFERENCE. IT IS ADVISABLE TO MAKE A WOODEN TEMPLATE TO CHECK THE DOOR APERTURE DIMENSIONS.

IF SINGLE SKIN WALLS ARE USED THEN PIERS SHOULD BE FORMED AT THE DOOR OPENING.

IN ORDER TO SUPPORT THE OUTER EDGE OF THE DOOR THRESHOLD THERE MUST BE A PROJECTION OF BRICKWORK / CONCRETE DIRECTLY IN FRONT OF THE DOORWAY WITH A MINIMUM WIDTH OF 50mm. THIS NEEDS TO BE LEVEL WITH THE DOOR THRESHOLD OPENING.

Property of 'Robinsons Greenhouses' © 2017

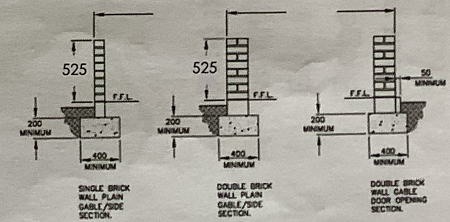

TITLE: ROBINSONS VICTORIAN DWARF WALL RANGE
 THIS PLAN APPLIES TO GREENHOUSE WITH DOOR AT ONE END ONLY!