

NOTES

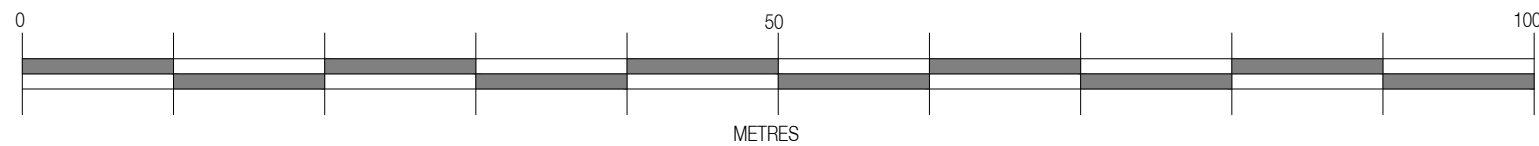
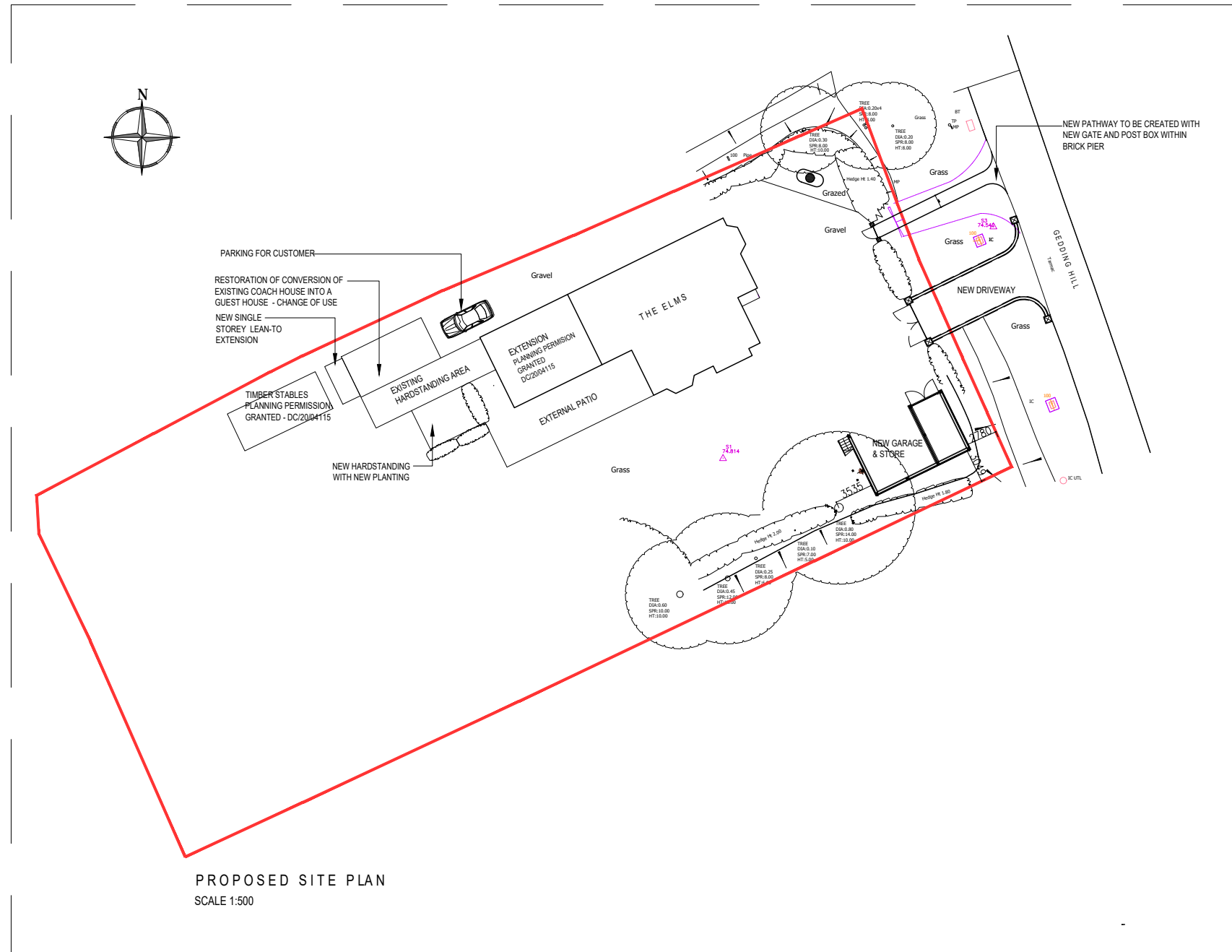

| | | | |
|---|----------|--------------------------------|----|
| G | 14/06/21 | ISSUED TO LOCAL AUTHORITY | VP |
| F | 18/01/20 | GARAGE ADDED | VP |
| E | 17/11/20 | CALOR GAS TANK ADDED | VP |
| D | 16/10/20 | PLANT RM AND STABLES RELOCATED | VP |
| C | 02/10/20 | ISSUED TO BMSDC FOR PLANNING | VP |
| B | 25/09/20 | ISSUED TO BMSDC FOR PLANNING | VP |
| A | 21/09/20 | ISSUED TO BMSDC FOR PLANNING | VP |

| REV. | DATE | PURPOSE | DRAWN |
|------|------|---------|-------|
|------|------|---------|-------|

CLIENT MR & MRS ENTWISTLE
 PROJECT THE ELMS, GEDDING HILL IP30 0QX
 TITLE PROPOSED SITE PLAN

| | | |
|----------|-------------|----------|
| REVISION | DWG No. | SCALE |
| G | SKK3266/004 | 1:500@A3 |
| DATE | DRAWN | CHECKED |
| JUL '20 | VP | APF |



INTERIOR, ARCHITECTURAL & RETAIL DESIGN

The Mill
 Stortford Road
 Hatfield Heath
 CM22 7DL

Tel: 01279 873010
www.senkenken.com