



Notes

1. All levels and dimensions are to be checked on site before any work commences. All dimensions are in metres unless stated otherwise.
2. Any discrepancies shall be reported to the architect and/or engineer immediately, so that clarification can be sought prior to the commencement of works.
3. This drawing shall be read in conjunction with all other relevant architect and engineering details, drawings and specification.
4. All works to be in accordance with the Specification for Highway Works.
5. Refer to Statutory Undertakers records for details of apparatus present within the construction areas. Chambers are to be adjusted where required to match new levels. The main contractor is to coordinate all diversionary works.
6. The contractor is to complete the Section 278 Works within the existing highway boundary. There is no agreement with adjacent landowners for use of their property.

Legend

- Existing Highway Boundary
- Site Boundary
- Proposed New Highway Boundary

- S278 Carriageway
- S278 Footway
- S278 Landscaping
- S38 Carriageway
- S38 Footway
- S38 Landscaping

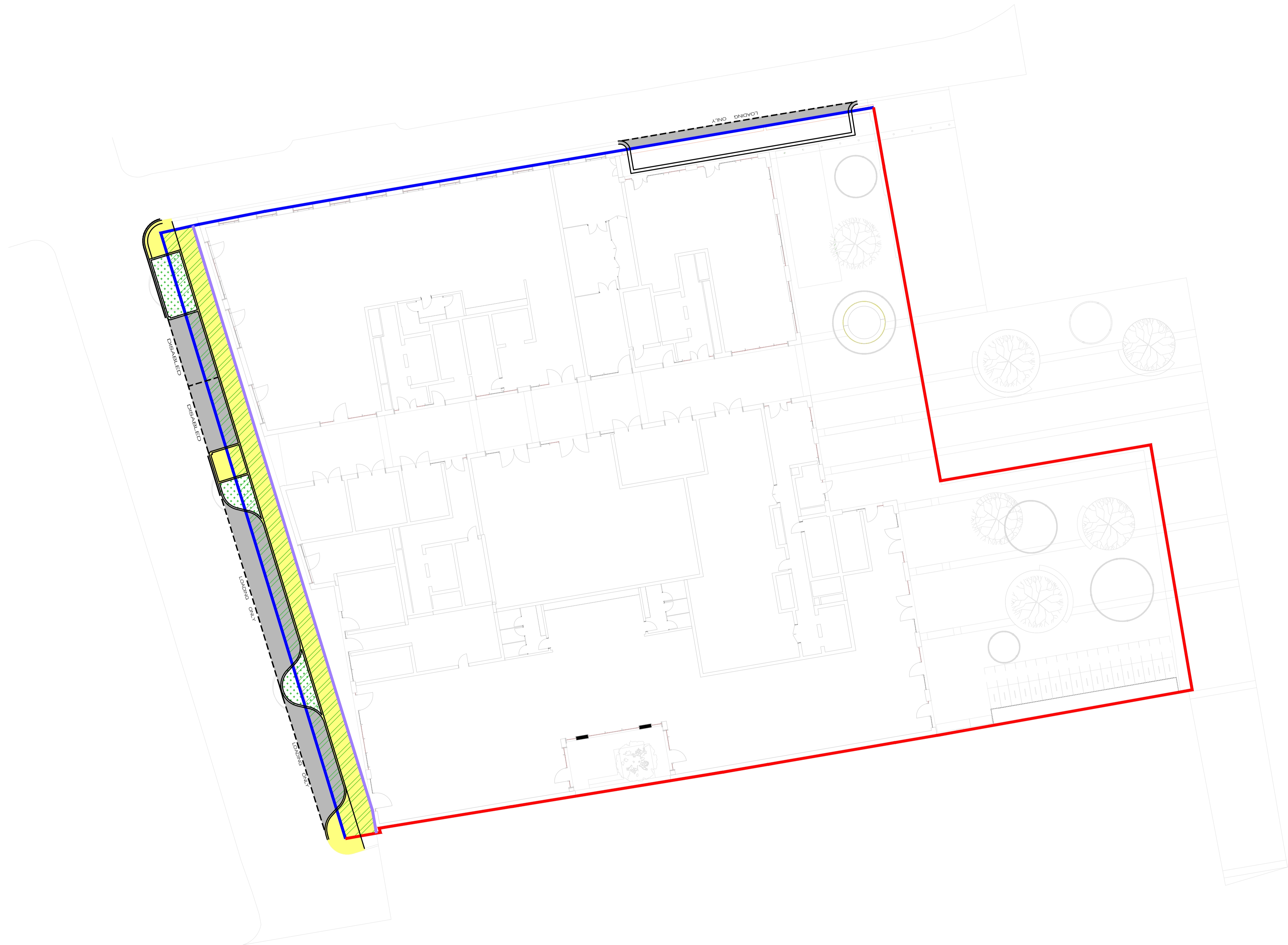

C	Areas of Adoption revised following comments	NM	JM	JM	11/04/21
B	First Issue - Southwark Council	NM	JM	JM	03/03/21
A	First Draft Issue	NM	JM	JM	26/02/21
Revision Notes:		Dm	Chk	App	Date

Drawing Status:
FOR APPROVAL
NOT FOR CONSTRUCTION

84 North Street
Guildford
Surrey
GU1 4AU

9 Greyfriars Road
Reading
Berkshire
RG1 1NU

Golden Cross House
8 Duncannon Street
London
WC2N 4JF

01483 531300

0118 206 2930

020 7031 8141

www.motion.co.uk

Client:
Southern Housing Group

Project:
49-53 Glengall Road, Southwark

Title:
Section 38 / 278 Agreement

Scale: 1:200	Size: A1	Project No: 2008016	Revision:
Drawing: 2008016-0101-01			C

