

Note: The contractor will be held to have examined the site and determined all dimensions and levels before commencing construction work. No assumption should be made without reference to the architect. No dimensions should be scaled from drawing.

Revision Description Date By

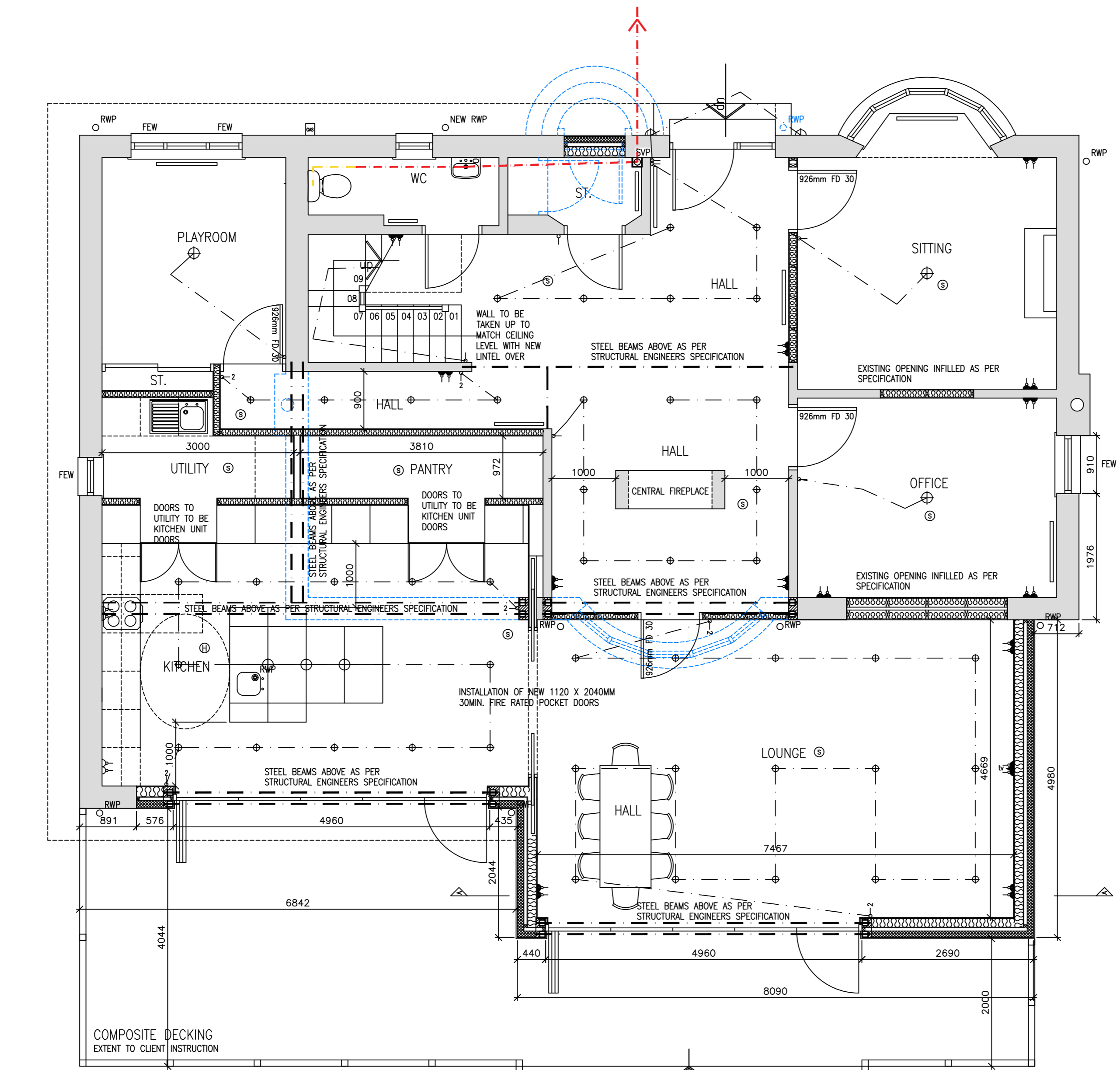

- LEGEND**
- 13A DOUBLE SOCKET AT LOW LEVEL
  - SWITCHED SPUR AT LOW LEVEL
  - 13A DOUBLE SOCKET AT HIGH LEVEL
  - 1 GANG 1 WAY SWITCH
  - 1 GANG 2 WAY SWITCH
  - CEILING POINT
  - DOWNLIGHTER
  - EXTERNAL WALL LIGHT
  - CEILING MOUNTED MECHANICAL EXTRACT
  - TV POINT
  - TELECOM POINT
  - COOKER CONTROL UNIT
  - 240V IONISATION SMOKE DETECTOR
  - RADIATOR
  - HEAT DETECTOR
  - WALL MOUNTED MECHANICAL EXTRACT
  - CARBON MONOXIDE DETECTOR
  - ELECTRICITY BOX
  - GAS SUPPLY TO PROPERTY
  - BOILER

- EXISTING DRAINAGE
- NEW DRAINAGE
- DENOTES DOWNTAKINGS

**GROUND FLOOR PLAN AS PROPOSED**

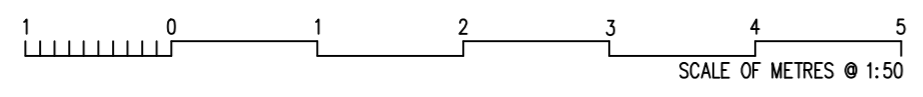

t: 07403 232228  
 e: colin@thehomearchitect.co.uk  
 www.thehomearchitect.co.uk



Issue for <b>PLANNING &amp; WARRANT</b>		
Client MR ABDUL QAYAM		
Project Title TWO STOREY REAR EXTENSION 9 HILLCREST DRIVE, NEWTON MEARNES, G77 5HH		
Drawing Title GROUND FLOOR PLAN AS PROPOSED		
Scale 1:50 @ A2	Date 19/05/2021	Job No. A145
Drawn by CK	Checked by CK	Sheet Size A3
Drawing No. AL(00)009		Rev. --