

General Notes:

All dimensions must be checked on site prior to commencing the works and errors and omissions to be reported to the Architectural Designer.

All works shall conform to the current edition of the Building Regulations and other statutory requirements.

All materials and workmanship shall conform with the relevant British Standard Specifications and Code of Practice.

All dimensions are in mm unless otherwise stated.

If this drawing incorporates information from other professions, the Architectural Designer does not accept responsibility for the integrity and accuracy of such information.

If this drawing forms part of an application for Planning Permission on behalf of the applicant named below, it must not be used for constructional purposes or for any other purpose whatsoever. Copyright of the drawing design is and shall remain the Architectural Designer's. All copies are only for information about the application and must not be used for any other purpose.

© Alex Coleman Associates 2021

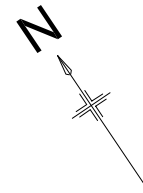

No.9

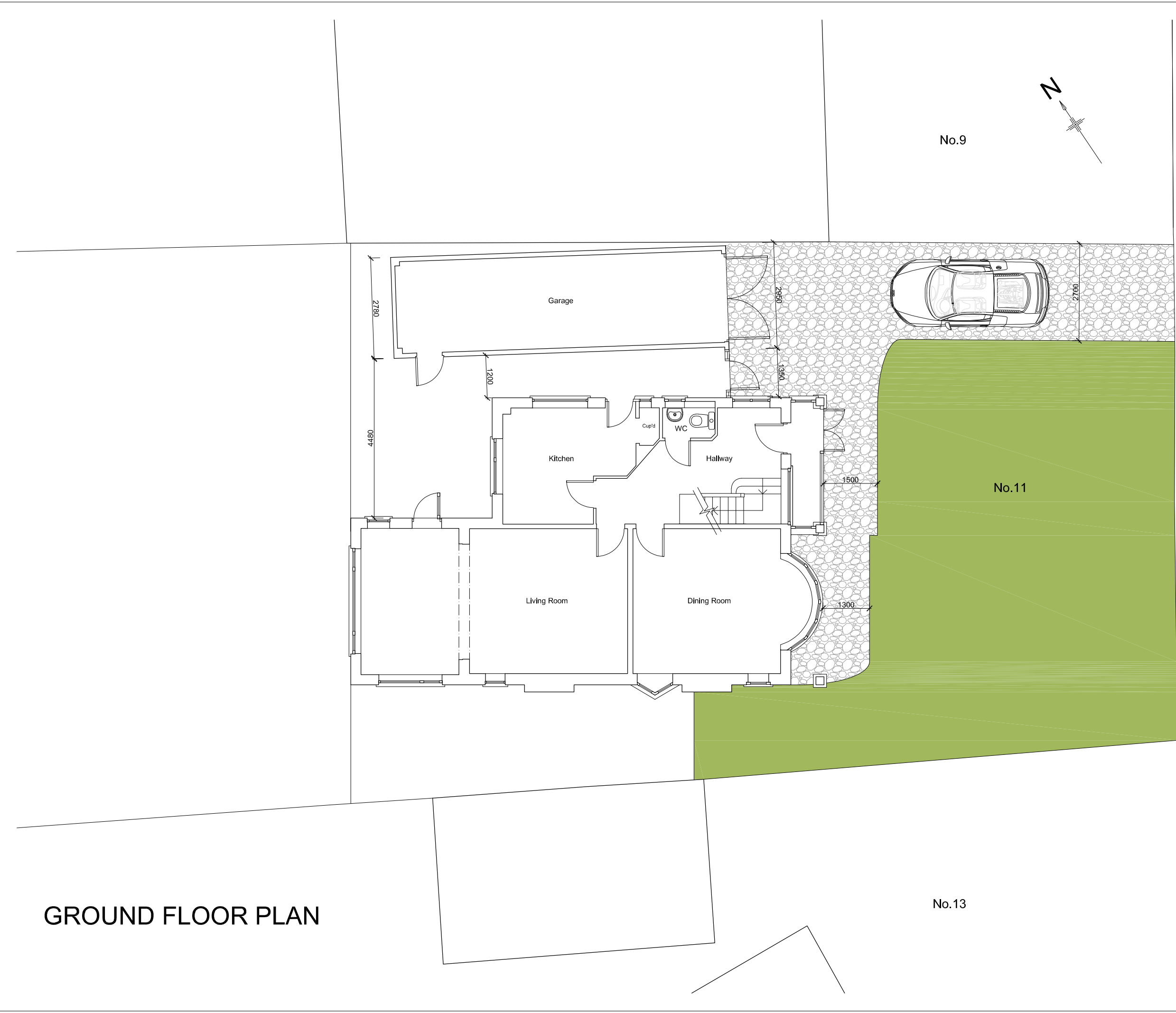

HIGHER GREEN

No.11

No.13

GROUND FLOOR PLAN

REVISION	DESCRIPTION	DATE
CLIENT MR A. HAYES		
CONTRACT HOUSE EXTENSION AND ALTERATIONS, 11 HIGHER GREEN, EWELL, SURREY KT17 3BB		
DESCRIPTION GROUND FLOOR PLAN - EXISTING		
alex coleman associates architecture and design		
<small>40 Copse Edge Avenue, Epsom, Surrey KT17 4HS Tel: 01372 742535 Email: alex@alexcoleman.com www.alexcoleman.com</small>		
SCALE: 1:50@A1; 1:100@A3	DATE 11/07/19	
DRAWN AJC	DRAWING No. 01913-010 PLANNING	REVISION -
PLOT DATE = 17/05/2021		