

**GENERAL NOTES:-**

1. PLANNING APPLICATION, NEW STAND ALONE TIMBER SHED SITTING ON A 100mm THICK CONCRETE SLAB LAD ON A COMPACTED HARD CORE OR SIMILAR SLAB BASE. NEW CONCRETE SLAB DATTIN TO BE 150mm BELOW EXISTING DPC. NEW SHED TO HAVE A FOOT PRINT OF 3.6m x 2.5m AND SHALL NOT EXCEED 2.5m IN HEIGHT. ACCESS IS VIA A SINGLE DOOR LOCATED IN THE SOUTH ELEVATION SIDE.
2. FOR INFORMATION ONLY, THE EXISTING PAVING IS TO BE EXTENDED TO CONNECT THE NEW SHED, A NEW PERGOLA TO BE CONSTRUCTED TO THE SOUTH EAST CORNER, THE GATE TO THE PADDOCK AREA IN THE SOUTH EAST CORNER AND A NEW PERGOLA ADJACENT TO THE HOUSE. ALL NEW PATHWAYS ARE TO BE 1100mm WIDE. PLEASE NOTE THAT THIS ACCESS GATE IS SHOWN ON THE ORIGINAL EDEN HALL PLANNING DOCUMENTS.
3. FOR INFORMATION ONLY, THE WINDING PATH LINKING THE PERGOLA ADJACENT TO THE HOUSE AND THE NEW PADDOCK GATE IS TO BE COVERED BY A 1500mm WIDE PERGOLA OR COVERED WALKWAY
4. PRF: 1000mm HIGH POST AND RAIL FENCE
5. CBF 1: 2000mm HIGH CLOSE BOARDED FENCE
6. CBF-TP: CLOSE BOARDED TRANSITION PANEL

**IF IN DOUBT ASK DO NOT SCALE**

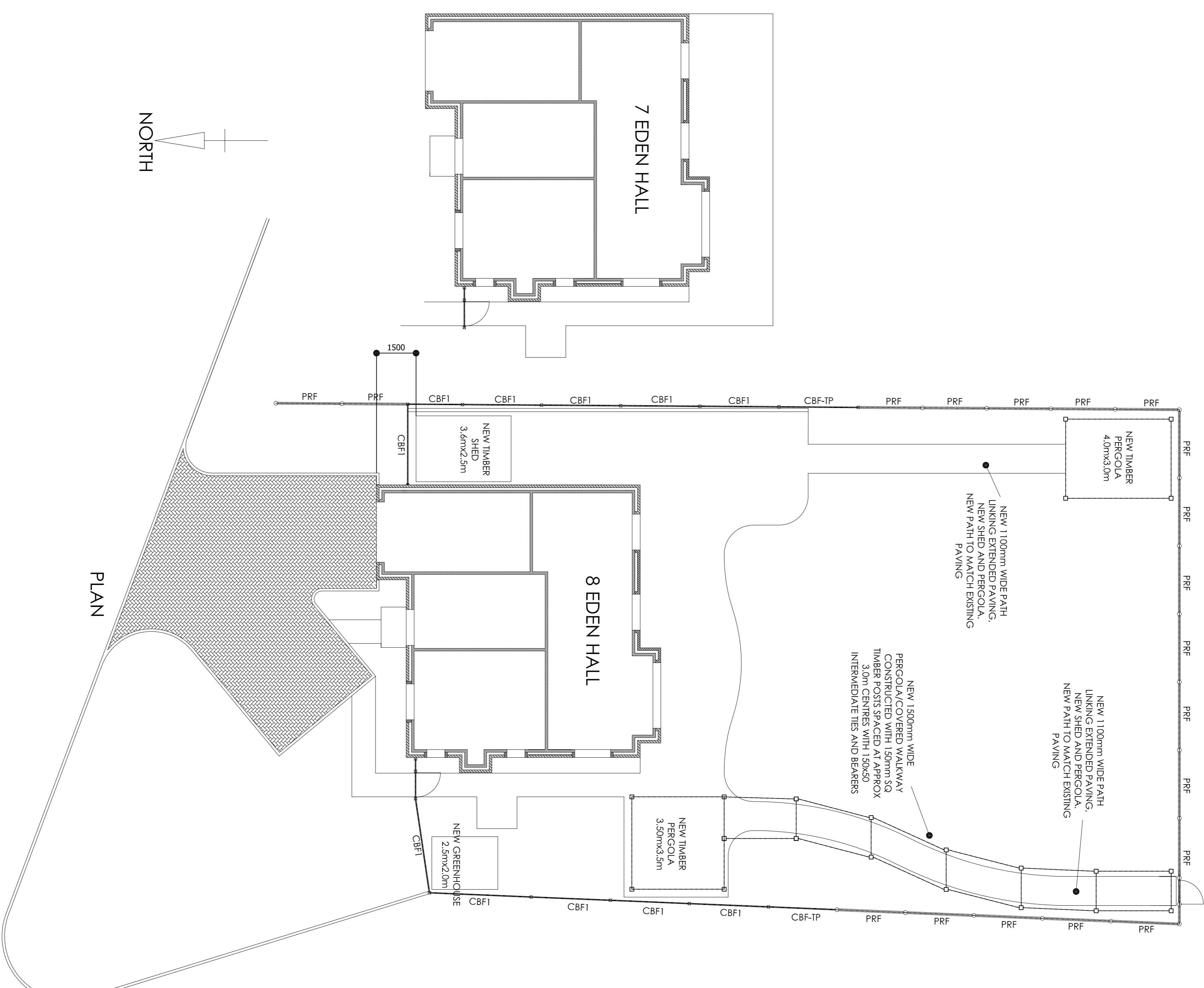

PLAN

NORTH

REV	NAME DATE
A:	
B:	
C:	
D:	
E:	

TITLE :- PROPOSED NEW GARDEN SHED - PLANNING APPLICATION DOCUMENT

SITE 8 EDEN HALL  
STOCK HILL  
EDENBRIDGE KENTING SQ

CLIENT:- Mr & Mrs P O'Dell  
CONTRACTOR:-

DATE:- 27.05.2021

DESIGN BY:- GG SCALES:- 1:100

DRAWN BY:- GG

CHECK BY:- DRG No:- PD-01-01

PLOT 1:1 @ A1

Rev