

## Akam Nicky

---

**From:** Foster Ben  
**Sent:** 17 June 2021 15:50  
**To:** Development Control  
**Subject:** FW: Written Direction, 21/00913/FULL - 11 Malvern Avenue

Invalid application and email below for scanning.

Thanks

Ben

Ben Foster  
Development Management Officer  
Development Control  
Planning Services  
Hull City Council  
The Guildhall  
Alfred Gelder Street  
Hull  
HU1 2AA

Email: [ben.foster@hullcc.gov.uk](mailto:ben.foster@hullcc.gov.uk)  
Tel: (01482) 612483  
Web: <http://www.hull.gov.uk>

**LGO Awards**  
2019

Winner



---

**From:** Foster Ben  
**Sent:** 17 June 2021 15:50  
**To:** [REDACTED]  
**Subject:** Written Direction, 21/00913/FULL - 11 Malvern Avenue

Dear Paul,

The application you have submitted is lacking the items **listed** and this is a written direction requiring you to submit the items.

The Council is expected to deal with your application within 8 weeks of receiving all the information required. The application will not be processed and the 8 week period will not begin until the Council has received the items referred to on the attached list.

If you disagree with this requirement you have the right of appeal to the Secretary of State against non-determination of the application. This appeal can be made on the expiry of 8 weeks from the date the application was lodged (specified above). Details of how to appeal are available on request.

---

**Information required:-**

1. **Sufficient Plans, drawings and other information necessary to describe the development the subject of the application:** The amount and nature of information required will vary with each application. All plans and drawings must include the following information: the scale of the drawing, the original paper size, key dimensions and a scale bar indicating a minimum of 0-10 metres, see example at the bottom of this list.

- **Please include overall height and eaves height on proposed plans**

**Local Requirements for the Submission of Applications Under the Planning Acts**

(please discuss the following requirements with the Planning Officer prior to submission to discuss the extent of the necessary information).

1. Heritage Statement

**Example of information required on submitted drawings:-**

The scale of the drawing, the original paper size, key dimensions and a scale bar indicating a minimum of 0-10 metres.

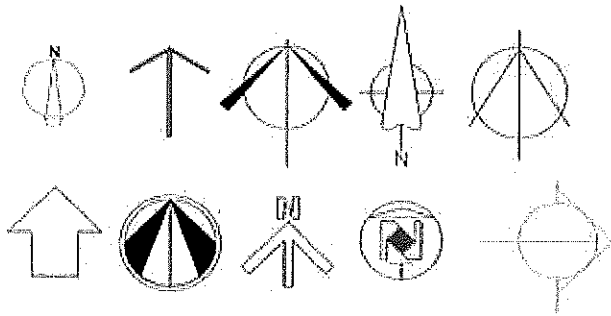
**North Point Indicators****Plan Scale examples (Scale and paper size of the plan that it is reproduced on)**

1:500@A1, 1:100@A3, 1:1250@A4, 1:500@A2

**Key Dimensions**

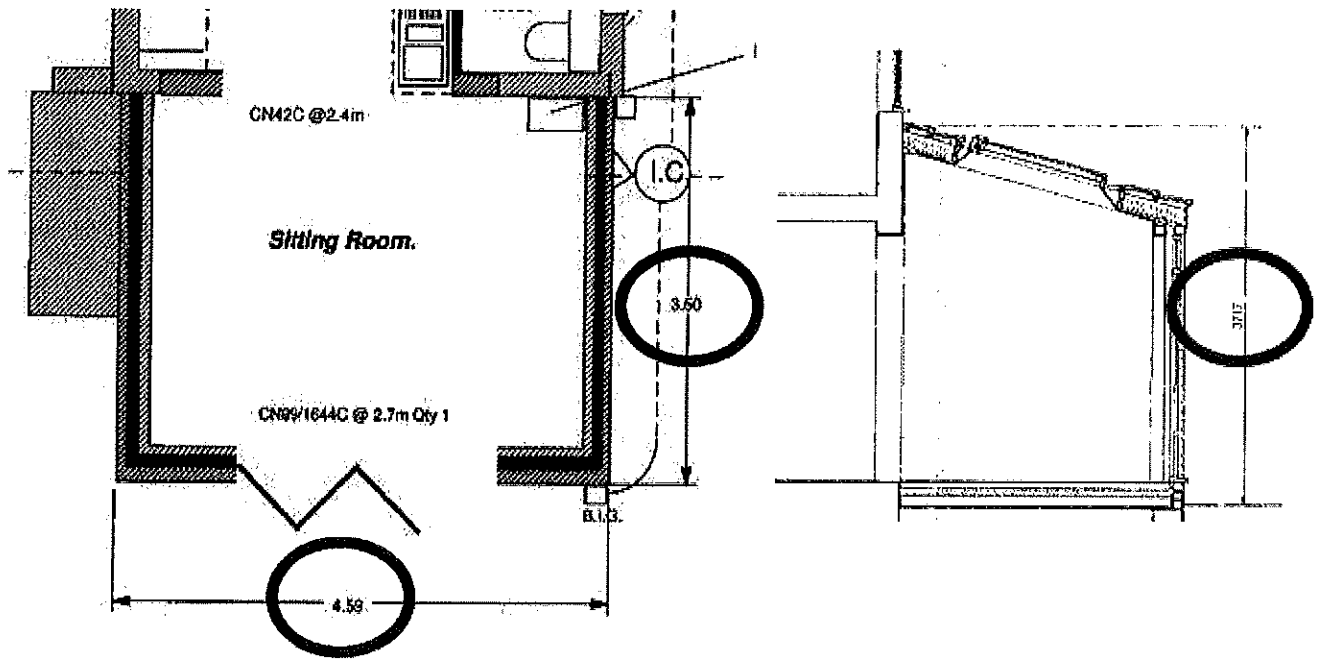

**Scale Bar**



Yours Faithfully

Ben Foster  
 Development Management Officer  
 Development Control  
 Planning Services  
 Hull City Council  
 The Guildhall  
 Alfred Gelder Street  
 Hull  
 HU1 2AA

Email: [ben.foster@hullcc.gov.uk](mailto:ben.foster@hullcc.gov.uk)  
 Tel: (01482) 612483  
 Web: <http://www.hull.gov.uk>



