





- LEGEND
-  Application boundary
 -  Existing tree with associated root protection area (RPA)
 -  Building to be removed
 -  Associated landscape features to be removed - such as fencing, paving, ramps etc



Robert Bray Associates
Sustainable Drainage Consultants + Landscape Architects

Project name: Kingston Hill University Campus
 Drawing title: Demolition Layout Plan
 Status: Planning Date: 18.05.2021
 Drawing no: RBA-KHC-025 Sheet: - Rev: A
 Scale: 1:200 @A1 Drawn by: MH Approved by: MH

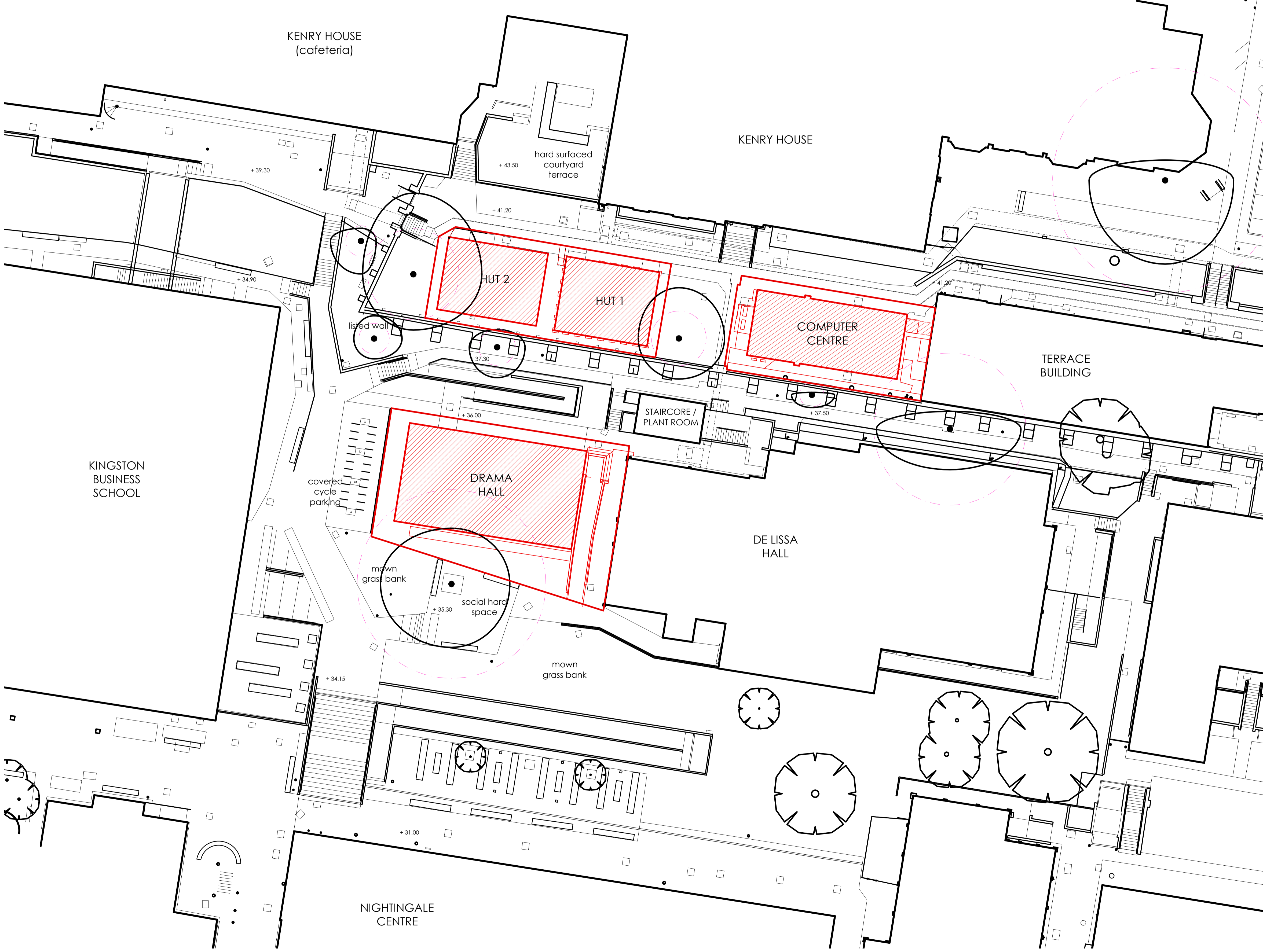
Robert Bray Associates Ltd :: 9 New Mills Libbys Drive Stroud GL5 1RN
 tel 01453 763116 :: info@robertbrayassociates.co.uk :: www.sustainable drainage.com

Copyright Robert Bray Associates Ltd. Robert Bray Associates accepts no liability for any use of this document other than for its original purpose, or by the original client, or following Robert Bray Associates express agreement to do such. No dimensions are to be scaled from this drawing, all measurements are to be checked on site. If in doubt please ask.