



LEGEND

-  Application boundary
-  Existing tree with associated root protection area (RPA)
-  Proposed temporary hoarding, 1.8m high

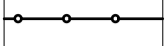
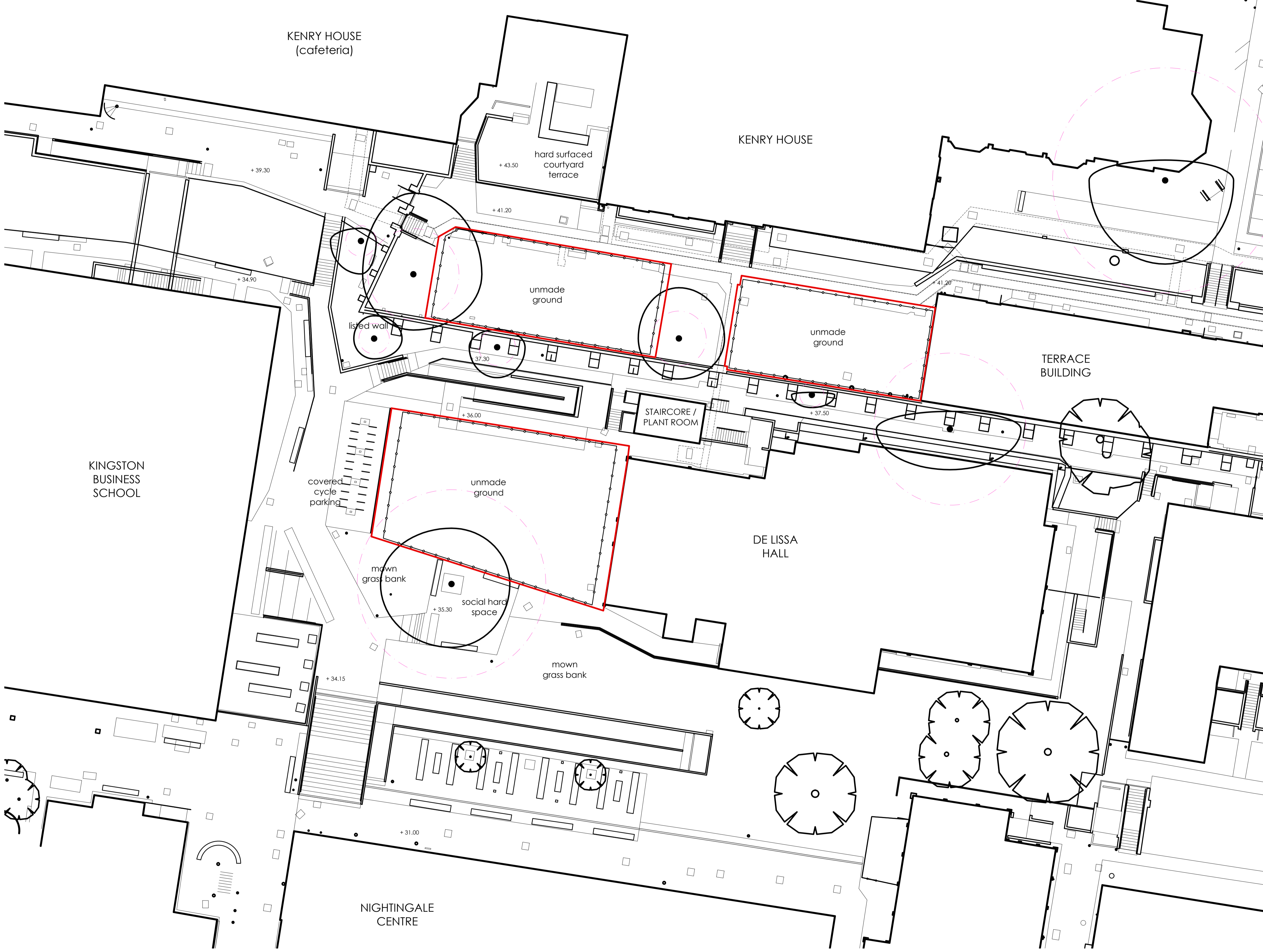

KINGSTON
BUSINESS
SCHOOL

KENRY HOUSE
(cafeteria)

KENRY HOUSE

TERRACE
BUILDING

STAIRCORE /
PLANT ROOM

DE LISSA
HALL

NIGHTINGALE
CENTRE

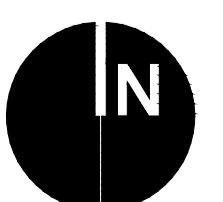

Robert Bray Associates
Sustainable Drainage Consultants + Landscape Architects

Project name: Kingston Hill University Campus

Drawing title: Proposed Site Layout Plan

Status: Planning Date: 18.05.2021

Drawing no: RBA-KHC-024 Sheet: - Rev: A

Scale: 1:200 @A1 Drawn by: MH Approved by: MH

Robert Bray Associates Ltd :: 9 New Mills Libbys Drive Stroud GL5 1RN
tel 01453 763116 :: info@robertbrayassociates.co.uk :: www.sustainable drainage.com

Copyright Robert Bray Associates Ltd. Robert Bray Associates accepts no liability for any use of this document other than for its original purpose, or by the original client, or following Robert Bray Associates express agreement to do such. No dimensions are to be scaled from this drawing, all measurements are to be checked on site. If in doubt please ask.