

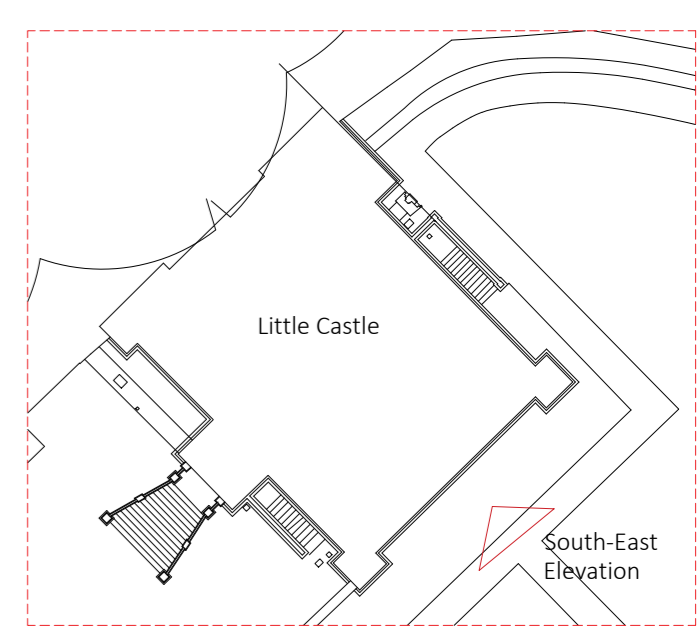

Note:
Do not scale from this drawing.
Dimensions are to be checked on site.
If in doubt please ask.

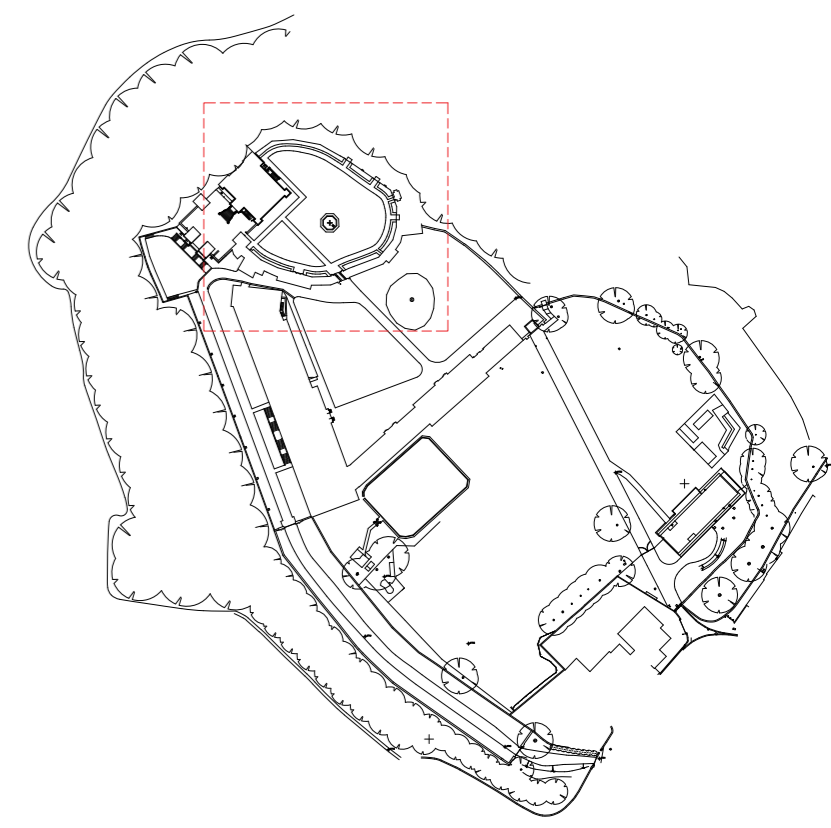

- Notes:
1. This drawing is to be read in conjunction with the Specification and the Structural Engineer's details.
 2. Final location of repairs and connections to be undertaken are to be agreed with the Architect/Structural Engineer on site.
 3. The Contractor is to ensure that allowance is made for further inspection and confirmation of repairs within the programme.
 4. All dimensions must be checked on site before proceeding.
 5. Dimensions of new work are to be adjusted to suit the existing elevation where necessary. Do not assume that the existing structure or details are plumb, square or level.
 6. The Contractor must report any discrepancies to the Architect before proceeding.
 7. Where blocks/stone are noted to be replaced, the contractor is to note that this is to match the existing and adjacent.



Roof Slope = 3 degree pitch
30mm dark anodised steel plate with 5mm rebate to underside perimeter, offset from edge by 20mm.
Steel fitch plated sandwiched between oak timber sections clamped using M12 dark anodised steel bolt sections.

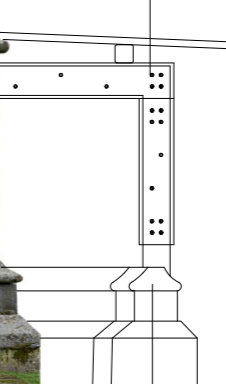

Existing coping stone to be carefully removed and replaced like-for-like to match existing. Lime mortar specification to match existing. Fabric to be reviewed on site with Architect.



Rev Date/Ints Details

© The moral rights of the author are hereby asserted.
This drawing and design is the sole property of Buttress Ltd and must not be reproduced without permission.
Buttress Ltd is Registered in England and Wales: 1368373

Buttress

41 Bengal St
Manchester
M4 6AF
T 0161 236 3303
E contact@buttress.net
W www.buttress.net

Project Title	BOLSOVER CASTLE - CANOPY		
Client	ENGLISH HERITAGE		
Location	BOLSOVER, CHESTERFIELD, S44 6PR		
Drawing Title	PROPOSED ELEVATIONS South East Elevation as Proposed		
Date	01/02/2021	Scale	1:50
Checked	EK	Orig Paper Size	A1
Status PLANNING			
Drawing ref	Job No	Drawing No	Revision
	9110	(05) 002	-