

Proposed location of timber frame and dark anodised steel roof canopy.

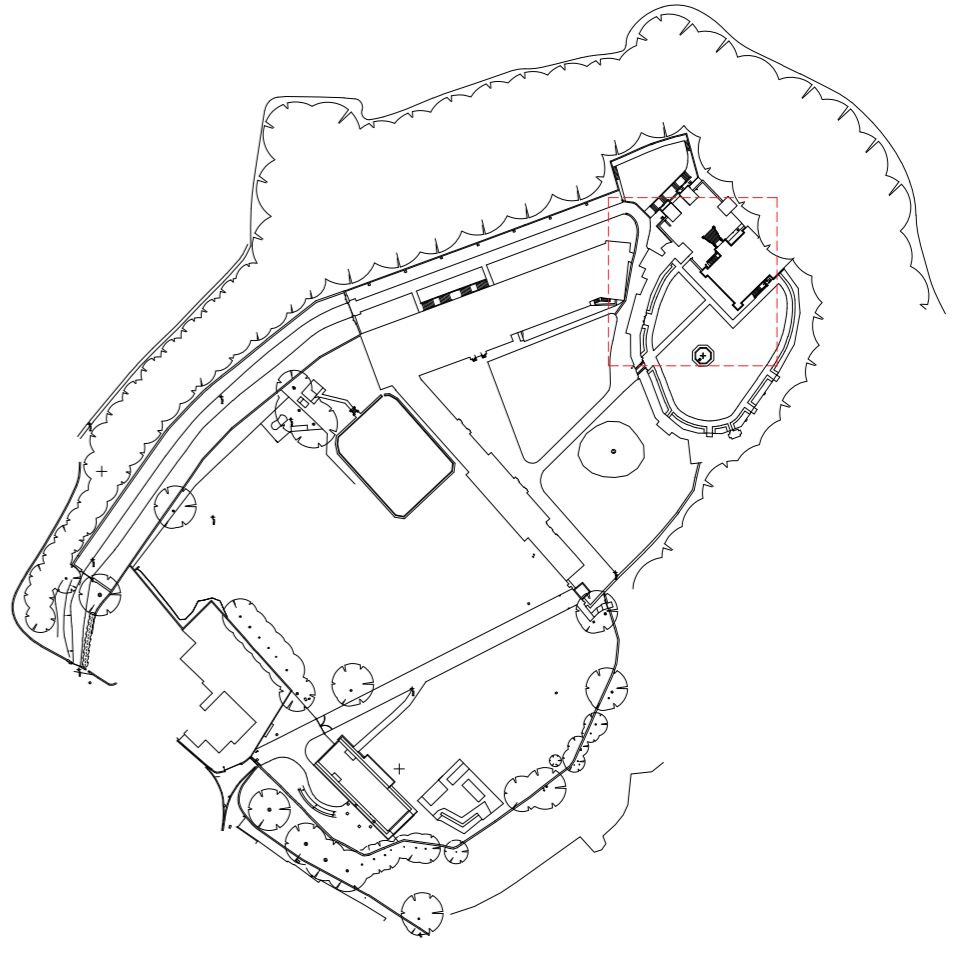

Note:  
Do not scale from this drawing.  
Dimensions are to be checked on site.  
If in doubt please ask.

- Notes:
1. This drawing is to be read in conjunction with the specification and the Structural Engineer's details.
  2. Final location of repairs and connections to be undertaken are to be agreed with the Architect/Structural Engineer on site.
  3. The Contractor is to ensure that all work is made for further inspection and approval by the Architect/Structural Engineer.
  4. All dimensions must be checked on site before proceeding.
  5. Dimensions of new work are to be adjusted to suit the existing elevation where necessary. Do not assume that the existing elevation is correct.
  6. The Contractor is to ensure that any work is done in accordance with the Architect's specifications.
  7. Where blocks/some are noted to be replaced, the contractor is to note that this is to match the existing and adjacent.

Rev Date/Info Details

© The visual rights in this drawing are hereby granted.  
This drawing is the property of Butress and no part of the reproduction without permission.  
Butress is not responsible for any errors or omissions.  
www.butress.net

# Butress

41 Bengali St  
Manchester  
M4 6JF  
T 0161 236 3303  
E contact@butress.net  
W www.butress.net

**Project Title** BOLSOVER CASTLE - CANOPY  
**Client** ENGLISH HERITAGE  
**Location** BOLSOVER, CHESTERFIELD, S44 6PR  
**Drawing Title** PROPOSED PLANS  
Canopy Plan as proposed

**Date** 01/02/2021 **Scale** 1:100  
**Checked** EK **Orig Paper Size** A1

**Status** PLANNING

**Drawing ref** Job No Drawing No Revision  
**9110** (04) 001 -