

site plan as proposed - scale 1:200

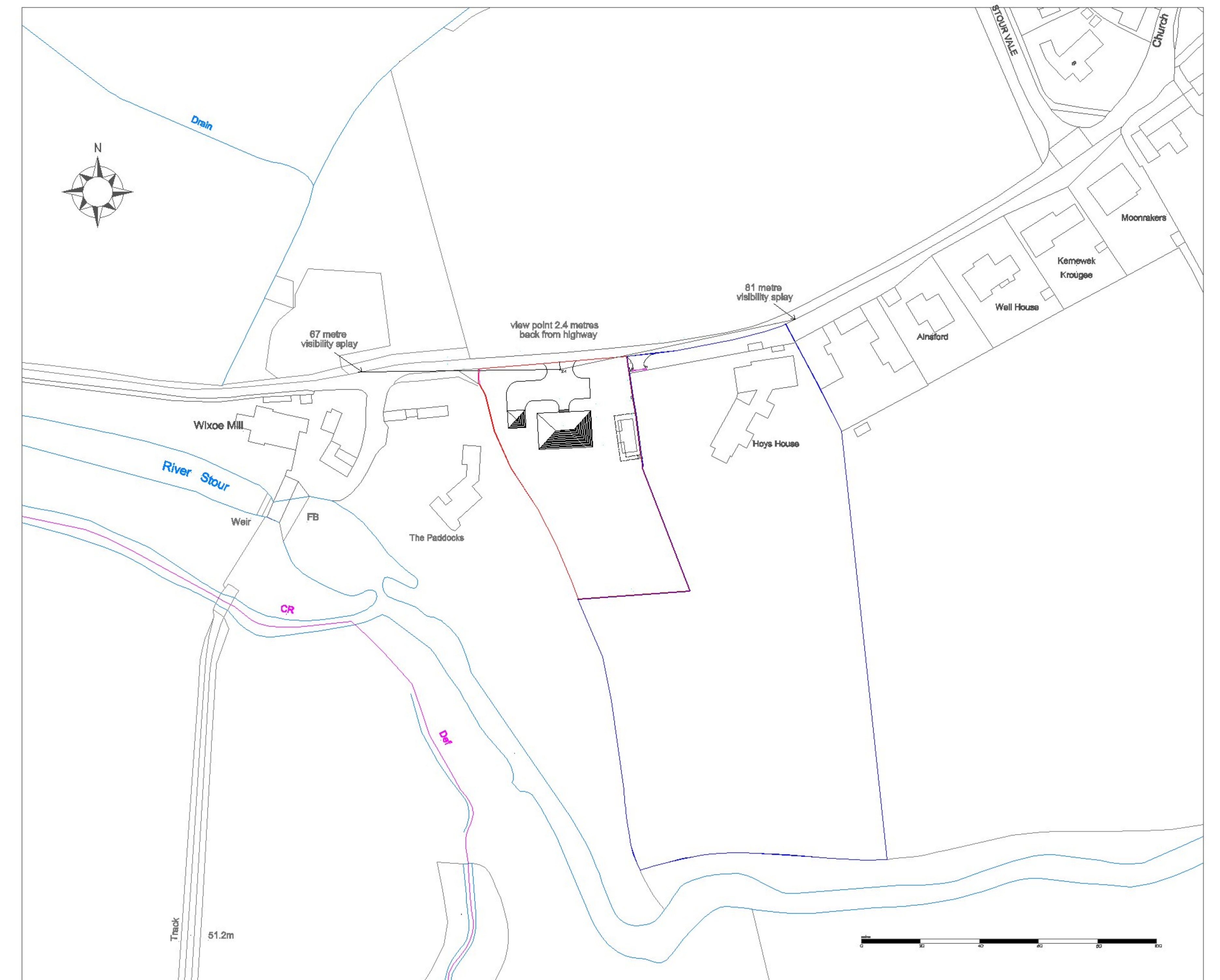

location plan - scale 1:250
(showing visibility splays)

Michael Sale M.R.I.C.S. F.C.I.O.B.
Architectural Surveyors
16 Dane Close, Kedington,
Haverhill, Suffolk. CB9 7NX
Telephone: 01440 702106
Fax: 08707 065471
email: info@michaelsale.co.uk
website: www.michaelsale.co.uk

Proposed new dwelling within the
curtilage of
Hays House,
Wixoe, Stoke by Clare,
Sudbury, Suffolk.
CO10 8UD

For Mr & Mrs L. Nicoll

Drawing No: 9198/21/1
Scale: 1:200 & 1:250
Drawn By: Nicola Sale
Checked By: Michael Sale
Date: April 2021