

■ Proposed Structure
 ■ Existing Structure

Lean to addition to north range for stove and inglenook. Stove with metal flue

New limed oak clad dormer window with zinc standing seam roof

North range extension with glazed black pantiles to match existing. Reuse existing and reclaimed pantiles from the existing link where possible.

North range to be extended, internally altered and reclad with limed oak vertical boarding and a red brick plinth to match existing. Extension to match form of existing north range.

New single storey link building with zinc standing seam roof.

New limed oak post and beam covered loggia with zinc standing seam roof.

New side extension with oak post and beam covered loggia to the south. Zinc standing seam roof.

New timber external stairs with brick steps up to brick plinth line

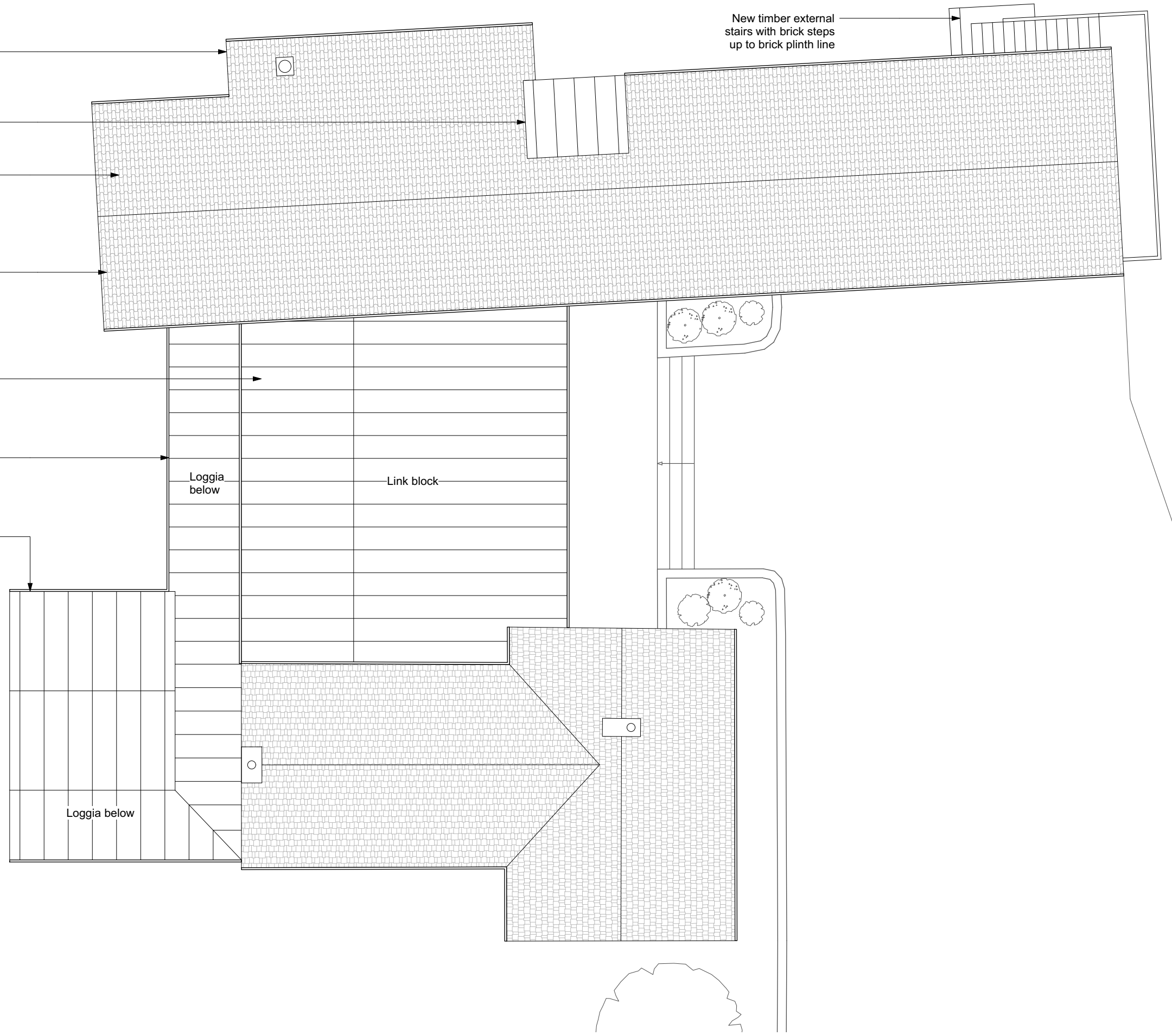

Notes:
 New sanitaryware throughout
 New electrical wiring throughout
 New windows throughout. All new windows in listed farmhouse to be with new painted hardwood casements to detail. Side hung lower casements and top hung fanlights, with Slimlite double glazed units.

PLANNING		

project orange
 1st Floor, Cosmopolitan House
 10A Christina Street, London EC2A 4PA
 T: +44 (0)20 7739 3035 F: +44 (0)20 7739 0103
 www.projectorange.com

P105
 Project
**OLD APPLECROFT FARM
 GREAT HENNY, SUDBURY**
 Roof Plan
PROPOSED

Job No.	Drawn	Date	Scale
2101	BC	25.06.21	1:100 @ A3 1:50 @ A1

THE COPYRIGHT DESIGN AND PATENTS ACT 1988 THIS DRAWING IS THE COPYRIGHT OF PROJECT ORANGE LTD AND MUST NOT BE COPIED OR REPRODUCED, IN WHOLE OR PART, BY ANY METHOD WHATSOEVER, WITHOUT THE PRIOR WRITTEN APPROVAL OF PROJECT ORANGE LTD
 NOTES
 ALL SETTING OUT MUST BE CHECKED ON SITE
 ALL LEVELS MUST BE CHECKED ON SITE
 ALL DIMENSIONS MUST BE CHECKED ON SITE
 DO NOT SCALE FROM THIS DRAWING
 THIS DRAWING MUST NOT BE USED ON SITE UNLESS ISSUED FOR CONSTRUCTION

1 Proposed Roof Plan
 1:100 @A3