

Notes: 24/06/2021 17:22:33

Drawings are based on survey data and may not accurately represent what is physically present.

Do not scale from this drawing. All dimensions are to be verified on site before proceeding with the work.

All dimensions are in millimeters unless noted otherwise.

Purcell shall be notified in writing of any discrepancies.

Key Plan
not to scale

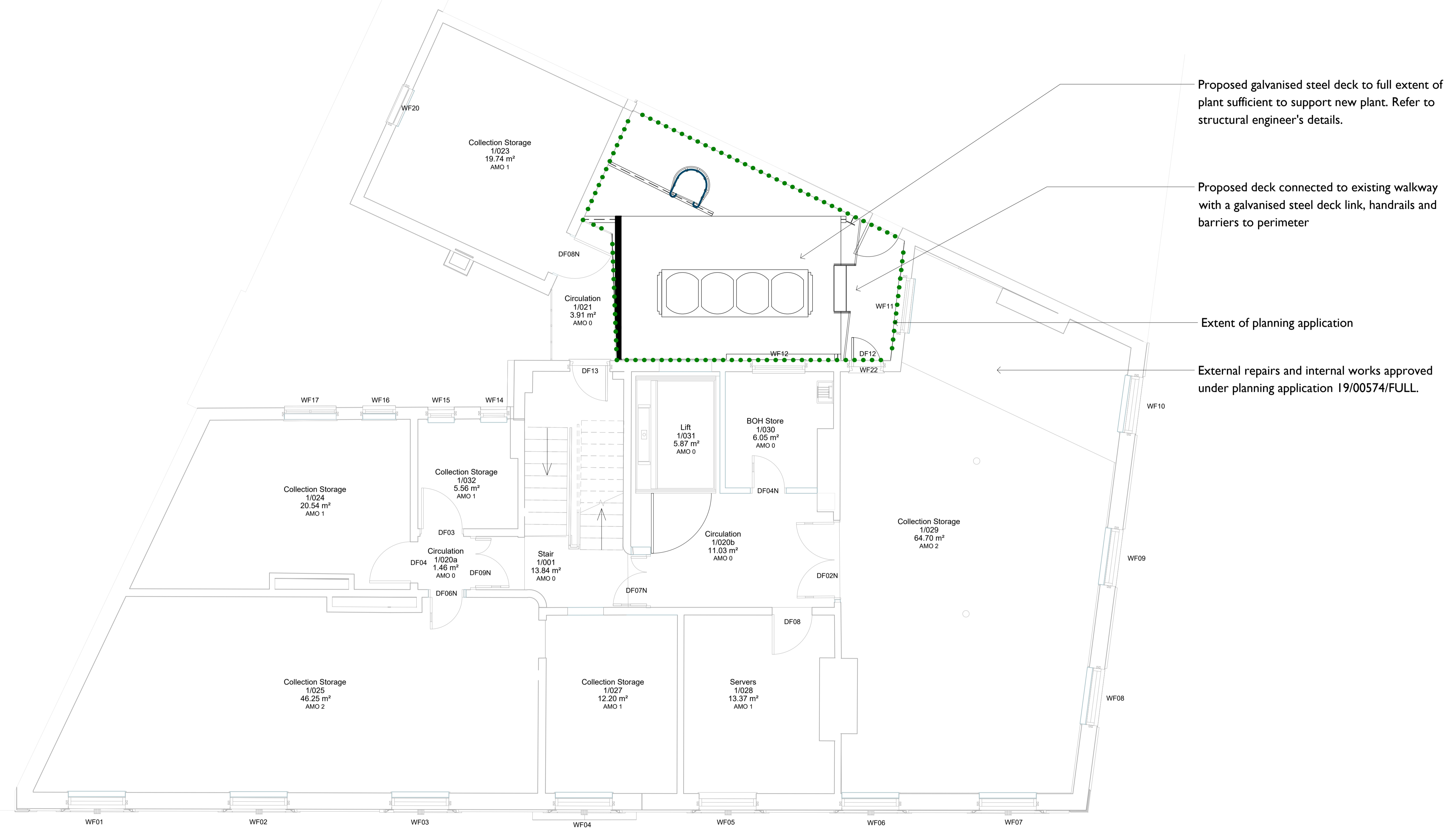

Proposed galvanised steel deck to full extent of plant sufficient to support new plant. Refer to structural engineer's details.

Proposed deck connected to existing walkway with a galvanised steel deck link, handrails and barriers to perimeter

Extent of planning application

External repairs and internal works approved under planning application 19/00574/FULL.

Proposal relates to plant deck only. All other external repairs and internal works approved under planning application 19/00574/FULL.

1 First Floor Plan - Proposed Plant Deck
9012 1 : 50

P01	24/06/2021	CH	CH	Planning
REV	DATE	BY	CHK	DESCRIPTION

CLIENT
Hull City Council

PROJECT

JOB NUMBER

PURCELL

TITLE
**First Floor Plan as Proposed
Plant Deck**

SIZE	SCALE	LAST REVISED	DRAWN	CHECKED
A1	As Shown	24/06/2021	CH	CH

REV SUITABILITY/REASON FOR ISSUE
P01 S4 - Planning

DRAWING NAME
HYMC-PUR-02-01-DR-A-9012