

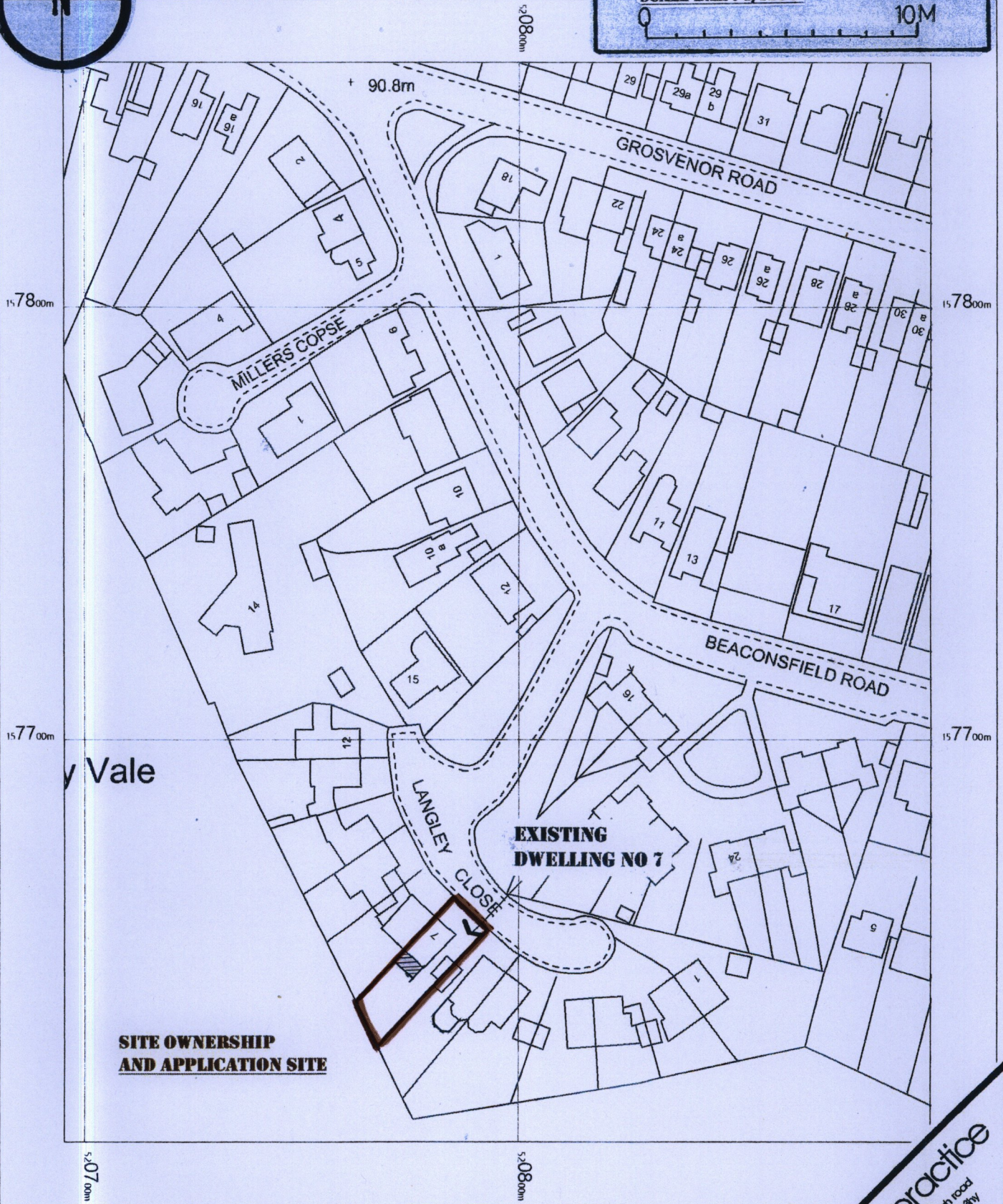

7, Langley Close

SCALE BAR : 1/1250

10M



PROPOSED LOCATION/OWNERSHIP PLAN : 1/1250

PROPOSED :- SINGLE STOREY REAR EXTENSION.

AT :- NO 7 LANGLEY CLOSE. EPSOM. KT13 6HG

derek salisbury practice
 hoddern house crowborough road
 nutley east sussex tn22 3xy
 telephone + fax 01825 713332

21.10/P01