

ISO A1 694mm x 841mm
 Approved: VB
 Checked: JW
 Designer: UM
 Project Management Initials:
 Filename: \\M:\MAN-001\JOB_NOZ47065487 BRUNSWICK PFI PLANNING\08 DRAWINGS\CIVIL\SITE SURVEY\ZONE 2 S278 DRAWINGS\PHASE 2 S278 DRAWINGS\CIVIL\SITE SURVEY\ZONE 2 - PHASE 2 S278 - DR-Z2-31.DWG

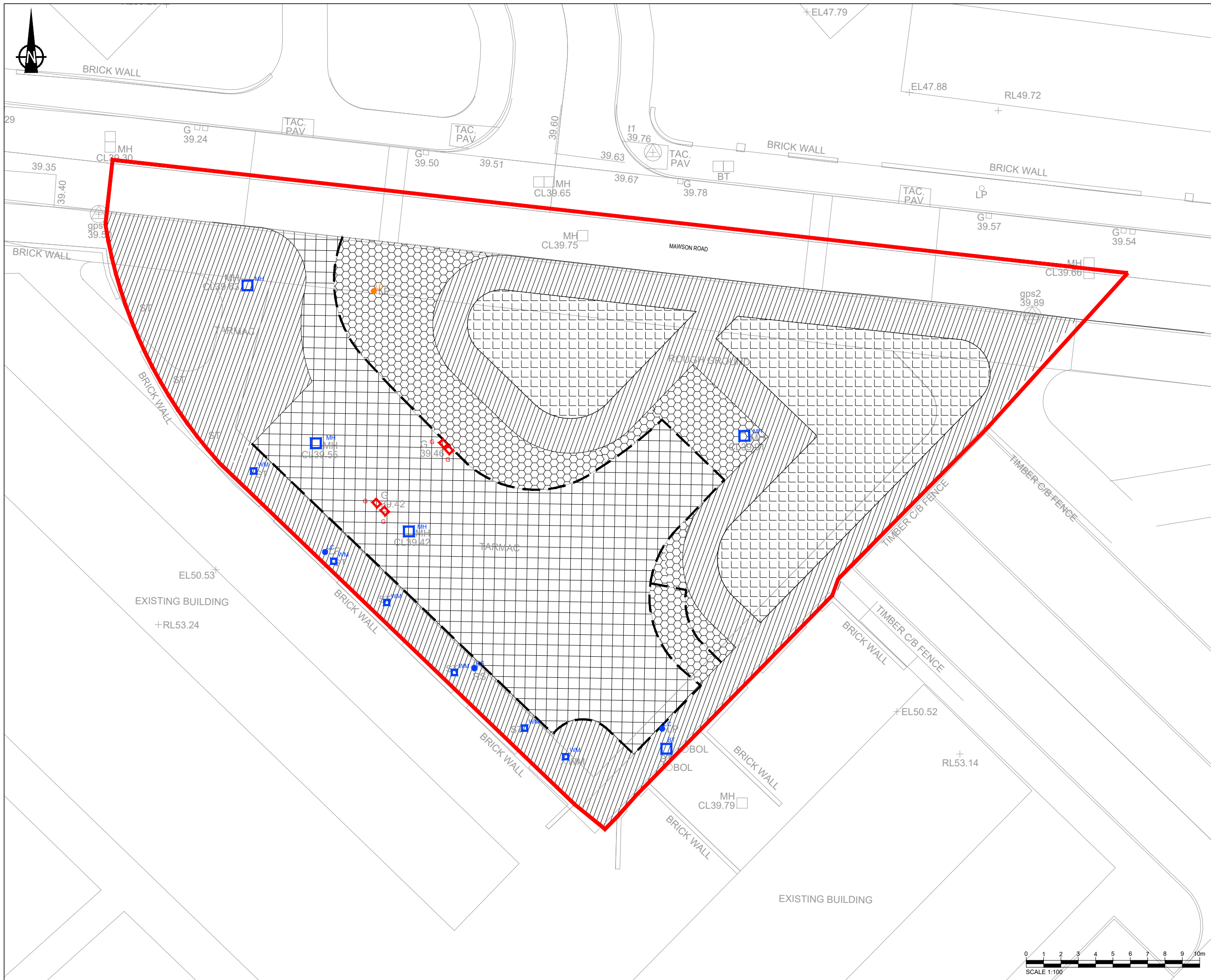

PROJECT
 Brunswick PFI

CLIENT



CONSULTANT
 AECOM Manchester
 1 New York Street,
 Manchester, M1 4HD
 0161 907 3500 tel 0161 907 3599 fax
 www.aecom.com

- NOTES**
1. DRAWN TO 1:100 SCALE @ A1
 2. IF RECEIVED ELECTRONICALLY, IT IS THE RECIPIENTS RESPONSIBILITY TO PRINT TO THE CORRECT SCALE. ONLY WRITTEN DIMENSIONS SHALL BE USED.
 3. THIS DRAWING IS FOR TECHNICAL APPROVAL ONLY.
 4. ALL WORKS TO BE INSTALLED IN ACCORDANCE WITH MANCHESTER CITY COUNCIL STANDARD DETAILS.
 5. TOPOGRAPHICAL SURVEY CARRIED OUT BY RJP SURVEYORS ON JANUARY 2021.

- KEY**
- S278 WORKS BOUNDARY
 - EXISTING KERBING TO BE REMOVED
 - EXCAVATION FOR DULL DEPTH CARRIAGEWAY CONSTRUCTION
 - EXCAVATION FOR FOOTWAY
 - EXTENT OF CARRIAGEWAY TO BE PLANNED AND RESURFACED
 - GENERAL SITE CLEARANCE FOR FUTURE LANDSCAPING
 - EXISTING MANHOLE/INSPECTION COVER TO BE RETAINED AND RESET TO THE PROPOSED LEVELS
 - EXISTING LIGHTING COLUMN TO BE RETAINED
 - EXISTING GULLEY TO BE REMOVED AND SET ASIDE FOR REUSE
 - EXISTING LIGHTING COLUMN TO BE RELOCATED

ISSUE/REVISION

IR	DATE	DESCRIPTION
P1	24.02.21	PRELIMINARY ISSUE

PROJECT NUMBER
 60470359

SHEET TITLE
 BRUNSWICK SECTION 278
 ZONE 2 - PHASE 2
 SITE CLEARANCE

SHEET NUMBER
 60470359-ACM-BS278-DR-Z2-31 P1

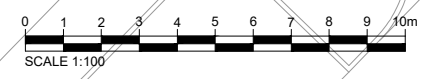

This drawing has been prepared for the use of AECOM's client. It may not be used, modified, reproduced or relied upon by third parties, except as agreed by AECOM or as required by law. AECOM accepts no responsibility, and denies any liability whatsoever, to any party that uses or relies on this drawing without AECOM's express written consent. Do not scale this document. All measurements must be obtained from the stated dimensions.