

RIEFIELD ROAD

Existing

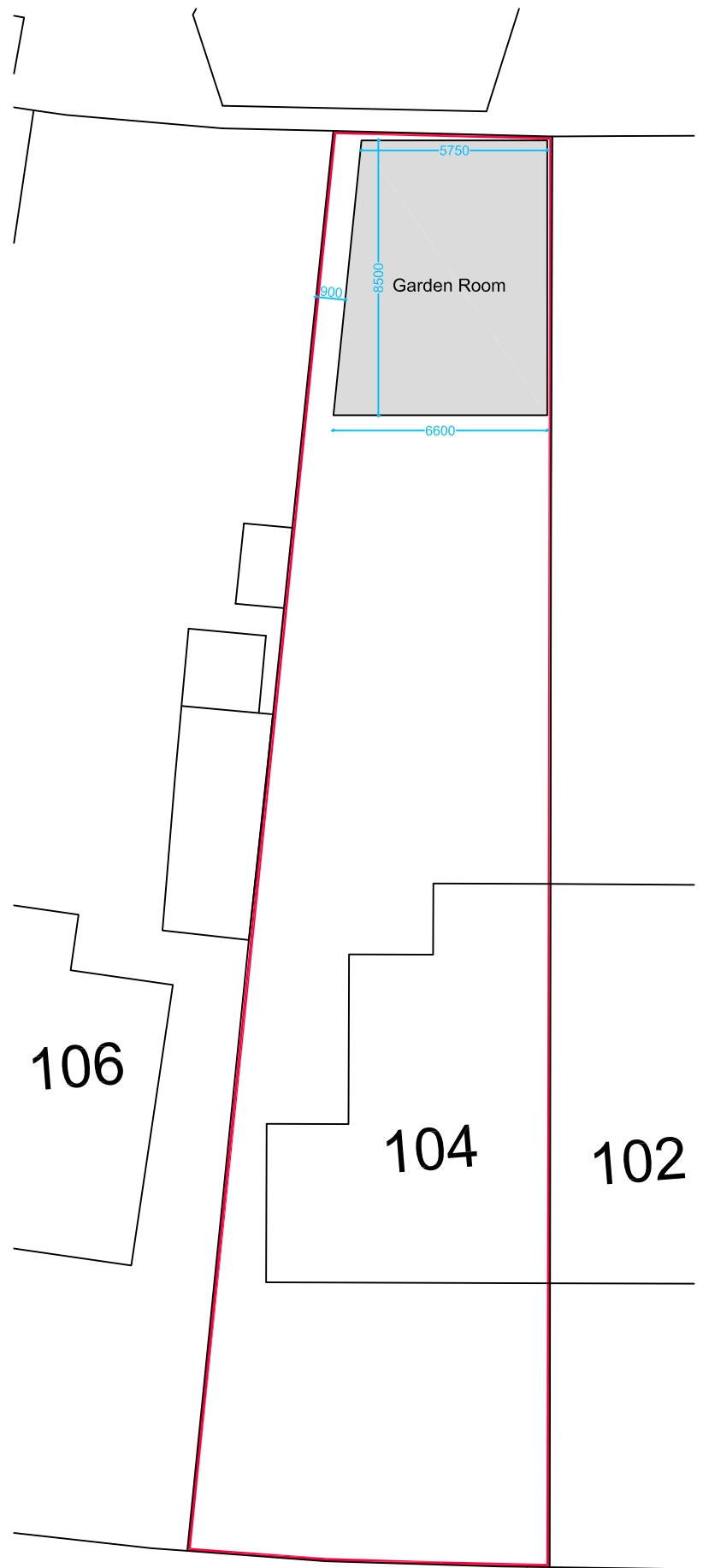

RIEFIELD ROAD

Proposed

| | |
|--|----------------------------|
| Existing Site Area | 398m ² |
| Existing House | 83m ² |
| Proposed Garden Room GFA | 52m ² |
| Total Area of Coverage | 135m ² |
| Percentage of Coverage in Site Area | 33.9% <50% Of Site Area |
| If proposed extension added, percentage of site: | 38% <50% Of Site Area |

project
104 Riefield Road
London
SE9 2RA

drawing
Existing Proposed:
Block Plan

| | |
|-------------------|-----------------|
| scale 1:200 A3 | date JUNE'21 |
| drawn AC | checked |

| | | |
|----------------|----------------|-----|
| job no 1481 | dwg no P.61 | rev |
|----------------|----------------|-----|

