

- NOTES
1. THIS IS AN A1 DRAWING, IF REPRODUCED IN ANY OTHER FORMAT THE SCALE SHOWN WILL BE INCORRECT.
 2. DO NOT SCALE OFF THIS DRAWING.
 3. ANY AMBIGUITIES, OMISSIONS AND ERRORS, OR INCONSISTENCIES WITH OTHER DOCUMENTS, ON THIS DRAWING SHOULD BE NOTIFIED IMMEDIATELY TO THE ARCHITECT BEFORE THE COMMENCEMENT OF WORKS ON SITE.
 4. ALL DIMENSIONS ARE IN MILLIMETRES UNLESS OTHERWISE STATED.
 5. ALL DIMENSIONS, UNLESS OTHERWISE STATED, ARE TO THE FACE OF UNFINISHED MASONRY WALLS OR TO THE FINISHED PLASTER FACE OF STUD PARTITIONS.
 6. ALL DIMENSIONS ARE TO BE CHECKED ON SITE. ANY DISCREPANCIES ARE TO BE NOTIFIED IMMEDIATELY TO THE ARCHITECT BEFORE THE COMMENCEMENT OF WORKS ON SITE.
 7. ALL LEVELS ARE IN METRES UNLESS OTHERWISE STATED.
 8. THIS DRAWING IS TO BE READ IN CONJUNCTION WITH ALL OTHER RELEVANT DRAWINGS AND SPECIFICATIONS FOR THIS PROJECT AND APPARENT INCONSISTENCIES BROUGHT TO THE ATTENTION OF THE ARCHITECT.

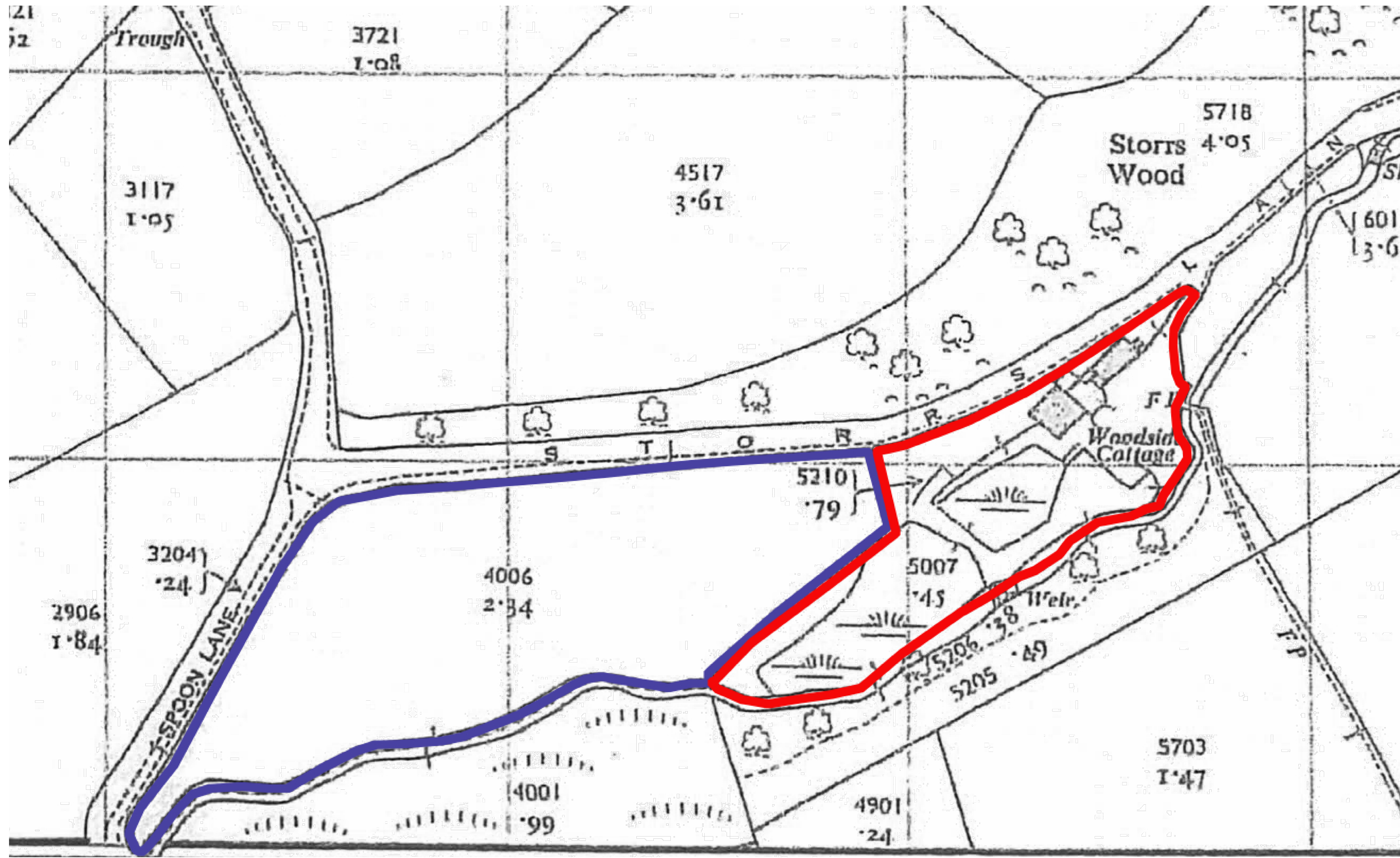

SAFETY, HEALTH AND ENVIRONMENTAL INFORMATION UNUSUAL SIGNIFICANT HAZARDS

It is assumed that all works will be carried out by a competent contractor working, where appropriate, to an approved method statement. In addition to the hazards/risks normally associated with the types of work detailed on this drawing, note the following:

Construction:	1.	
	2.	
	3.	
Cleaning/Maintenance:	1.	
	2.	
	3.	
Residual:	1.	
	2.	
	3.	

P03	09.06.21	Planning Issue	JMH	XX
P02	02.10.20	Planning Issue	JMH	XX
P01	18.09.19	Preliminary Issue	AC	XX
Rev.	Date	Content	By	Ckd

cbp architects

44 The Ropewalk Nottingham NG1 5DW
 t: 0115 9481144 f: 0115 9580976 w: cbp-arch.co.uk

Project
 Storrs Mill House, Extension

Drawing Title
 Location Plan

Scale 1:500 Date September 19
 Drawn JMH Checked xx

Drawing number 18157-A-0001 Revision P03

Reproduction subject to copyright Original sheet size A1

Location Plan
 Scale 1:500 @ A1

