

0 1m 2m 3m 4m 5m

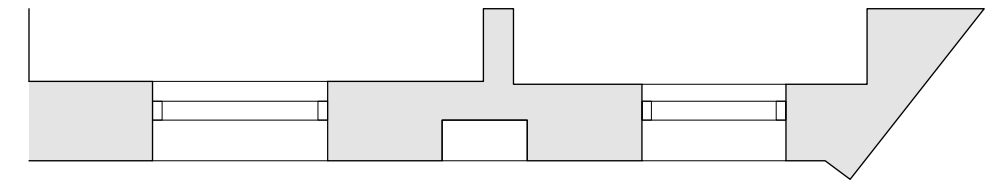
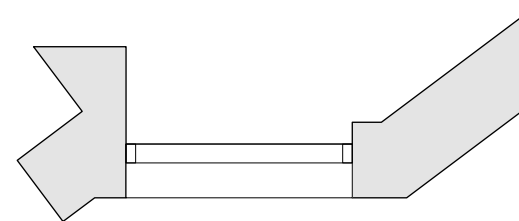
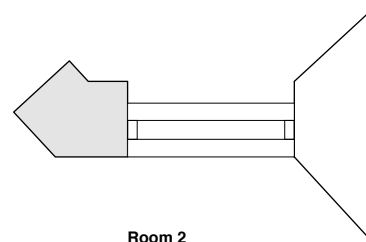
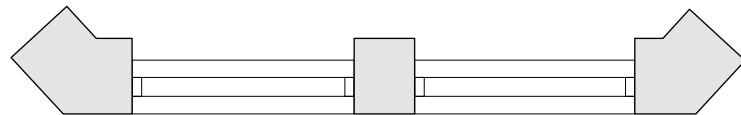
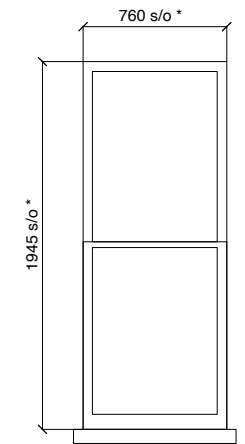
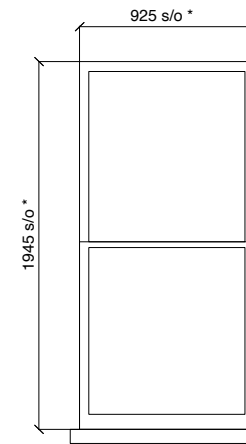
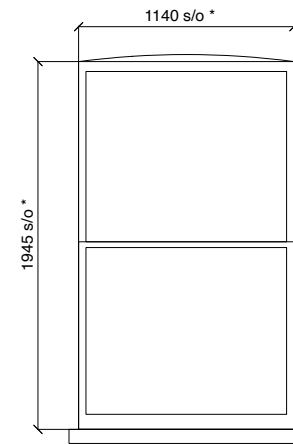
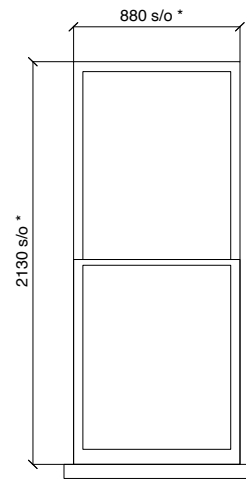
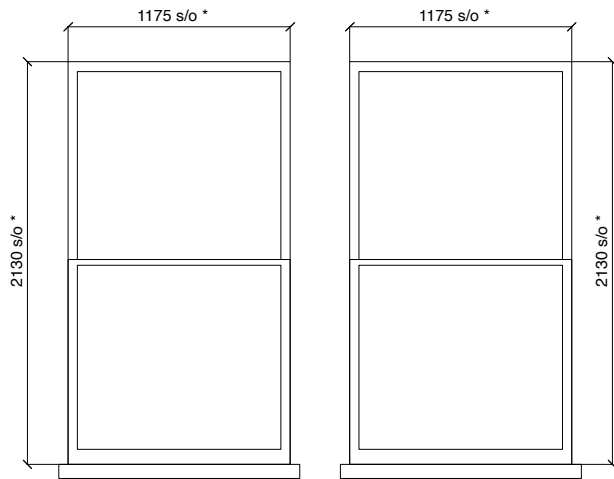

**Room 2
Bedroom 1**

Window Reference:
WEX-2-03.

Hardwood timber framed sash window to match existing. Painted timber finish internally and externally. Double glazed. Clear glazing.

Ironmongery to match existing. Sash stop lock.

Refer to Specification.

Approximate dimensions, contractor confirm existing dimensions on site.

**Room 2
Bedroom 1**

Window Reference:
WEX-2-02.

Hardwood timber framed sash window to match existing. Painted timber finish internally and externally. Double glazed. Clear glazing.

Ironmongery to match existing. Sash stop lock.

Refer to Specification.

Approximate dimensions, contractor confirm existing dimensions on site.

**Room 2
Bedroom 1**

Window Reference:
WEX-2-01.

Hardwood timber framed sash window to match existing. Painted timber finish internally and externally. Double glazed. Clear glazing.

Ironmongery to match existing. Sash stop lock.

Refer to Specification.

Approximate dimensions, contractor confirm existing dimensions on site.

**Room 5
Kitchen**

Window Reference:
WEX-5-01.

Hardwood timber framed sash window to match existing. Painted timber finish internally and externally. Double glazed. Clear glazing.

Ironmongery to match existing. Sash stop lock.

Refer to Specification.

Approximate dimensions, contractor confirm existing dimensions on site.

**Room 7
Bedroom 2**

Window Reference:
WEX-7-01.

Hardwood timber framed sash window to match existing. Painted timber finish internally and externally. Double glazed. Fluted glazing.

Ironmongery to match existing. Sash stop lock.

Refer to Specification.

Approximate dimensions, contractor confirm existing dimensions on site.

**Room 6
Bathroom**

Window Reference:
WEX-6-01.

Hardwood timber framed sash window to match existing. Painted timber finish internally and externally. Double glazed. Clear glazing.

Ironmongery to match existing. Sash stop lock.

Refer to Specification.

Approximate dimensions, contractor confirm existing dimensions on site.

01 : PROPOSED EXTERNAL WINDOWS

Rev.	Date	Description
-	21.09.20	First draft issue.
A	07.06.21	Added scale bar.

Key:
 Existing construction

Notes:
1. All dimensions in mm (except where noted).
2. Survey conducted by Apex Surveys, drawing number 1837/01.

**studio
on the
rye**

t 020 7924 0125 e sarah@studioontherye.com w www.studioontherye.com
a Springbank Studio 81A Grove Park London SE5 8LE

Project: 145A Ashley Gardens, Thirleby Road London SW1P 1HW
Client: Matt Archenhold + Olga Trujillo
Title: Proposed External Window Schedule
Scale: 1:20 at A3
Project no: A0078
Drawing no: **A0078-PL-811/A**