

East Elevation as Existing · 1:50.

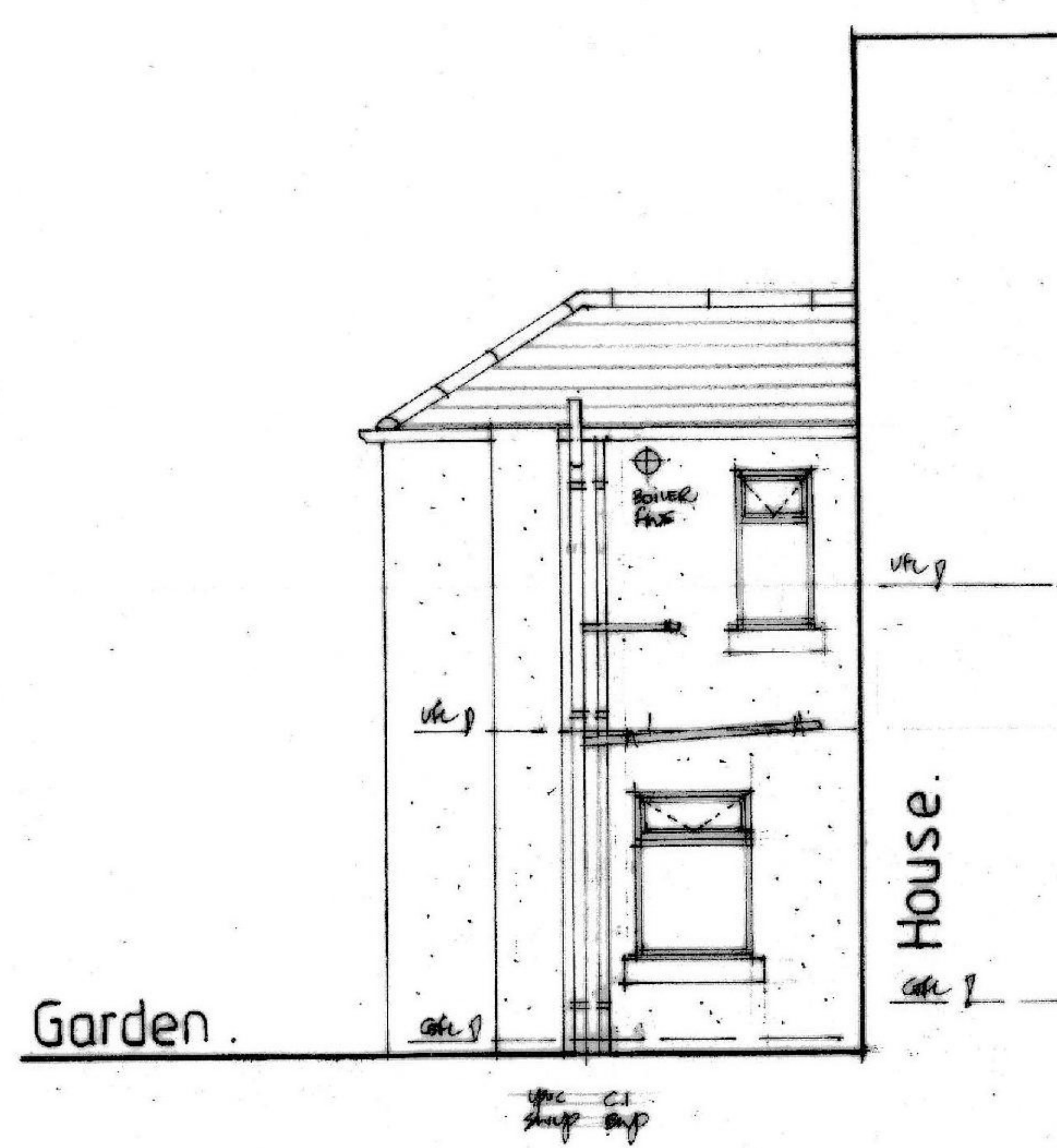

North Elevation as Existing · 1:50.

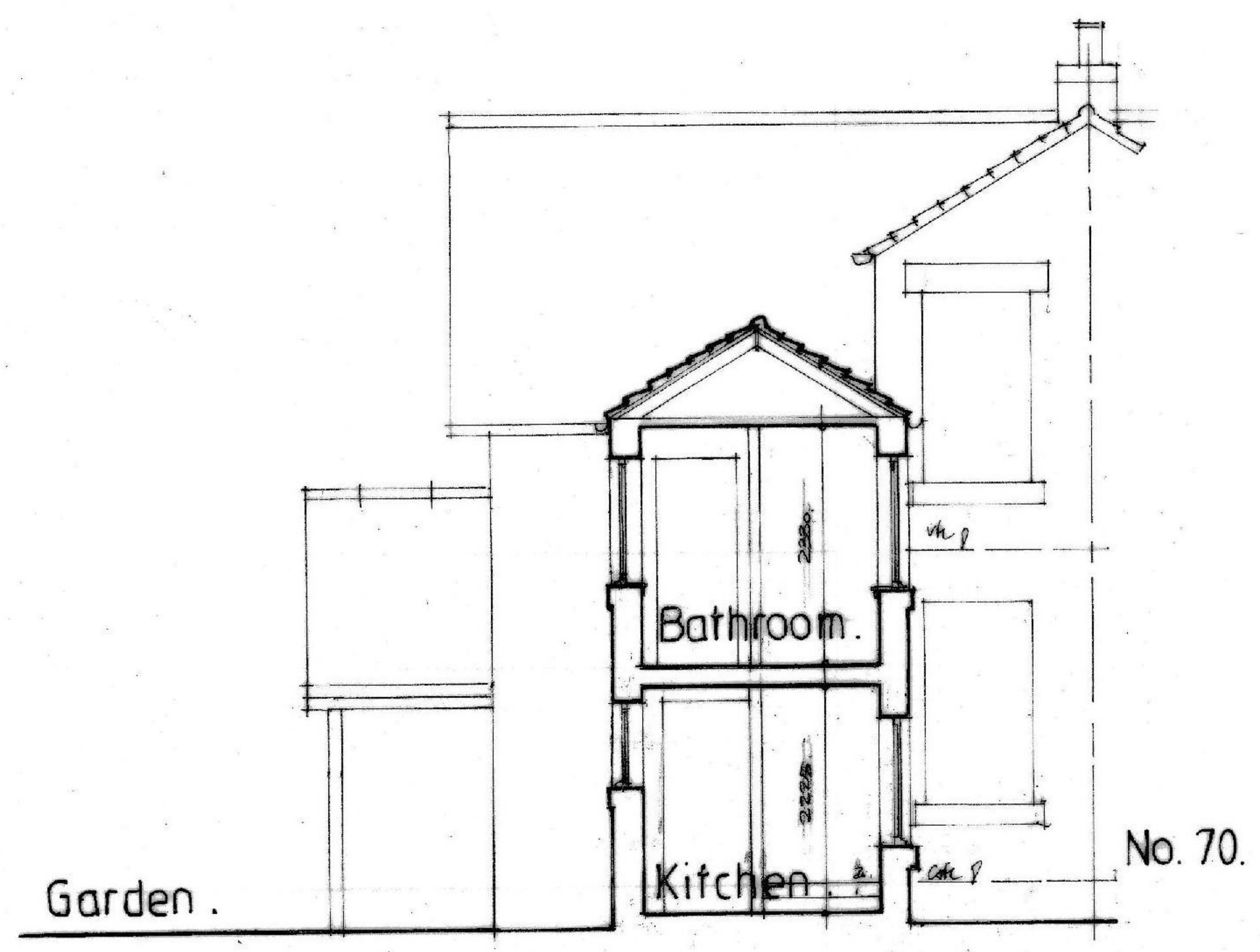

Cross Section as Existing · 1:50.



South Elevation as Existing · 1:50.

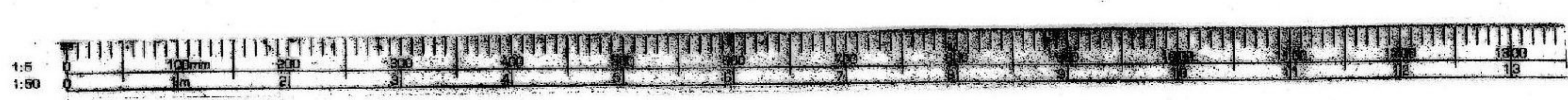

G.M. THOMSON Chartered Architect 28 Crossvegate, Milngavie, G62 6RA Tel: [REDACTED] Fax: [REDACTED] Mob: [REDACTED] E-mail: [REDACTED]	Client: Mr. T. Kelly, 68 Crawford Drive, Old Drumchapel, Glasgow, G15 6TR	Project: Proposed Single Storey Extension to Rear of House at 68 Crawford Drive, Old Drumchapel
	Title: North, South & East Elevations & Cross Section as Existing	
	Scale: 1:50 Date: June 2021	No: 1624-04 Rev: