

**NOTES**

Copyright: All rights reserved.  
 This drawing must not be reproduced without permission.  
 This drawing must not be scaled. Dimensions are in millimetres unless specified.

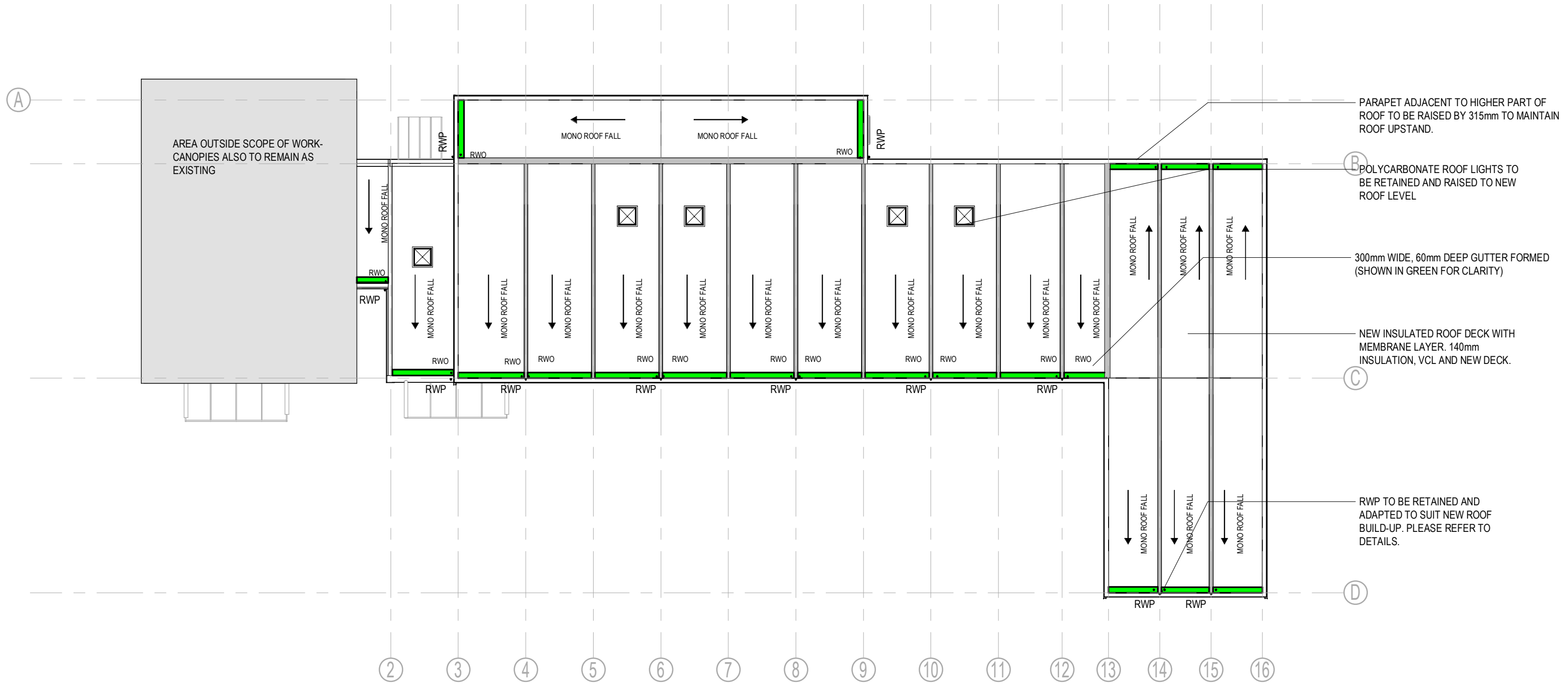

**NOTE -**

**FIRE BARRIERS** - CONTRACTOR TO ENSURE EXISTING FIRE BARRIERS WITHIN ROOF VOID ARE REINSTATED/REPLACED AS PART OF ROOF REFURBISHMENT TO ENSURE FIRE INTEGRITY OF COMPARTMENTS ARE PRESERVED.

**LIGHTENING PROTECTION** - EXISTING LIGHTENING PROTECTION TO BE REMOVED AND RE-INSTATED AS PART OF WORKS-- SPECIALIST TO ENSURE DESIGN CONFORMS TO ALL RELEVANT STANDARDS

**1 Roof Plan**  
 1 : 200

P3	01.07.21	Amendments made in-line with comments from BJ Planning.	RM	EWA
P2	25.06.21	AMENDMENTS MADE TO ROOF.	RM	EWA
REV	DATE	REVISION NOTE	BY	CHECK

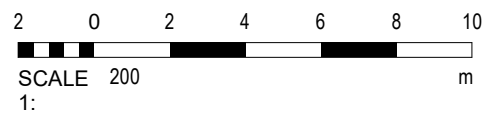

Wellfield Chester Road Preston Brook WA7 3BA  
 T: +44 1928 752 200 E: info@ewa.co.uk

**SHEET SIZE: A3**

Orchid Vale Primary School- Re-Roofing

Roof Plan - Proposed

2708\_ 10405

STATUS | PLANNING

DRAWN BY | OD

SCALE | 1 : 200

DATE | 07.05.21

REV P3

OV- EWA- ZZ- R1- DR- A- 10405