

For planning purposes

This drawing is the copyright of CAD delta and may not be altered or reproduced in any way without written permission from CAD delta.

Written dimensions supersede scaled dimensions. All levels and dimensions to be checked on site before commencement of the works. If in doubt ask. It is the clients responsibility to ensure that they are working from the latest issue of drawings, and this is to be confirmed first prior to starting on site.

This drawing is to be used only for the purposes intended as noted by the Drawing Status.

All works must comply with current Building Regulations and the relevant accredited details whether specifically detailed or not.

No works to be started until both Planning and Building Regulation approvals have been given by the local authority, and it is the clients responsibility to comply with any conditions placed on the approvals, and with the party wall act 1996, including CDM regulations where applicable.

It is the clients responsibility to determine the presence of any contamination and services in the vicinity of the works, prior to starting, and if the works affect any easement requirements or party wall act. It is the clients responsibility to notify and register with Robust details, and any warranty provider where applicable prior to starting the project.

Topographical survey reproduced courtesy of Richard Williams

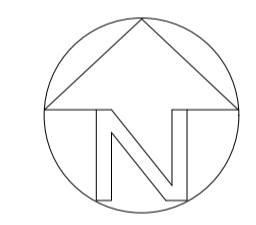
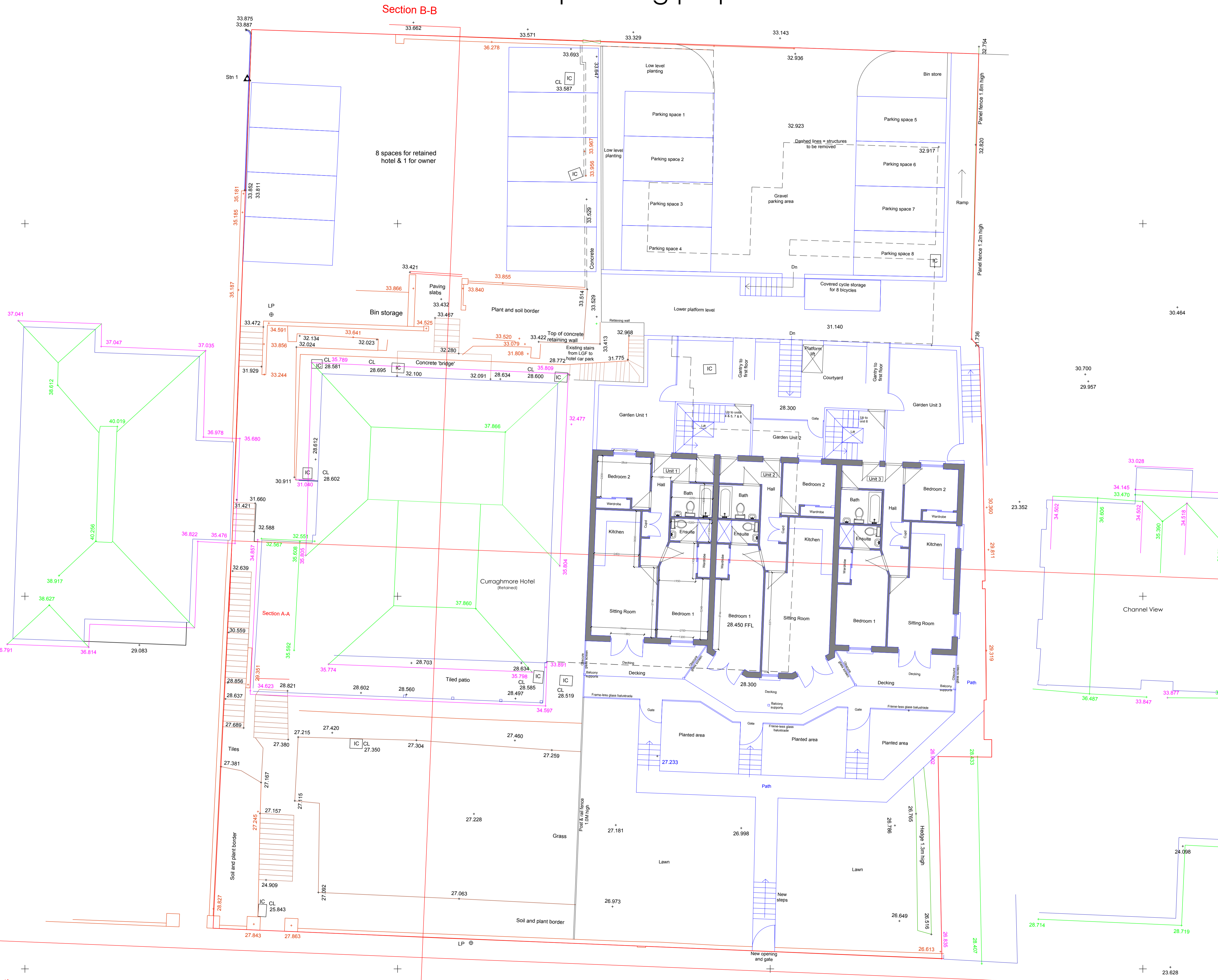

Rev A - Dec 17

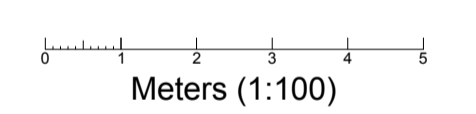

Project Title
Proposed redevelopment
The Curraghmore Hotel
22 Hope Road
Shanklin
PO37 6EA

Client Mr and Mrs Lazenby

Drawing Title
Proposed Site Plan

Drawing Status Planning

Drawing No. 006-17.2 **Revision** 1.25

Date Sept 17 Scale(s) 1:100 Drawn by GC

A1
CAD delta
Architectural Services, New-build, Extensions & Conversions

CAD delta Ltd.
3, Drake Road, Newport,
Isle of Wight, PO30 1EQ
www.CADdelta.co.uk
Tel: 01983 521987
email: sales@CADdelta.co.uk

THIS DRAWING IS THE COPYRIGHT OF CAD delta

Elevation A-A

37.041	36.791	36.814	29.083
38.612	38.917	38.627	
40.019	40.256		
37.047	37.035	36.978	35.680
35.187	35.185	35.181	33.852
33.887	33.875		

Section B-B