

For planning purposes

This drawing is the copyright of CAD delta and may not be altered or reproduced in any way without written permission from CAD delta.

Written dimensions supersede scaled dimensions. All levels and dimensions to be checked on site before commencement of the works. If in doubt ask. It is the clients responsibility to ensure that they are working from the latest issue of drawings, and this is to be confirmed first prior to starting on site.

This drawing is to be used only for the purposes intended as noted by the Drawing Status.

All works must comply with current Building Regulations and the relevant accredited details whether specifically detailed or not.

No works to be started until both Planning and Building Regulation approvals have been given by the local authority, and it is the clients responsibility to comply with any conditions placed on the approvals, and with the party wall act 1996, including CDM regulations where applicable.

It is the clients responsibility to determine the presence of any contamination and services in the vicinity of the works, prior to starting, and if the works affect any easement requirements or party wall act. It is the clients responsibility to notify and register with Robust details, and any warranty provider where applicable prior to starting the project.

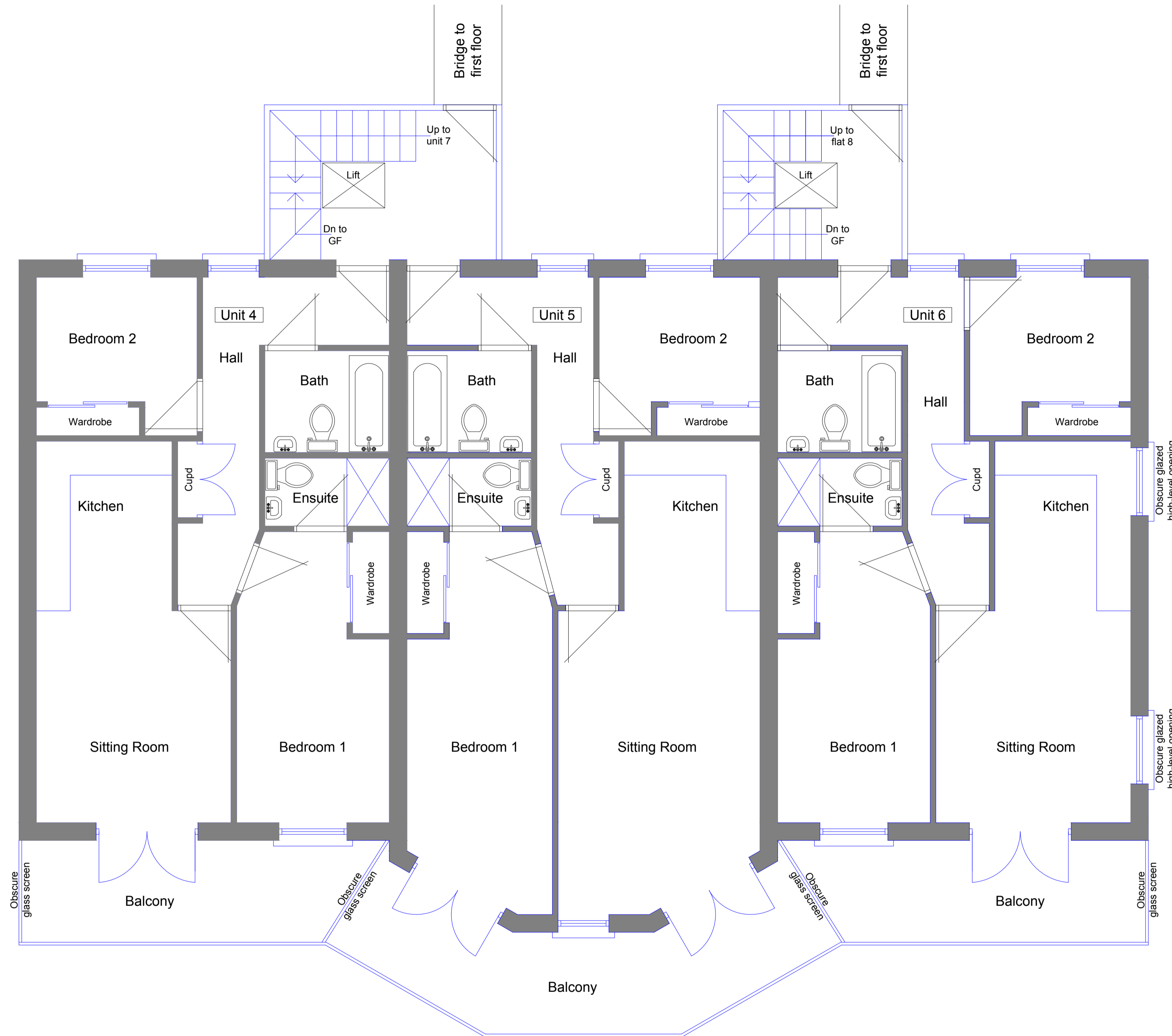

Rev A - Dec 17

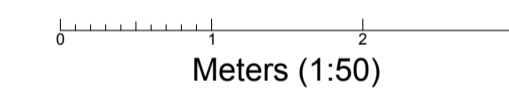

Project Title
 Proposed redevelopment
 The Curraghmore Hotel
 22 Hope Road
 Shanklin
 PO37 6EA

Client Mr and Mrs Lazenby

Drawing Title
 Flats: first floor plans

Drawing Status Planning

Drawing No. 006-17.6 **Revision** 1.25

Date Sept 17 Scale(s) 1:50 Drawn by GC

A1
CAD delta
 Architectural Services, New-build, Extensions & Conversions

CAD delta Ltd.
 3, Drake Road, Newport,
 Isle of Wight, PO30 1EQ
 www.CADdelta.co.uk
 Tel: 01983 521987
 email: sales@CADdelta.co.uk

THIS DRAWING IS THE COPYRIGHT OF CAD delta