

NOTES:
 COPYRIGHT ©
 PLANNED DRAWINGS ONLY ARE TO BE USED, FOR OTHER PURPOSES REFER TO THE DRAWER. ALL DRAWINGS OR WORKS PRODUCED IN WHOLE OR IN PART BY THE DRAWER, OR ANY OF ITS EMPLOYEES, AGENTS OR SUBCONTRACTORS, ARE HEREBY CONFIRMED TO BE THE PROPERTY OF THE DRAWER AND NOT TO BE REPRODUCED OR TRANSMITTED IN ANY FORM OR BY ANY MEANS, ELECTRONIC OR MECHANICAL, INCLUDING PHOTOCOPYING, RECORDING, OR BY ANY INFORMATION STORAGE AND RETRIEVAL SYSTEM, WITHOUT THE WRITTEN PERMISSION OF THE DRAWER.

CAD REGULATIONS 1984
 This drawing has been prepared to minimise the risk to health & safety during construction. The design, planning supervisor and contractor should be consulted for any specific safety requirements. The contractor should inform the engineer or designer of any operations that require inspection, and all work and one to be provided as required. All work one to be in accordance with the following details:-
 This construction (Design & Management) 1984. Electricity of Work, 1989. 1974.
 A method statement for erection of scaffolding to be prepared and approved before work commences. It should be approved by the engineer or designer. All working areas are to be fenced off and the site kept safe after working hours.

THE PARTY WALL ETC ACT 1996
 The Party Wall etc Act 1996 may apply in which case proper notice should be given to the adjoining owner clearly describing the work to be carried out and enclosing a copy of this drawings.

PLANNING AND BUILDING REGULATIONS:
 This drawing is prepared for the purpose of obtaining Building, electrical and other details will be submitted to the local authority for building regulations. It is recommended that you should not commence work until Building Regulations approval is received and any conditions therein have been discharged. It is the Contractor's responsibility to ensure that the drawings are in working form and comply with the requirements of these approved under building regulations.

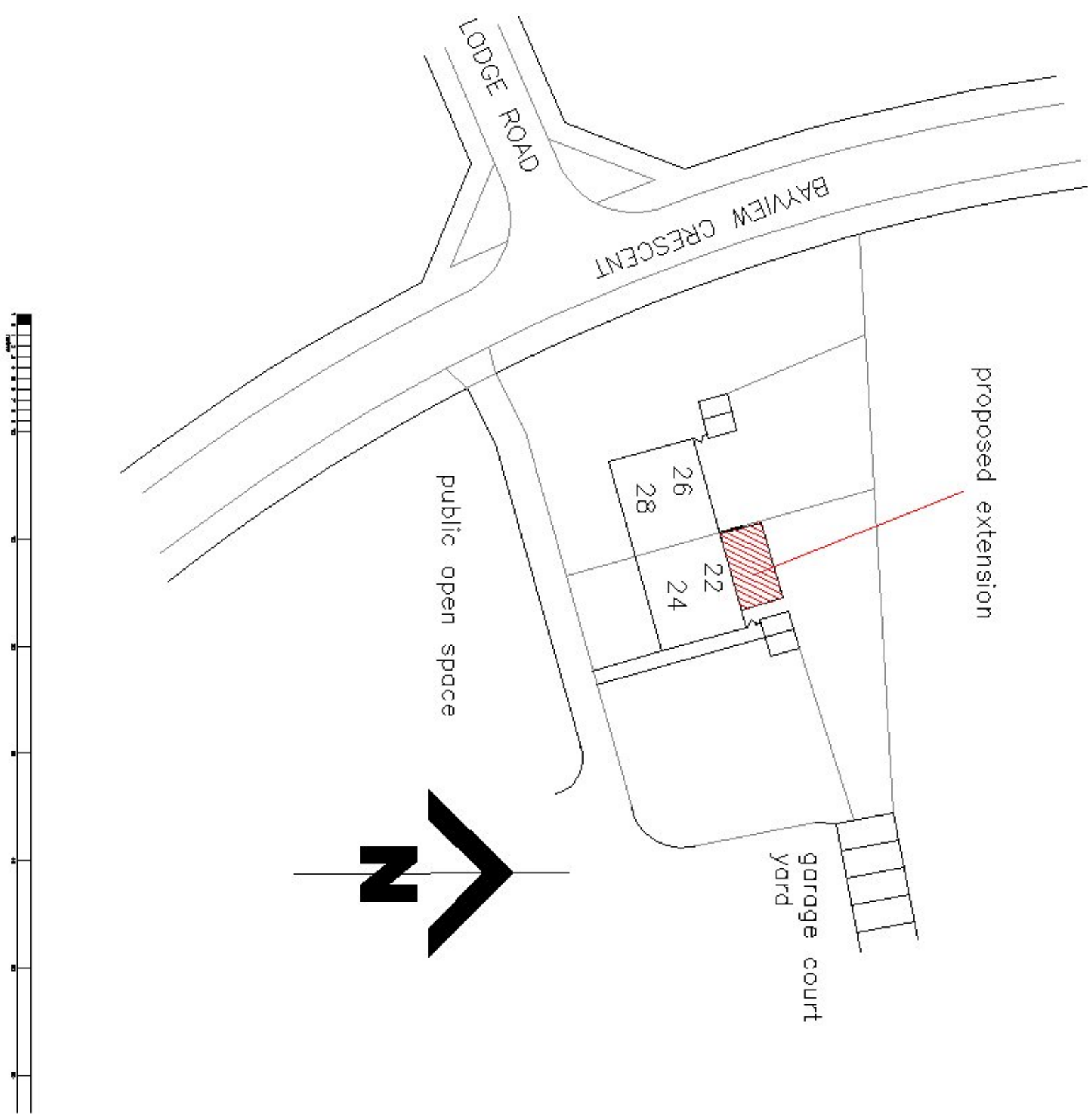

REV. DATE DETAILS.
PROJECT PROPOSED SINGLE STOREY EXTENSION
DRAWING BLOCK PLAN
LOCATION 24 BAYVIEW CRESCENT LITTLE OAKLEY
CLIENT MR C SMITH
SCALE 1:500
DRAWING NO. 2101.3/0
DATE 31.5.21
ISSUE PLANNING
John McPherson Architectural. First Floor 29 Station Road Dovercourt Essex CM12 3AL tel: [REDACTED]

