

EXISTING GROUND FLOOR

EXISTING ROOFTOP PLAN

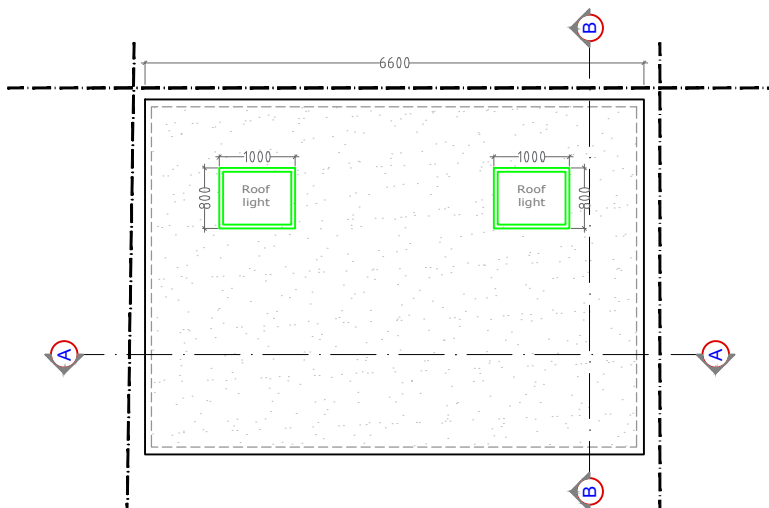
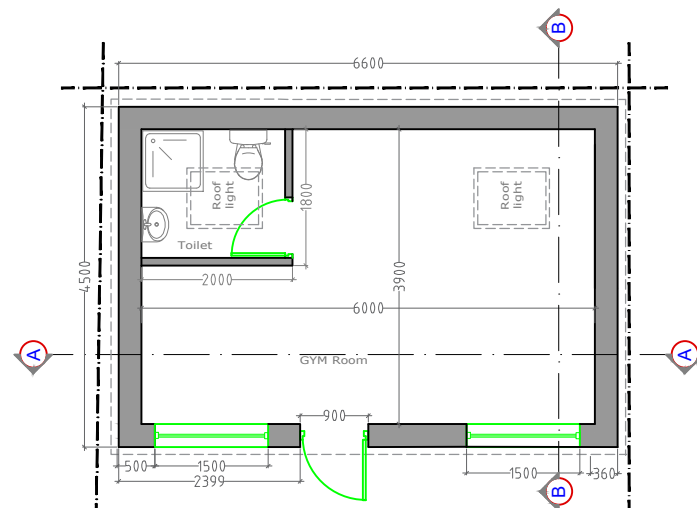

PROPOSED GROUND FLOOR

PROPOSED ROOFTOP PLAN

Original Garden: 105m<sup>2</sup>  
50% of original garden: 52.5m<sup>2</sup>  
Existing extension: 17.5m<sup>2</sup>  
Usable space: 52.5 - 17.5 = 35m<sup>2</sup>  
New outbuilding: 29.7m<sup>2</sup>

Hence 29.7m<sup>2</sup> is less than 35m<sup>2</sup> and the proposal is within permitted development rights

CLIENT:  
Mr Akanesyans

Project:  
Outbuilding

Address:  
48 Parkfield Road  
Northolt  
UB5 5NW

TITLE:  
EXISTING & PROPOSED GROUND FLOOR PLAN  
EXISTING & PROPOSED ROOF PLAN

PROJECT NUMBER:  
180302-3

REV: A

SCALE:  
1:100 @ A3

DRAWING No:  
A-01

DATE:  
04/07/2021

